

# **TREK**

**Ion Pro RT and  
Flare RT**

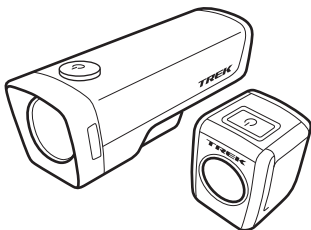

Please read this entire manual, especially the safety information. Check for updates at [trekbikes.com](http://trekbikes.com)

**IMPORTANT:** Check your local lighting laws. Flashing lights and full brightness may not be allowed in all locations. Ion Pro RT and Flare RT do not conform to the German road traffic regulation StVZO.

## **WARNING**

If you or someone you are riding with has photosensitivity to flashing lights, ensure this light does not trigger an episode prior to use on the road. While the flash pattern is designed to be outside of the frequency range most associated with causing a photosensitive reaction (5-60Hz), each individual's response may vary, and having an episode while riding may result in serious injury or death.

## **WARNING**



These lights are very bright. Do not stare at an operating light. Staring may be harmful to the eyes.

- The front light may be hot and could cause a burn or damage material it may contact.
- Do not activate (turn on) light in enclosed area.
- Do not use if the battery is impacted. Also do not puncture, crush, deform, disassemble, or heat a lithium-ion battery above the permitted temperature. Inflicted damage to the battery may result in a fire, explosion, or coming in contact with specks of lithium or lithium dust.

# Specifications

## Ion Pro RT

- Battery: 17.78 Wh, 21700 lithium Ion battery
  - Capacity: 4900mAh
  - Voltage (Nom): 3.63 V
  - Charge Voltage: 5V
  - Weight: 187g (6.6oz)
  - Ingress rating: IPX4
  - Charge Temperature: 0°–40° C (32°–104° F)
  - Storage Temperature: -20°–60° C (-4°–140° F)
- Reduced performance when operating below freezing.

## Flare RT

- Battery: 1.6 Wh lithium polymer battery
  - Capacity: 420mAh
  - Voltage (Nom): 3.7 Vdc
  - Charge Voltage: 5V
  - Weight: 33g (1.2oz)
  - Charge Temperature: 0°–40° C (32°–104° F)
  - Storage Temperature: -20°–60° C (-4°–140° F)
- Reduced performance when operating below freezing.

## For more information

If you need help not offered by this manual, talk to your Trek retailer or visit [trekbikes.com](http://trekbikes.com).

# Parts list

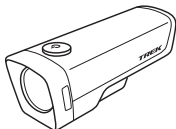

**Ion Pro RT**



**Flare RT**

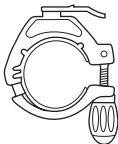

**Bar mount**



**Quick Connect  
Rear Mount**

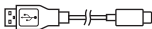

**USB-C cable**

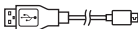

**Micro USB cable**

# Operation

## **Ion Pro RT:**

To turn on, double click the power button.

To turn off, press and hold the power button.

## **Flare RT:**

To turn on, single click the power button.

To turn off, press and hold the power button.

## **Low battery feature**

When the battery charge drops below 5% the light automatically adjusts the output brightness to 50 lumens. This extends the light output for an additional 30 minutes.

## **Light Mode Lock and Unlock**

Turn on the Ion Pro RT and select the desired light mode. Press and hold the power button for 8 seconds. The light will turn off and then flash once. To unlock, repeat the process.

## **Reset**

To reset the light to factory default settings, with the light on, press and hold the power button for 15 seconds. The light will flash once at 8 seconds, and again at 15 seconds. Release the button after the second flash.

## **Wireless Communication**

The lights are shipped with ANT+ and Bluetooth wireless connectivity. This feature is OFF until the lights are turned on for the first time.

### **To disable (Flare RT only)**

With the light off, press and hold the power button for 15 seconds. The light will flash once at 8 seconds, and again at 15 seconds. Release the button after the second flash.

**NOTE (Flare RT only):** The status LED turns on blue for 3 seconds IF the wireless is enabled. After 3 seconds, the status LED continues to display the battery level. If the wireless is disabled, the status LED immediately displays the battery level.

### **Auto brightness (Flare RT only)**

The light is shipped with an ambient light sensor disabled. When the ambient light sensor is enabled, the light automatically changes modes with ambient light conditions. It changes from Day Flash or All Day Flash to Night Flash, or Day Steady to Night Steady. To enable, press and hold the power button 8 seconds. The light will flash once.

# Modes

To change mode, quick-press the power button.

## Ion Pro RT



### High

1300 lumens  
(1.5 hours of runtime)  
Green steady LED  
25-100% battery life



### Medium

800 lumens  
(3 hours of runtime)  
Green steady LED  
25-100% battery life



### Low

400 lumens  
(6 hours of runtime)  
Red steady LED  
5-25% battery life



### Day flash

300 lumens  
(24 hours of runtime)  
Red flashing LED  
< 5% battery life



## Flare RT



### Day flash

90 lumens  
(6 hours of runtime)  
Green steady LED  
25-100% battery life



### All day flash

45 lumens  
(12 hours of runtime)  
Green steady LED  
25-100% battery life



### Night flash

5 lumens  
(15 hours of runtime)  
Red steady LED  
5-25% battery life



### Day steady

25 lumens  
(4.5 hours of runtime)  
Red flashing LED  
< 5% battery life



### Night steady

5 lumens  
(13.5 hours of runtime)  
Red flashing LED  
< 5% battery life

## Battery charging

Although the lights are charged at the factory, Trek recommends charging before first use.

**IMPORTANT:** For best results, charge at room temperature in a dry place.

Use a certified CE or UL approved USB-C (Ion Pro RT) or Micro USB (Flare RT) charger. Avoid extreme conditions including wet, cold, or extreme heat.

1. Open the USB port cover.
2. Plug the charger cable into the USB port on the light.
3. Plug the cable into a computer or wall adapter.
4. When the charge is complete, unplug the charger cable and close the USB port cover.

**NOTICE:** Ensure the USB covers are latched and secure before riding in rain or in wet conditions. If the USB cover is not closed, damage to the lights may occur.

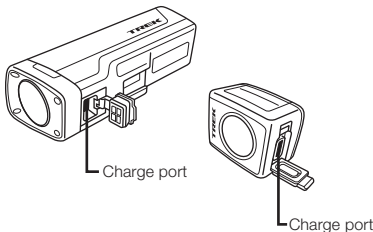

## **Ion Pro RT Battery charging status**

### **Red flash**

<25%

### **Yellow flash**

25%-75%

### **Green flash**

75%-99%

### **Green steady**

100%

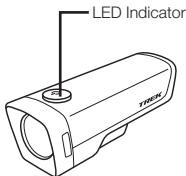

## **Flare RT Battery charging status**

### **Red flash**

0-75%

### **Green flash**

75%-99%

### **Green steady**

100%

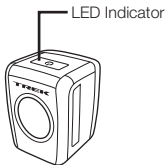

When fully charged, status led remains steady for 1 minute then turns off.

# Installation

## Ion Pro RT Installation

1. Loosen knob and open.
2. Adjust for bar size (31.8mm or 35mm).
3. Close and tighten knob.
4. Slide light onto mount until it locks in place.

**NOTE:** Use provided shim to fit 25.4 bars.

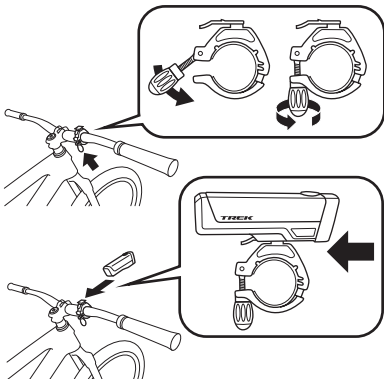

## Removal

1. Press down on mount notch.
2. Slide light to remove.

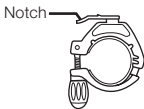

## Flare RT Installation

### To attach with the Quick Connect rear mount

1. Attach strap to seatpost.
2. Slide light onto mount until it locks in place.

**IMPORTANT:** The seatpost/saddle icon shows that the lens is oriented perpendicular to the ground to optimize visibility.

**NOTE:** Use the second hook to latch any excess strap.

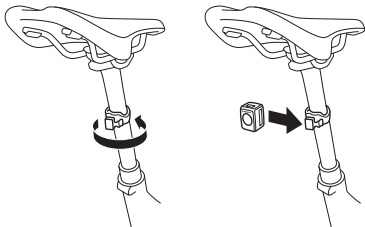

### Removal

1. Press down on mount notch.
2. Slide light to remove.

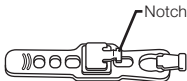

## Battery care

Store the lights at room temperature in a dry place. Avoid moisture, or extreme hot or cold. Store the lights in the charged condition. Avoid “deep discharge.”

Battery life will decrease if the lights are stored in a fully discharged condition.

Over time, the run time of the batteries will diminish.

Expect about 500 full charges, depending on care.

After a full life, the batteries will continue to charge but with a lower run time. When the run time is unsatisfactory, please recycle. Do not open the case of the lights or incinerate.

## Traveling with the lights

The lights contain a lithium battery. Certain restrictions may apply to this product when traveling, especially when traveling by air. Always check with your carrier for specific restrictions prior to traveling with this product.

## Recycling

Please recycle the battery.

In the US, you can find out where to do this at call2recycle:

<http://www.call2recycle.org/>

This symbol on the product(s) and/or accompanying documents means that used electrical and electronic products should not be mixed with general household waste. For proper treatment, recovery, and recycling outside the US, please take this product(s) to

designated collection points. Alternatively, in some countries you may be able to return your products to your local retailer upon purchase of an equivalent new product.

Disposing of this product correctly will help save valuable resources and prevent any potential negative effects on human health and the environment, which could otherwise arise from inappropriate waste handling. Please contact your local authority for further details of your nearest designated collection point. Penalties may be applicable for incorrect disposal of this waste, in accordance with your national legislation.



# **Trek contact information**

## **North America**

Trek Bicycle  
801 West Madison Street  
Waterloo, WI 53594 USA  
Tel: +1 800-313-8735

## **Europe**

Bikeurope BV  
Ceintuurbaan 2-20C  
3847 LG Harderwijk  
The Netherlands  
Tel: +31 (0)33 45 09 060

## **United Kingdom**

Trek Bicycle Corporation, Ltd.  
Victory House South, The  
Park MK  
Ortensia Dr, Milton Keynes,  
MK 17 8 LX, UK  
TEL: +44 1908 360 140

## **Australia**

Trek Bicycle Corp. Au.  
8 Townsville Street  
(Level One)  
Fyshwick (ACT)  
2609 AU  
Tel: +61 (02) 61 732 400

## **South Korea**

5th floor, 312,  
Yeongdong-daero  
Gangnam-gu, Seoul  
Republic of Korea  
ZIP Code: 06177

## **Japan**

トレック・ジャパン(株)  
7-28 Oide-cho  
Nishinomiya-shi, Hyogo-ken  
Japan 662-0036

# FCC Compliance Statement:

Ion Pro RT - FCC ID: 2AHXD552373

Flare RT - FCCC ID: 2AHXD553852

This device complies with part 15 of the FCC Rules.

Operation is subject to the following two conditions:

- (1) This device may not cause harmful interference, and
- (2) this device must accept any interference received, including interference that may cause undesired operation.

**NOTE:** This equipment has been tested and found to comply with the limits for a Class B digital device, pursuant to part 15 of the FCC Rules. These limits are designed to provide reasonable protection against harmful interference in a residential installation.

This equipment generates, uses and can radiate radio frequency energy and, if not installed and used in accordance with the instructions, may cause harmful interference to radio communications. However, there is no guarantee that interference will not occur in a particular installation.

If this equipment does cause harmful interference to radio or television reception, which can be determined by turning the equipment off and on, the user is encouraged to try to correct the interference by one or more of the following measures:

- Reorient or relocate the receiving antenna.
- Increase the separation between the equipment and receiver.
- Connect the equipment into an outlet on a circuit different from that to which the receiver is connected.
- Consult the dealer or an experienced radio/TV technician for help.

Changes or modifications not expressly approved by the party responsible for compliance could void the user's authority to operate the equipment.

This equipment complies with FCC radiation exposure limits set forth for an uncontrolled environment. This equipment should be installed and operated with a minimum distance of 20cm between the radiator and a human body.



# **Canadian Compliance**

Ion Pro RT - (P/N 5298295) IC ID: 21334-552373

Flare RT - (P/N 5298300) IC ID: 21334-553852

CAN ICES-3(B)/NMB-3(B)

This device contains license-exempt transmitter(s) that comply with Innovation, Science and Economic Development Canada's license-exempt RSS(s). Operation is subject to the following two conditions:

(1) this device may not cause interference, (2) this device must accept any interference, including interference that may cause undesired operation of the device.

## **RF Exposure Statement:**

This equipment complies with ISED radiation exposure limits set forth for an uncontrolled environment. This equipment should be installed and operated with a minimum distance of 20cm between the radiator and a human body.

L'émetteur exempt de licence contenu dans le présent appareil est conforme aux CNR d'Innovation, Sciences et Développement économique Canada applicables aux appareils radio exempts de licence. L'exploitation est autorisée aux deux conditions suivantes : (1) L'appareil ne doit pas produire de brouillage; (2) L'appareil doit accepter tout brouillage radioélectrique subi, même si le brouillage est susceptible d'en compromettre le fonctionnement.

## **Déclaration d'exposition aux RF :**

Cet équipement est conforme aux limites d'exposition aux rayonnements ISED établies pour un environnement non contrôlé. Cet équipement doit être installé et utilisé avec une distance minimale de 20 cm entre le radiateur et un corps humain.

## UK Compliance



Trek Bicycle Corporation hereby declare that the lighting devices identified as 'IonProRT' and 'Flare RT' are in compliance with the following UK legislation:

- The Electromagnetic Compatibility Regulations 2016
- Electrical Equipment (Safety) Regulations 2016
- The Restriction of the Use of Certain Hazardous Substances in Electrical and Electronic Equipment Regulations 2012
- The Radio Equipment Regulations 2017

Full text of the UK declaration of conformity is available from your dealer, or at the following internet address: [www.trekbikes.com/coc-doc](http://www.trekbikes.com/coc-doc).

## European Union Compliance



Trek Bicycle Corporation hereby declare that the wireless device identified as 'Ion Pro RT' and 'Flare RT' are in compliance with the following European Directives:

- Radio Equipment Directive 2014/53/EU
- EMC Directive 2014/30/EU
- Low Voltage Directive 2014/35/EU
- RoHS Directive 2011/65/EU

The full text of the EU declaration of conformity is available from your dealer, or at the following internet address: <http://www.trekbikes.com/support>

**Ion Pro RT and Flare RT do not comply with German StVZO regulations.**

## China Compliance

Ion Pro RT - CMIIT ID: 2018DJ6875

Flare RT - CMIIT ID : 2018DJ5531

## Japan Compliance

トレック・ジャパン(株)

Ion Pro RT



018-180330

Flare RT



018-180227

## South Korea Compliance

Ion Pro RT - (P/N 5298295)



인증자 상호: TREK Bicycle Corporation

기기의 명칭: Ion Pro RT 특정소출력무선기기

(무선데이터통신시스템용 무선기기)

모델명: 5298295

제조사/제조국가: TREK Bicycle Corporation / 대만

인증자 식별부호: R-C-T3B-552373

Flare RT - (P/N 5298300)



인증자 상호: TREK Bicycle Corporation

기기의 명칭: Flare RT 특정소출력무선기기

(무선데이터통신시스템용 무선기기)

모델명: 5298300

제조사/제조국가: TREK Bicycle Corporation / 대만

인증자 식별부호: R-C-T3B-553852

당해 무선기기는 전파혼신 가능성이 있으므로 인명안전과 관련된 서비스는 할 수 없습니다. 당해 무선기기는 운용 중 전파혼신 가능성이 있음. 자전거 전조등 외 사용 금지

trekbikes.com