

TREK



2022 TOP FUEL

SERVICE MANUAL SUPPLEMENT

Contents



[Safety](#)

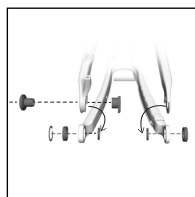

[Active Braking
Pivot \(ABP\)](#)

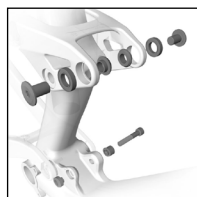

[Shock mounts](#)

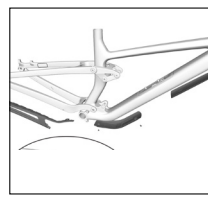

[Frame guards —
carbon frame](#)

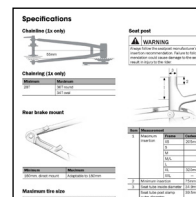

[Specifications](#)

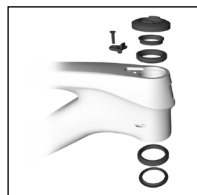

[Headset with
Knock Block](#)

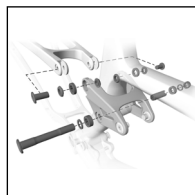

[Rocker pivot](#)

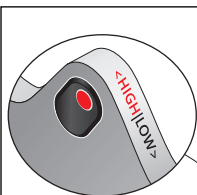

[Adjust the
geometry](#)

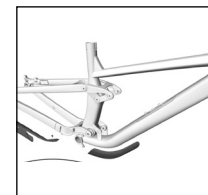

[Frame guards —
aluminum frame](#)

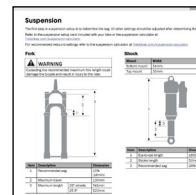

[Suspension](#)



[Derailleur hanger](#)

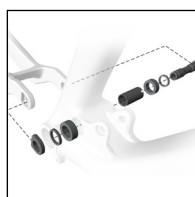

[Main pivot](#)

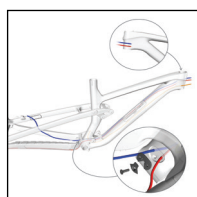

[Cabling](#)

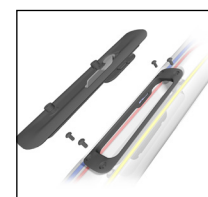

[Down tube storage](#)

Safety



WARNING

Properly tighten hardware

Always tighten hardware to the specified torque. Over-tightening hardware could deform or break the hardware or components. Under-tightening hardware could cause hardware or components to become loose. Either situation could damage the bicycle and result in injury to the rider.



WARNING

Reapply threadlocker

All reused-fasteners with pre-applied threadlocker must be cleaned with isopropyl alcohol and have new threadlocker applied before re-assembly. If threadlocker is not applied, the fasteners may loosen which could damage the bicycle and result in injury to the rider.

Legend



Apply grease



Do not apply grease



Apply threadlocker

Nm

Torque



Zip tie

Headset with Knock Block

Notice: To operate the bicycle without a Knock Block chip, a non-block chip must be installed.

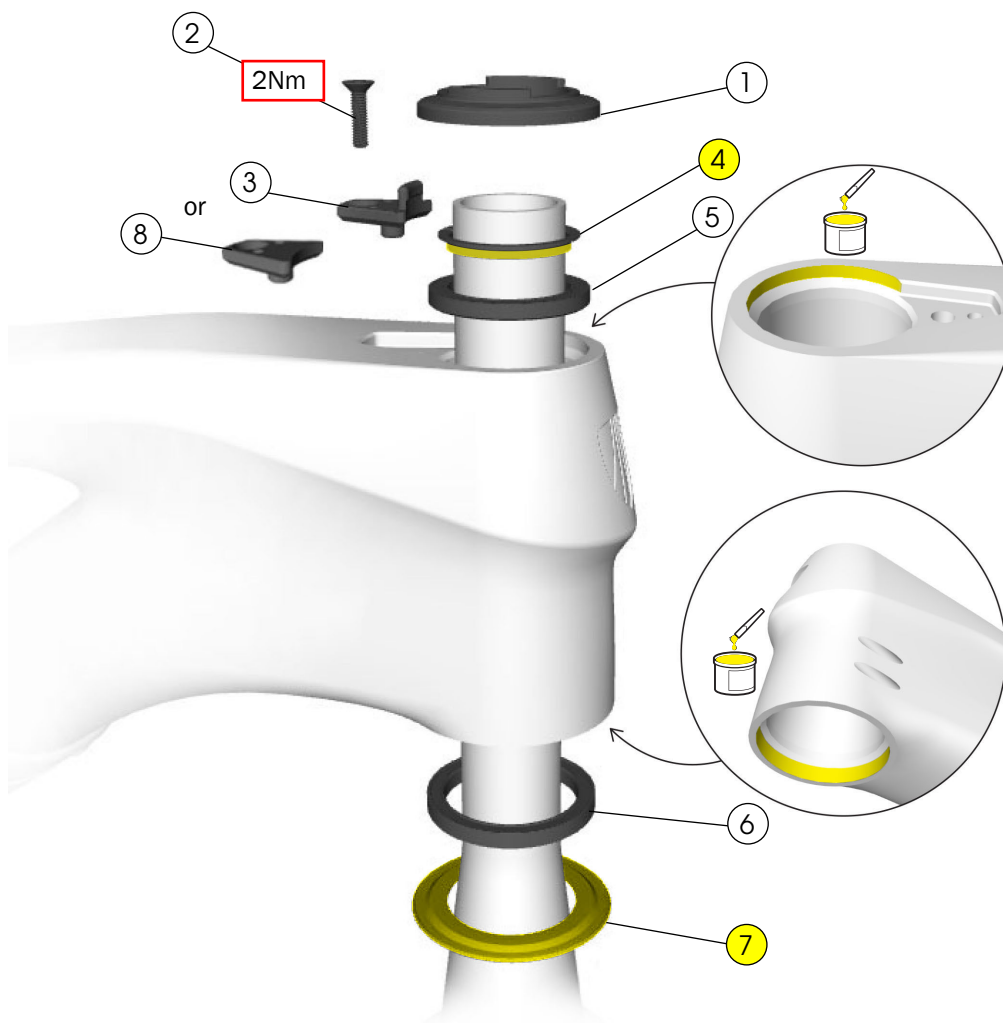

- | | |
|-----------------------------|-------------|
| ① Upper bearing cover |] — 5252161 |
| ② Chip bolt | |
| ③ Knock Block chip | |
| ④ Compression ring |] — 5252160 |
| ⑤ Upper bearing | |
| ⑥ Lower bearing | |
| ⑦ Crown race | |
| ⑧ Non block chip — W1048249 | |

Tools

- 2.5mm hex tool
- Torque wrench with 2.5mm hex bit
- Grease

Deraillieur hanger

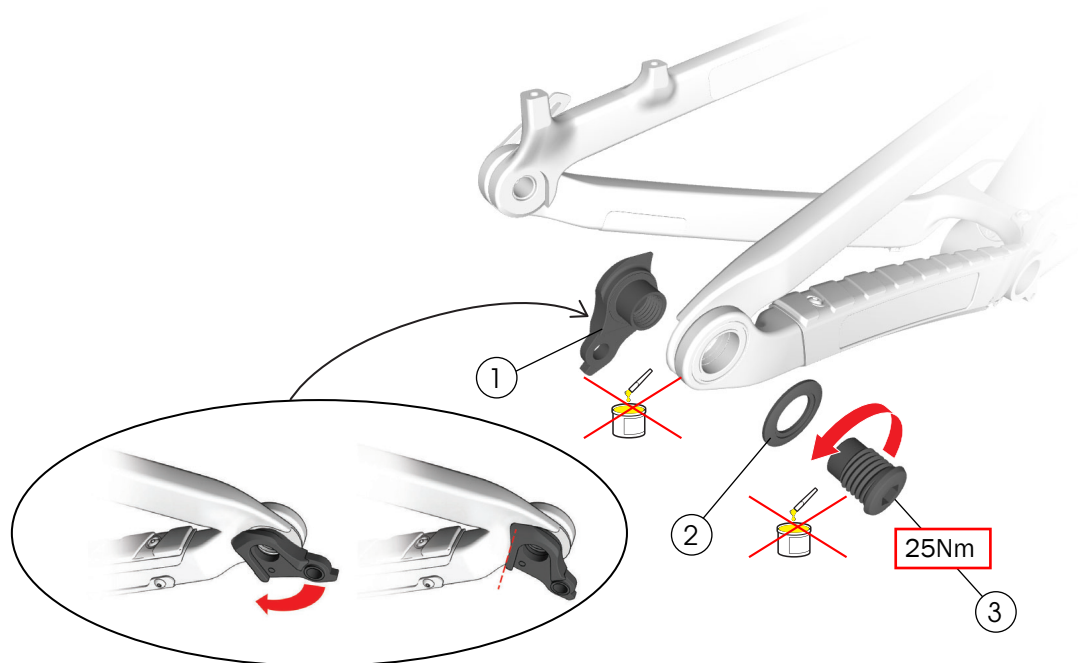

- | | |
|----------------------|-----------|
| ① Deraillieur hanger | — W583423 |
| ② Washer, 30mm | |
| ③ Bolt | |

Tools

- 8mm hex tool
- Torque wrench (left-hand thread) with 8mm hex bit



WARNING

Do not apply grease to the derailleur hanger or bolt.

This bicycle frame is designed to use a Universal Derailleur Hanger (UDH).

NOTICE: The thru axle must be compatible with a UDH and must be M12x1.0 with a 12.7mm thread.

NOTICE: The washer is frame-specific. Install only the washer size specified.

NOTICE: Do not over-tighten. Over-tightening the bolt could cause the hanger to break.

For additional information about the UDH, refer to the SRAM user manual at www.sram.com.

Active Braking Pivot (ABP)

Carbon frame

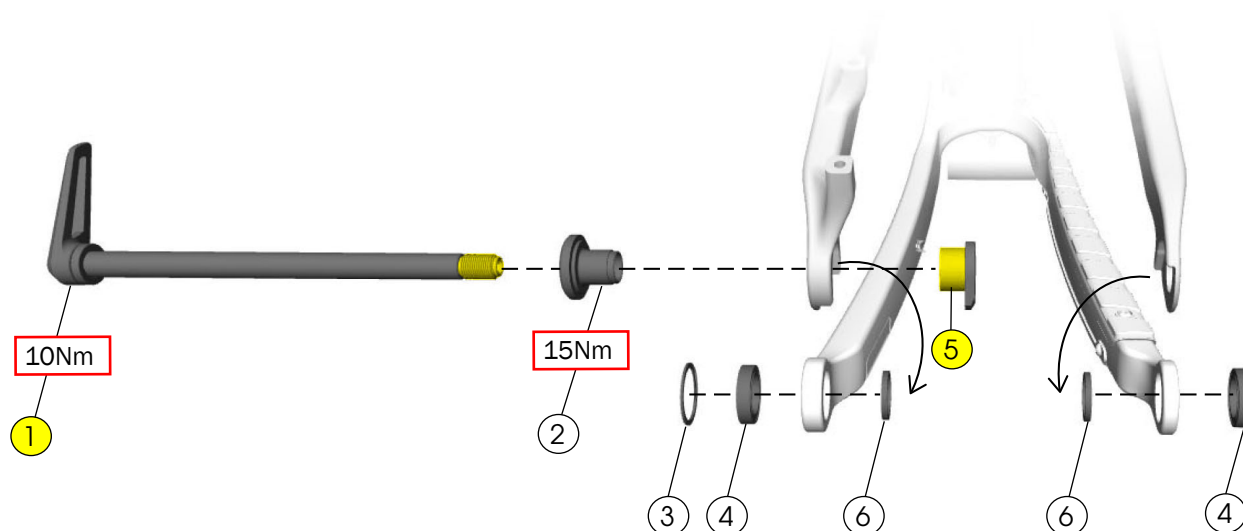

Aluminum frame

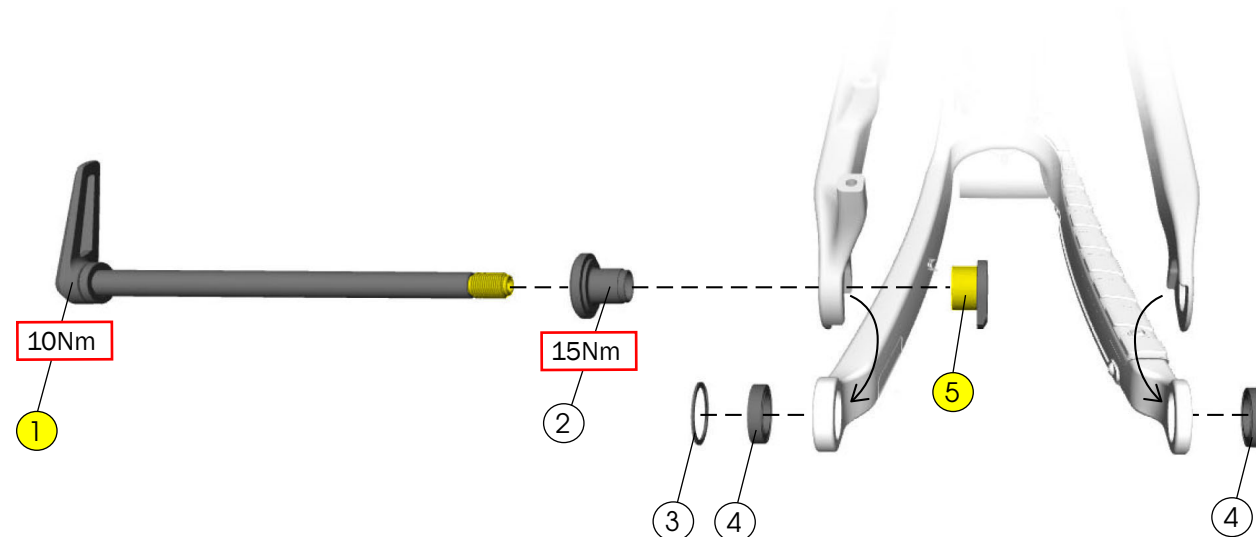

- ① Thru axle – W583469
- ② Non-driveside dropout – W5251141
- ③ Retaining ring – W5251279
- ④ Bearing – W5256340
- ⑤ Dropout – W5269707
- ⑥ Spacer – W583422
(for use with carbon frame only)

– W5272776

Tools

- Bearing press
- Cassette locking tool
- Grease

NOTICE: The thru axle must be compatible with a UDH and must be M12x1.0 with a 12.7mm thread.

Apply grease to:

- Threads of the thru axle (1)
- Shoulders of non-driveside dropout (2) and the dropout (5)

Rocker pivot

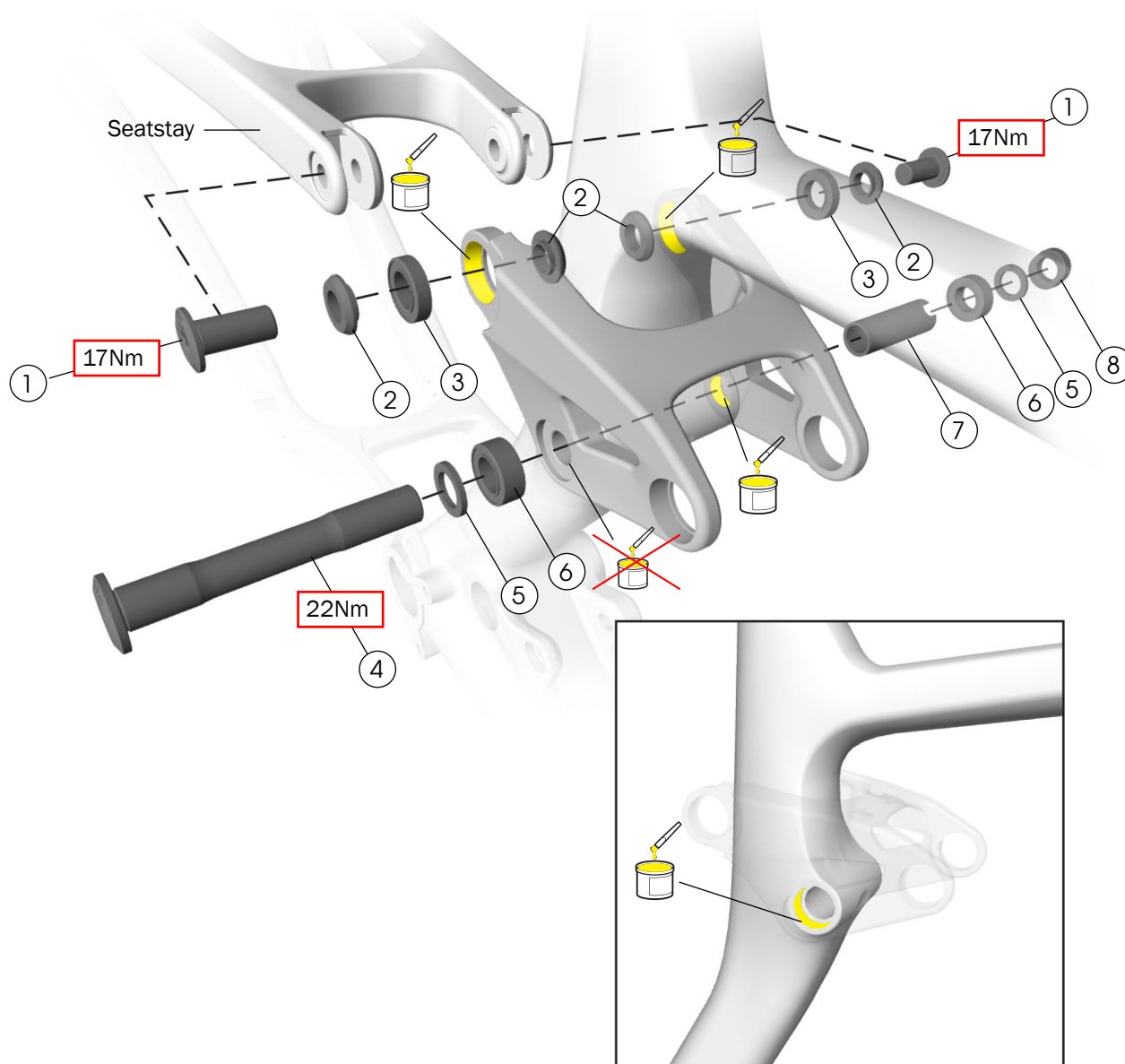

- ① Bolt – W600629
- ② Hat-style washer (2mm hat height) – W5257190
- ③ Bearing – W5257592
- ④ Rocker axle – W600627
- ⑤ Spacer – W290057
- ⑥ Bearing – W5256341
- ⑦ Seat tube pivot sleeve – W310155
- ⑧ Nut – W311582

Tools

- Bearing press
- 5mm and 6mm hex wrenches
- Torque wrench with 5mm and 6mm hex bits

Apply grease to the :

- Seat tube bearing bore
- Rocker pivot seat stay bearing bores
- Rocker pivot non-driveside seat tube pivot
- Do not apply grease to rocker pivot drive side seat tube pivot.

Seat tube pivot

Important: Press in driveside bearing first.

Main pivot

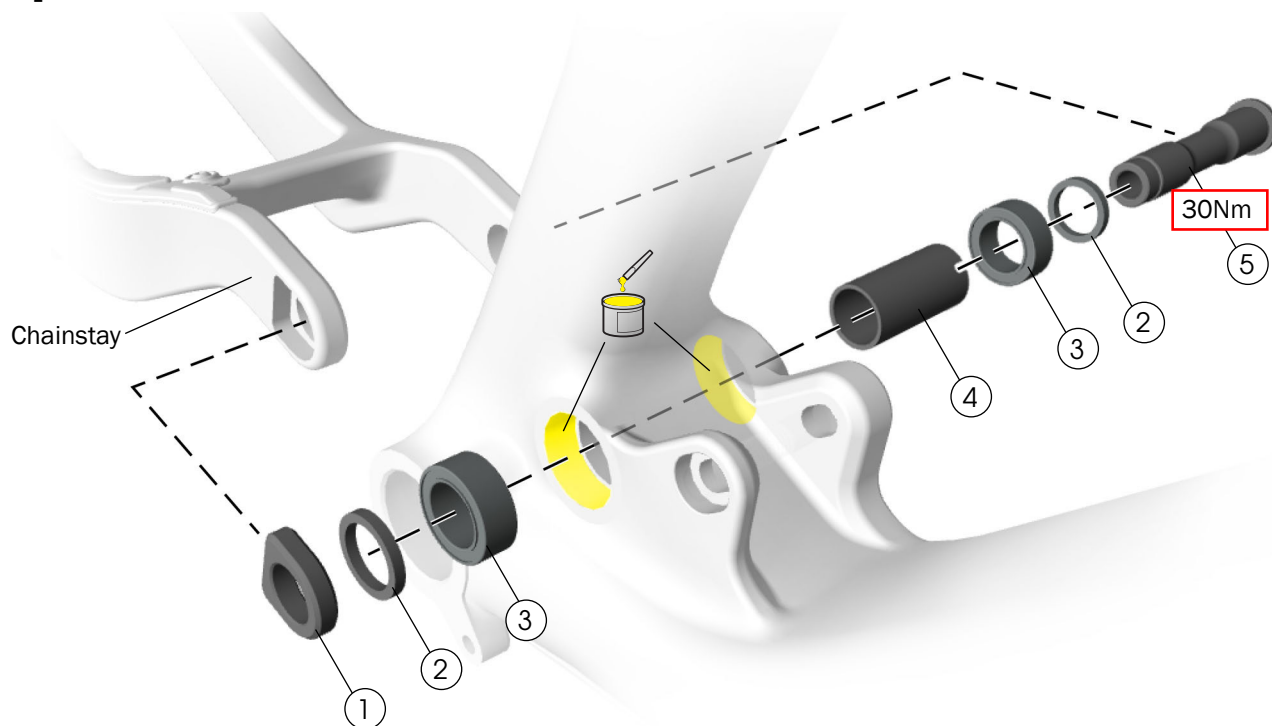

- ① Nut — W584134
- ② Spacer — W440921
- ③ Bearing — W5256338
- ④ Main pivot sleeve — W500592
- ⑤ Main pivot axle — W601376

Tools

- Bearing press
- 8mm hex tool
- Torque wrench with 8mm hex bit
- Grease

Apply grease to:

- The bearing bores as shown above.

Important: Press in the driveside bearing first.

Shock mounts

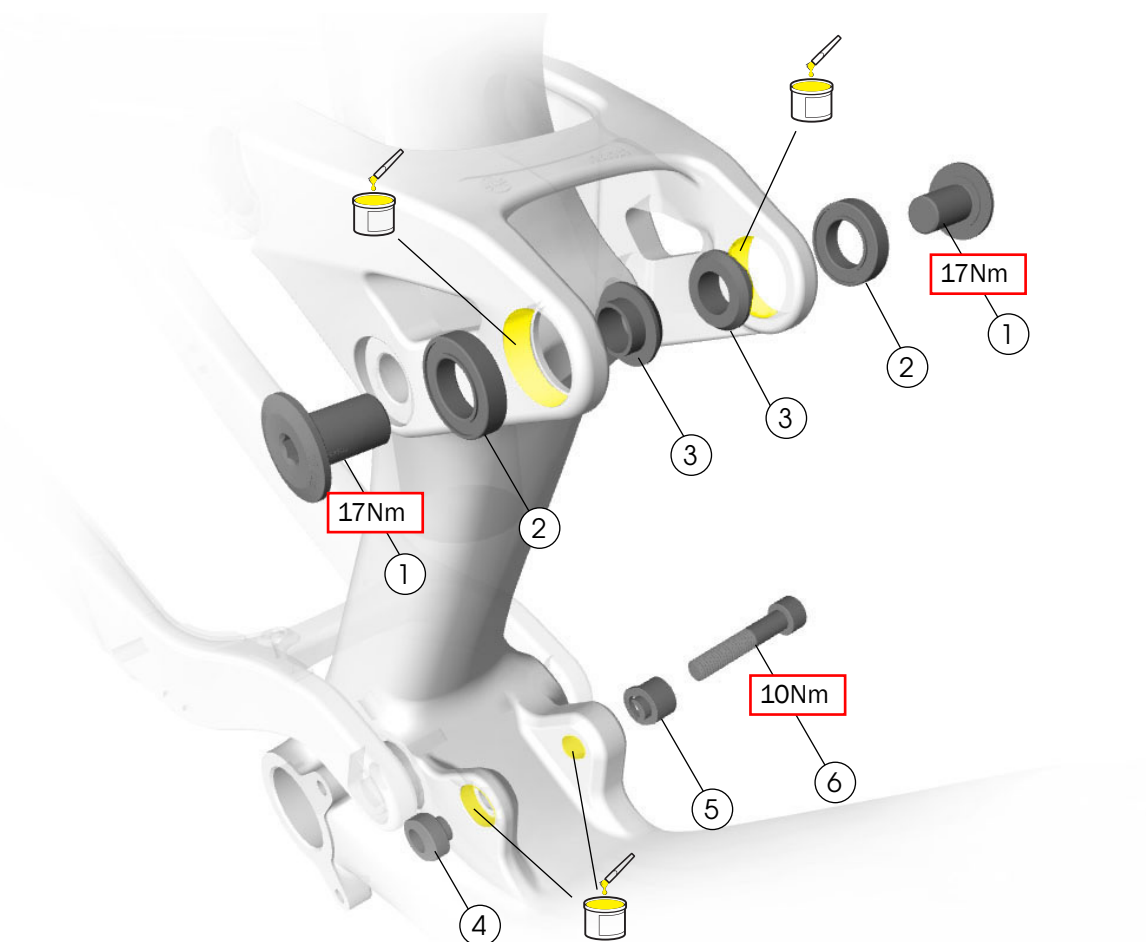

- ① Bolt – W5257188
 - ② Bearing – W5257592
 - ③ Hat-style washer (4mm hat height) – W5257189
 - ④ Lower shock Mino nut
 - ⑤ Lower shock Mino spacer
 - ⑥ Socket head cap screw – W5251046
-] – 5280295

Tools

- Bearing press
- 5mm and 6mm hex wrenches
- Torque wrench with 5mm and 6mm bits

Apply grease to:

- The bores as shown above.

Adjust the geometry

Flip the lower shock mount Mino nut and spacer to change the bike's geometry to fit your riding style or the terrain.

Steeper head tube angle

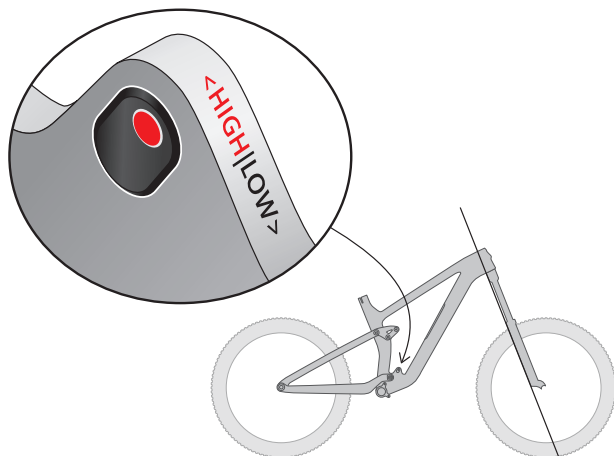

Mino nut and spacer in the high position

- Pulls in the front fork for quicker steering
- Raises the bottom bracket for improved climbing

Slacker head tube angle

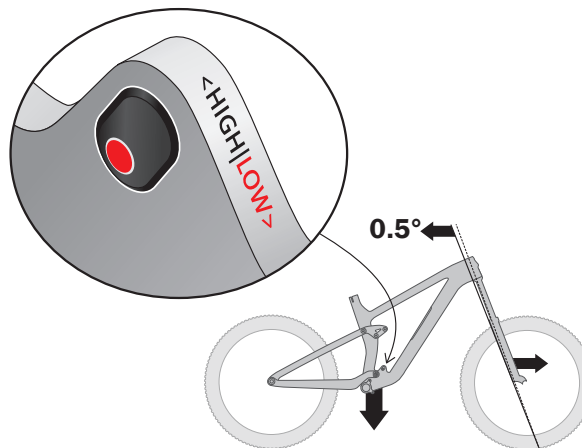

Mino nut and spacer in the low position

- Pushes the head tube angle back 0.5° and pushes out the front fork for slower steering that is more stable at high speed
- Lowers the bottom bracket up to 9mm for more stability

Tools

- 6mm hex tool
- Torque wrench with 6mm hex bit

1. Remove the lower shock bolt. For the location, see the [Shock mounts on page 7](#).
2. Flip the lower shock Mino nut and spacer to the desired position.
3. Re-install the lower shock bolt and torque to 10Nm.

Cable routing

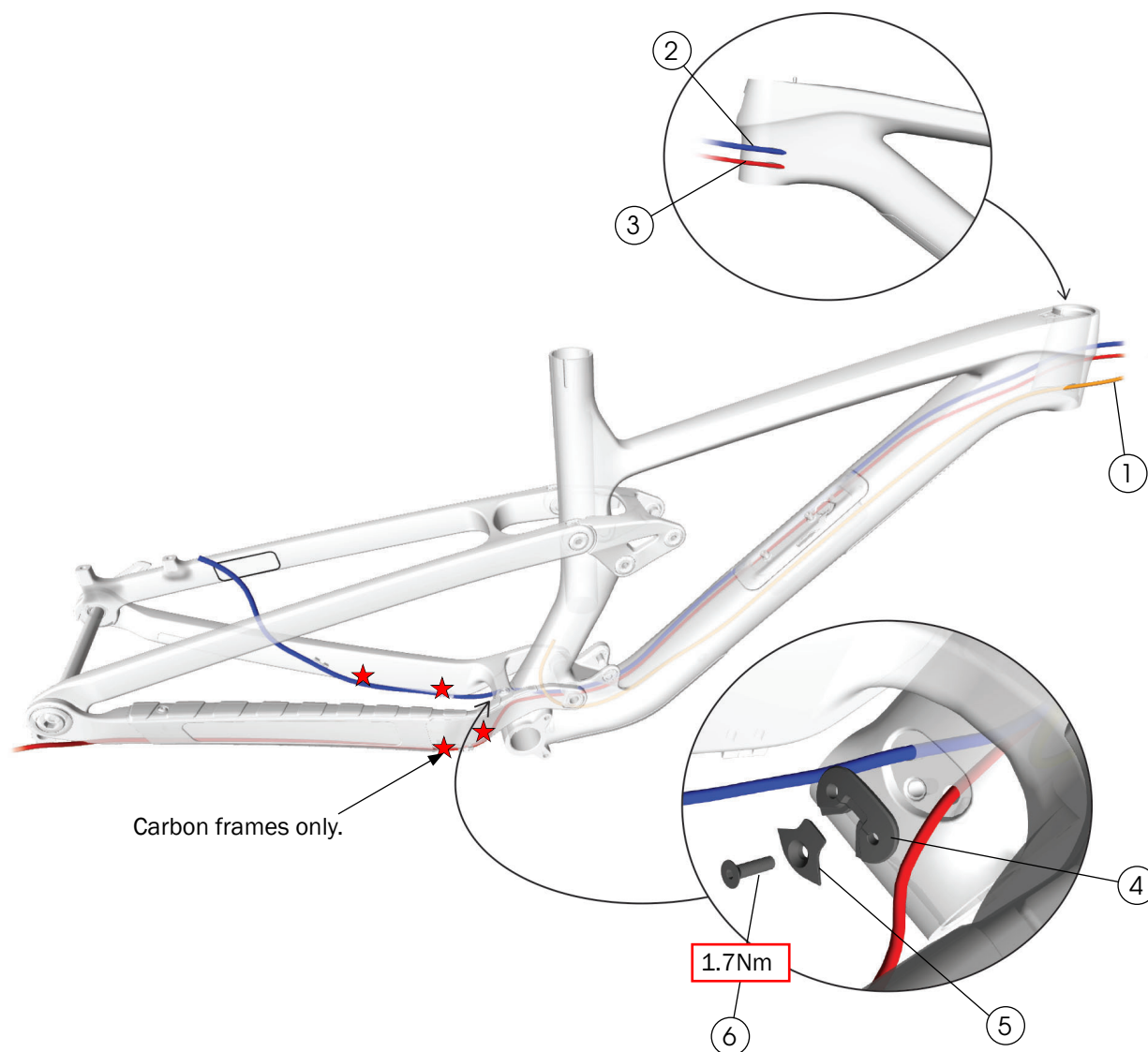

- ① Dropper cable
- ② Rear brake cable
- ③ Derailleur cable
- ④ Rubber housing guide
- ⑤ Exit guide
- ⑥ Bolt — W532763
- ★ Zip tie

— 5275988

Route cables

Notes

- All models feature cable routing tunnels.
- Route cables first, then install seat tube cable exit guide components (4, 5 and 6).

Route cables:

- Rear brake: back to front
- Derailleur: back to front
- Dropper: head tube to seatpost

Aluminum frame derailleur and brake routing

To improve access to the cable entry holes located behind the chainstay bridge:

1. Remove the upper shock mount bolt.
2. Rotate the rear triangle up.

Frame guards — carbon frame

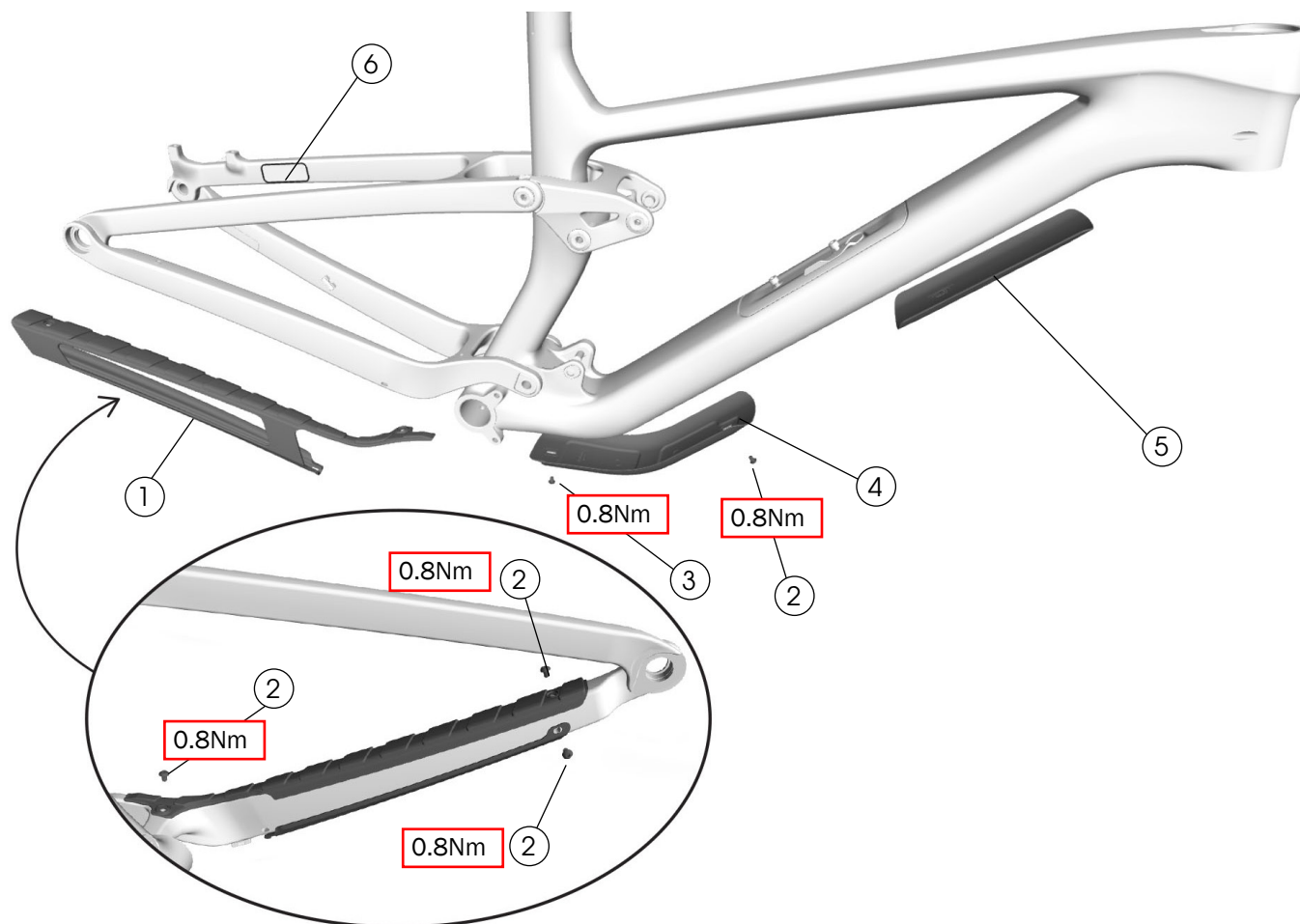

- ① Chainstay guard — W5257206
- ② Button head screw — 1042535
- ③ Button head screw — 327526
- ④ Downtube guard — 5280104
- ⑤ Shuttle guard — W5257546
- ⑥ Frame protection decal — W326986

Shuttle guard

Use isopropyl alcohol to clean the frame surface where the guard (4) attaches. Wait for the alcohol to dry before applying the guard.

Notice: Do not clean the entire frame with isopropyl alcohol. Isopropyl alcohol could damage the paint.

Frame guards — aluminum frame

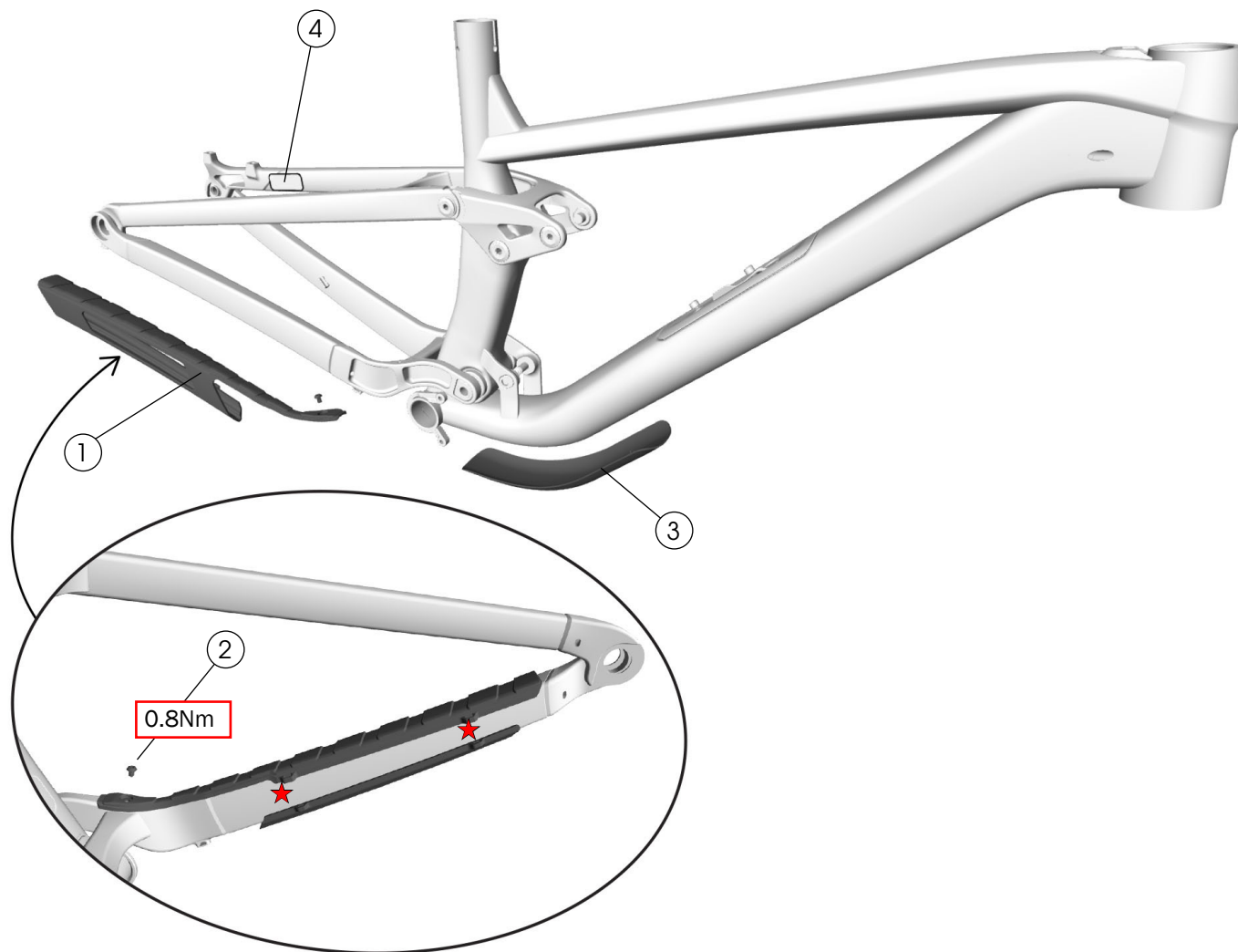

- ① Chainstay guard — W5259518
- ② Button head screw for chainstay guard — 1042535
- ③ Downtube guard — W5258504
- ④ Frame protection decal — W326986
- ★ Zip tie

Downtube guard

Use isopropyl alcohol to clean the frame surface where the guard (3) attaches. Wait for the alcohol to dry before applying the guard.

Notice: Do not clean the entire frame with isopropyl alcohol. Isopropyl alcohol could damage the paint.

Down tube storage

Carbon frame

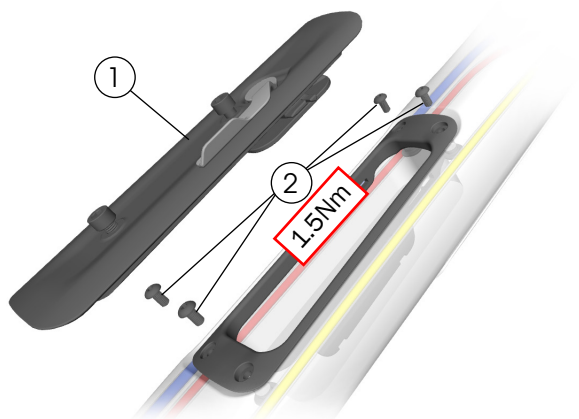

- ① Storage door
 - ② Button head screws – 547053
(includes nuts, not used on carbon frames)
- W583862

Aluminum frame

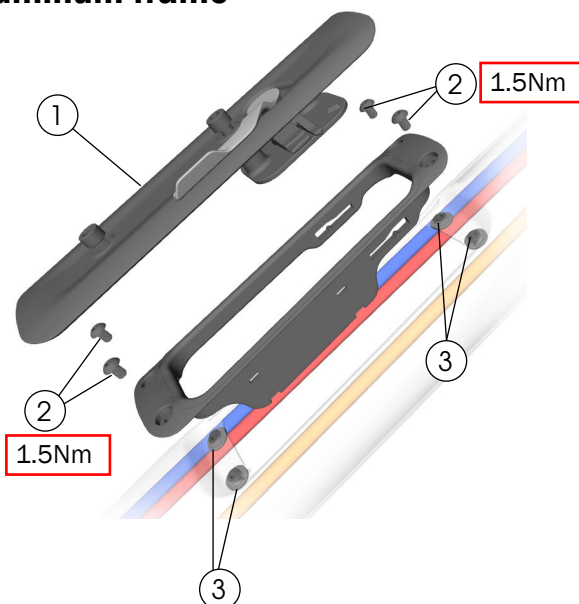

- ① Storage door
 - ② Button head screw
 - ③ Nut
- 1042535
- W583862

Specifications

Chainline (1x only)

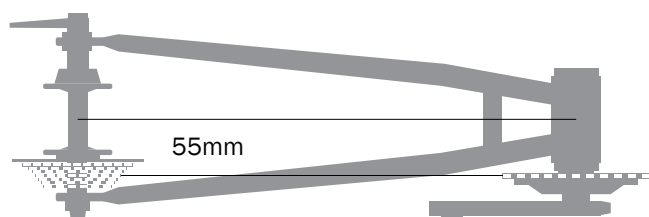

Chainring (1x only)

Minimum	Maximum
28T	36T round
	34T oval

Rear brake mount



Minimum	Maximum
160mm, direct mount	Adaptable to 180mm

Maximum tire size

Notice: Measurements of actual tires may vary. Always verify there is sufficient clearance between the tire and the frame. Improper tire size could damage the bicycle frame. Trek recommends 6mm clearance above and on the sides of the tire.

Wheel set	Maximum tire size
29"	29" x 2.5"
27.5" (Extra small frame only)	27" x 2.5"

Seat post



WARNING

Always follow the seatpost manufacturer's minimum insertion recommendation. Failure to follow the recommendation could cause damage to the seatpost and result in injury to the rider.

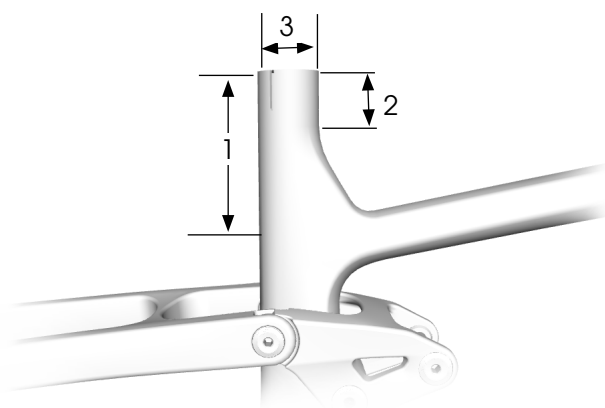

Item	Measurement	Frame	Carbon	Aluminum
1	Maximum insertion	XS	205mm	—
		S	245mm	
		M	270mm	
		M/L	285mm	
		L	300mm	
		XL	320mm	350mm
		XXL	—	390mm
2	Minimum insertion	75mm*		
3	Seat tube inside diameter	34.9mm		
	Seat tube post clamp outer diameter	39.5mm		

*Follow the seatpost manufacturer's guidelines.

Bottom bracket /ISCG tabs

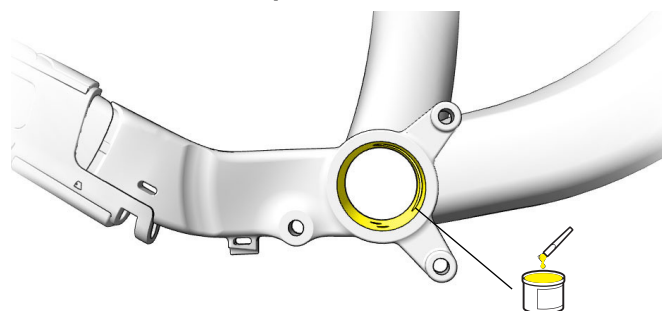

Bottom bracket	ISCG tabs
BSA73	ISCG 05

Suspension

The first step in suspension setup is to determine the sag. All other settings should be adjusted after determining the sag.

Refer to the suspension setup card included with your bike or the suspension calculator at

[Trek bikes.com/suspension-calculator](https://trekbikes.com/suspension-calculator).

For recommended rebound settings refer to the suspension calculator at [Trek bikes.com/suspension-calculator](https://trekbikes.com/suspension-calculator).

Fork



WARNING

Exceeding the recommended maximum fork length could damage the bicycle and result in injury to the rider.

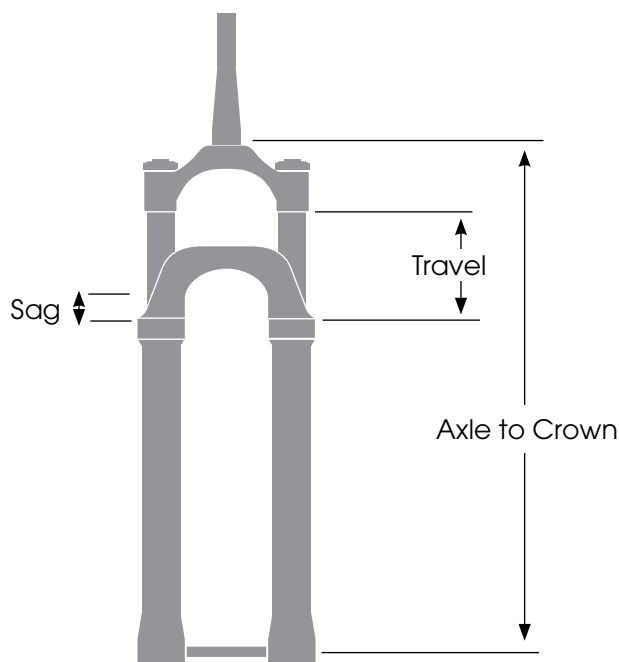

Frame/ Wheel Size	Axle to Race (mm)		Travel (mm)	Sag (15%) (mm)
XS 27.5" wheels	Recommended	512	120	18
	Maximum	522	130	19.5
S, M, ML, L, XL, XXL 29" wheels	Recommended	531	120	18
	Maximum	541	130	19.5

Shock

Mount	Width
Upper mount	54mm x 10mm Trunnion
Lower mount	30mm x 8mm

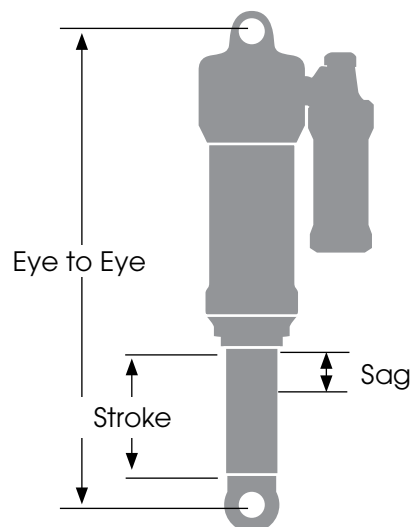

Description	Dimension
Eye-to-eye	185mm
Stroke	50mm
Recommended sag	28% (14mm)