

TREK



2024 SUPERCALIBER SL AND SLR

SERVICE MANUAL

Contents



[Safety](#)



[Rear axle with UDH](#)



[Rear axle with SRAM
Transmission
Deraillieur](#)

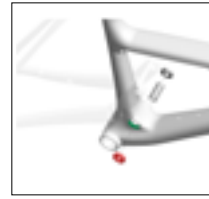

[Main pivot](#)



[Swingarm](#)



[SLR routing with
AXS shifting](#)



[SLR routing with
mechanical shifting](#)



[SL routing with
AXS shifting](#)

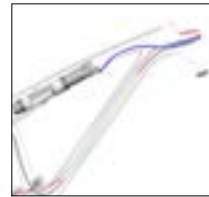

[SL routing with
mechanical shifting](#)



[Frame guards](#)



[IsoStrut](#)

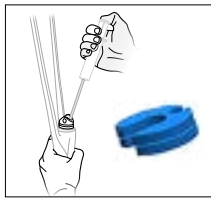

[IsoStrut maintenance](#)

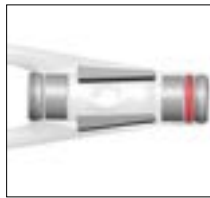

[Bushings, carriage
wiper seals, and foam
blocks](#)

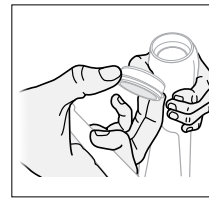

[Replace bushings and
carriage wiper seals](#)

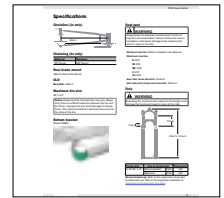

[Specifications](#)

Safety

WARNING

Properly tighten hardware

Always tighten hardware to the specified torque. Over-tightening hardware could deform or break the hardware or components. Under-tightening hardware could cause hardware or components to become loose. Either situation could damage the bicycle and result in injury to the rider.

WARNING

Reapply threadlocker

All reused-fasteners with pre-applied threadlocker must be cleaned with isopropyl alcohol and have new threadlocker applied before re-assembly. If threadlocker is not applied, the fasteners may loosen which could damage the bicycle and result in injury to the rider.

Legend



 Apply grease



Do not apply grease



 Apply threadlocker

Nm

Torque



Zip tie

Scope

This manual contains parts diagrams, specifications (such as grease and torque values), instructions, and helpful tips. It does not contain instructions for all components (such as brake calipers). Refer to the original manufacturer for more information.

Additional resources

- Trek's YouTube channel: youtube.com/trek bikes
- Trek Owner's Manual: trekbikes.com/manuals
- RockShox SIDLUXE IsoSrut Service Manual found on SRAM's dealer portal.

Rear axle with UDH

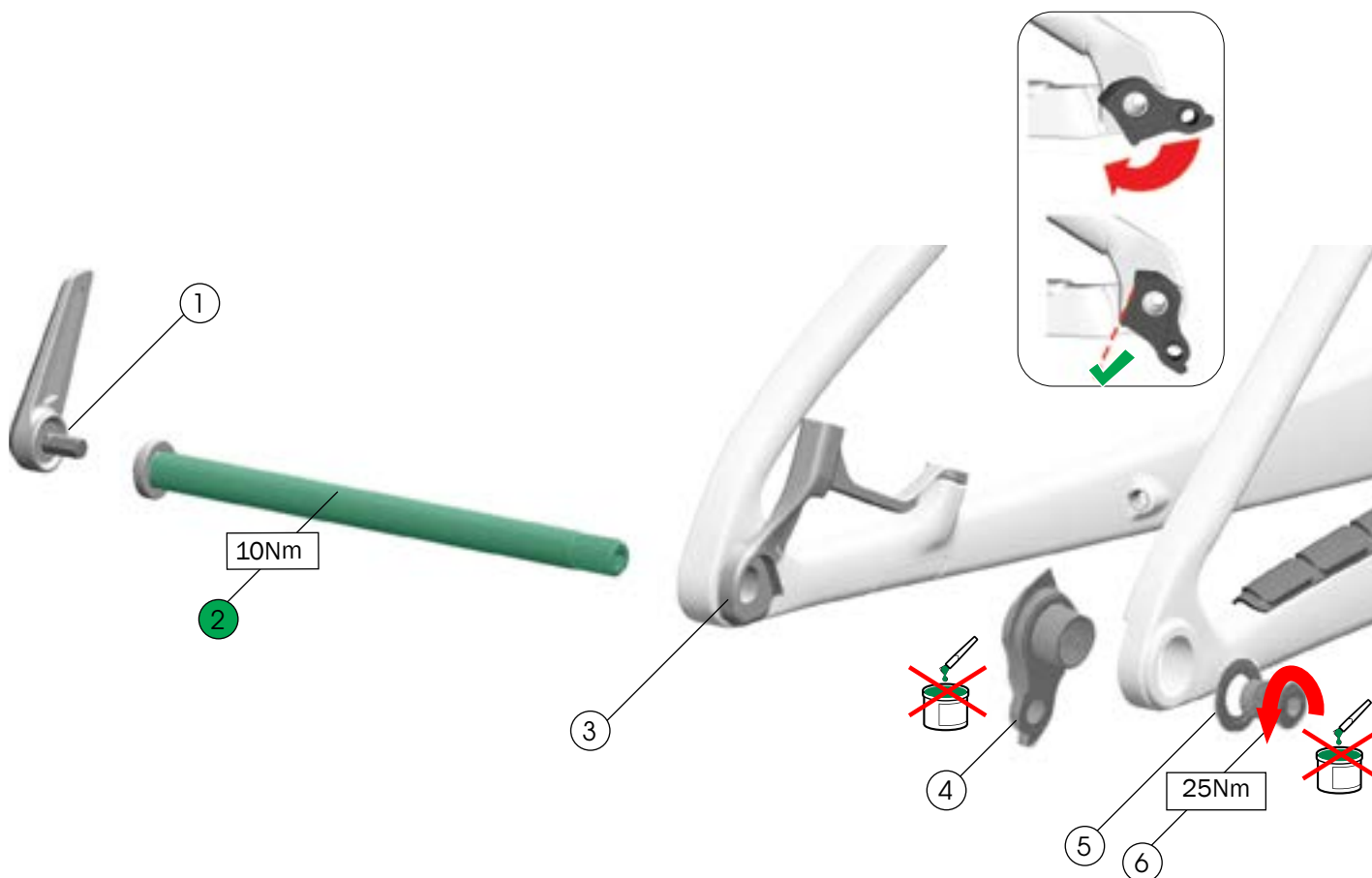

① Switch lever — [W573860](#)

② Thru axle, 12x180 — [W5290786](#)

③ Dropout brake mount — [W5307257](#)

④ Derailleur hanger, UDH
Notice: Do not apply grease.

⑤ Washer, 25mm
Notice: The washer is frame-specific. Install only the washer size specified.

⑥ Bolt
Notice: Do not apply grease. Left-hand thread. Do not over-tighten.
Over-tightening could cause the hangar to break

— [W5271424](#)

For additional information about the UDH, refer to the SRAM user manual at sram.com.

Rear axle with SRAM Transmission Derailleur

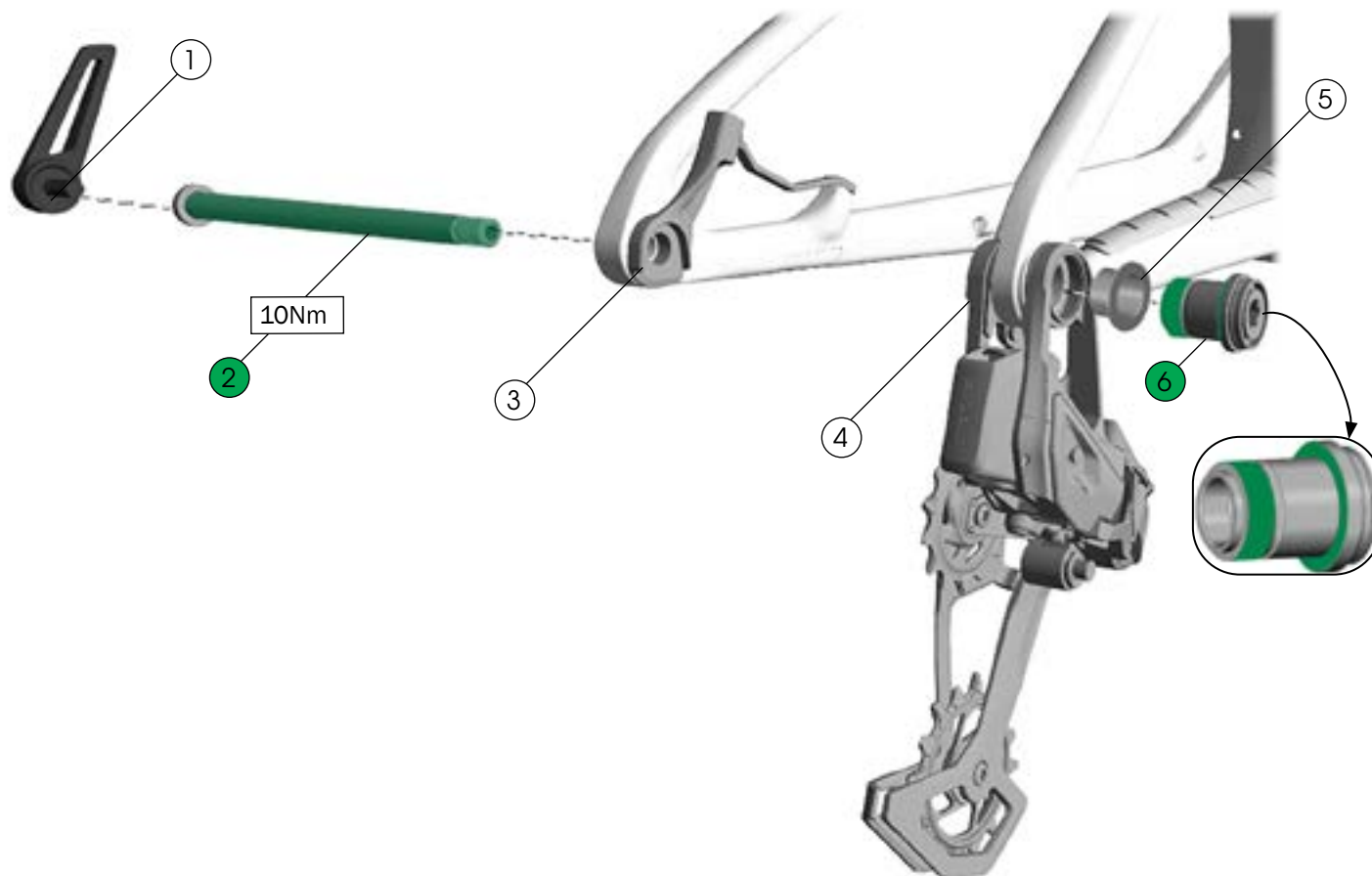

- ① Switch lever — [W573860](#)
- ② Thru axle, 12x180 — [W5290786](#)
- ③ Dropout brake mount — [W5307257](#)
- ④ SRAM Transmission Derailleur
- ⑤ Bushing
- ⑥ Mounting bolt

— Refer to information on sram.com.

For additional information about the Transmission derailleur, refer to the SRAM user manual at sram.com.

Main pivot

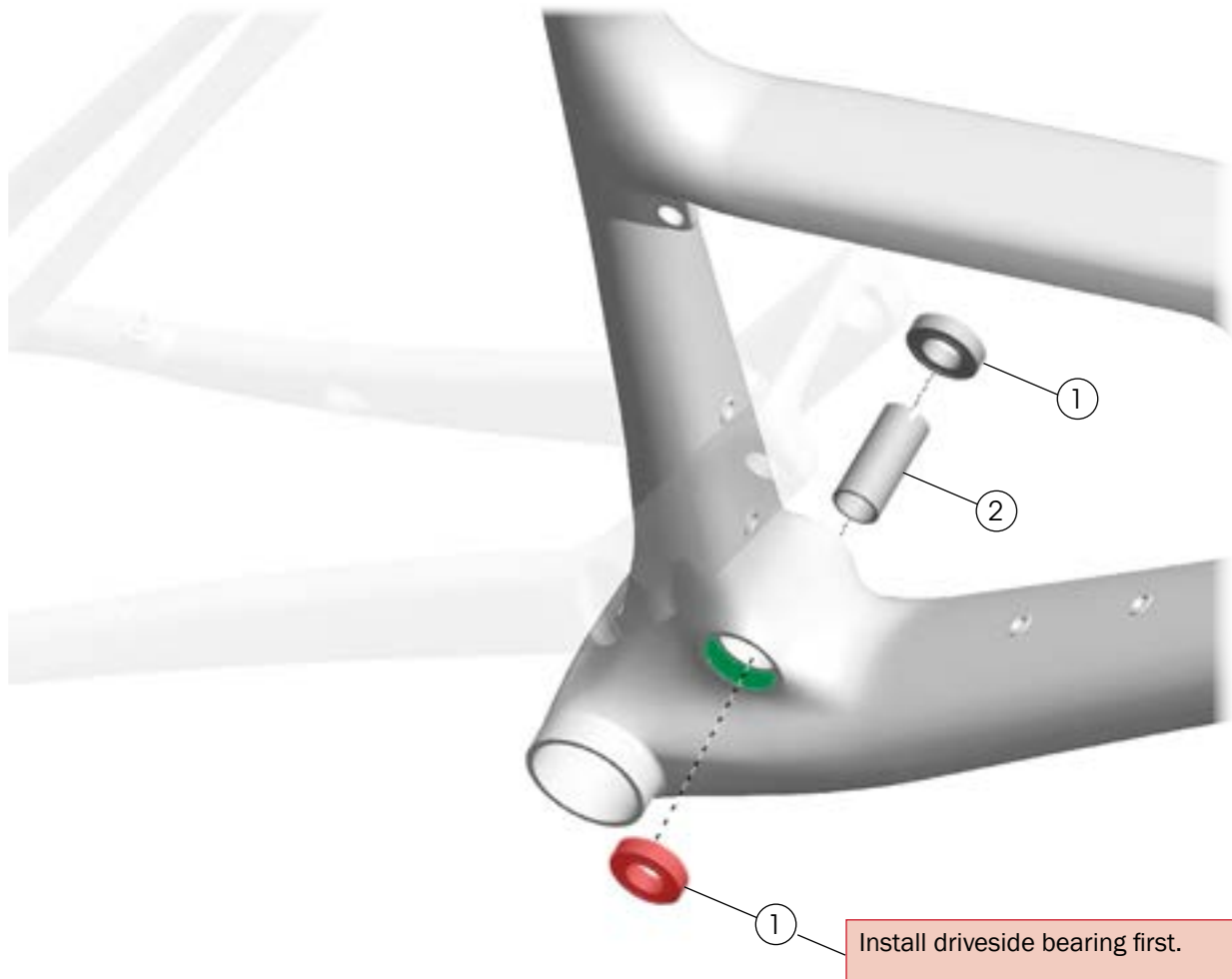

① Bearings, 28x15x7 — [W5290782](#)

② Main pivot sleeve — [W5290783](#)

Swingarm

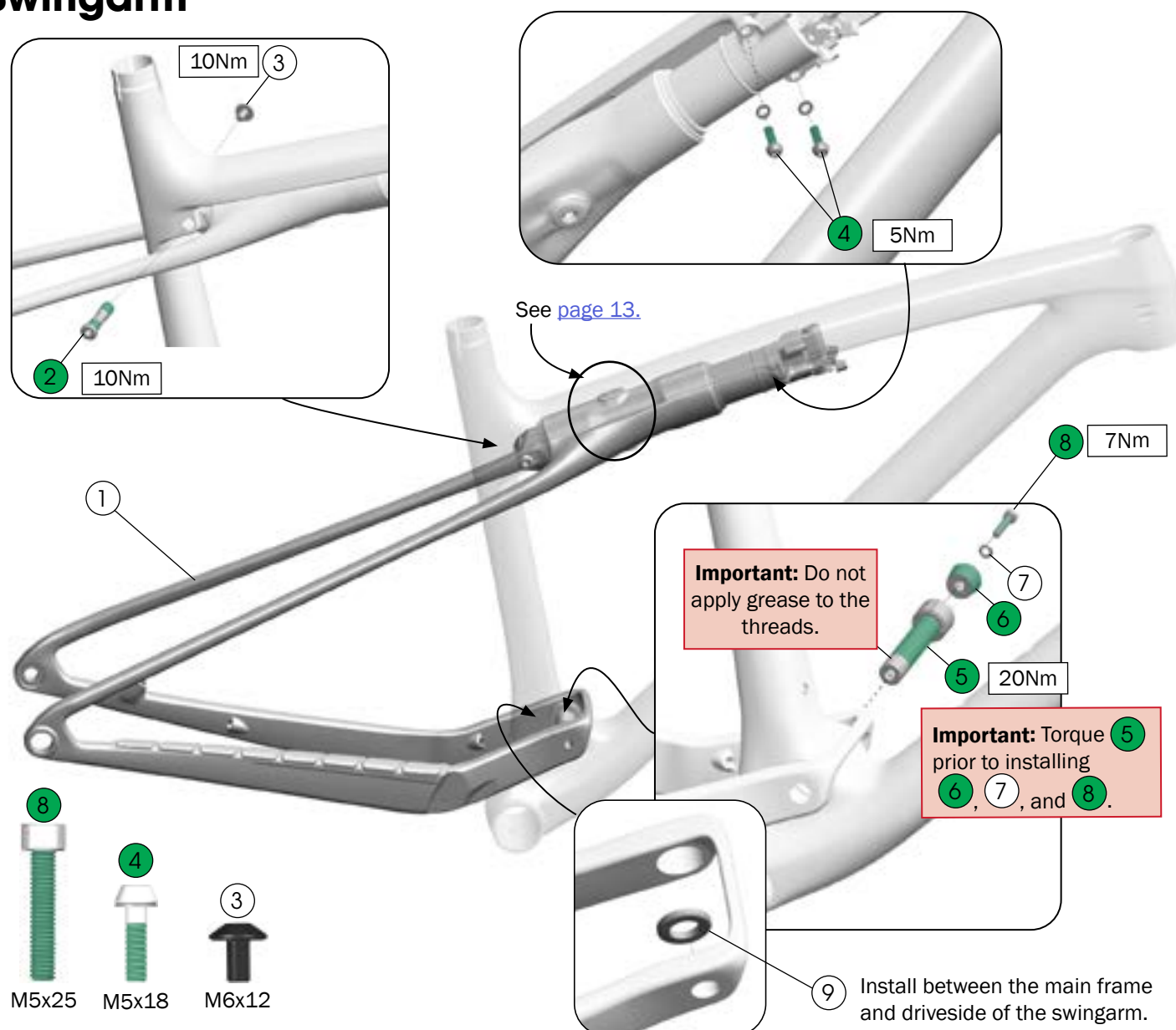

- ① Swingarm SM — [45582](#)
M-XL — [45583](#)
- ② IsoStrut axle bolt, M6x10mm — [W5290780](#)
- ③ Endcap fastener, M6x1mm — [W582252](#)
- ④ Fasteners, M5x18mm, with washers, — [W584485](#)
- ⑤ Main pivot bolt, M15x71mm — [W5306810](#)
- ⑥ Wedge spacer — [W5306811](#)
- ⑦ Washer, 5.3mm x 1mm — [W5309244](#)
- ⑧ Fastener, M5x25mm — [W5306809](#)
- ⑨ Spacer, 15x26x4 — [W5307573](#)

— IsoStrut mounting fasteners

SLR routing with AXS shifting

Note: The fork must be removed to route the brake hose and IsoStrut lockout cable housing.

Important: Route the cables as shown below.

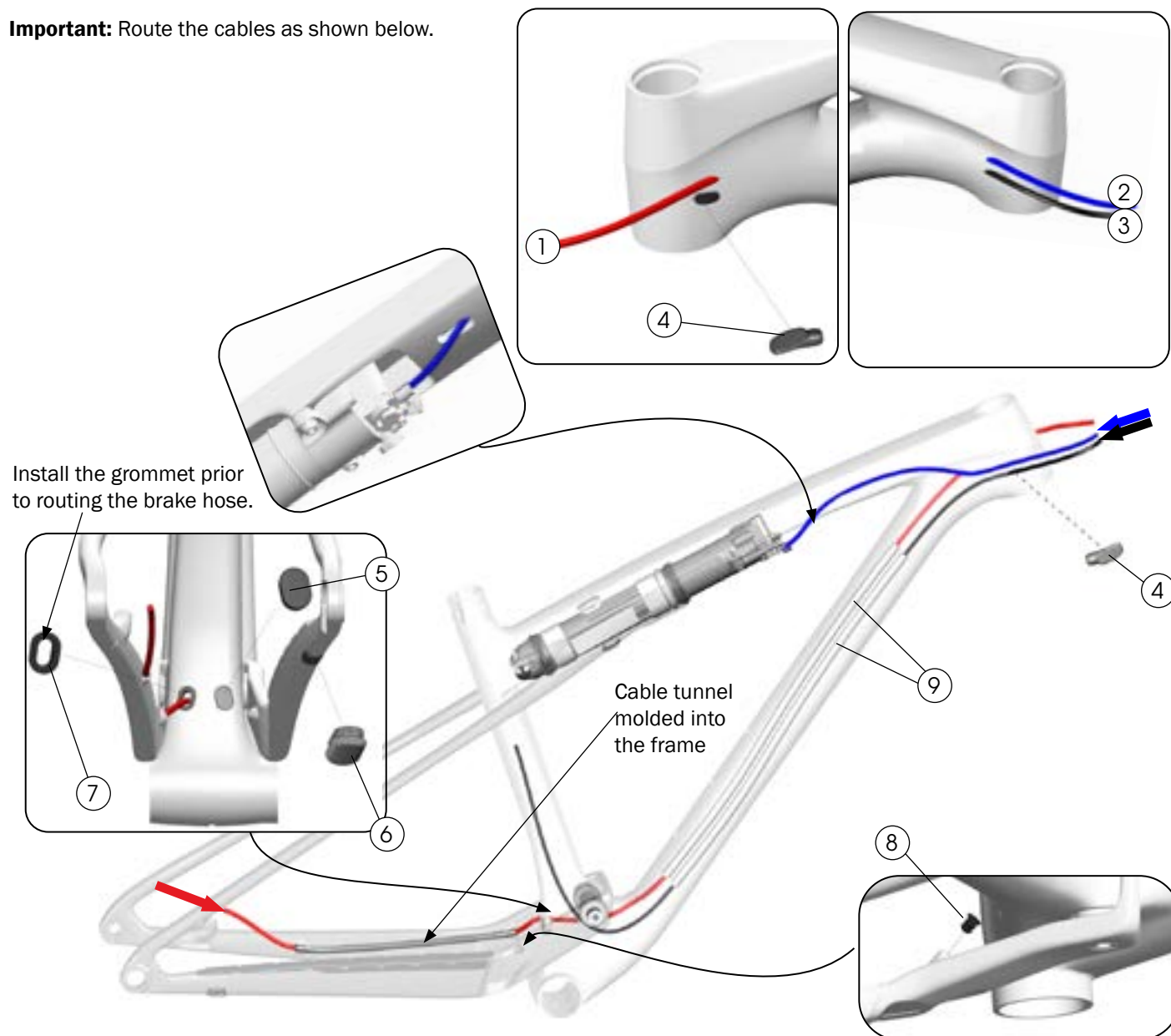

- ① Rear brake hose
- ② IsoStrut lockout cable housing
- ③ Dropper seatpost cable housing
- ④ Cable housing plugs — [W600649](#)
- ⑤ Cable exit plug — [W5256254](#)
- ⑥ Chainstay plug — [W5259425](#)
- ⑦ Cable exit grommet — [W5255861](#)
- ⑧ Chainstay plug — [W600209](#)
- ⑨ Foam housing sleeves — [W528082](#)

SLR routing with mechanical shifting

Note: The fork must be removed to route the brake hose and IsoStrut lockout cable housing through the head tube.

Important: Route the cables as shown below.

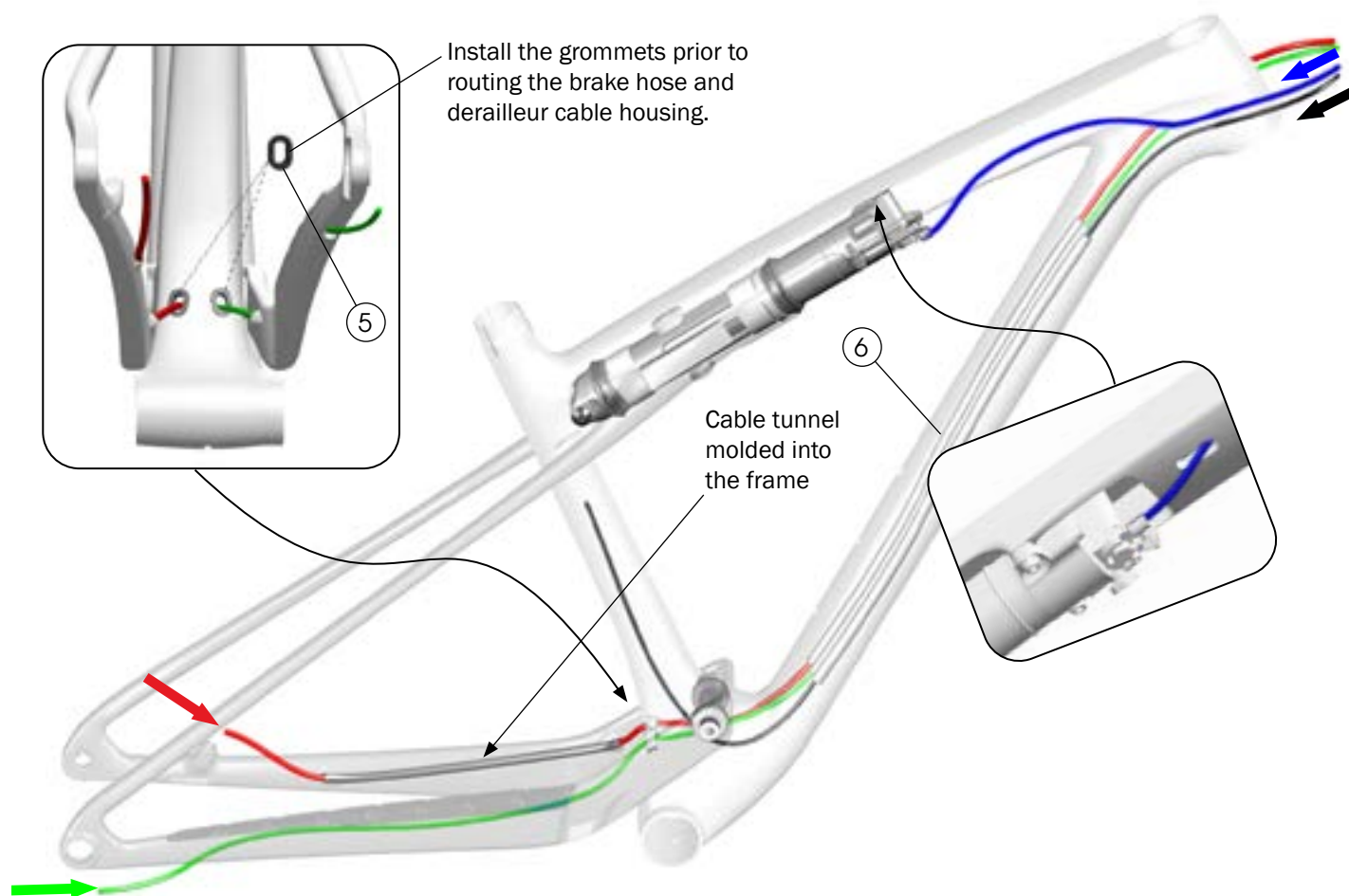
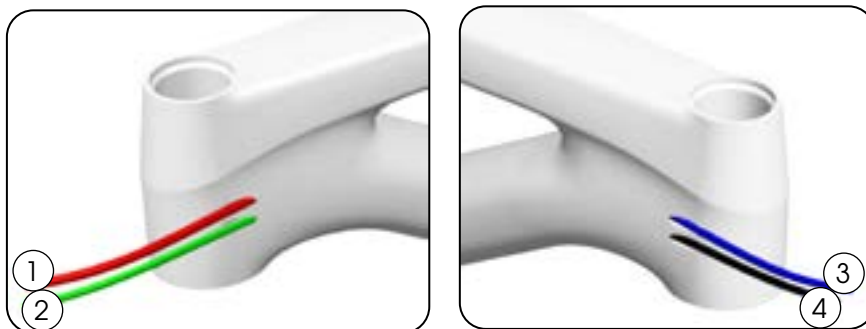

- ① Rear brake hose
- ② Rear derailleur cable housing
- ③ IsoStrut lockout cable housing
- ④ Dropper seatpost cable housing
- ⑤ Cable exit grommets — [W5255861](#)
- ⑥ Foam housing sleeves — [W528082](#)

SL routing with AXS shifting

Important: Route the cables as shown below.

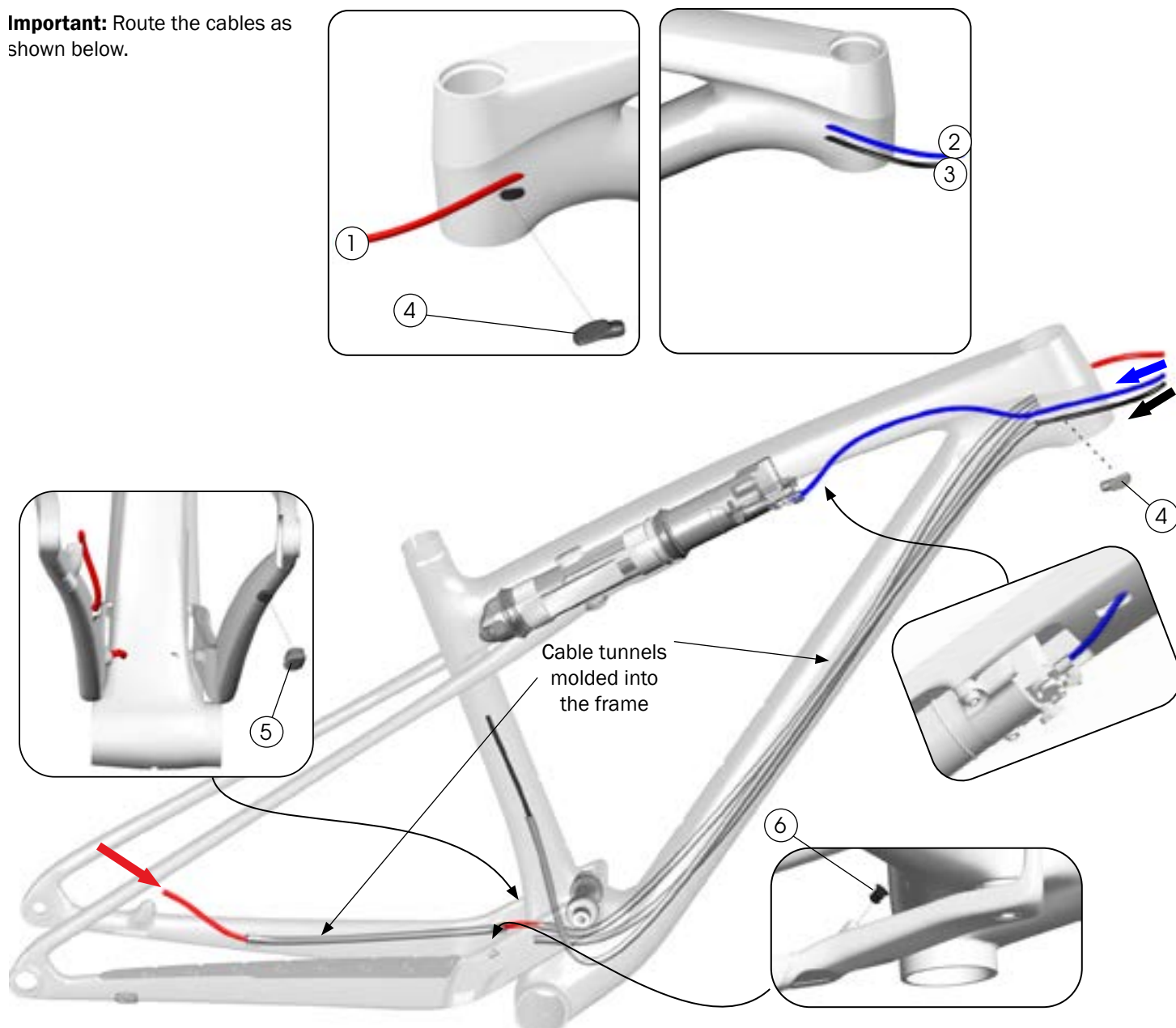

- ① Rear brake hose
- ② IsoStrut lockout cable housing
- ③ Dropper seatpost cable housing
- ④ Cable housing plugs — [W600649](#)
- ⑤ Chainstay plug — [W5259425](#)
- ⑥ Chainstay plug — [W600209](#)

SL routing with mechanical shifting

Important: Route the cables as shown below.

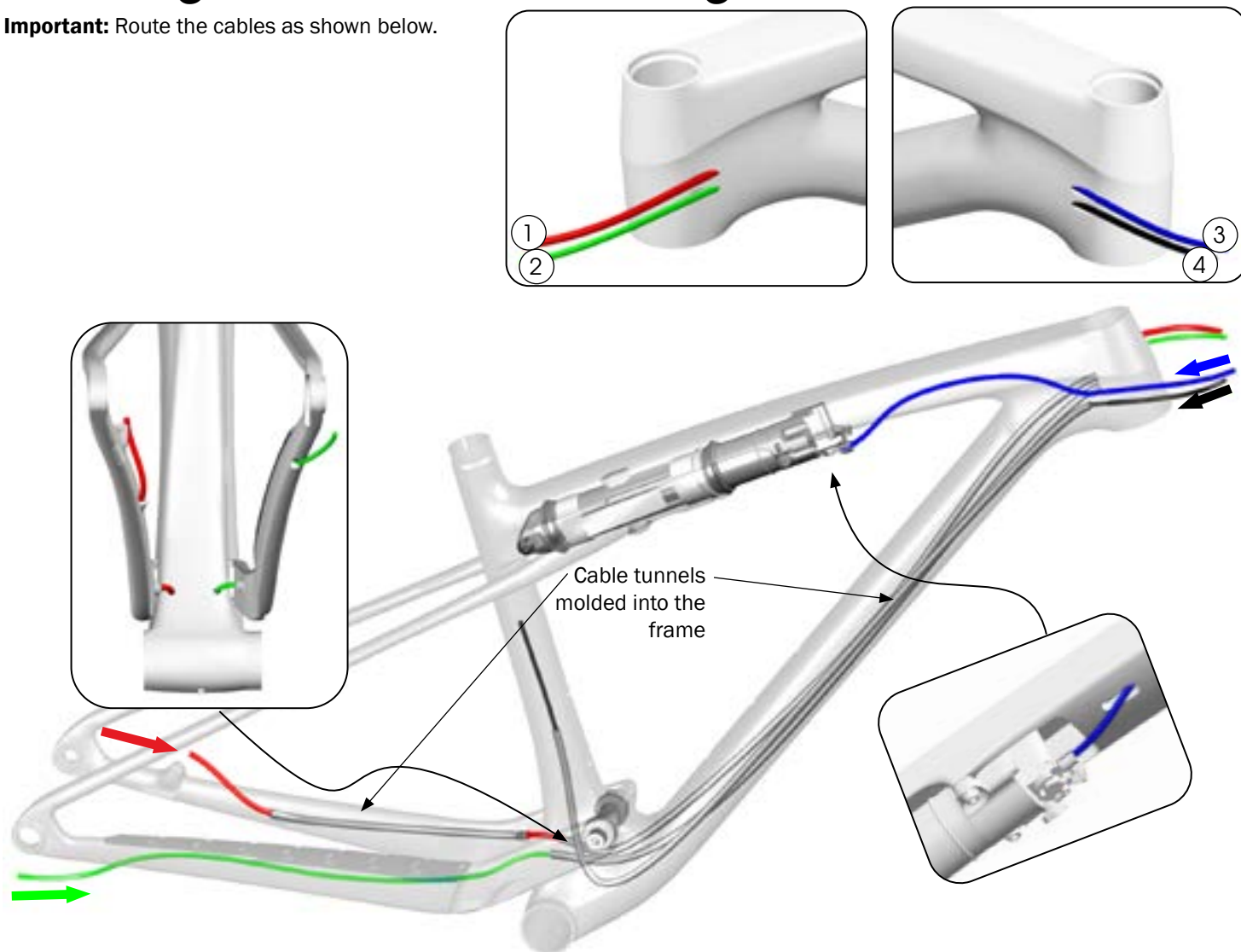

- ① Rear brake hose
- ② Rear derailleur cable housing
- ③ IsoStrut lockout cable housing
- ④ Dropper seatpost cable housing

Frame guards

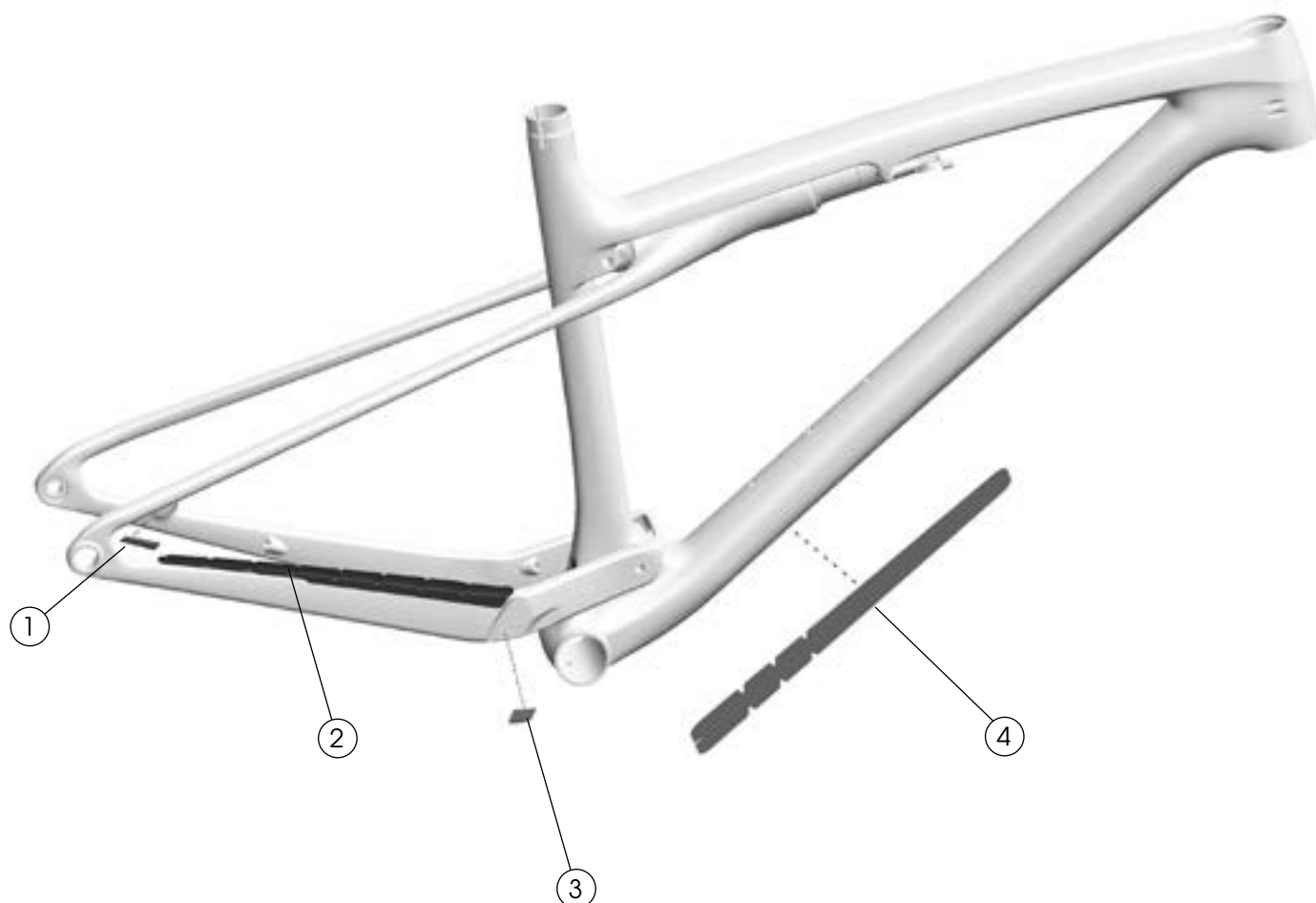

- ① Rotor strike guard, bonded — [W5307943](#)
- ② Chainstay guard, adhesive — [W5307370](#)
- ③ Chainring strike guard, bonded — [W5307942](#)
- ④ Downtube protector, clear adhesive — [W5312789](#)

Adhesive guards ② ④

Use isopropyl alcohol to clean the frame surface where the guards attach. Wait for the alcohol to dry before applying the guards.

NOTICE: Do not clean the entire frame with isopropyl alcohol. Isopropyl alcohol could damage the paint.

Bonded strike guards ① ③

1. To improve adhesion, use sandpaper to roughen the backside of the guards and/or remove remnants of the old guard from the areas of the frame where epoxy will be applied.
2. Attach the guards with a two-part epoxy.
3. Allow the guards and epoxy to cure for 24 hours.

IsoStrut

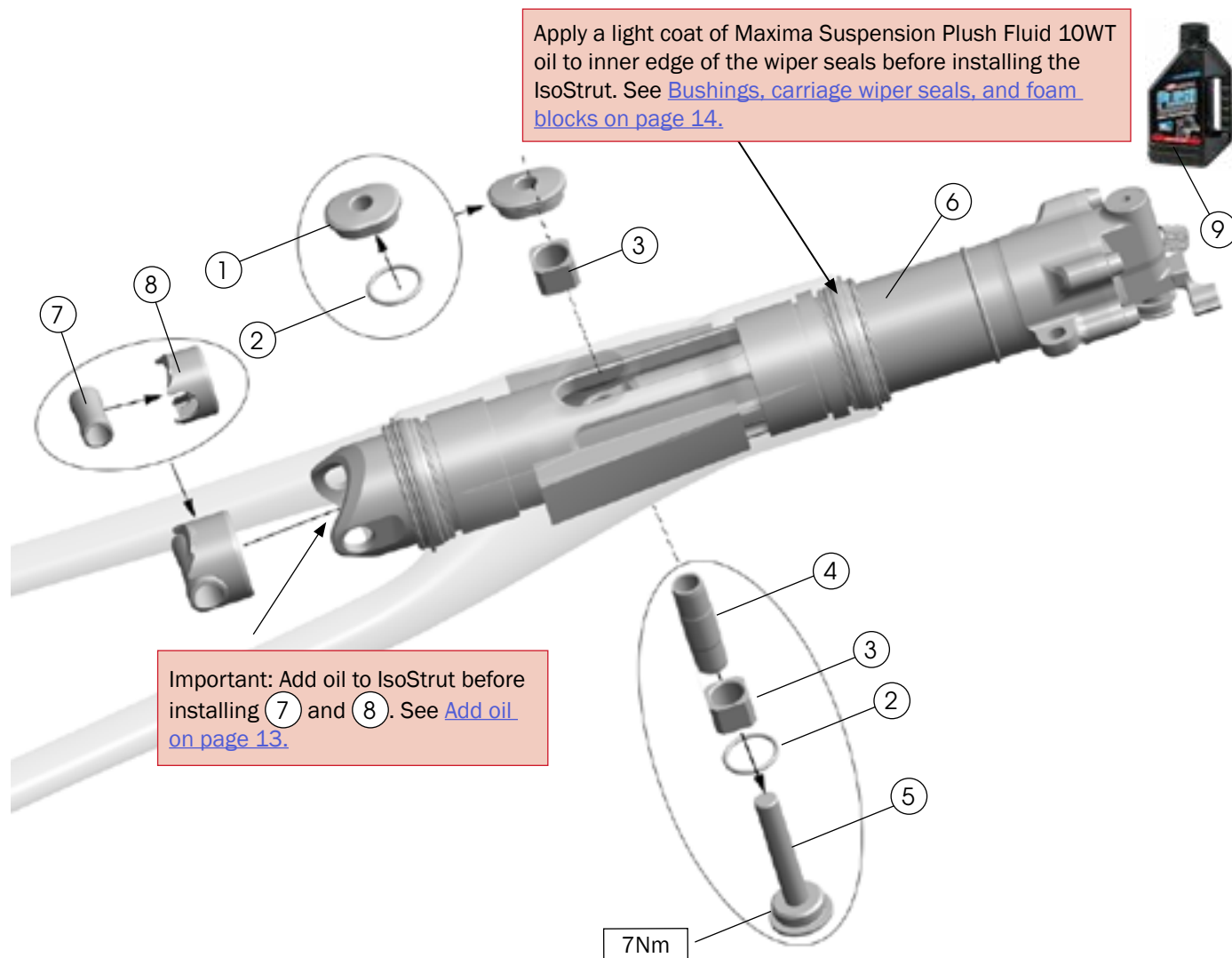

- (1) Damper body nut — [W601176](#)
 - (2) O-ring — [W601177](#)
 - (3) Guide bushings — [591628](#)
 - (4) Damper body sleeve — [W5290778](#)
 - (5) Damper body bolt — [W5306808](#)
- Damper body components
- (6) SIDLuxe IsoStrut by ROCKSHOX — [W5308335](#)
 - (7) Spacer — [W5291120](#)
 - (8) Oil plug — [W5292128](#)
 - (9) Maxima Suspension Plush Fluid 10WT oil — [600297](#)

IsoStrut maintenance

For detailed service instructions, refer to the RockShox SIDLux IsoStrut service manual found on SRAM's dealer portal.

Remove the IsoStrut

1. Remove the IsoStrut mounting fasteners. See [on page 6](#).
1. Remove the damper components. See [IsoStrut on page 12](#).
2. Slide the IsoStrut from the carriage.

Add oil

1. Remove the spacer and oil plug. See [IsoStrut on page 12](#).
2. Use a syringe to fill the IsoStrut with 15cc of Maxima Suspension Plush Fluid 10WT — [600297](#).

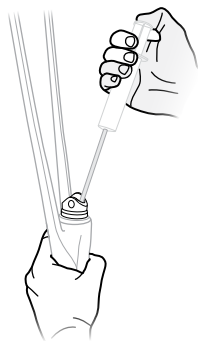

3. Press the oil plug with spacer back into the IsoStrut.
4. Install the IsoStrut mounting fasteners. See [on page 6](#).

Air volume spacers (bottomless tokens)



— [5316700](#)

Two bottomless tokens are included with your Supercaliber. See the RockShox SIDLux IsoStrut service manual found on the SRAM.com dealer portal for installation instructions.

Install the IsoStrut

1. Use Maxima Suspension Plush Fluid 10WT — [600297](#) to lightly oil the inside of the carriage seals.

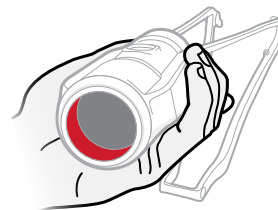

2. With the sag o-ring in place on the IsoStrut, insert the IsoStrut into the carriage.
3. Install the damper components. See [IsoStrut on page 12](#).
4. Install the IsoStrut mounting fasteners. See [on page 6](#).

Bushings, carriage wiper seals, and foam blocks

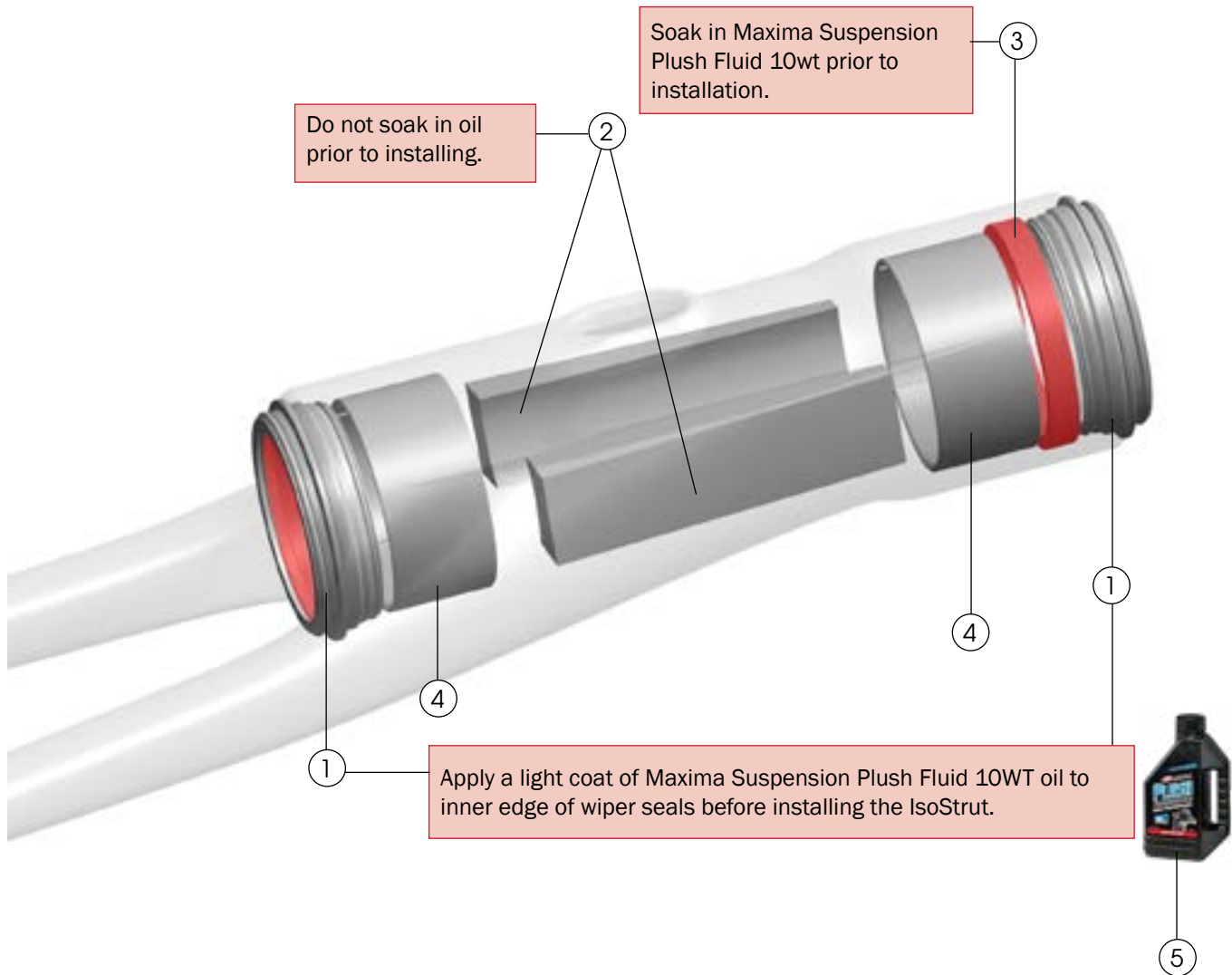

- ① Carriage wiper seals
 - ② Foam blocks
 - ③ Foam ring
 - ④ Bushings — [5316699](#)
 - ⑤ Maxima Suspension Plush Fluid 10WT oil — [600297](#)
- } [5316705](#)

Replace bushings and carriage wiper seals

Tools for replacing the seals

- IsoStrut seal and bushing press tool set — [5317338](#)
- Delrin rod, 1 inch (25.4mm)
- Headset press
- Maxima Suspension Plush Fluid 10wt oil — [600297](#)

Tools for replacing the bushings

- Slide hammer
- 38 Expanding collet
- IsoStrut seal and bushing press tool set — [5317338](#)
- Bushing sizer head — [5318880](#)
- Bushing sizer handle — [5318944](#)
- Clean, dry cloth

NOTICE: Inspect all tools prior to use to make sure they are clean. Dirty tools could deposit grit into the shock which could mar surfaces and create friction that could damage the shock.

Remove the carriage wiper seals

1. Use the Delrin rod to pull out the front seal.

Tip: You may need to move the rod around the carriage to remove the seal.



2. Pull out the foam ring.

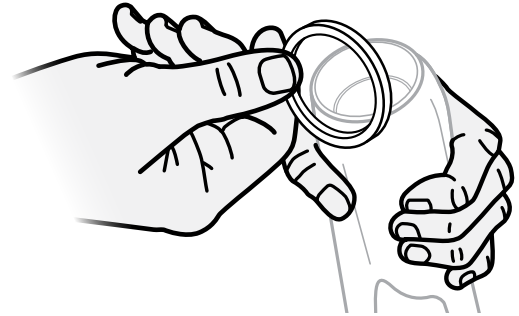

3. Use the Delrin rod to pull out the rear seal.

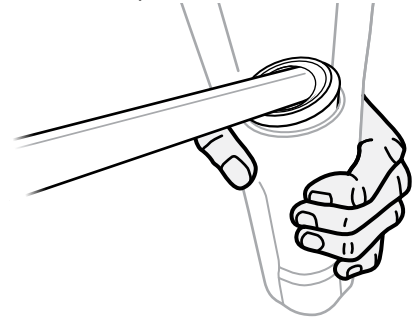

If you are replacing only the seals, see [Replace the wiper seals on page 18](#)

If you are replacing both the seals and the bushings, continue with the [Replace the bushings on page 16](#).

Replace the bushings

Notice: Do not apply grease to the bushings.

1. Put the slide hammer with the collet attached inside the front end of the carriage.

Notice: Take care to engage only the bushing, and NOT the interior of the carriage. Engaging the carriage could damage the carriage.

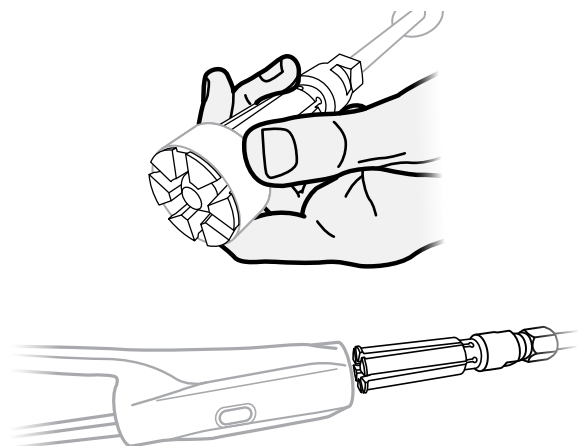

2. Thread the collet to engage the bushing lip.

Tip: Be careful not to engage the lip inside the carriage. Engage the bushing only.

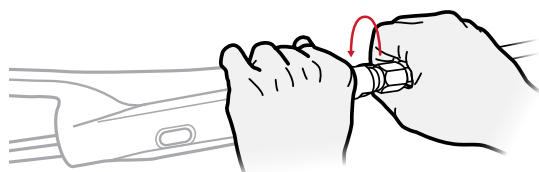

3. Use the slide hammer to remove the bushing.

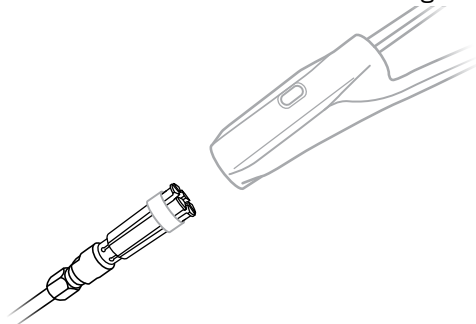

4. Repeat steps 1–3 to remove the rear bushing.
5. Wipe the bushing bores with a clean, dry cloth to remove any debris.

6. Load a new bushing onto each bushing installation tool.

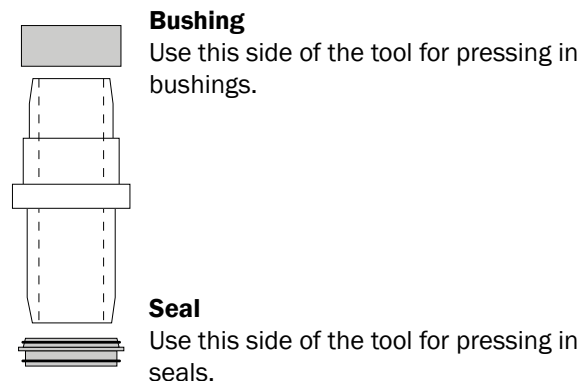

Notice: Do not use grease when installing the bushings. Using grease could cause the bushings to slip out of place.

7. Put one tool with one bushing into the front of the carriage, and the other tool with the other bushing into the rear of the carriage.

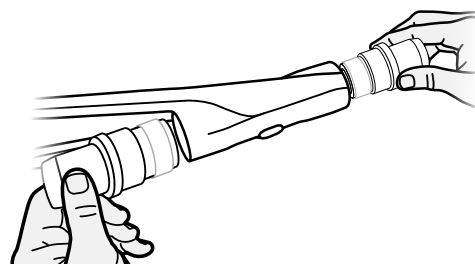

8. Insert the upper half of the headset press into the front of the carriage.

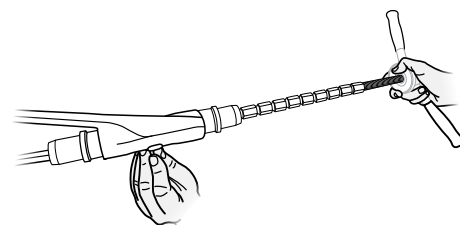

9. Insert the lower half of the headset press into the rear end of the carriage and lock it into place.

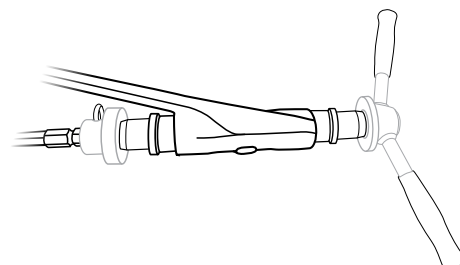

10. Spin the headset press until it is snug against the bushing tool. Check for correct alignment of the press, tools, and bushings. Rotate the press to push the bushings into place. It's normal to have different gaps at the front and rear of the carriage.

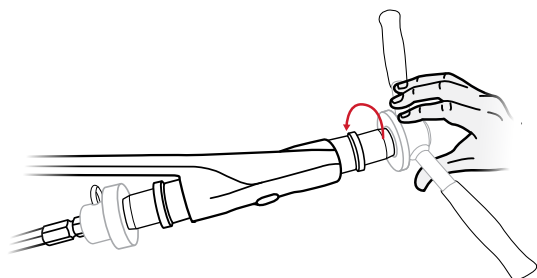

11. Tighten the press until you feel resistance. Once you feel resistance, remove the press and tools.
12. Inspect the bushings to verify they are pressed deep enough into the carriage. From the top of the bushing to the step above the bushing, the measurements should be:

Front = 16.5mm

Rear = 10mm

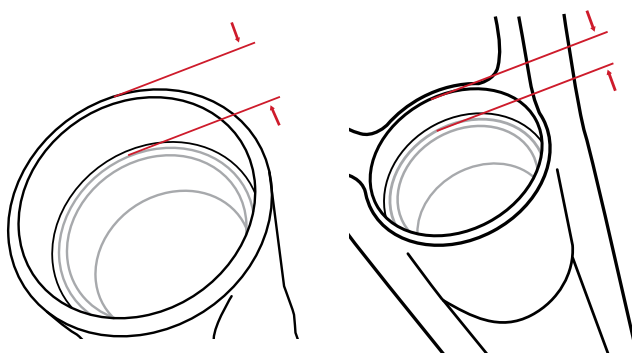

13. Apply a light coat of Maxima Suspension Plush Fluid 10wt oil — [600297](#)
14. From the front of the carriage, use the bushing sizer to size the bushings to 38.01 - 38.07mm. The sizer can be rotated to the left or to the right.

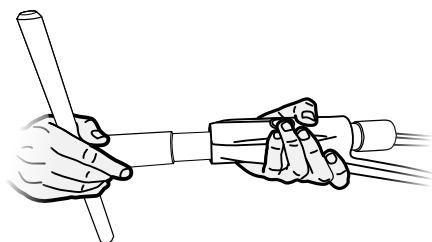

15. Repeat step 14 one to four times, alternating between the front and rear bushings.

Replace the wiper seals

Notice: Take care to not scuff or scratch the bushings. Scuffed or scratched bushing will need to be replaced.

1. Wipe the seal surface inside the carriage to remove debris.
2. Load a new seal onto each seal installation tool.

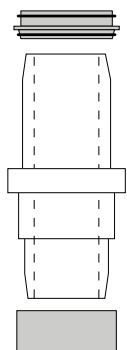

Seal

Use this side of the tool for pressing in seals.

Bushing

Use this side of the tool for pressing in bushings.

3. Put one tool with one seal into the front of the carriage, and the other tool with the other seal into the rear of the carriage.

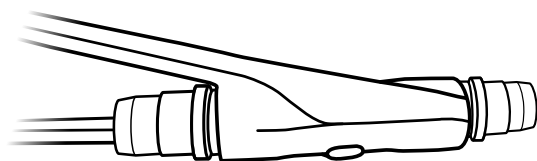

4. Insert the upper half of the headset press into the front of the carriage.

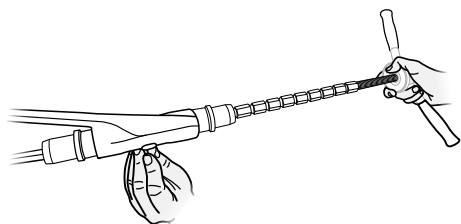

5. Insert the lower half of the headset press into the rear end of the carriage and lock it into place.

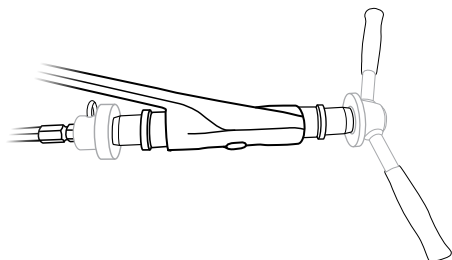

6. Spin the headset press until it is snug against the seal tool. Check for correct alignment of the press, tools, and seals. Rotate the press to push the seals into place.

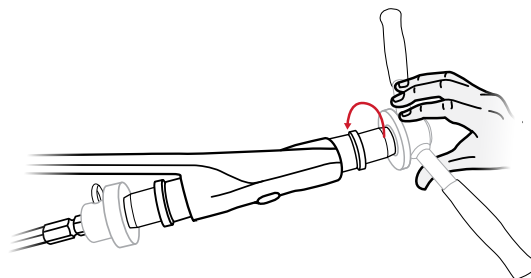

7. Tighten the press until you feel resistance. Press the wiper seals for approximately 30 seconds. Remove the press and both tools.
8. Inspect the seals to verify there is no gap between the seal and the carriage.

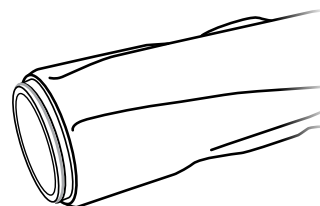

9. Soak the foam ring in Maxima Suspension Plush Fluid 10wt oil – [600297](#).
10. Install the foam ring into the front of the carriage.



Specifications

Chainline (1x only)

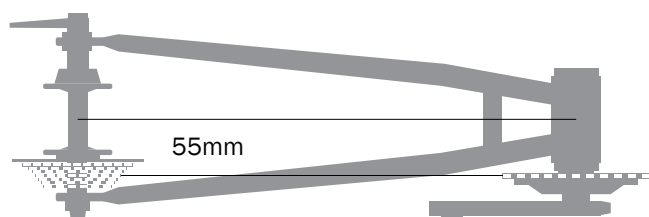

Chainring (1x only)

Minimum	Maximum
30T Round	38T Round

Rear brake mount

160mm Direct Post Mount

OLD

Rear Hub: 148mm

Maximum tire size

29" x 2.4"

Notice: Measurements of actual tires may vary. Always verify there is sufficient clearance between the tire and the frame. Improper tire size could damage the bicycle frame. Trek recommends 6mm clearance above and on the sides of the tire.

Bottom bracket

Press fit BB92



Seat post



WARNING

Always follow the seatpost manufacturer's minimum insertion recommendation. Failure to follow the recommendation could cause damage to the seatpost and result in injury to the rider.

Minimum insertion: Refer to seatpost manufacturer

Maximum insertion:

S: 215mm

M: 225mm

ML: 250mm

L: 270mm

XL: 330mm

Seat tube inside diameter: 31.6mm

Seat tube post clamp outer diameter: 36.2mm

Fork



WARNING

Exceeding the recommended maximum fork length could damage the bicycle and result in injury to the rider.

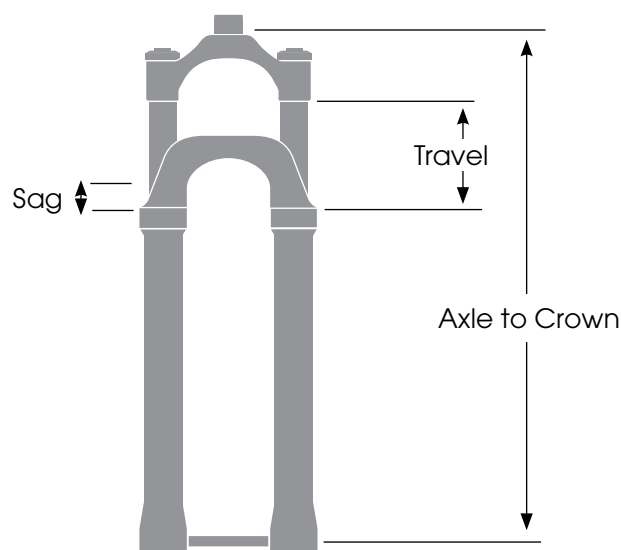

Frame/Size	Axle to Crown (mm)		Travel (mm)
S, M, ML, L, XL	Recommended	515	110
	Minimum	505	100
	Maximum	533	120

Recommended sag: Refer to the suspension calculator at [Trek bikes.com/suspension-calculator](https://trekbikes.com/suspension-calculator).