

TREK



2024 Procaliber Alloy

SERVICE MANUAL

Contents

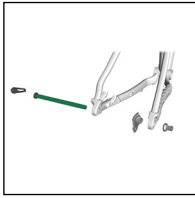

[Rear axle and UDH](#)

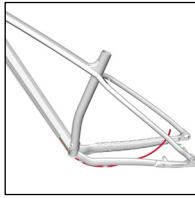

[Brake and shift routing](#)

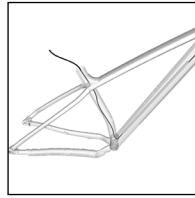

[Seat post dropper routing](#)



[Frame guards](#)

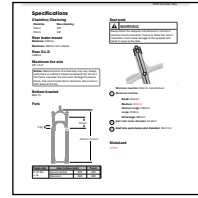

[Specifications](#)

Safety



WARNING

Tighten hardware properly

Always tighten hardware to the specified torque. Over-tightening hardware could deform or break the hardware or components. Under-tightening hardware could cause hardware or components to become loose. Either situation could damage the bicycle and result in injury to the rider.



WARNING

Re-apply threadlocker

All reused-fasteners with a pre-applied threadlocker must be cleaned with isopropyl alcohol and have new threadlocker applied before re-assembly. If a threadlocker is not applied, the fasteners may loosen, which could damage the bicycle and result in injury to the rider.

Legend



● Apply grease



Do not apply grease



● Apply threadlocker

Nm

Torque



Zip tie

Scope

This manual contains parts diagrams, specifications (such as grease and torque values), instructions and helpful tips. It does not contain instructions for all components (such as brake callipers). Refer to the original manufacturer for more information.

Additional resources

- Bicycle Owner's Manual: trekbikes.com/manuals
- Trek's YouTube channel: youtube.com/trek bikes

Rear axle and UDH

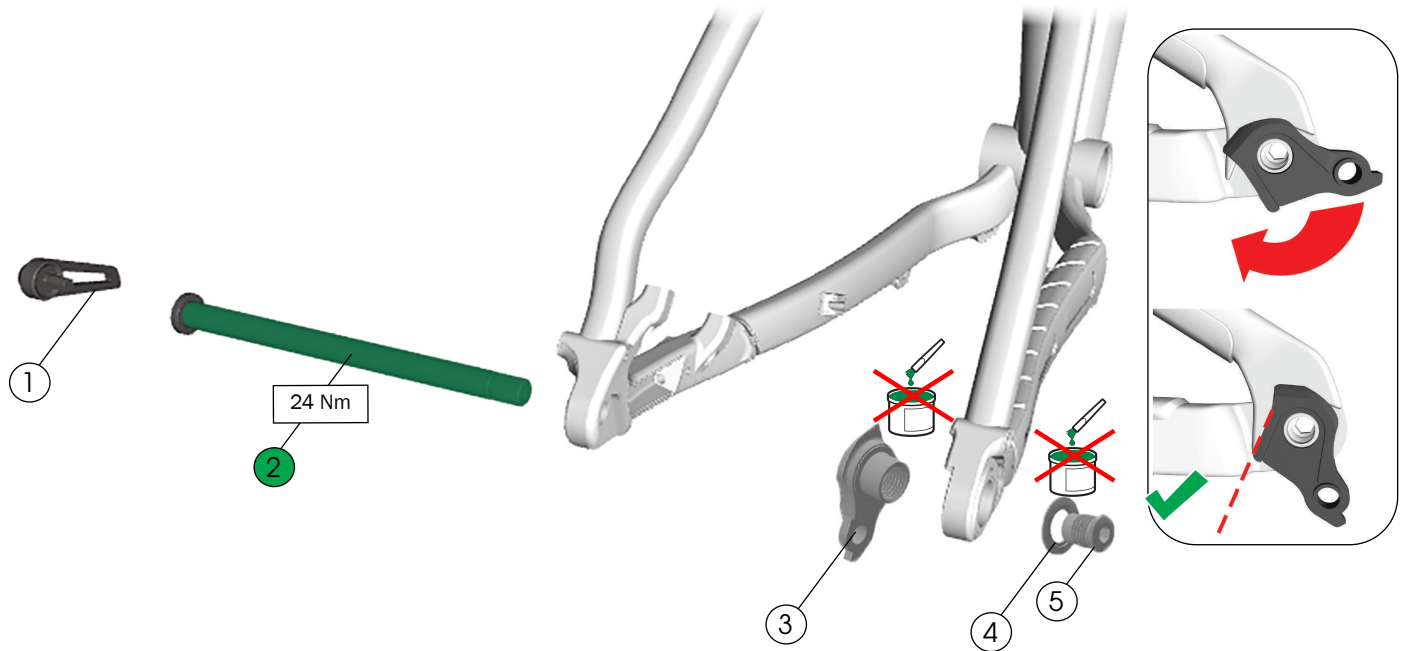

① Switch lever — [W573860](#)

② Thru-axle, 12x174mm — [W600321](#)

③ Dérailleur hanger
NOTICE: Do not apply grease.

④ Washer, 25 mm
NOTICE: The washer is frame-specific. Install only the washer size specified.

⑤ Bolt, M12
NOTICE: Do not apply grease. Do not overtighten. Overtightening may damage the hanger.

[W5271425](#)

Brake and shift routing

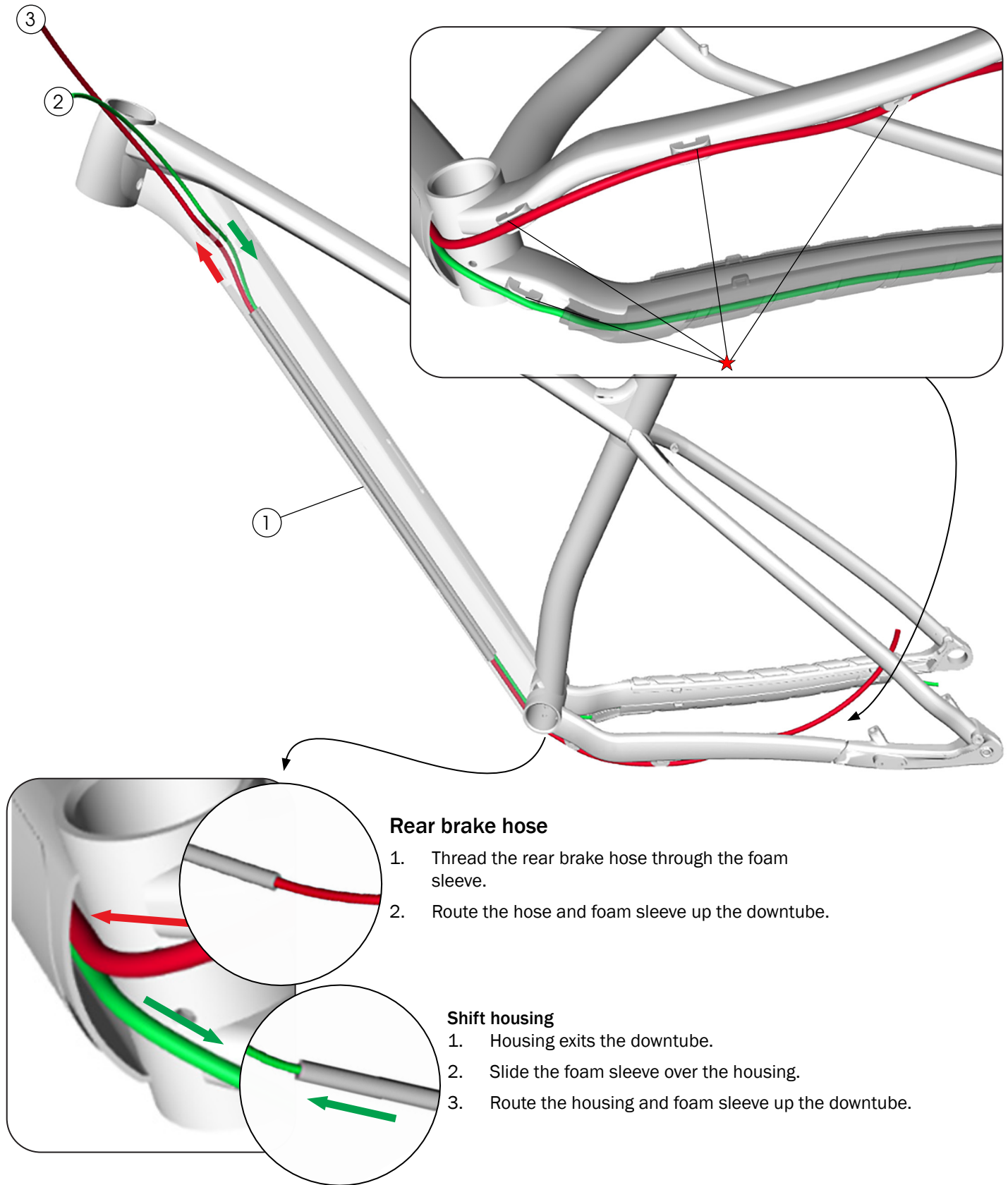

① Foam sleeves — [W528082](#)

② Rear brake hose

③ Shift housing

★ Zip ties

Seat post dropper routing

Bottom bracket must be removed to route the dropper housing.

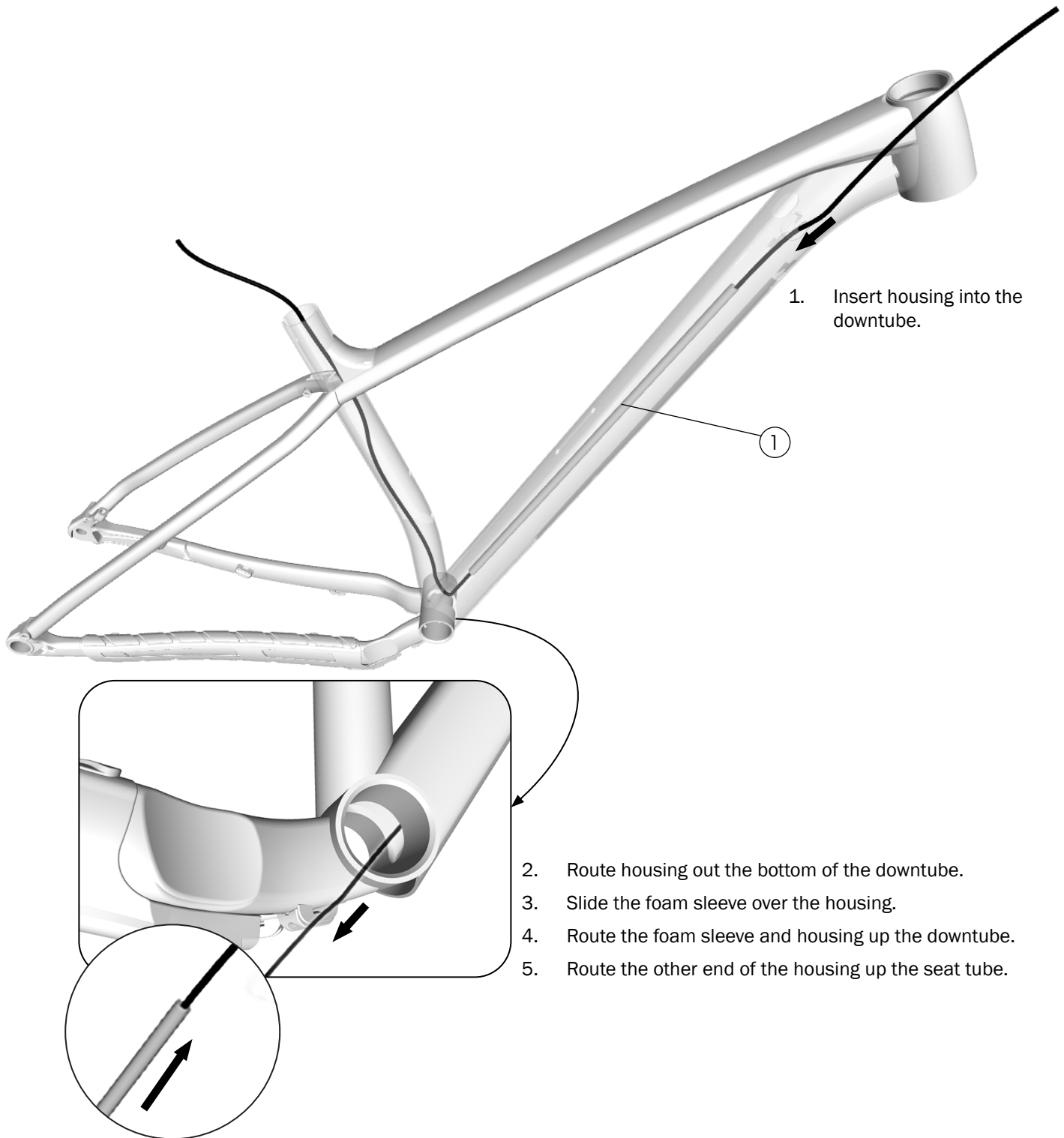

① Foam sleeve — [W528082](#)

Frame guards

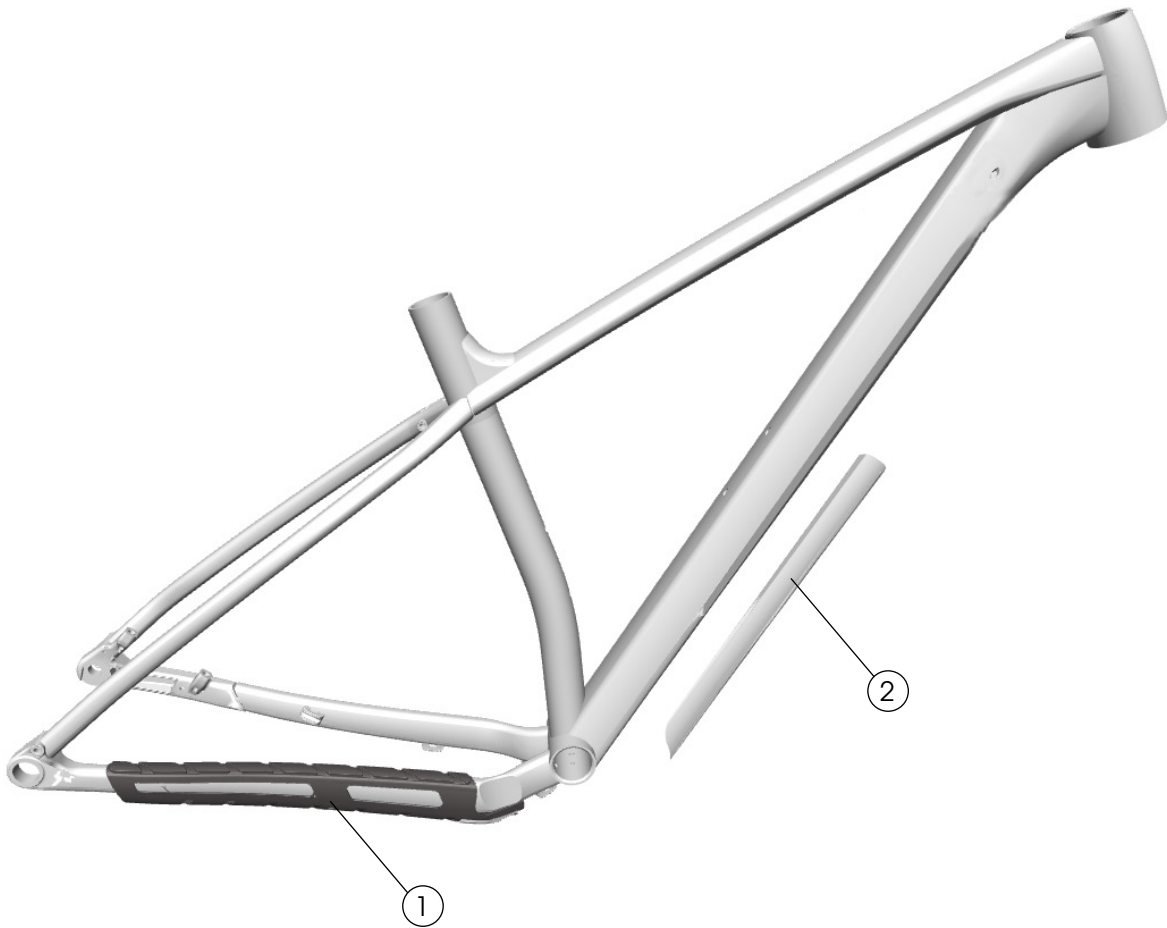

- ① Chainstay guard — [W5293689](#)
- ② Downtube guard:
SM/MD/ML frames — [W5308424](#)
LG/XL frames — [W5308425](#)

Use isopropyl alcohol to clean the frame surface where the guard is attached. Wait for the alcohol to dry before applying the guard.

NOTICE: Do not clean the entire frame with isopropyl alcohol. Isopropyl alcohol could damage the paint.

Specifications

Chain line/Chain ring

Chain line	Max chain ring
52 mm	30T
55 mm	34T

Rear brake mount

Minimum: 160 mm

Maximum: 180 mm with adapter

Rear O.L.D.

148 mm

Maximum tyre size

29" x 2.4"

Notice: Measurements of actual tyres may vary. Always verify that there is sufficient clearance between the tyre and the frame. Improper tyre size could damage the bicycle frame. Trek recommends 6mm clearance above and on both sides of the tyre.

Bottom bracket

BSA 73

Fork

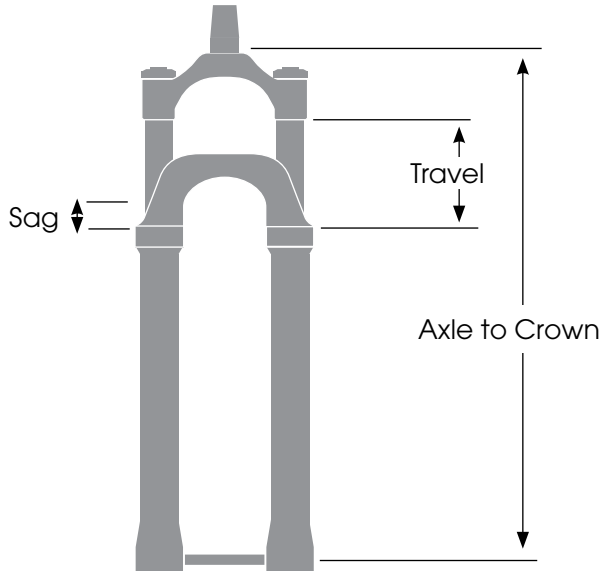

Frame size	Axle to Race (mm)		Travel
S, M, ML, L, XL	Recommended	520	120
	Maximum	540	130

Seat post



WARNING

Always follow the seat post manufacturer's minimum insertion recommendation. Failure to follow the recommendation could cause damage to the seat post and result in injury to the rider.

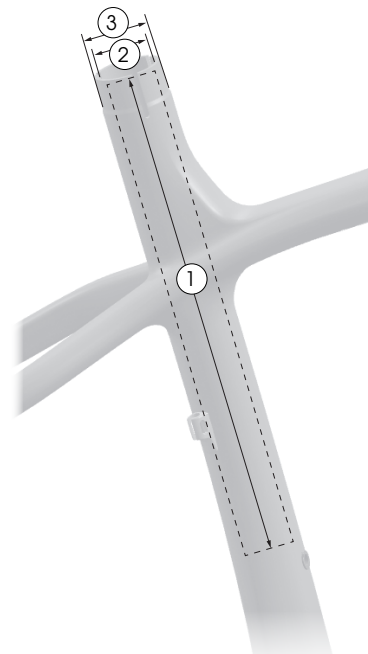

Minimum insertion: Refer to seat post manufacturer.

① Maximum insertion

Small: 210 mm

Medium: 200 mm

Medium/Large: 230 mm

Large: 250 mm

Extra large: 280mm

② Seat tube inside diameter: 31.6 mm

③ Seat tube post-clamp outer diameter: 36.2 mm