

TREK

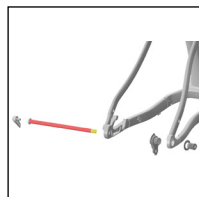

2023 Farley
Alloy 5, 7, and 9
SERVICE MANUAL

Contents



[Front and rear dropouts](#)

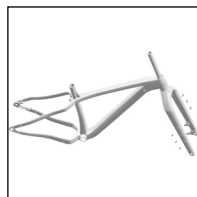

[Frame mounts — Farley 5 and Farley 9](#)

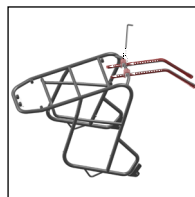

[Rear rack — installation](#)

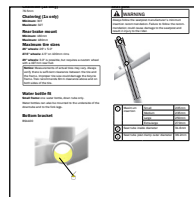

[Specifications](#)

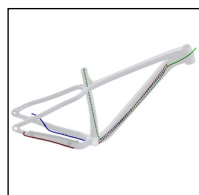

[Routing](#)



[Frame mounts — Farley 7](#)

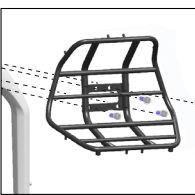

[Front rack](#)

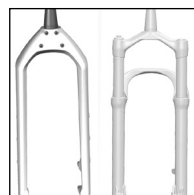

[Fork](#)



[Frame guards](#)

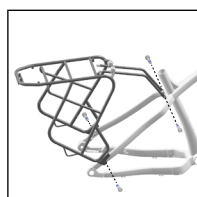

[Rear rack — parts](#)

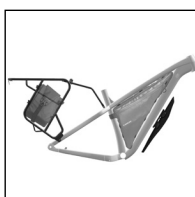

[Frame bag, rack bag, and fender](#)

Safety



WARNING

Properly tighten hardware

Always tighten hardware to the specified torque. Over-tightening hardware could deform or break the hardware or components. Under-tightening hardware could cause hardware or components to become loose. Either situation could damage the bicycle and result in injury to the rider.



WARNING

Reapply threadlocker

All reused-fasteners with pre-applied threadlocker must be cleaned with isopropyl alcohol and have new threadlocker applied before re-assembly. If threadlocker is not applied, the fasteners may loosen which could damage the bicycle and result in injury to the rider.

Legend



Apply grease



Do not apply grease



Apply threadlocker

Nm

Torque



Hex tool



Torx tool



Drift



Zip tie

Front and rear dropouts

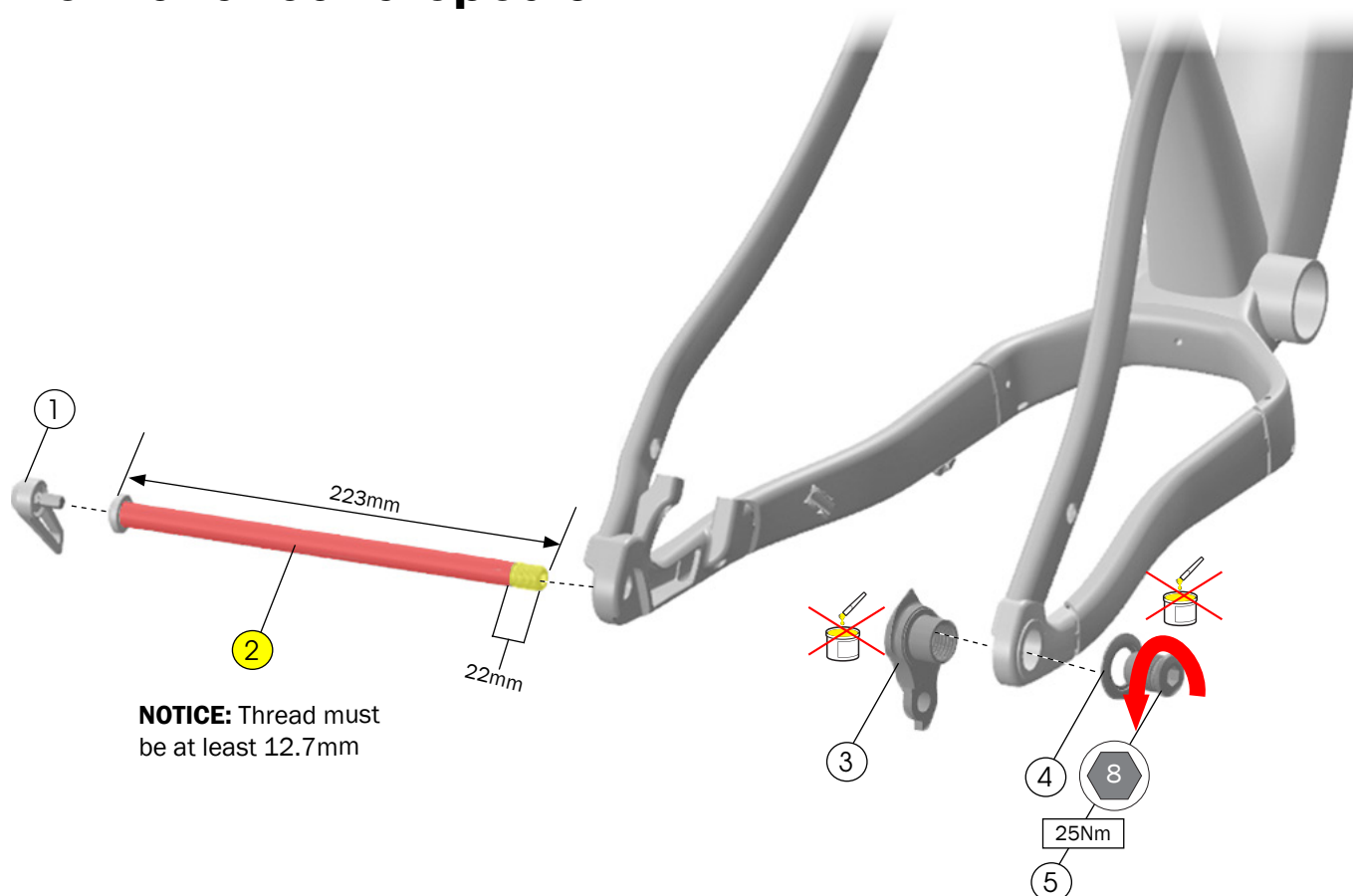

Front dropout (Farley 5 and 9)

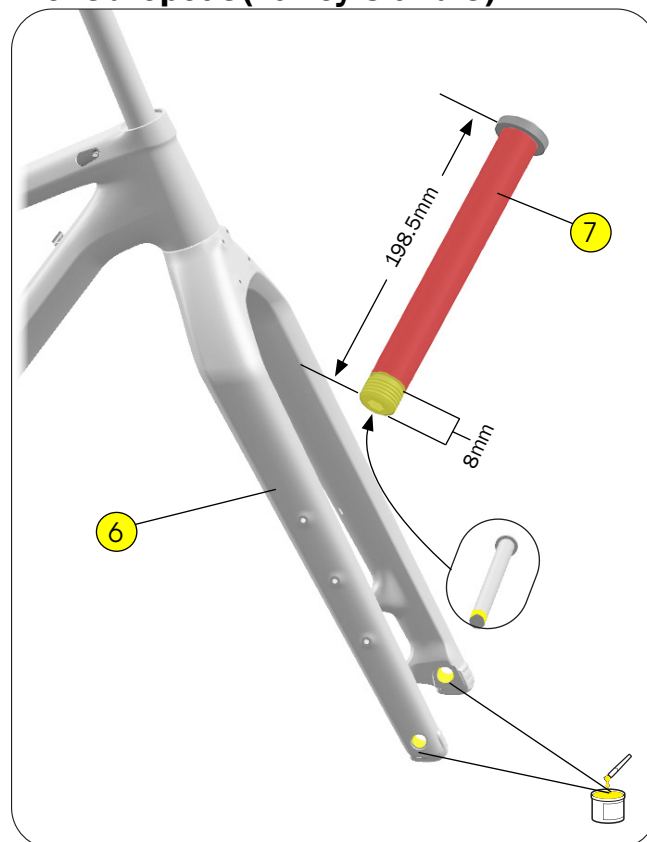

Routing

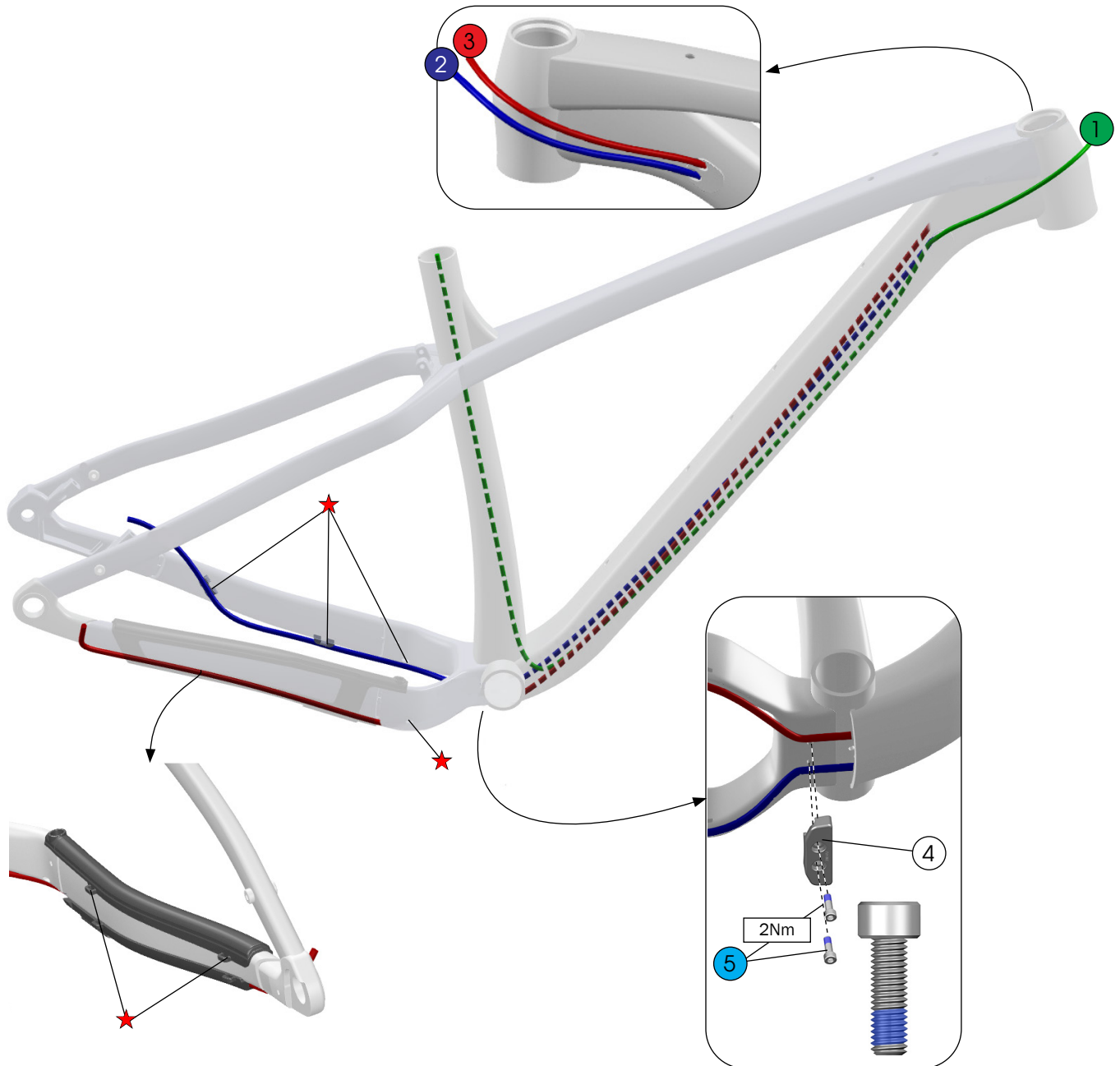

- ① Dropper post housing
- ② Rear brake hose
- ③ Rear derailleur housing

- ④ External cable guide — [W5287833](#)
- ⑤ Socket head screws, steel, M5 x 16 — [W5252789](#)
- ★ Zip ties

Frame guards

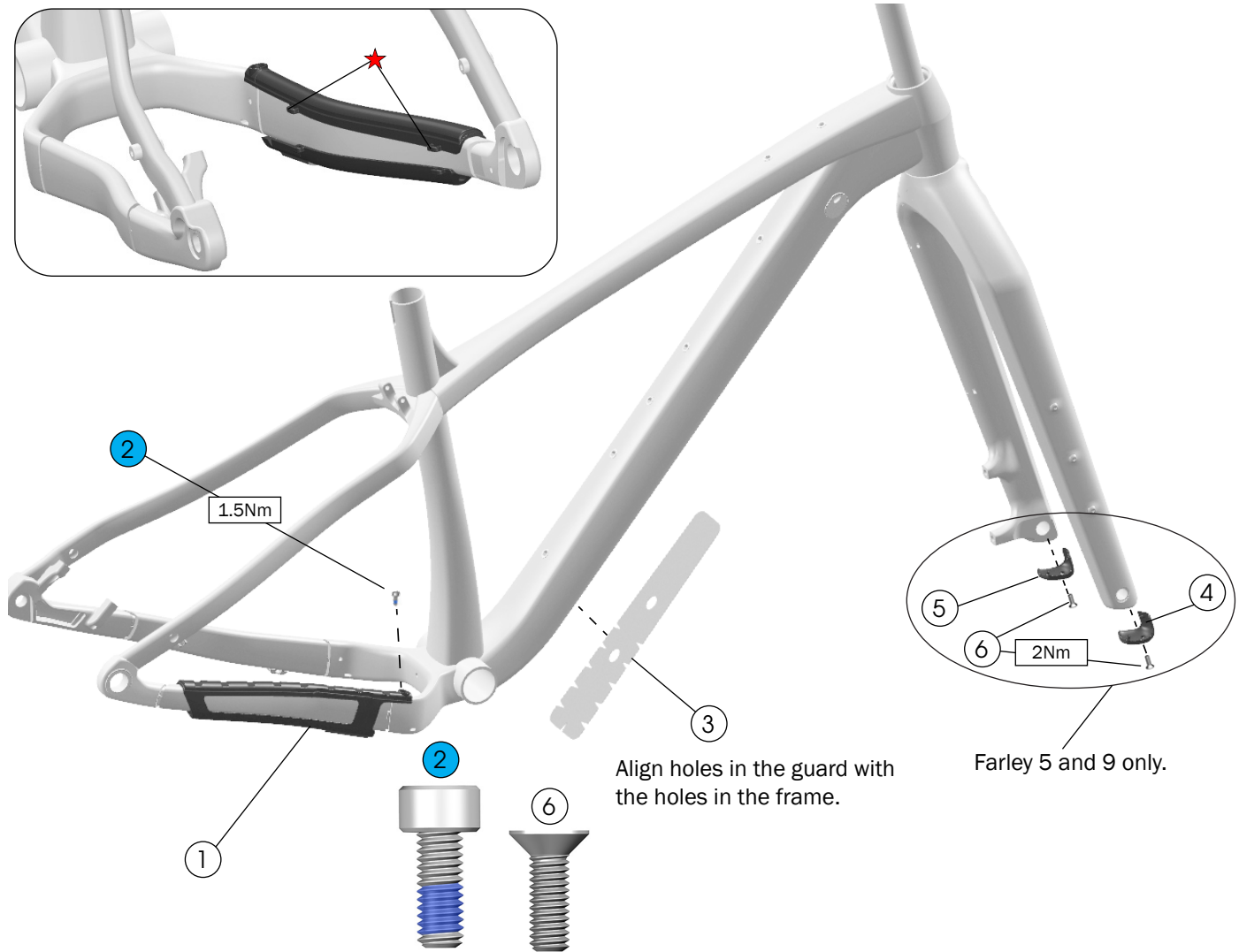

- ① Chainstay guard
Match the original part number found on the inside of the guard, with the correct replacement part (shown below).

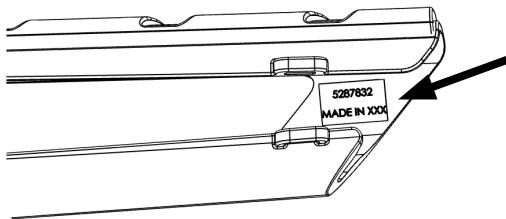

Original part	Order this part
5287832	W5287832
5306502	W5306502

- ② Socket head screw, steel, M5 x 16 — [W5271148](#)

- ③ Down tube adhesive guard
Small frame — [W5291271](#)
Medium frame — [W5290126](#)
Large frame — [W5291149](#)
Extra large frame — [W5291216](#)

Align holes in the guard with the holes in the frame.

Farley 5 and 9 only.

- ④ Fork dropout bumper, driveside
⑤ Fork dropout bumper, non-driveside
⑥ Screws, M4 x 12mm

— [5312674](#)

★ Zip tie

Adhesive guard ③

Use isopropyl alcohol to clean the frame surface where the guard attaches. Wait for the alcohol to dry before applying the guards.

Notice: Do not clean the entire frame with isopropyl alcohol. Isopropyl alcohol could damage the paint.

Frame mounts — Farley 5 and Farley 9

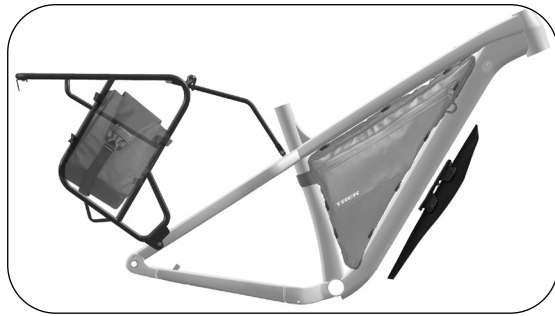

See [page 10](#) for bag and fender information.

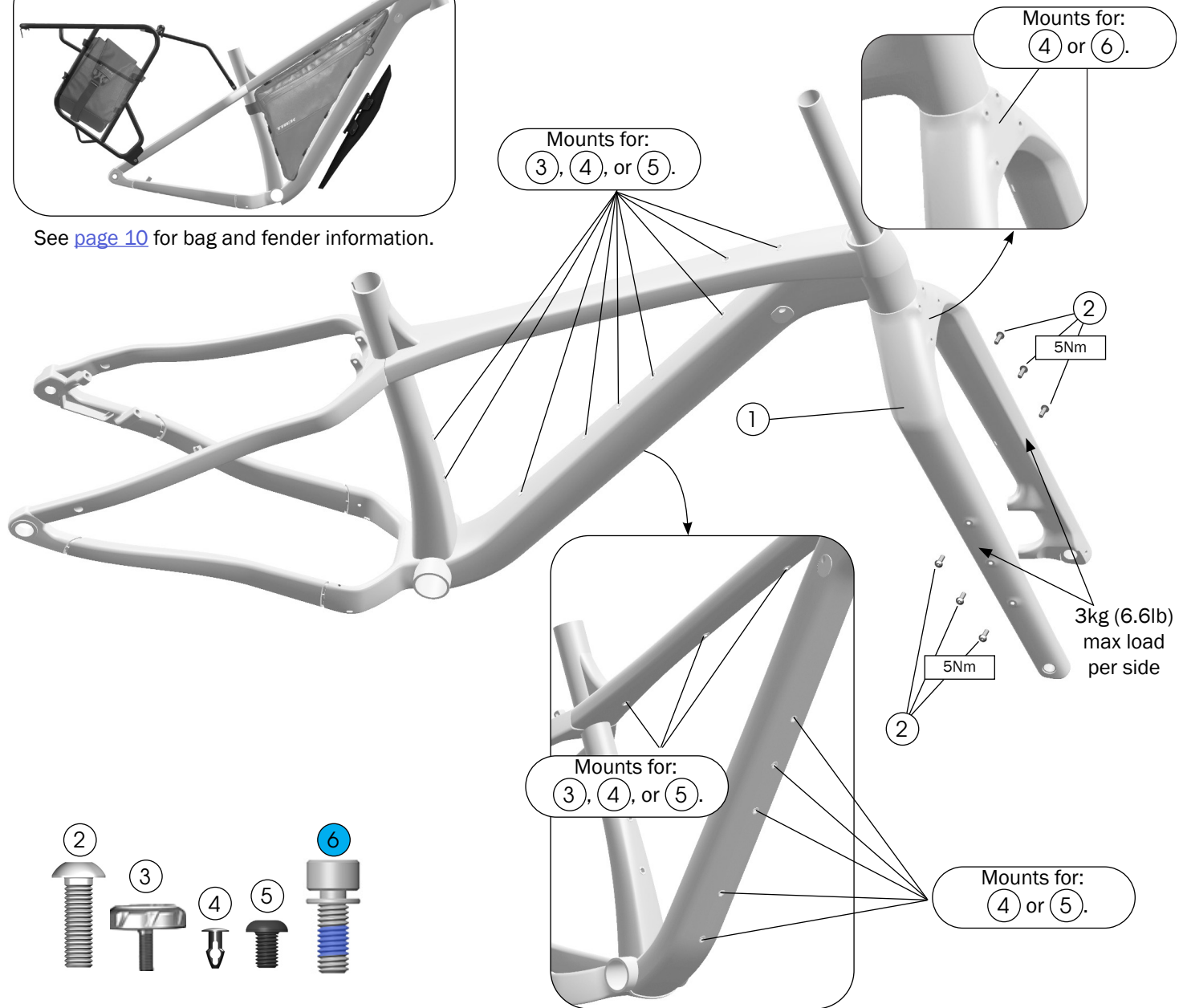

- ① Carbon fork — [5311796](#)
- ② Screws, stainless steel, M5 x 16mm — [W5252789](#)
- ③ Thumb screws — [5281893](#)
- ④ Water bottle nutsert plugs — [W308963](#)
- ⑤ Water bottle bolts, steel, M5 x 8mm — [W598484](#)
- ⑥ Rack Bolts, M6 x 16mm, with washers — [W582658](#)

Frame mounts — Farley 7

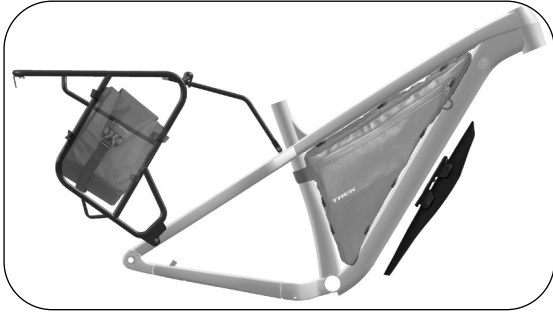

See [page 10](#) for bag and fender information.

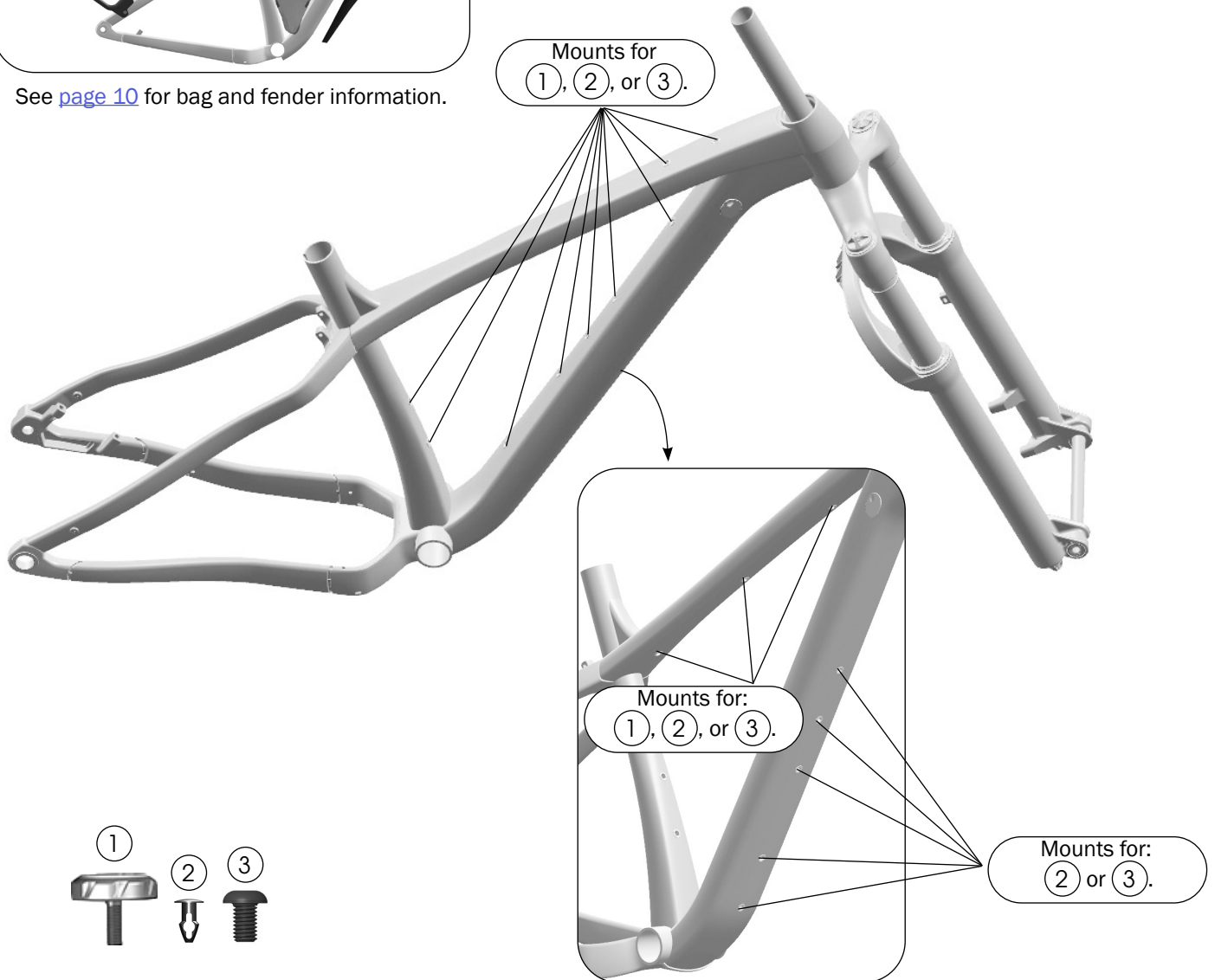

- ① Thumb screws — [5281893](#)
- ② Water bottle nutsert plugs — [W308963](#)
- ③ Water bottle bolts, steel, M5 x 8mm — [W598484](#)

Rear rack — parts

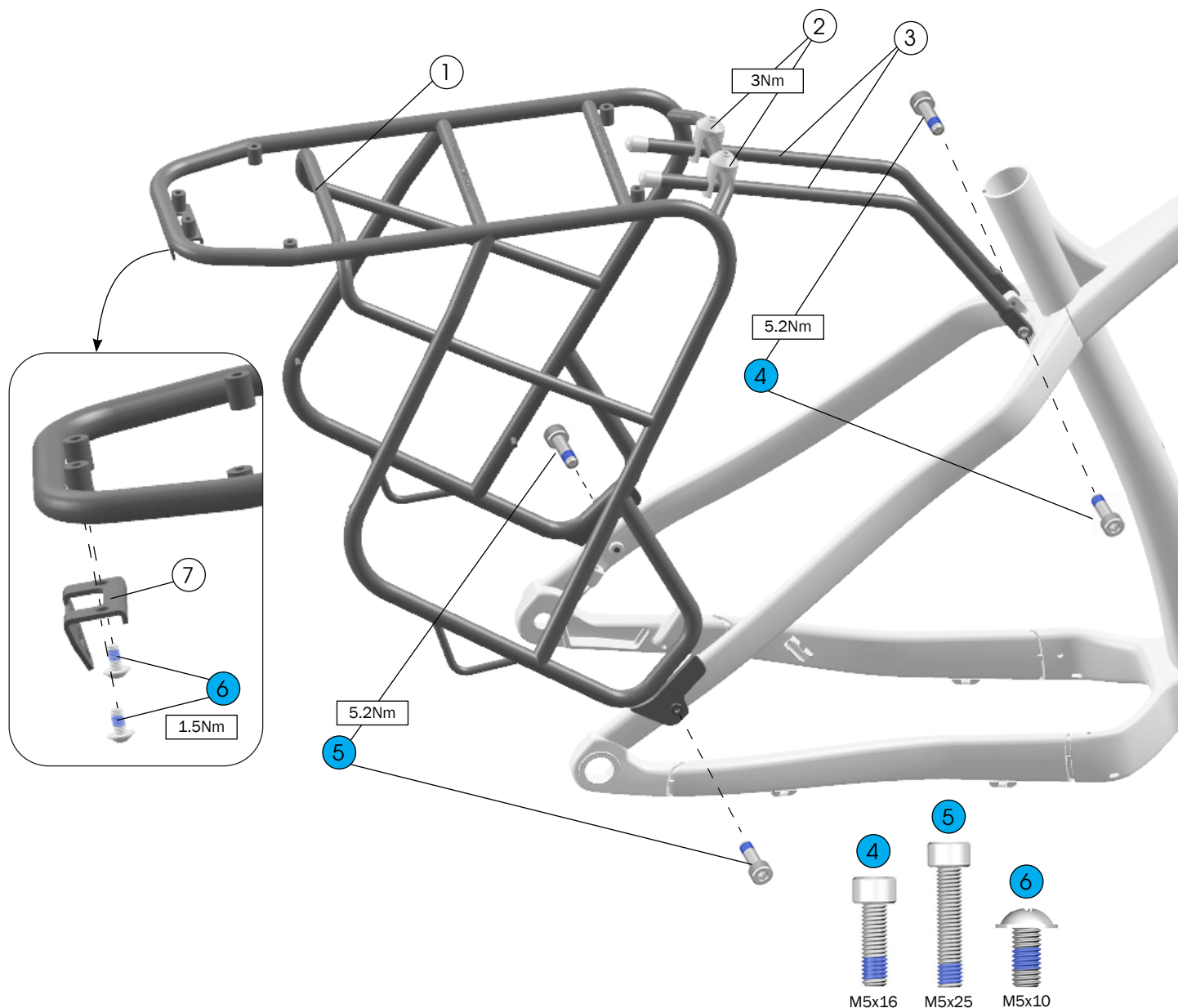

- ① Rear rack — [44355](#)
Search trekbikes.com to find the color-matched part for your bike.
- ② Strut nuts
- ③ Struts, one set. Matte black.
Includes strut caps — [5314713](#)
- ④ Socket head screws, steel, M5 x 16mm — [W5252789](#)
- ⑤ Socket head screws, steel, M5 x 25mm — [W5252787](#)
- ⑥ Bolts, stainless steel, M5 x 10mm — [W5288087](#)
- ⑦ Rear light bracket (black only) — [5314712](#)

— [423544](#)

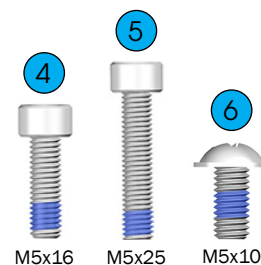

Rear rack — installation

Large or extra-large frames only: If adding or replacing a rack, use a hacksaw to cut two lengths from each strut to create clearance for the tire.

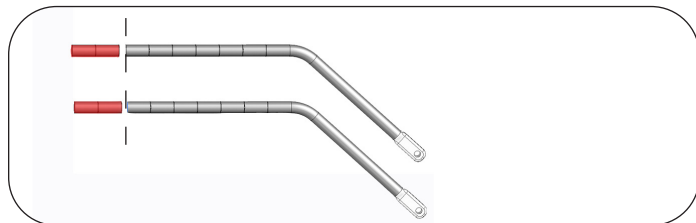

1. Place the strut mounts over the rack. Slide the struts thru the strut nuts. Then, slightly tighten the strut nuts to hold in the struts in place.

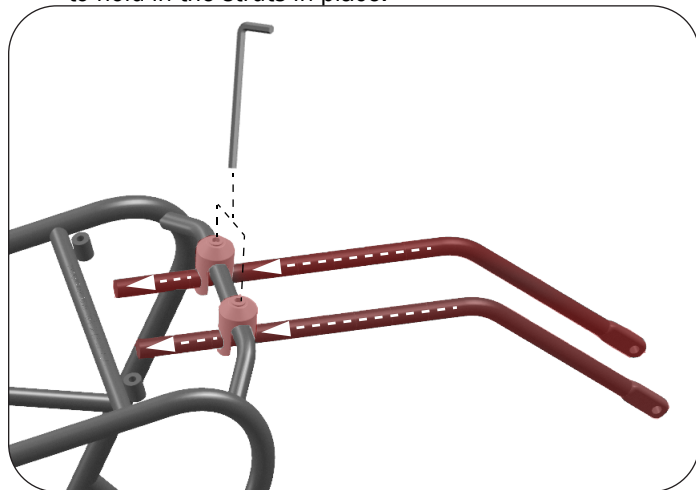

2. Install the strut caps on the struts.



3. Loosely attach the rack to the seatstay.

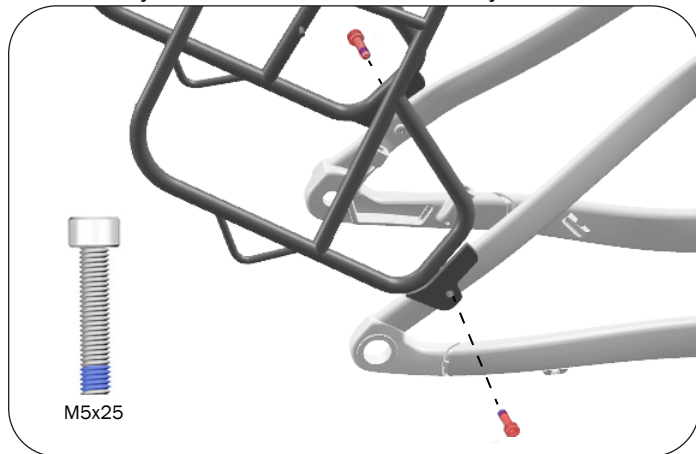

4. Loosely attach the rack to the seatstay bridge.

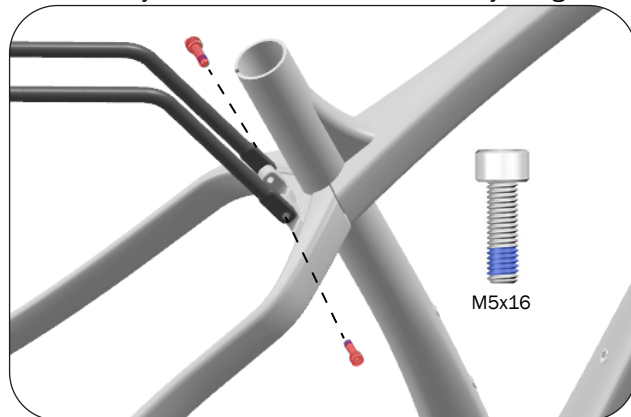

5. Adjust the rack to the desired angle. You may need to further loosen the strut nuts.

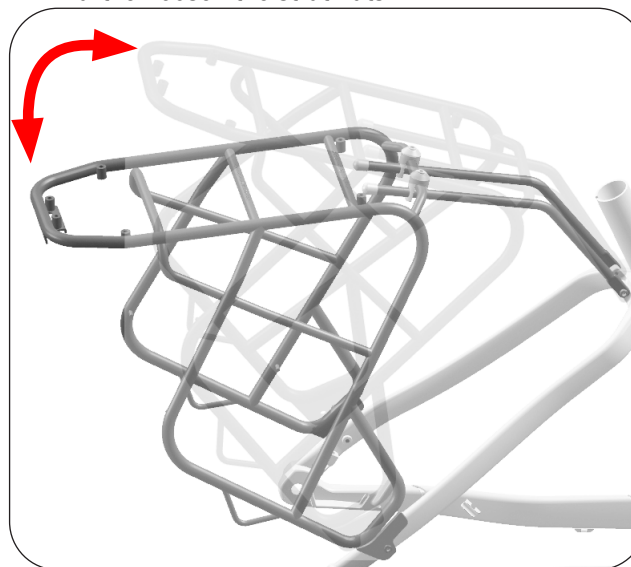

6. Torque all bolts.

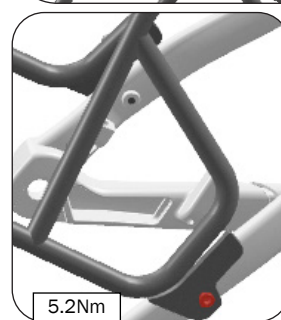
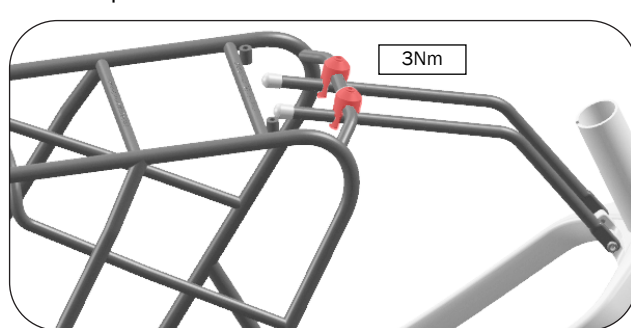

Front rack

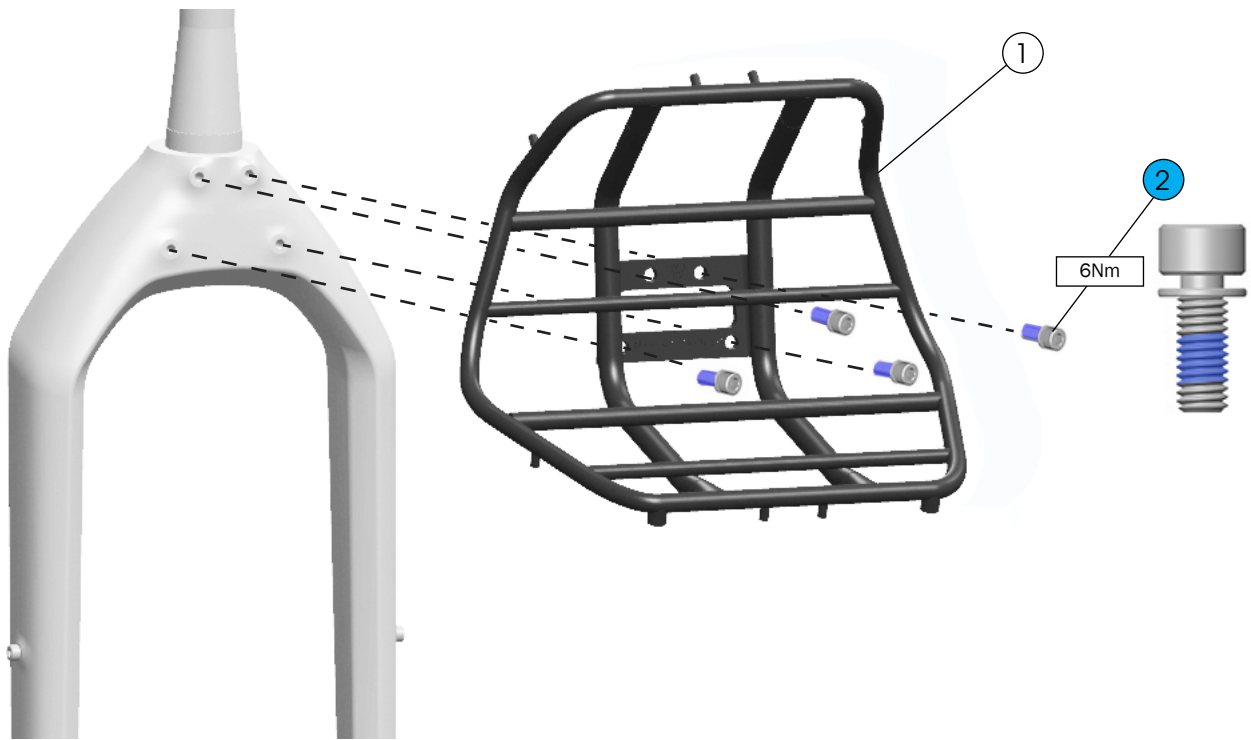

- ① Farley front rack — [44354](#)
Search trekbikes.com to find the color-matched part for your bike.
- ② Bolts, stainless steel, M6 x 16mm, with washers — [W582658](#)

Frame bag, rack bag, and fender

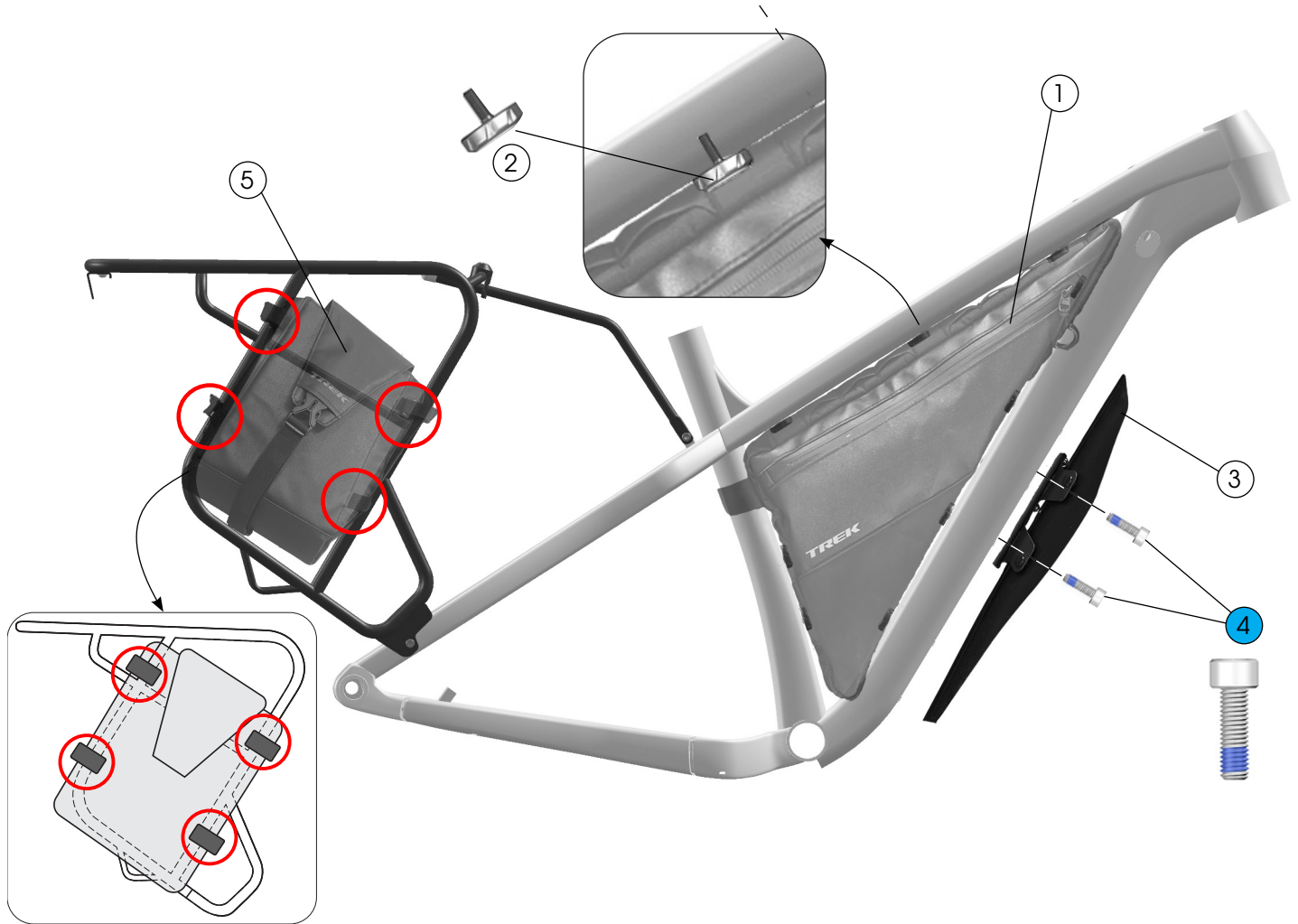

- ① Frame bag
S – [5288902](#)
M – [5288903](#)
L – [5288904](#)
XL – [5288905](#)
- ② Thumb screw – [5281893](#)
- ③ Universal fender kit – [W5289946](#)
- ④ Socket head screws, steel, M5 x 16mm – [W5252789](#)
- ⑤ Rear rack bag – [W1051275](#)

Specifications

Chainline (1x only)

76.5mm

Chainring (1x only)

Minimum: 30T

Maximum: 32T

Rear brake mount

Minimum: 160mm

Maximum: 180mm

Maximum tire sizes

26" wheels: 26" x 5.0"

27.5" wheels: 4.5" on 100mm rims

29" wheels: 3.0" is possible, but requires a custom wheel with a 197mm rear hub

Notice: Measurements of actual tires may vary. Always verify there is sufficient clearance between the tire and the frame. Improper tire size could damage the bicycle frame. Trek recommends 6mm clearance above and on both sides of the tire.

OLD

Front Hub: 150mm

Rear Hub: 197mm

Water bottle fit

Small frame: one water bottle, down tube only.

Water bottles can also be mounted to the underside of the downtube and to the fork legs.

Bottom bracket

BSA100

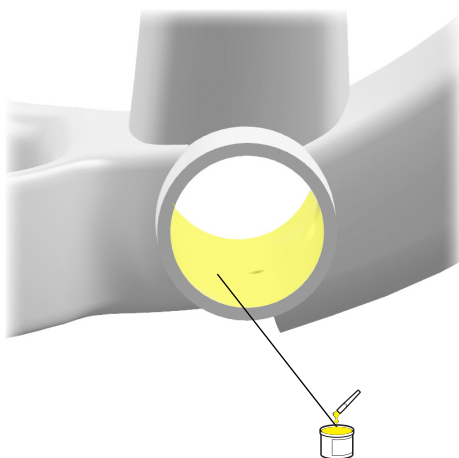

Seat post



WARNING

Always follow the seatpost manufacturer's minimum insertion recommendation. Failure to follow the recommendation could cause damage to the seatpost and result in injury to the rider.

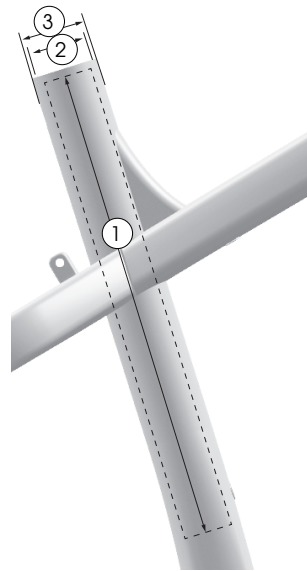

①	Maximum insertion	Small	205mm
		Medium	235mm
		Large	250mm
		Extra-large	270mm
②	Seat tube inside diameter		31.6mm
③	Seat tube post clamp outer diameter		36.2mm

Fork



WARNING
Exceeding the recommended maximum fork length could damage the bicycle and result in injury to the rider.

Farley 5 and 9

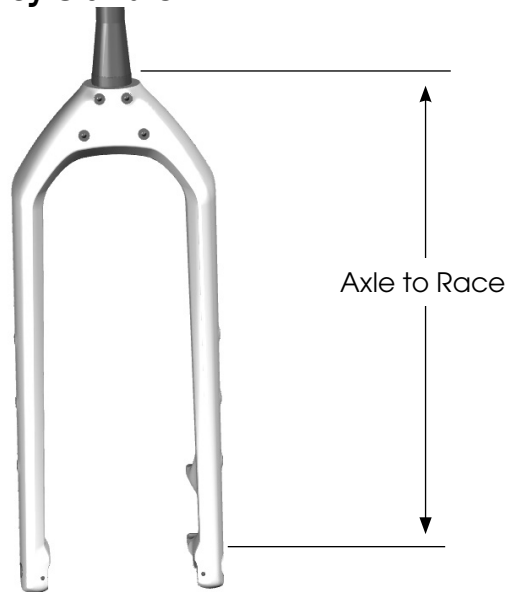

Frame size	Axle to Race (mm)	
S, M, L,	Recommended	490
XL	Recommended	491

Farley 7

Refer to the suspension setup card included with your bike or the suspension calculator at

[Trekbikes.com/suspension-calculator](https://trekbikes.com/suspension-calculator).

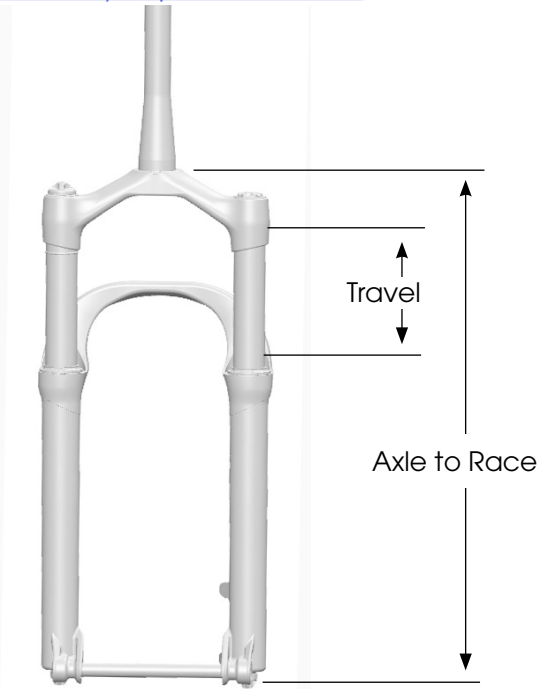

Frame size	Axle to Race (mm)		Travel (mm)
S, M, L, XL	Recommended	491.8	80
	Maximum	513.2	80