

TREK



2023 DOMANE SL/SLR

SERVICE MANUAL

Contents

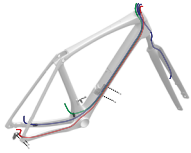

[Routing – mechanical
\(SL only\)](#)

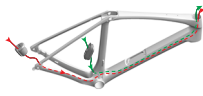

[Routing – mechanical
\(SL only\): instructions](#)

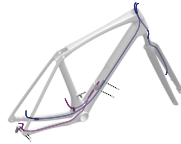

[Routing – Di2](#)

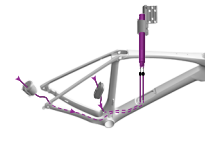

[Routing – Di2:
instructions](#)



[Routing – eTap](#)

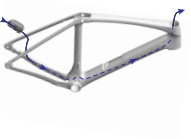

[Routing – eTap:
instructions](#)



[Fork and headset](#)

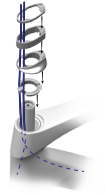

[Install the headset](#)



[Fork and headset –
standard stem](#)



[Seatpost](#)



[IsoSpeed](#)



[IsoSpeed: remove and
install](#)

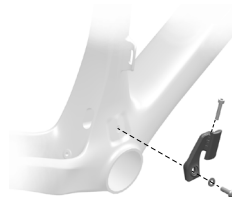

[Chainkeeper](#)



[Storage door](#)

	SL/SLR
Rear hub BCD	142mm
Rear hub BCD	142mm
Upper fork steerer tube ØD	31.8mm
Lower fork steerer tube ØD	31.8mm
Bottom bracket type / width	T47/68.5mm
Headset upper diameter (mm)	44/47/50/52mm
max	—
Frame width max (mm)	105mm
Frontset compatible – rear	Yes
Frontset compatible – front	Yes

	Max chainring teeth (T)		
	Short	Long	Single (SL)
Domane	43 Teeth	50T	50T
SLR	43 Teeth	52T	52T

Safety

WARNING

Tighten hardware properly

Always tighten hardware to the specified torque. Over-tightening hardware could deform or break the hardware or components. Under-tightening hardware could cause hardware or components to become loose. Either situation could damage the bicycle and result in injury to the rider.

WARNING

Re-apply threadlocker

All reused-fasteners with a pre-applied threadlocker must be cleaned with isopropyl alcohol and have new threadlocker applied before re-assembly. If a threadlocker is not applied, the fasteners may loosen, which could damage the bicycle and result in injury to the rider.

Legend



Apply appropriate grease



Apply threadlocker



Torque



Cable (zip) tie

Routing - mechanical

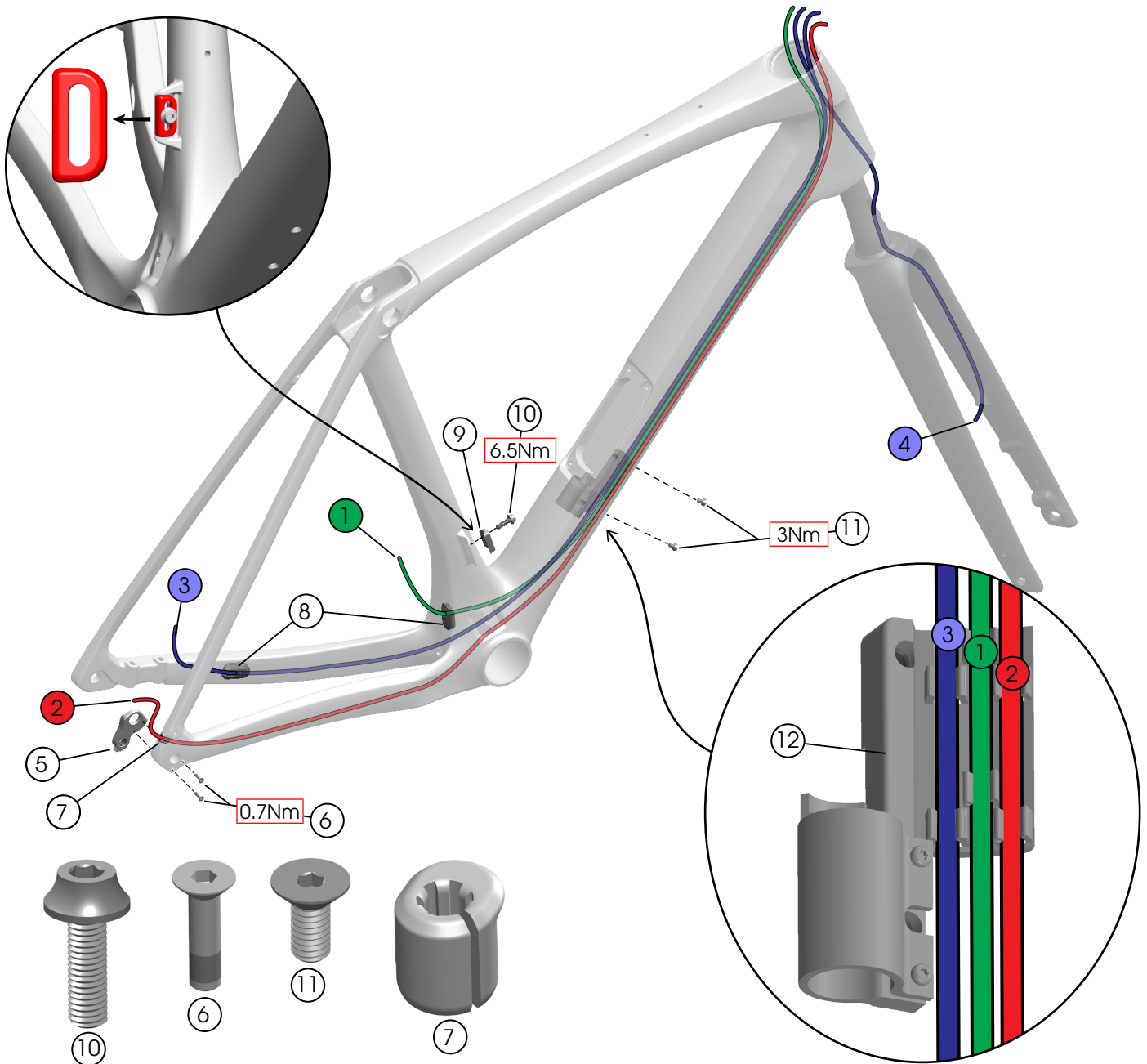

- | | |
|---|---|
| ① Front derailleur cable | ⑦ Cable housing grommet - W329119 |
| ② Rear derailleur cable | ⑧ Housing grommets - W330578 |
| ③ Rear brake hose | ⑨ Front derailleur hanger - W531901 |
| ④ Front brake hose. | ⑩ Front derailleur hanger bolt (M5x16 mm) - W543903 |
| ⑤ Rear derailleur hanger - W524188 | ⑪ Cable guide bolts (M4x9 mm) - W546731 |
| ⑥ Rear derailleur hanger bolts (M3x12 mm) - W524884 | ⑫ Cable guide - W588188 |

Routing – mechanical: instructions

1. Route the brake hoses.

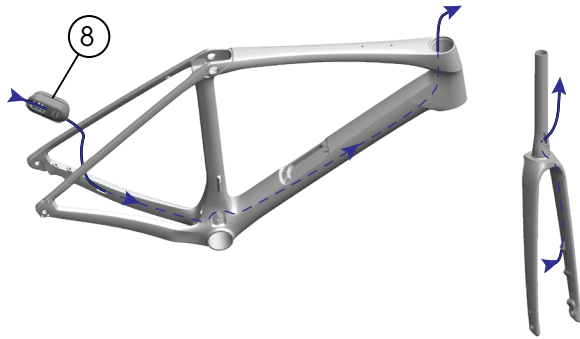

2. Route the shift housings.

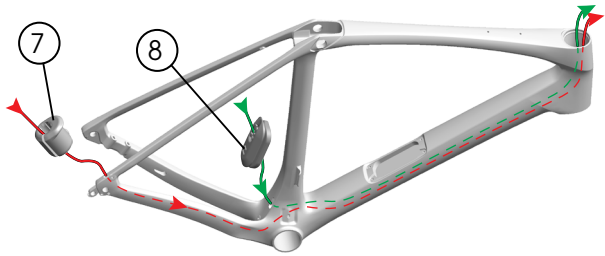

3. Insert the shift housings and rear brake hose into the cable guide.

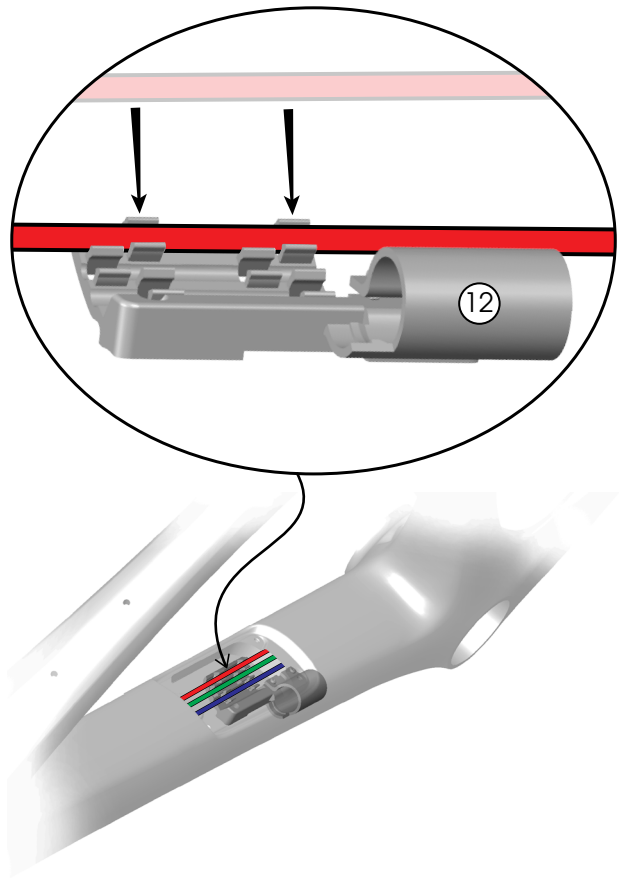

Routing - Di2

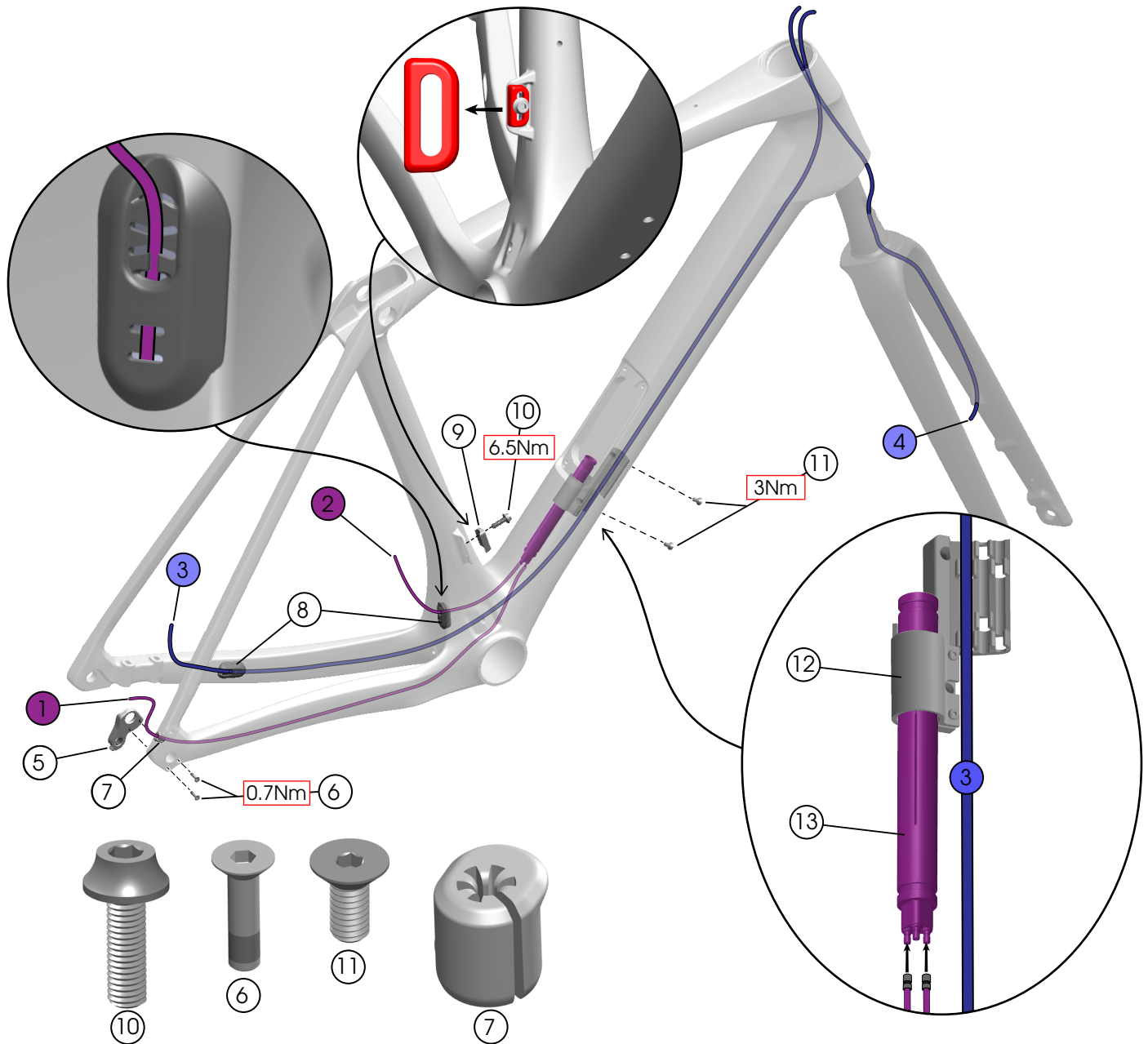

- | | | |
|--|--------------|---|
| <ul style="list-style-type: none"> 1 Rear Di2 wire 2 Front Di2 wire | } EW-SD300-I | <ul style="list-style-type: none"> 8 Housing grommets - W330578 9 Front derailleur hanger - W531901 10 Front derailleur hanger bolt (M5x16 mm) - W543903 11 Cable guide bolts (M4x9 mm) - W546731 12 Cable guide - W588188 13 Di2 battery - BTDN300 |
| <ul style="list-style-type: none"> 3 Rear brake hose 4 Front brake hose. 5 Rear derailleur hanger - W524188 6 Rear derailleur hanger bolts (M3x12 mm) - W524884 7 Di2 wire grommet - W317292 | | |

Routing - Di2: instructions

1. Route the brake hoses.

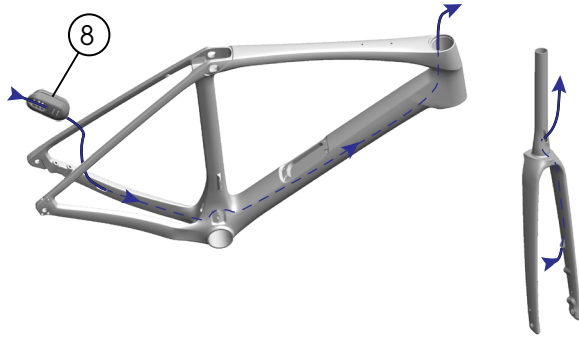

2. Route the Di2 wires through the frame and connect them to the battery.

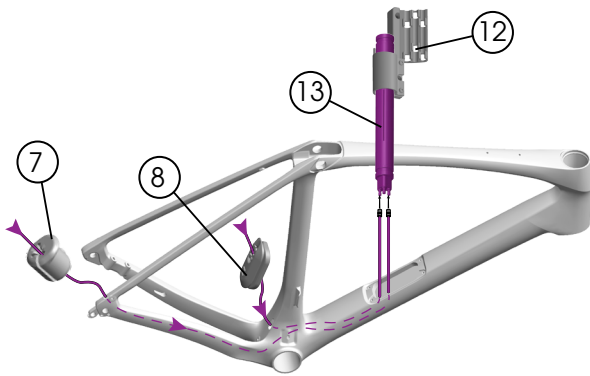

3. Install the battery assembly.

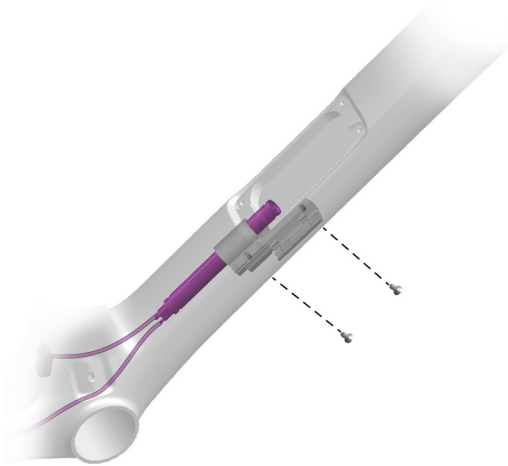

4. Insert the rear brake hose into the cable guide

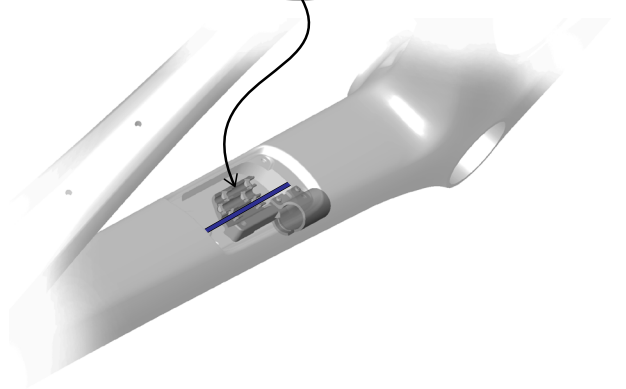
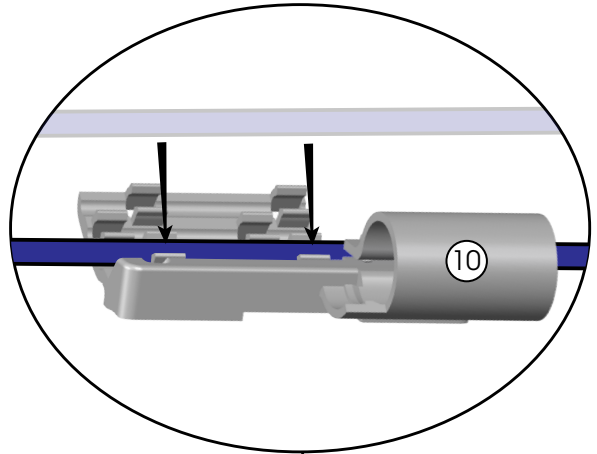

Routing - eTap

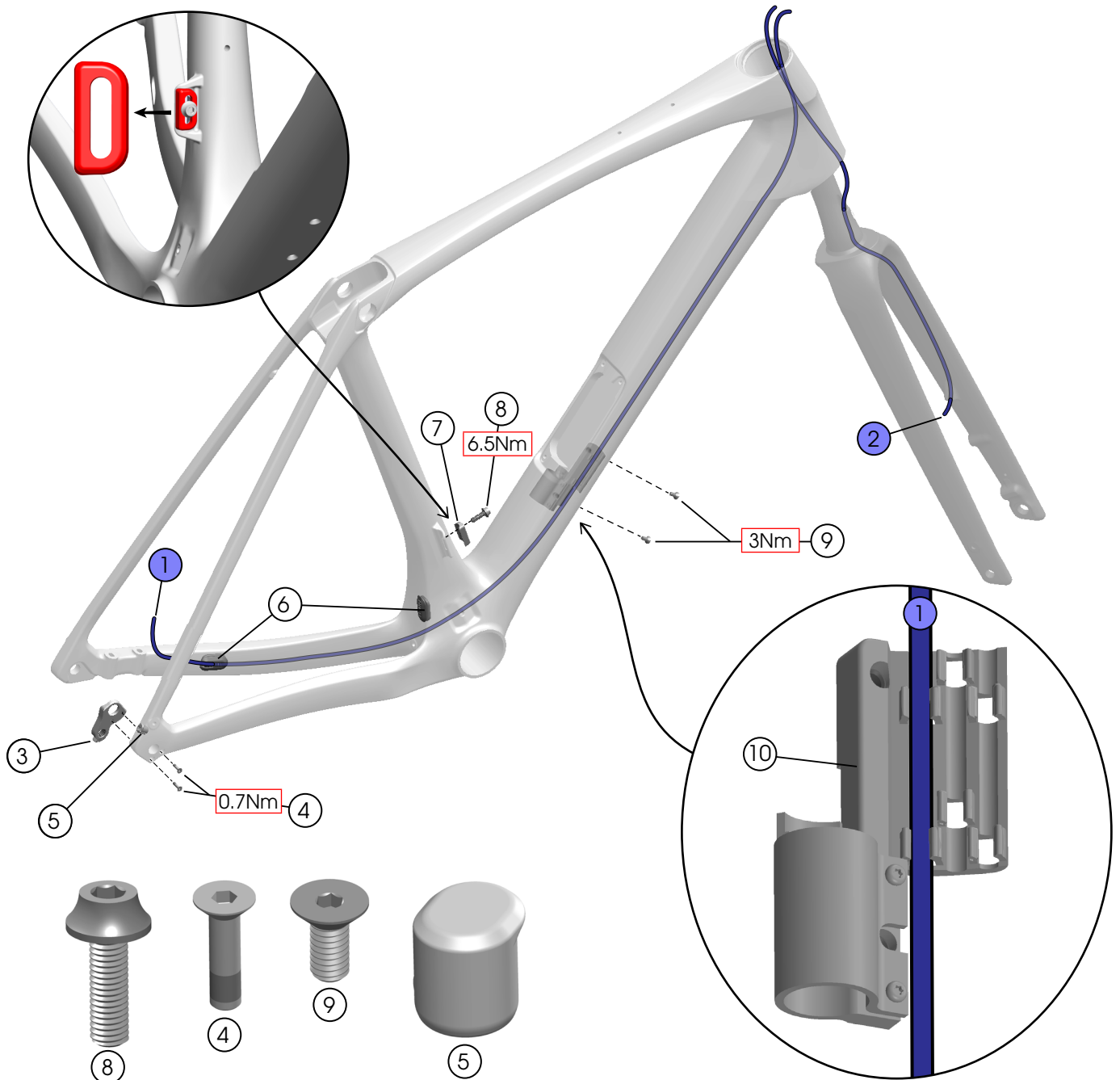

- ① Rear brake hose
- ② Front brake hose.
- ③ Rear derailleur hanger - [W524188](#)
- ④ Rear derailleur hanger bolts (M3x12 mm) - [W524884](#)
- ⑤ eTap hole plug - [W547906](#)
- ⑥ Housing grommets - [W330578](#)
- ⑦ Front derailleur hanger - [W531901](#)
- ⑧ Front derailleur hanger bolt (M5x16 mm) - [W543903](#)
- ⑨ Cable guide bolts (M4x9 mm) - [W546731](#)
- ⑩ Cable guide - [W588188](#)

Routing - eTap: instructions

1. Route the brake hoses.

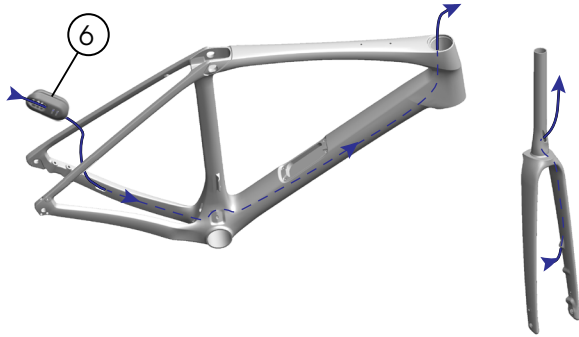

2. Insert the rear brake hose into the cable guide.

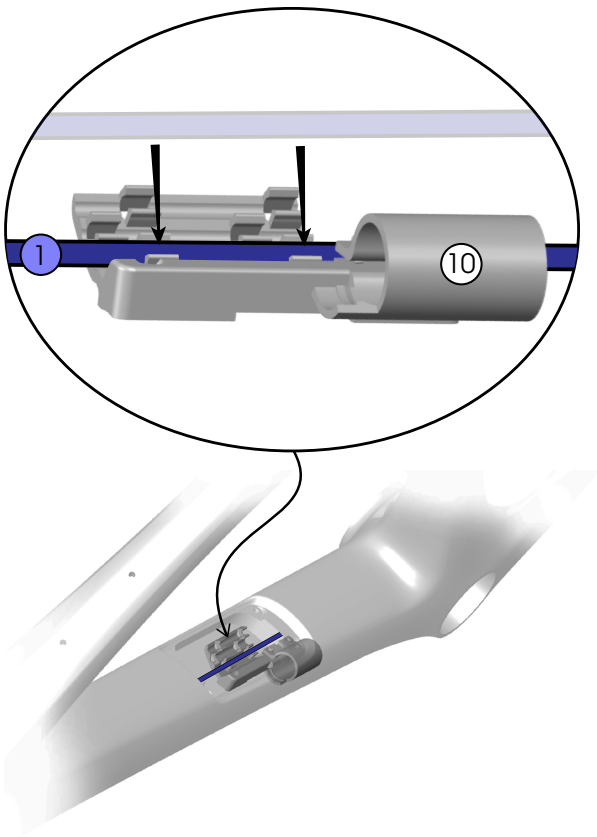

Fork and headset

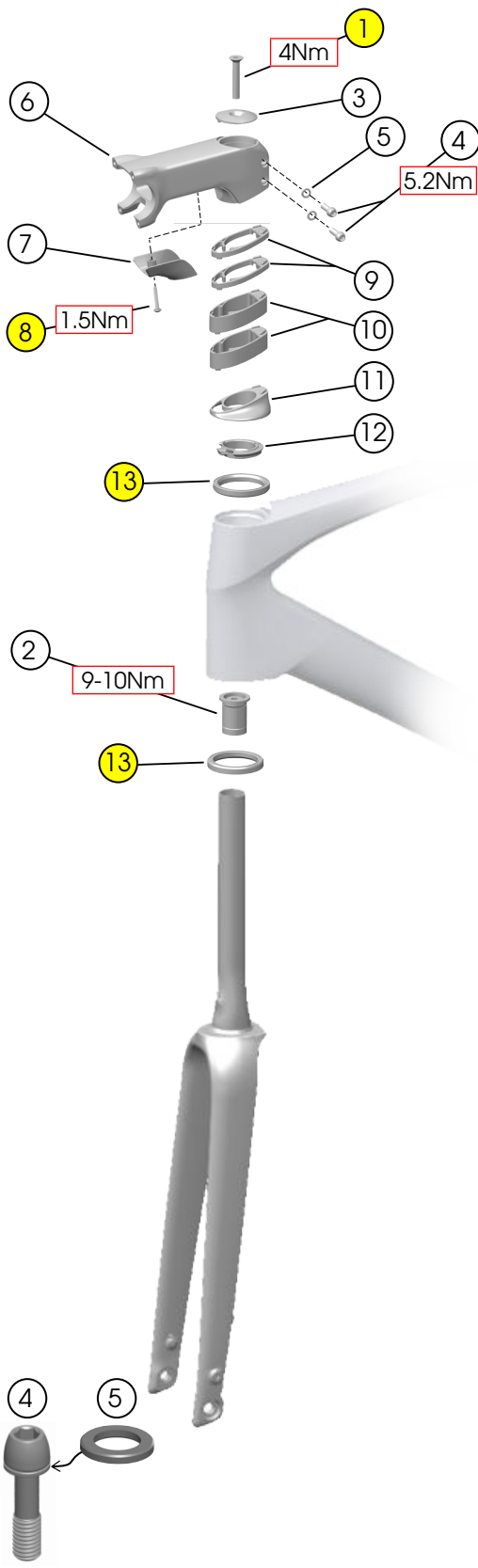

- ① Top cap bolt (M6x35 mm) } [W547432](#)
- ② Compression plug
- ③ Top cap - [W5274966](#)
- ④ Stem bolts (M5x15 mm) } [5305331](#)
- ⑤ Washers (M5)
- ⑥ Stem - [5274584](#)
- ⑦ Routing cover - [W5274600](#)
- ⑧ Bolt (M4x25 mm) - [W5274963](#)
- ⑨ Spacers (5 mm) - [5296906](#)
- ⑩ Spacers (15 mm) - [5296905](#)
- ⑪ Bearing cover - [W5274267](#)
- ⑫ Split ring - [W5274269](#)
- ⑬ Headset bearings - [W540243](#)

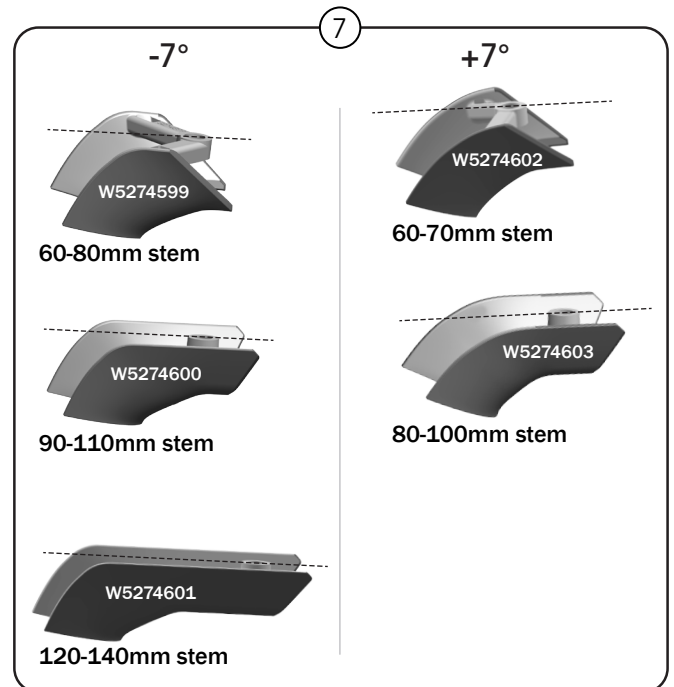

Fork and headset: max spacers

WARNING

Below the stem

Do not exceed 40 mm of headset spacers below the stem. If there are more than 40 mm of spacers, the steerer tube could become damaged and break, causing a crash and resulting in injury.

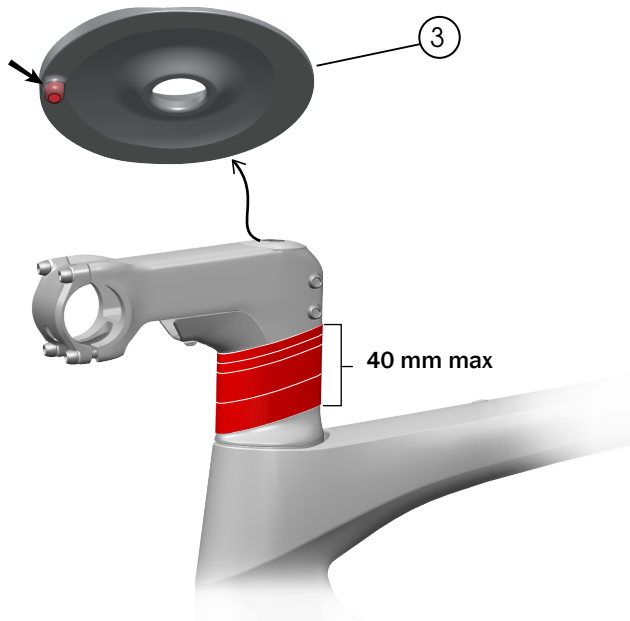

WARNING

Above the stem

Do not exceed 40 mm of headset spacers above the stem. If there are more than 40 mm of spacers, the steerer tube could become damaged and break, causing a crash and resulting in injury.

NOTE: If you add spacers above the stem, you must use a standard top cap (without the indent).

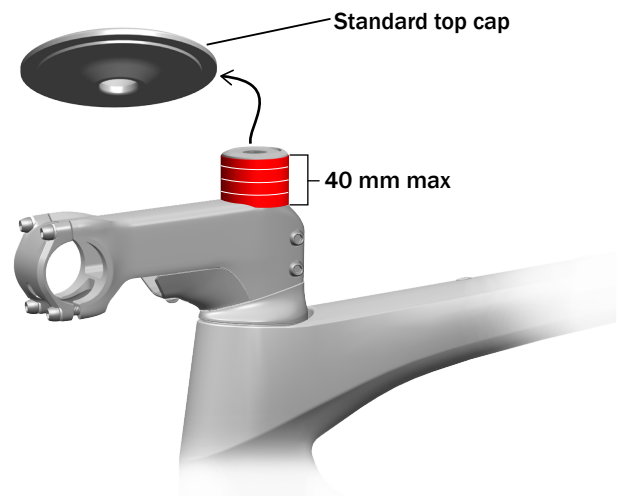

Install the fork

1. Install the compression plug in the fork.



2. Grease the fork crown race, both headset bearing bores and both bearings (13).

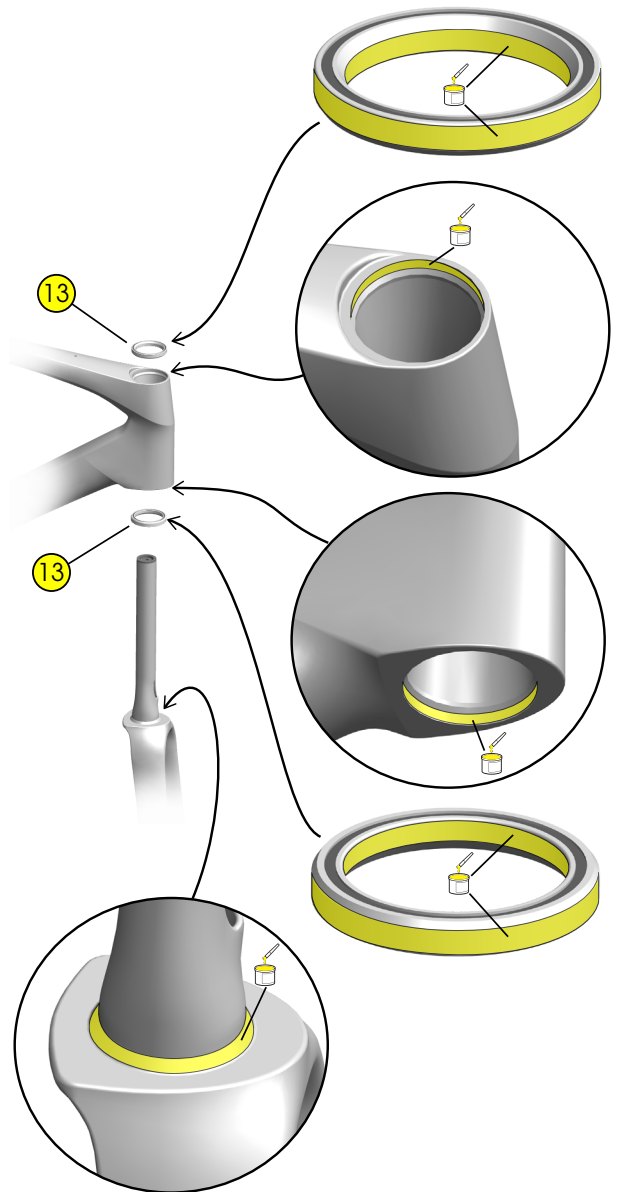

3. Insert the fork into the head tube.

TIP: Use a sprint stand to hold the fork in place.

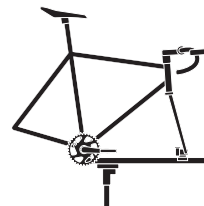

Install the headset

1. Route the headset parts down the housings.

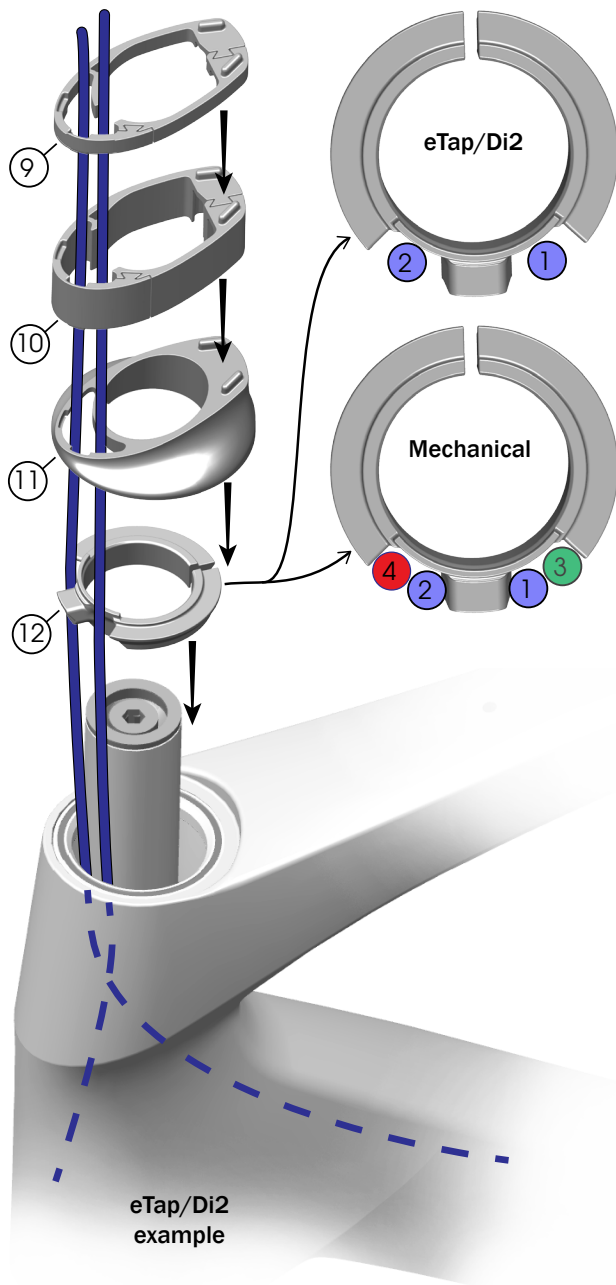

2. Loosely attach the stem (6).
3. Install the top cap (3) and tighten the top cap bolt (1).

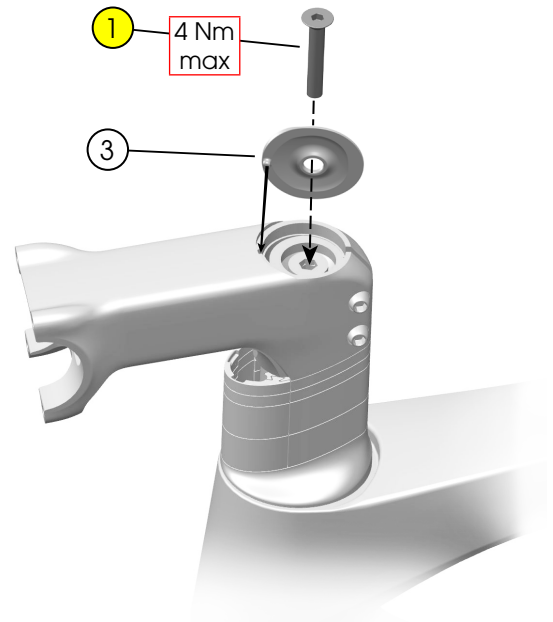

4. Tighten the stem bolts (4) – alternating between them – until both are torqued to 5.2 Nm.
5. Install the routing cover (7).

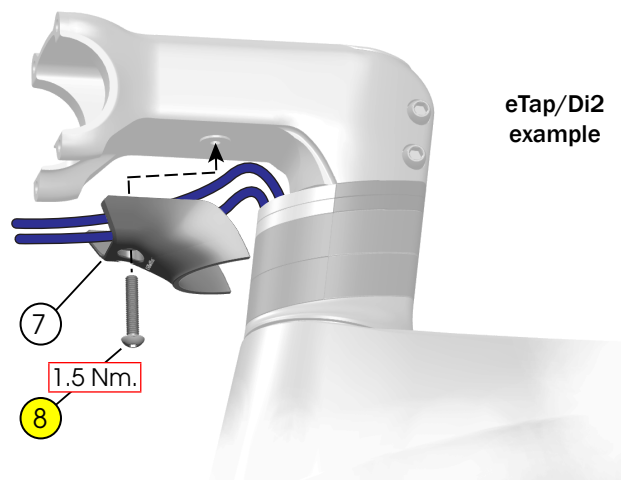

- ① Front brake hose.
- ② Rear brake hose
- ③ Front derailleur cable housing
- ④ Rear derailleur cable housing

Fork and headset – standard stem

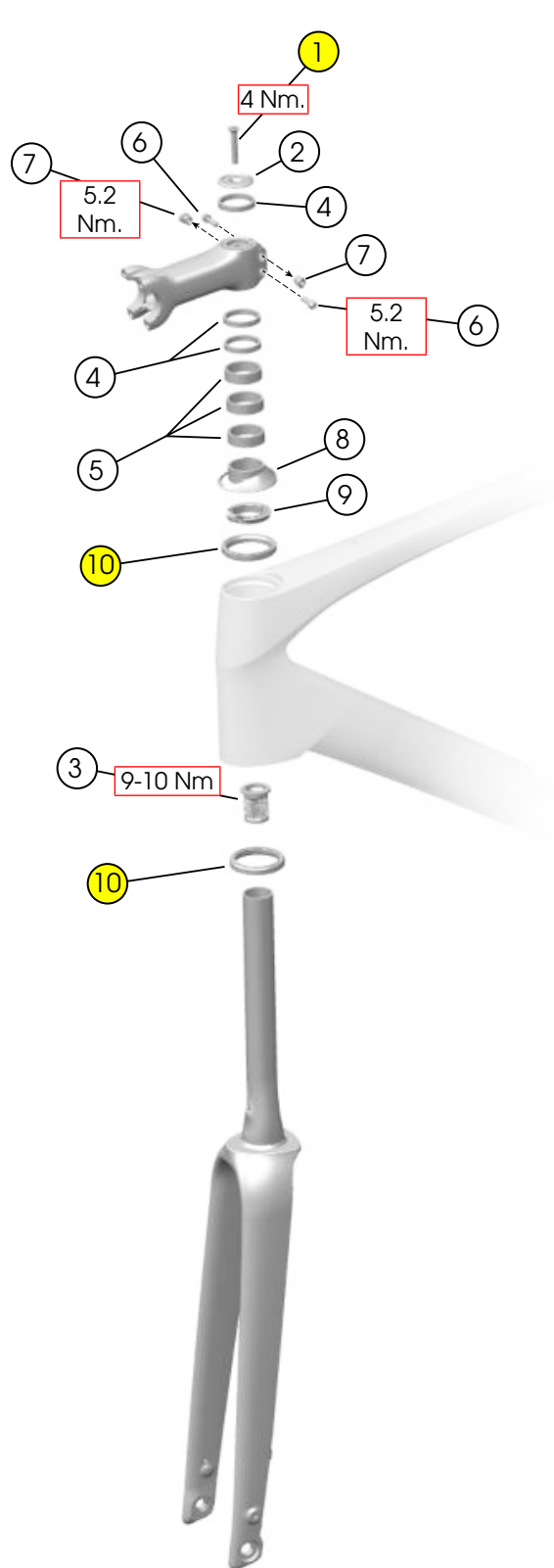

- ① Top cap bolt
- ② Top cap
- ③ Compression plug
- ④ Spacers (5 mm) – [5253930](#)
- ⑤ Spacers (10 mm) – [5253931](#)
- ⑥ Stem bolts (M5x18.5 mm)
- ⑦ D-nuts (M5)
- ⑧ Bearing cover (standard stem) – [W5274615](#)
- ⑨ Split ring – [W5274269](#)
- ⑩ Headset bearings – [W540243](#)

[W547432](#)

[5276082](#)

Seatpost

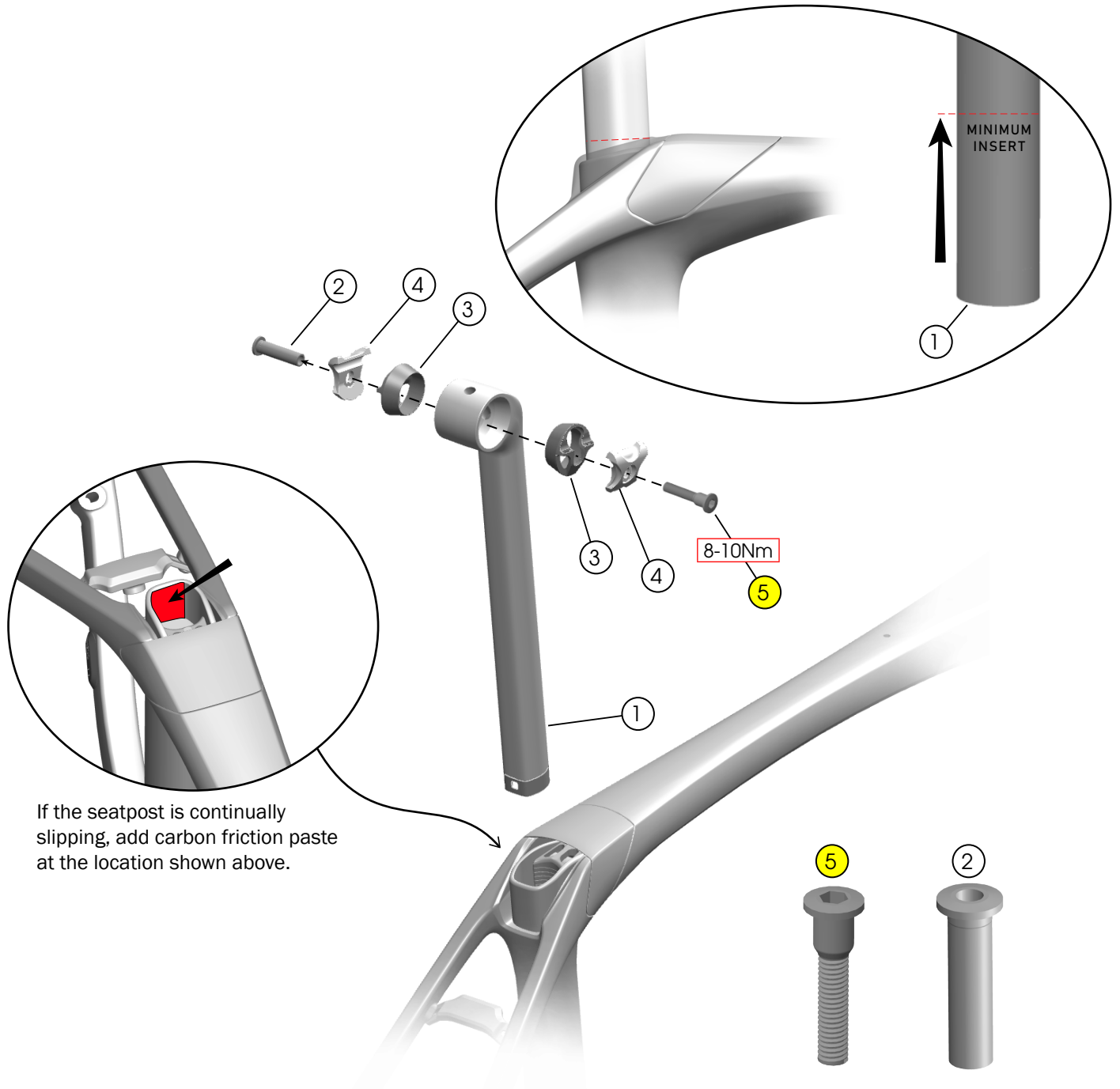

If the seatpost is continually slipping, add carbon friction paste at the location shown above.

- ① Seatpost (280mmx5mm) — [W5285077](#)
 - ② Bolt insert
 - ③ Barrels
 - ④ Saddle clamp ears (7mmx7mm) — [421564](#)
 - ⑤ Bolt (M6x16mm)
- [272628](#)

IsoSpeed

NOTICE: Do not perform routine maintenance on the IsoSpeed. Only service IsoSpeed hardware if you are replacing parts or torquing the pivot bolt (5).

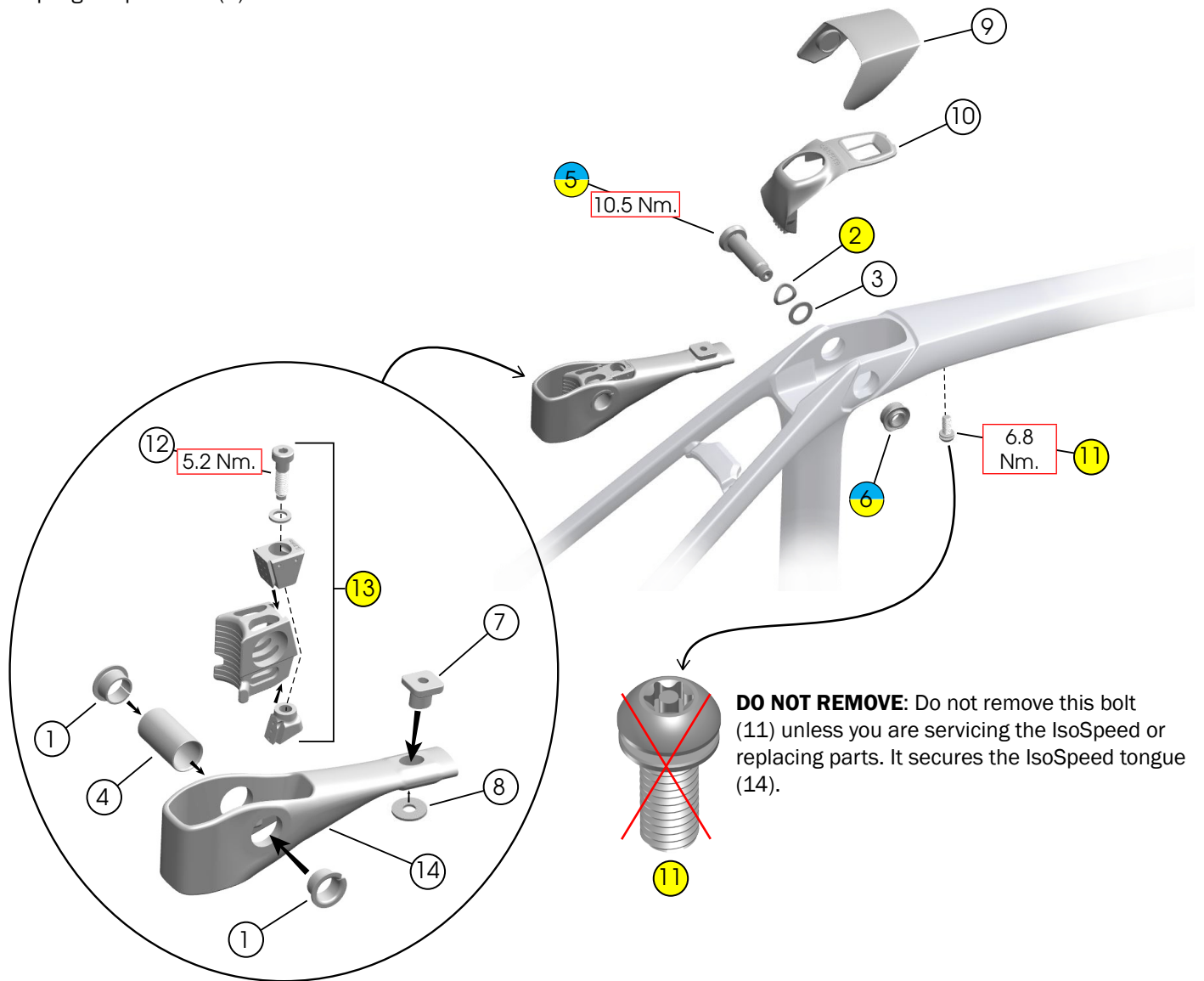

① Flanged bushings — [W5256074](#)

② Wave washer (M10)

③ Washer (M10)

④ Cylindrical bushing

⑤ Pivot bolt (M10)

⑥ Nut (M10)

⑦ T-nut — [W5260276](#)

⑧ Washer (M6) — [W5260277](#)

⑨ *IsoSpeed cover (black) — [W5297965](#)

⑩ Wedge cover — [W5269805](#)

⑪ Bolt, T25 tamper-resistant (M6x16 mm) — [W5280089](#)

⑫ Bolt (M6x22 mm)

⑬ Wedge assembly parts

⑭ IsoSpeed tongue (44-47cm) — [W5284403](#)

*This is a colour-matched part — search [trekbikes.com](#) to find the right colour for your bike.

IsoSpeed: remove parts

NOTICE: Do not perform routine maintenance on the IsoSpeed. Only service IsoSpeed hardware if you are replacing parts.

1. Remove the assembly cover (9).

NOTICE: Use your fingers to remove the cover. Do not use a tool or you could scratch the paint.

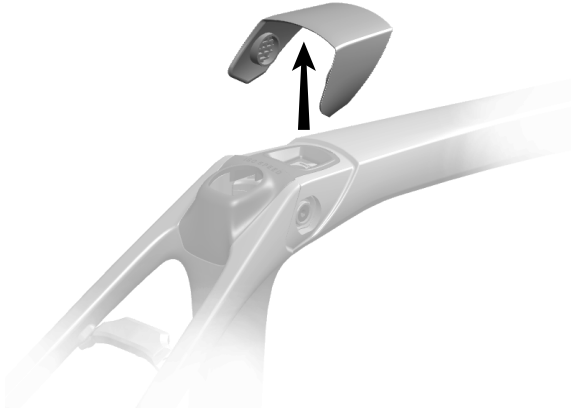

2. Remove the pivot bolt (5), washers (2, 3) and the nut (6).

NOTICE: Do not continue removing the pivot bolt (5) if the nut rotates (6) – this could damage the frame pockets. If necessary, use a shim to hold the nut (6) in place while removing the pivot bolt (5).

3. Remove the rest of the IsoSpeed parts as shown on page 14.

IsoSpeed: install parts

NOTICE: Do not perform routine maintenance on the IsoSpeed. Only service IsoSpeed hardware if you are replacing parts.

IMPORTANT: Clean all parts before reinstalling them using 50/50 isopropyl/water mix.

1. Grease the wedge assembly as shown below.

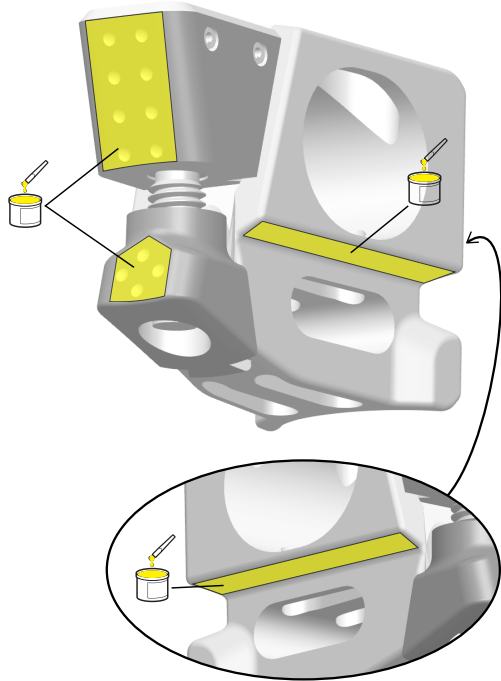

2. Assemble the tongue assembly (see page 14) and insert it into the frame. Insert and torque the bolt (11).

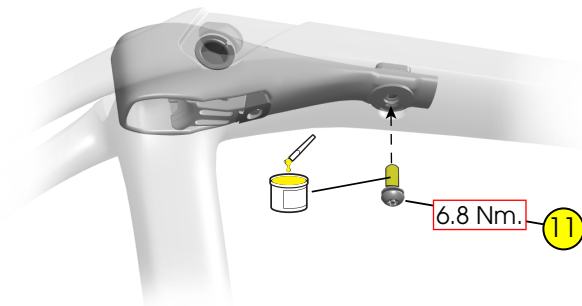

3. Apply threadlocker to the pivot bolt (5) and nut (6) threads.

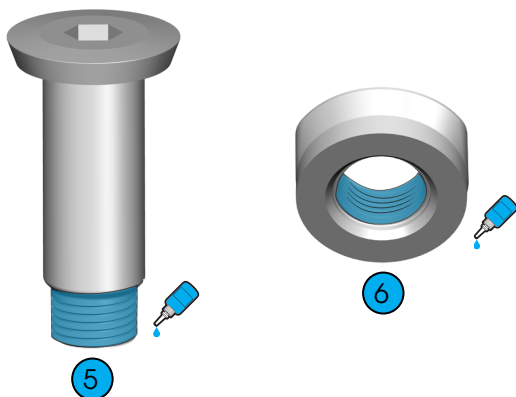

4. Place the wave washer (2) on the pivot bolt (5) and apply grease as shown below.

NOTE: Do not apply grease to the frame pockets or bushings. The grease could contact the pivot bolt threads.

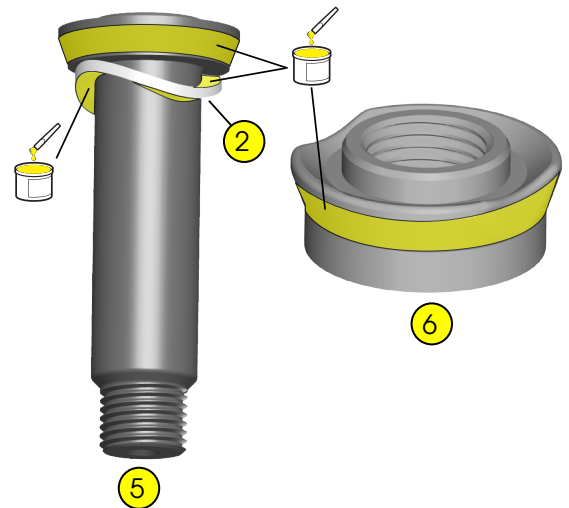

5. Install the nut (6) and pivot bolt (5). Torque the bolt to 10.5 Nm.

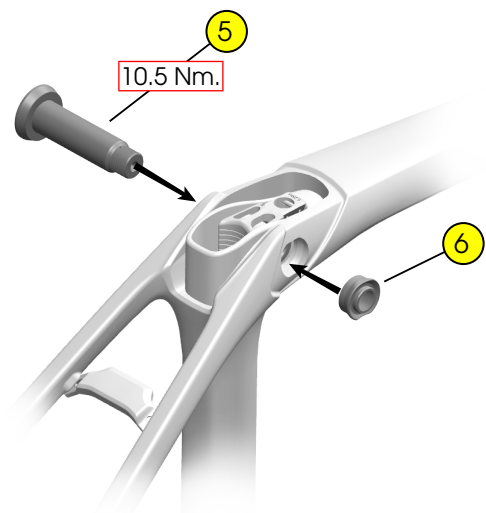

Chainkeeper

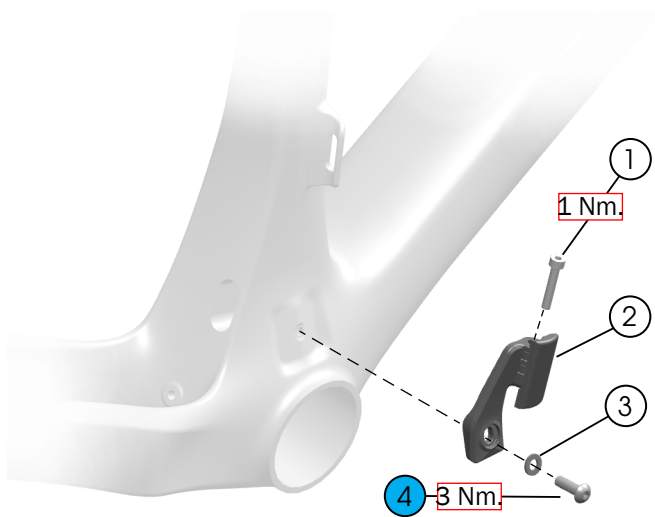

- ① Bolt (M4x22 mm)
- ② Chainkeeper
- ③ Flat washer (M5x10 mm)
- ④ Bolt (M5x16 mm)

[5305773](#)

Adjust the chainkeeper

1. Shift to the lowest gear (largest rear cassette cog) and inner chain ring.
2. Loosen the bolt (1) on the chainkeeper.
3. Rotate the loose piece (shown in red below) so there is 1 mm of horizontal clearance to the chain.

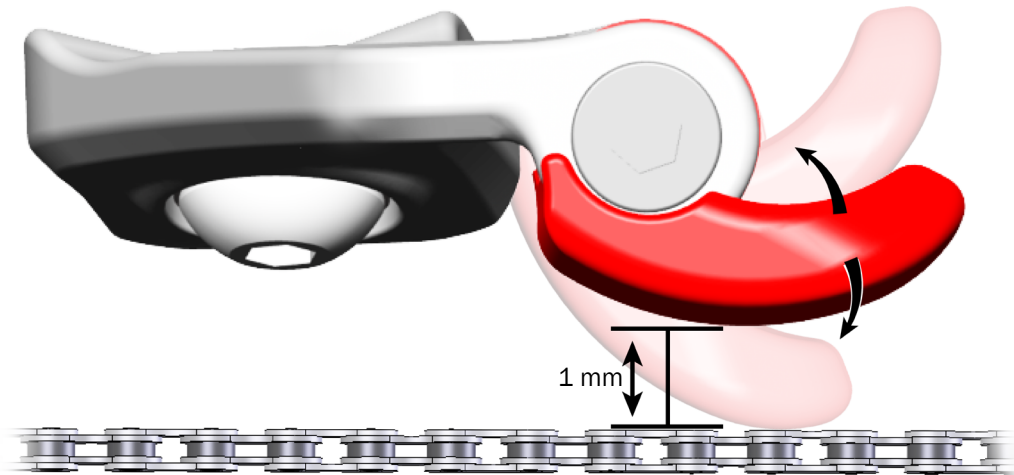

4. Tighten the bolt (1) to 1 Nm.

Storage door

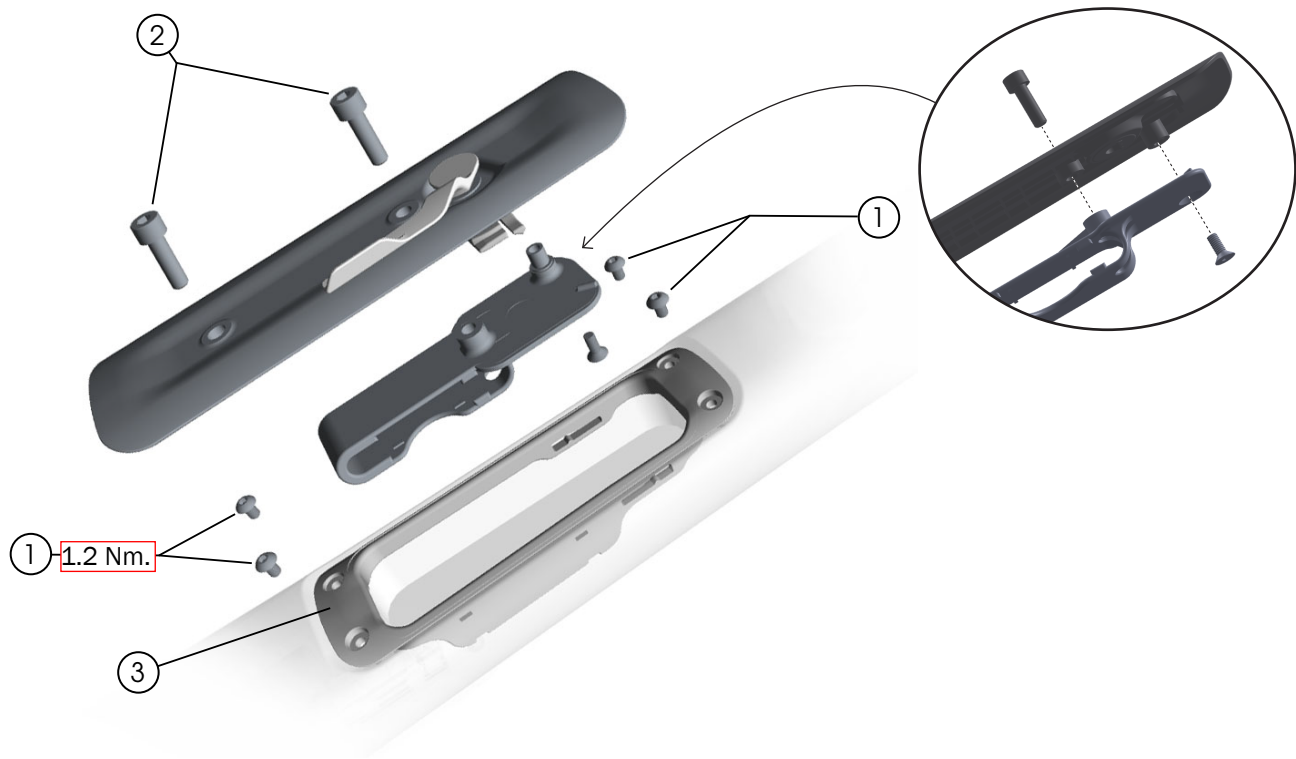

- ① Mount screws – [W547053](#)
 - ② Bolts (M5x16 mm) – [W596821](#)
 - ③ Door frame – [W580769](#)
- } Storage door kit*

*This is a colour-matched part – search trekbikes.com to find the right colour for your bike.

Specifications

Frame

	SL/SLR
Rear hub OLD	142 mm
Front hub OLD	100 mm
Upper fork steerer tube OD	28.6 mm
Lower fork steerer tube OD	38.1 mm
Bottom bracket type/width	T47/85.5 mm
Brake rotor diameter min/max	140/160 mm
Tyre width max 700c	38mm
Tyre width max 700c (with mudguards)	35 mm
Mudguard-compatible – rear	Yes
Mudguard-compatible – front	Yes

Chainline/chain ring

	Chainline	Max chain ring teeth (T)		
		Small	Large	Single (1x)
Shimano	43.5 mm	—	—	50t
	43.5 mm	36T	52T	—
SRAM	43.5 mm	—	—	50T
	43.5 mm	33T	52T	—

Brake hose lengths (calliper to lever)

NOTE: The lengths below are based on a 100 mm stem with 40 mm of headset spacers below the stem.

Frame size	Rear brake	Front brake
50cm	1,440 mm	815 mm
52 cm	1,460 mm	830 mm
54 cm	1,480 mm	845 mm
56 cm	1,500 mm	860 mm
58 cm	1,526 mm	880 mm
60 cm	1,557 mm	905 mm
62 cm	1,588 mm	930 mm

Wire lengths – Di2 (derailleur to battery)

Frame size	Rear derailleur	Front derailleur
50 cm	700 mm	250 mm
52 cm	700 mm	250 mm
54 cm	700 mm	250 mm
56 cm	700 mm	250 mm
58 cm	700 mm	250 mm
60 cm	700 mm	250 mm
62 cm	700 mm	250 mm

Housing lengths – mechanical (derailleur to lever)

Frame size	Rear derailleur	Front derailleur
50 cm	1,590 mm	1,240 mm
52 cm	1,610 mm	1,260 mm
54 cm	1,630 mm	1,280 mm
56 cm	1,650 mm	1,300 mm
58 cm	1,675 mm	1,325 mm
60 cm	1,710 mm	1,360 mm
62 cm	1,740 mm	1,390 mm