

TREK



2023 DOMANE SL/SLR

SERVICE MANUAL

Rev 1 December 2022

Contents

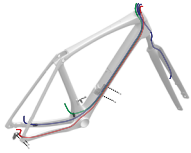
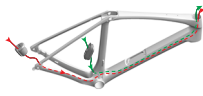
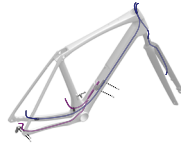
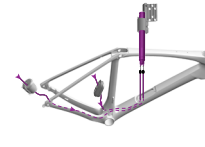
[Routing — mechanical](#)

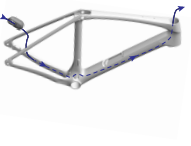
[Routing — mechanical: instructions](#)

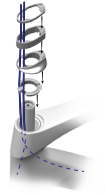
[Routing — Di2](#)

[Routing — Di2: instructions](#)

[Routing — eTap](#)

[Routing — eTap: instructions](#)

[Fork and headset](#)

[Install the headset](#)

[Fork and headset — standard stem](#)

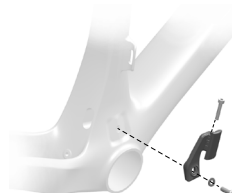
[Seatpost](#)

[IsoSpeed](#)

[IsoSpeed: remove parts and install](#)

[Chainkeeper](#)

[Storage door](#)

SL/SLR	
Rear hub BSA	142mm
Front hub BSA	142mm
Upper fork steerer tube Ø	31.8mm
Lower fork steerer tube Ø	31.8mm
Bottom bracket type / width	T47/68.5mm
Brake rotor diameter (mm)	140/160mm
max	
Tire width max (mm)	28mm
Fender compatible — rear	Yes
Fender compatible — front	Yes

Chainline	Max chainring teeth (T)		
	Small	Large	Single (T47)
Domane	43 Teeth	52T	52T
SL/SLR	43 Teeth	52T	52T

Safety

WARNING

Properly tighten hardware

Always tighten hardware to the specified torque. Over-tightening hardware could deform or break the hardware or components. Under-tightening hardware could cause hardware or components to become loose. Either situation could damage the bicycle and result in injury to the rider.

WARNING

Reapply threadlocker

All reused-fasteners with pre-applied threadlocker must be cleaned with isopropyl alcohol and have new threadlocker applied before re-assembly. If threadlocker is not applied, the fasteners may loosen which could damage the bicycle and result in injury to the rider.

Legend



Apply appropriate grease



Apply threadlocker



Torque



Cable (zip) tie

Routing — mechanical

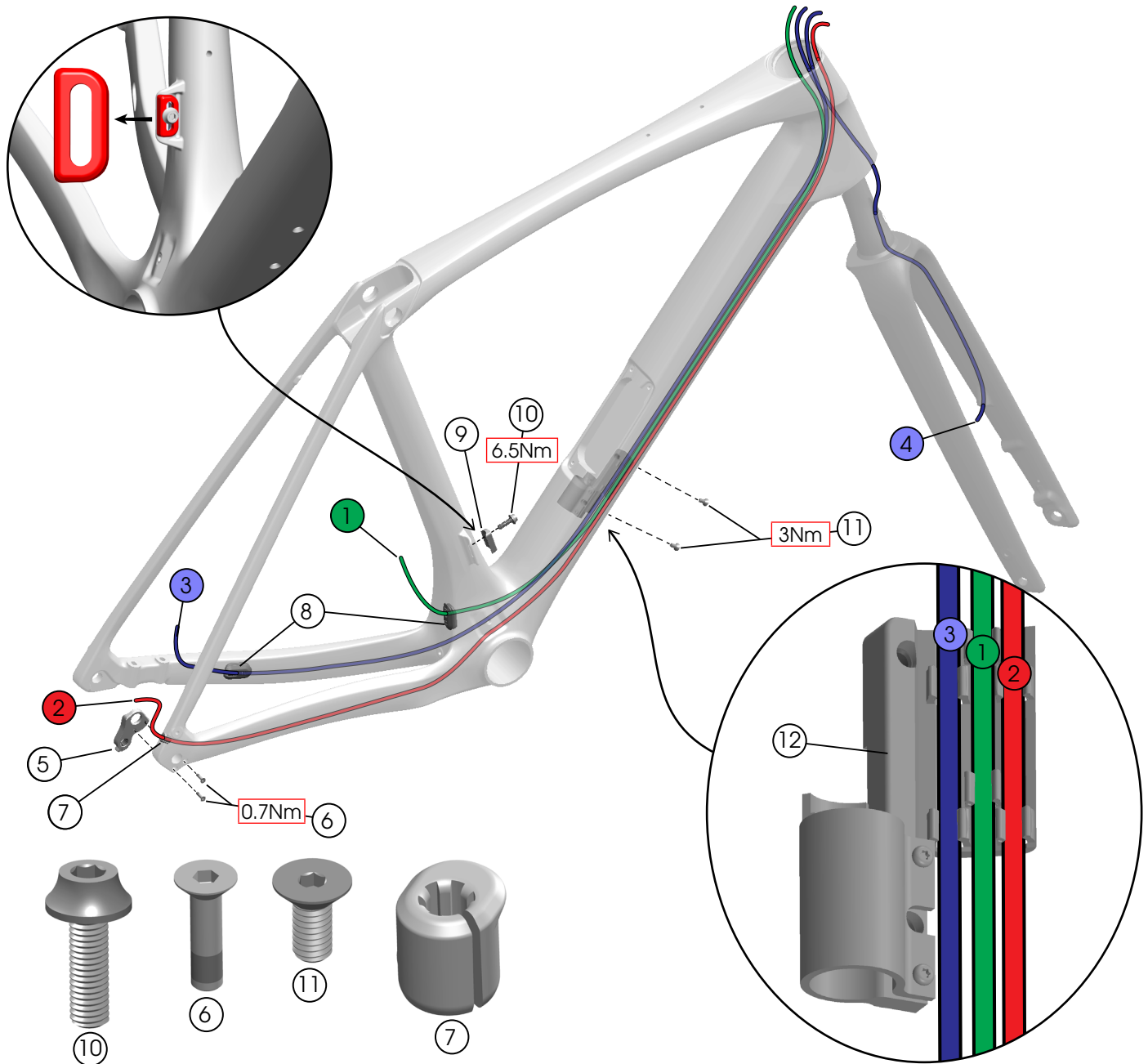

- | | |
|--|--|
| ① Front derailleur cable | ⑦ Cable housing grommet — W329119 |
| ② Rear derailleur cable | ⑧ Housing grommets — W330578 |
| ③ Rear brake hose | ⑨ Front derailleur hanger — W531901 |
| ④ Front brake hose | ⑩ Front derailleur hanger bolt (M5x16mm) — W543903 |
| ⑤ Rear derailleur hanger — W524188 | ⑪ Cable guide bolts (M4x9mm) — W546731 |
| ⑥ Rear derailleur hanger bolts (M3x12mm) — W524884 | ⑫ Cable guide — W588188 |

Routing — mechanical: instructions

1. Route the brake hoses.

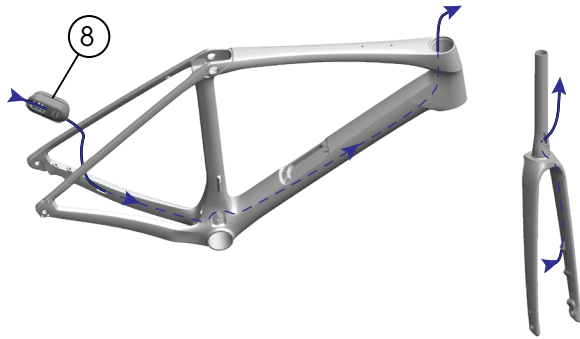

2. Route the shift housings.

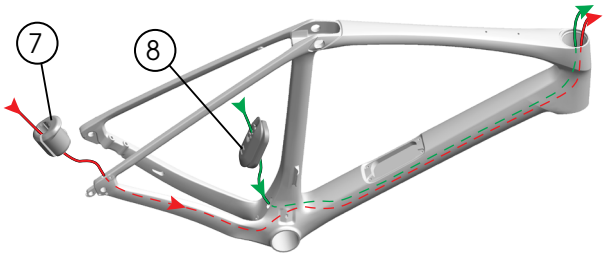

3. Insert the shift housings and rear brake hose into the cable guide.

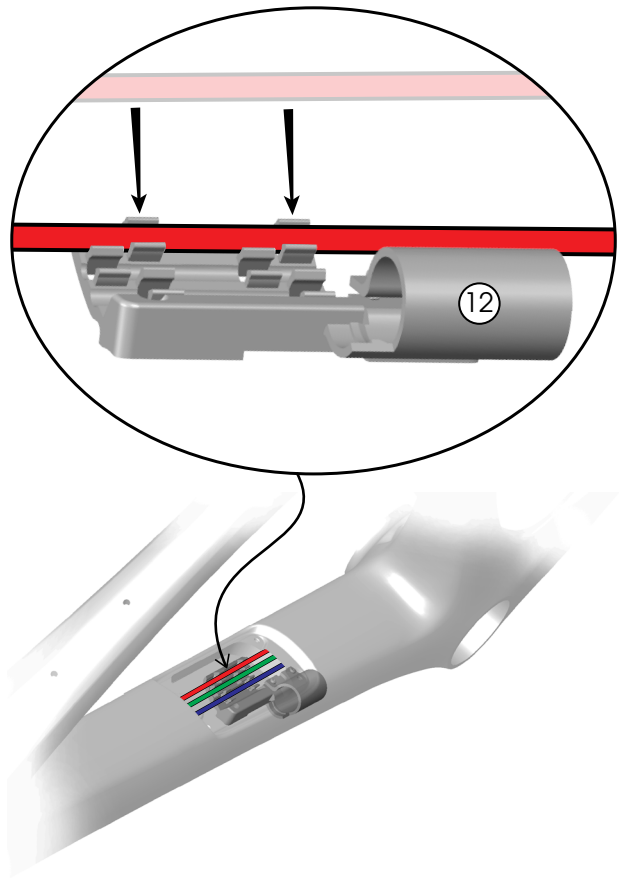

Routing — Di2

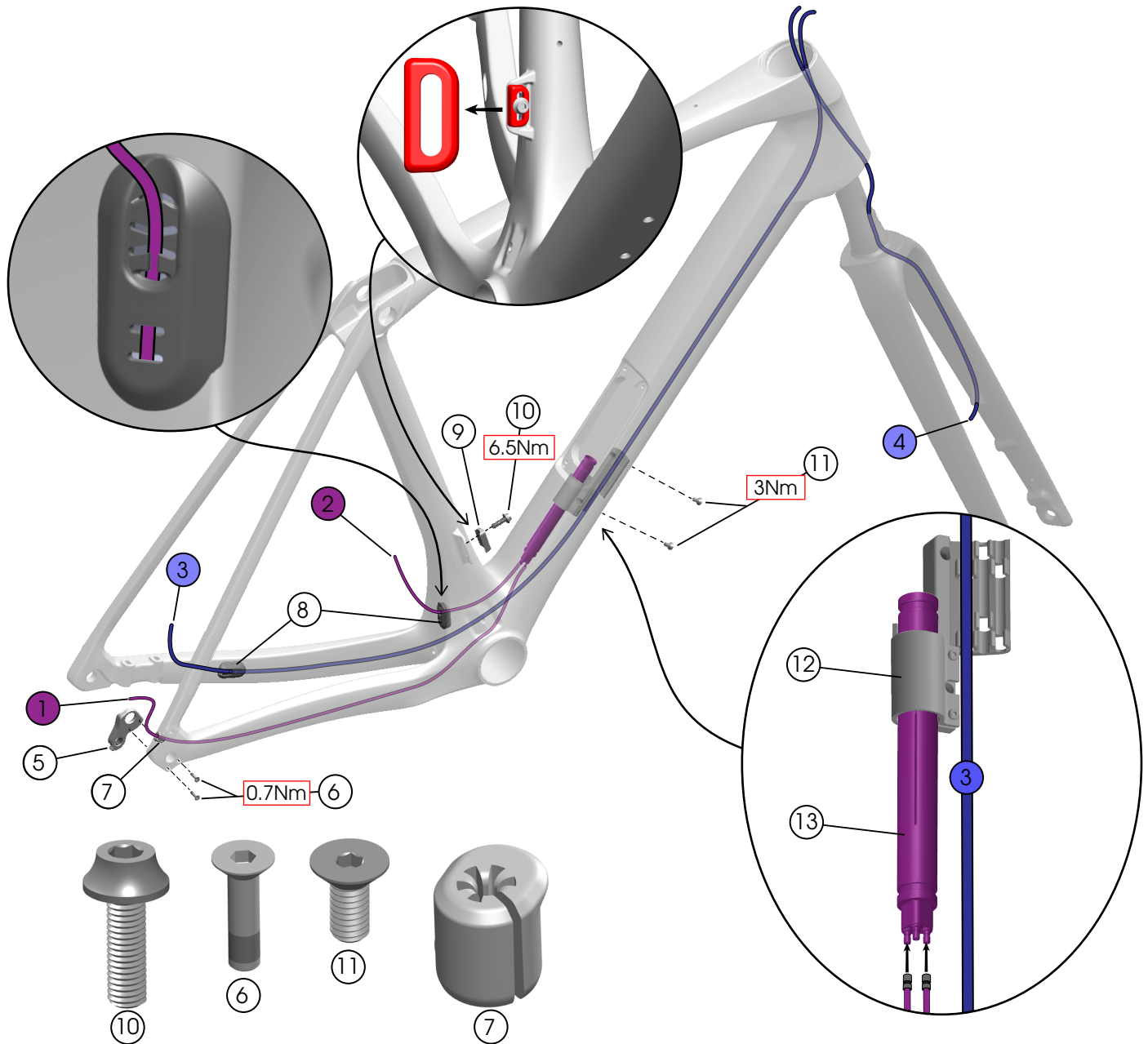

- | | | |
|--|--------------|--|
| ① Rear Di2 wire | } EW-SD300-I | ⑧ Housing grommets — W330578 |
| ② Front Di2 wire | | ⑨ Front derailleur hanger — W531901 |
| ③ Rear brake hose | | ⑩ Front derailleur hanger bolt (M5x16mm) — W543903 |
| ④ Front brake hose | | ⑪ Cable guide bolts (M4x9mm) — W546731 |
| ⑤ Rear derailleur hanger — W524188 | | ⑫ Cable guide — W588188 |
| ⑥ Rear derailleur hanger bolts (M3x12mm) — W524884 | | ⑬ Di2 battery — BTDN300 |
| ⑦ Di2 wire grommet — W317292 | | |

Routing — Di2: instructions

1. Route the brake hoses.

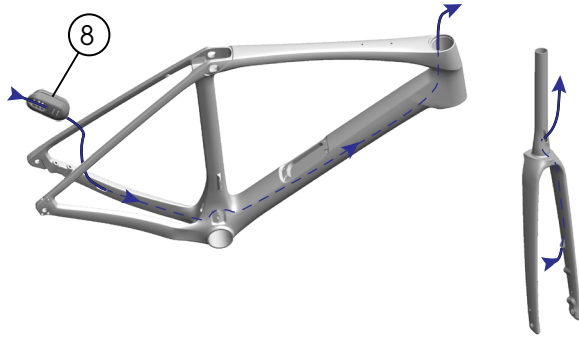

2. Route the Di2 wires through the frame and connect them to the battery.

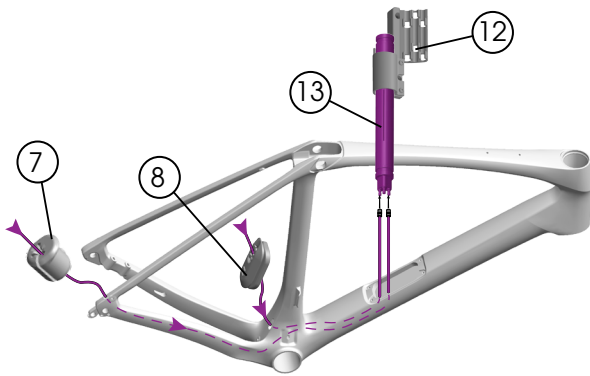

3. Install the battery assembly.

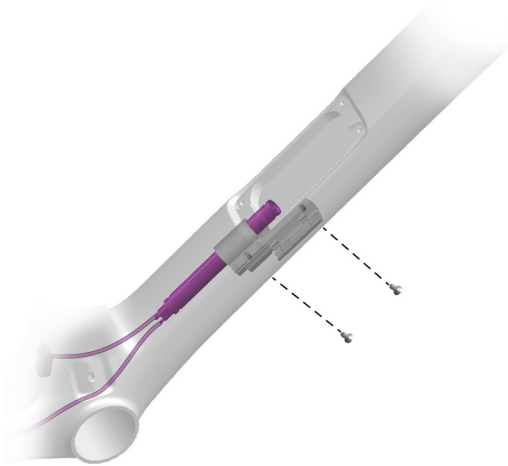

4. Insert the rear brake hose into the cable guide

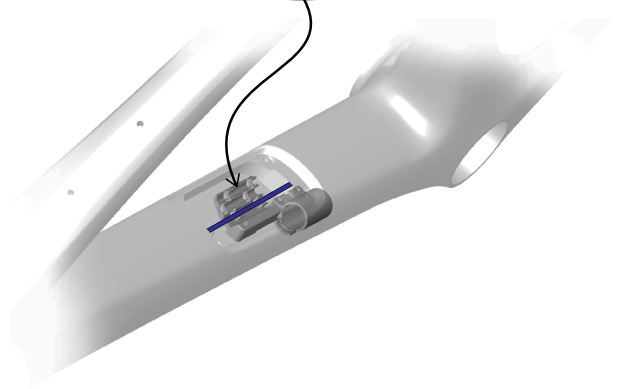
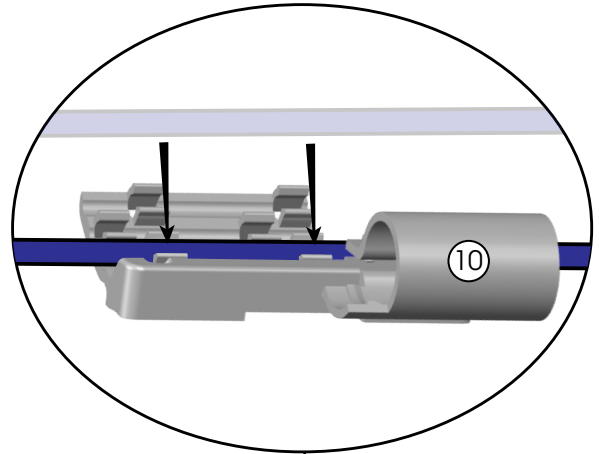

Routing — eTap

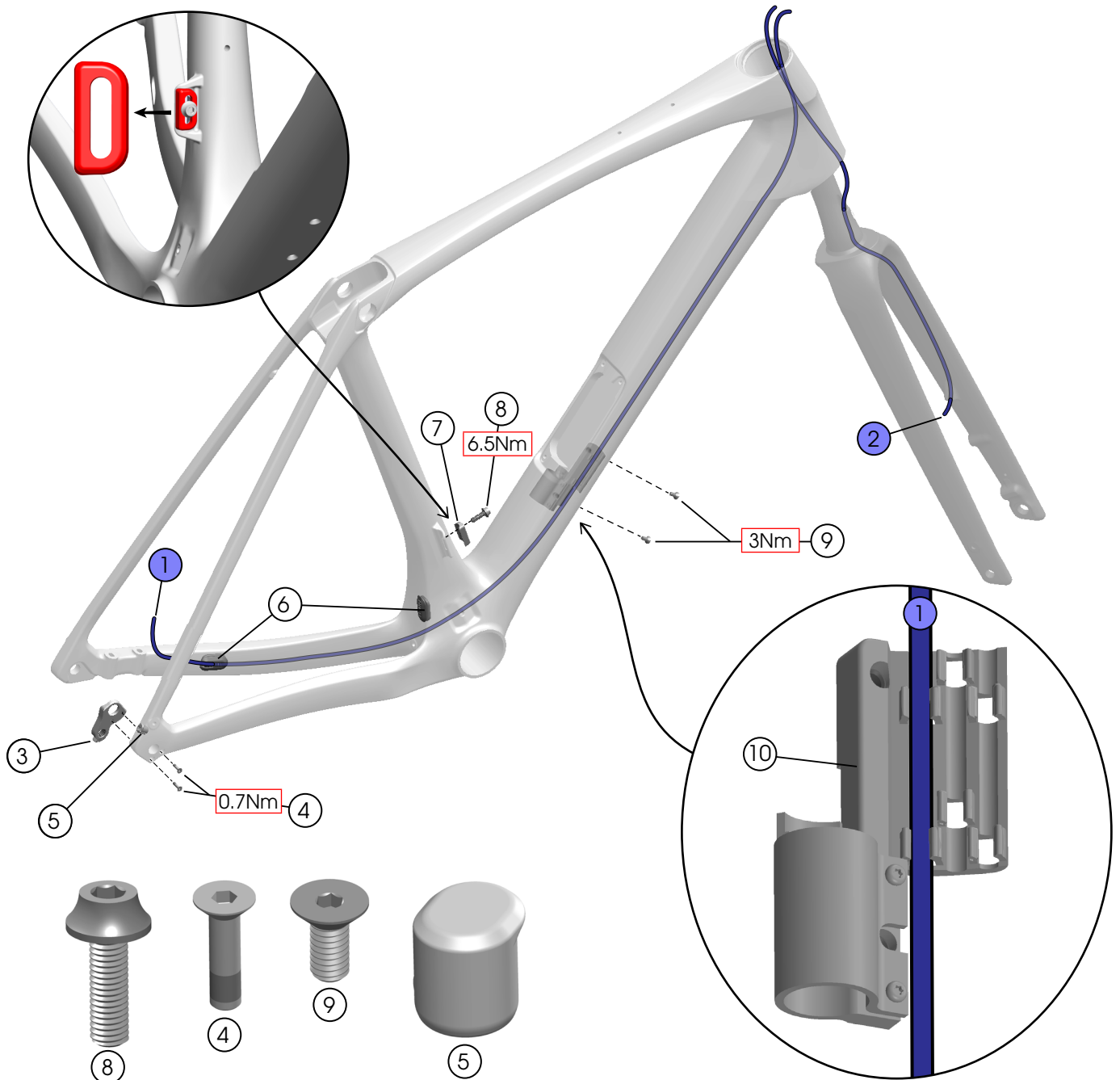

- ① Rear brake hose
- ② Front brake hose
- ③ Rear derailleur hanger — [W524188](#)
- ④ Rear derailleur hanger bolts (M3x12mm) — [W524884](#)
- ⑤ eTap hole plug — [W547906](#)
- ⑥ Housing grommets — [W330578](#)
- ⑦ Front derailleur hanger — [W531901](#)
- ⑧ Front derailleur hanger bolt (M5x16mm) — [W543903](#)
- ⑨ Cable guide bolts (M4x9mm) — [W546731](#)
- ⑩ Cable guide — [W588188](#)

Routing — eTap: instructions

1. Route the brake hoses.

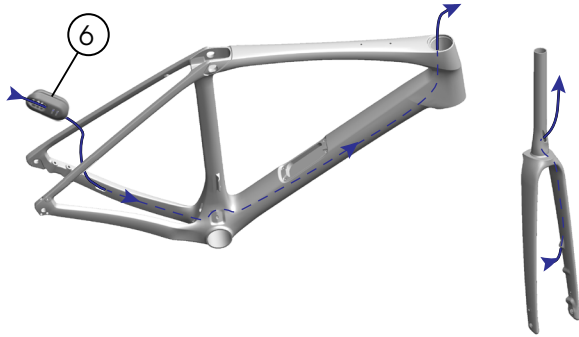

2. Insert the rear brake hose into the cable guide.

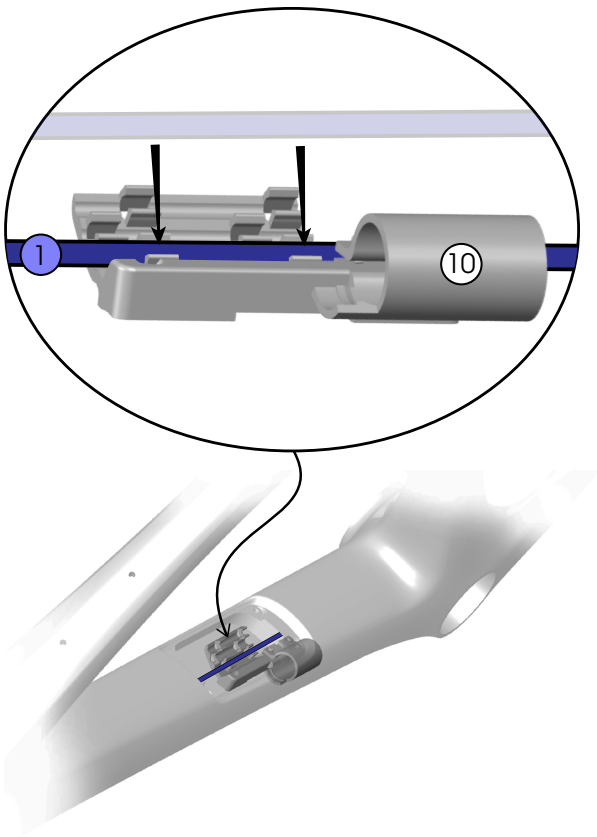

Fork and headset

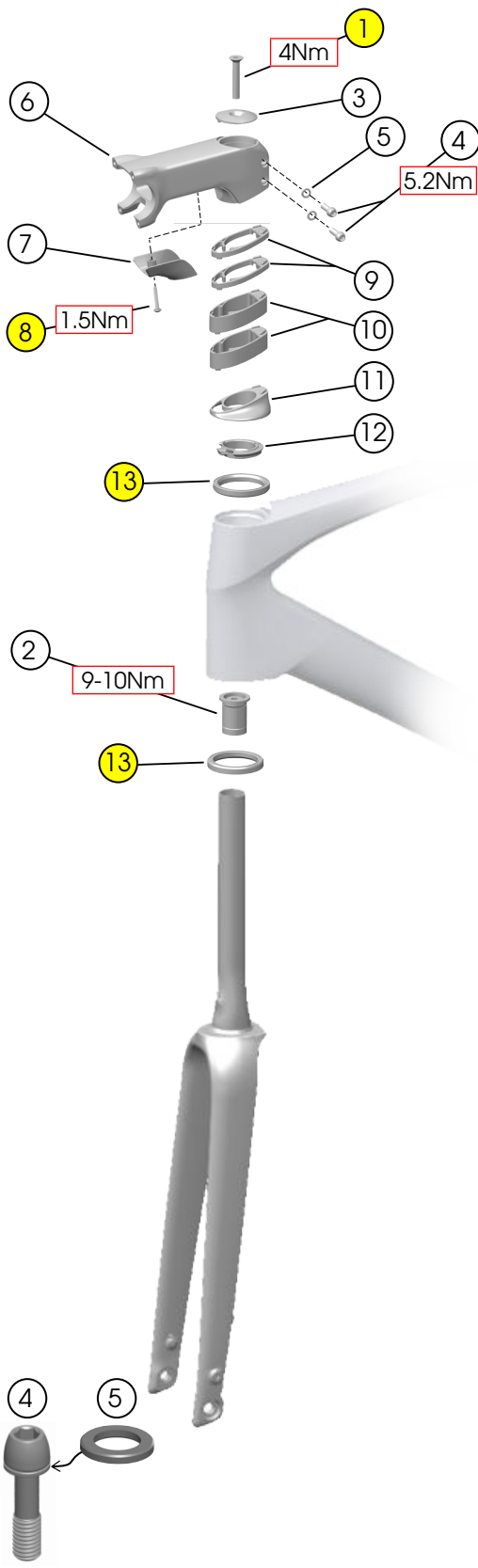

- ① Top cap bolt (M6x35mm) } [W547432](#)
- ② Compression plug
- ③ Top cap — [W5274966](#)
- ④ Stem bolts (M5x15mm) } [5305331](#)
- ⑤ Washers (M5)
- ⑥ Stem — [5274584](#)
- ⑦ Routing cover — [W5274600](#)
- ⑧ Bolt (M4x25mm) — [W5274963](#)
- ⑨ Spacers (5mm) — [5296906](#)
- ⑩ Spacers (15mm) — [5296905](#)
- ⑪ Bearing cover — [W5274267](#)
- ⑫ Split ring — [W5274269](#)
- ⑬ Headset bearings — [W540243](#)

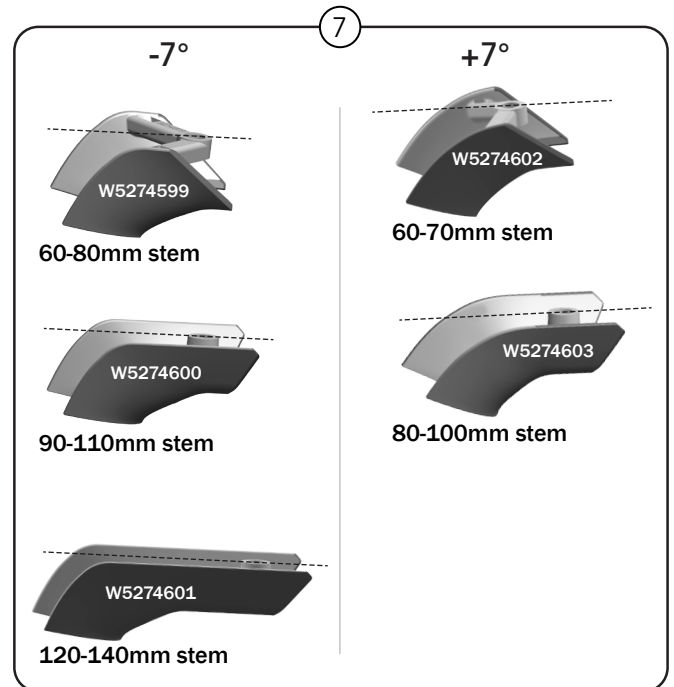

Fork and headset: max spacers

WARNING

Below the stem

Do not exceed 40mm of headset spacers below the stem. If there are more than 40mm of spacers, the steerer tube could become damaged and break, causing a crash resulting in injury.

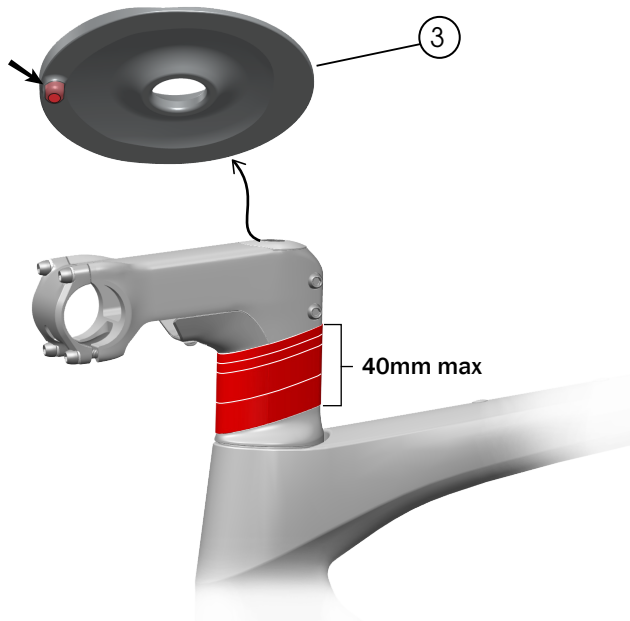

WARNING

Above the stem

Do not exceed 40mm of headset spacers above the stem. If there are more than 40mm of spacers, the steerer tube could become damaged and break, causing a crash resulting in injury.

NOTE: If you add spacers above the stem, you must use a standard top cap (without the indent).

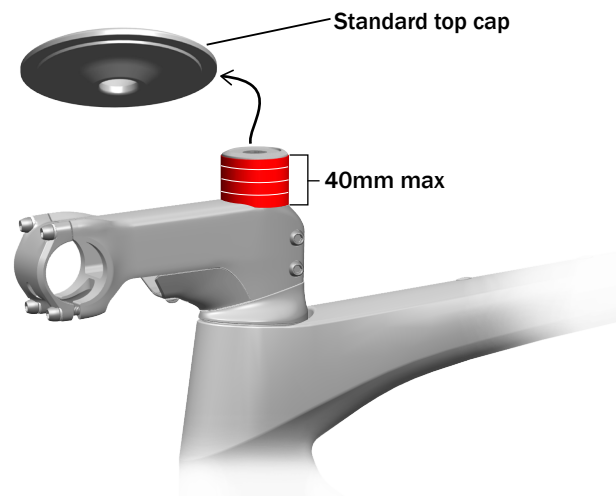

Install the fork

1. Install the compression plug in the fork.



2. Grease the fork crown race, both headset bearing bores, and both bearings (13).

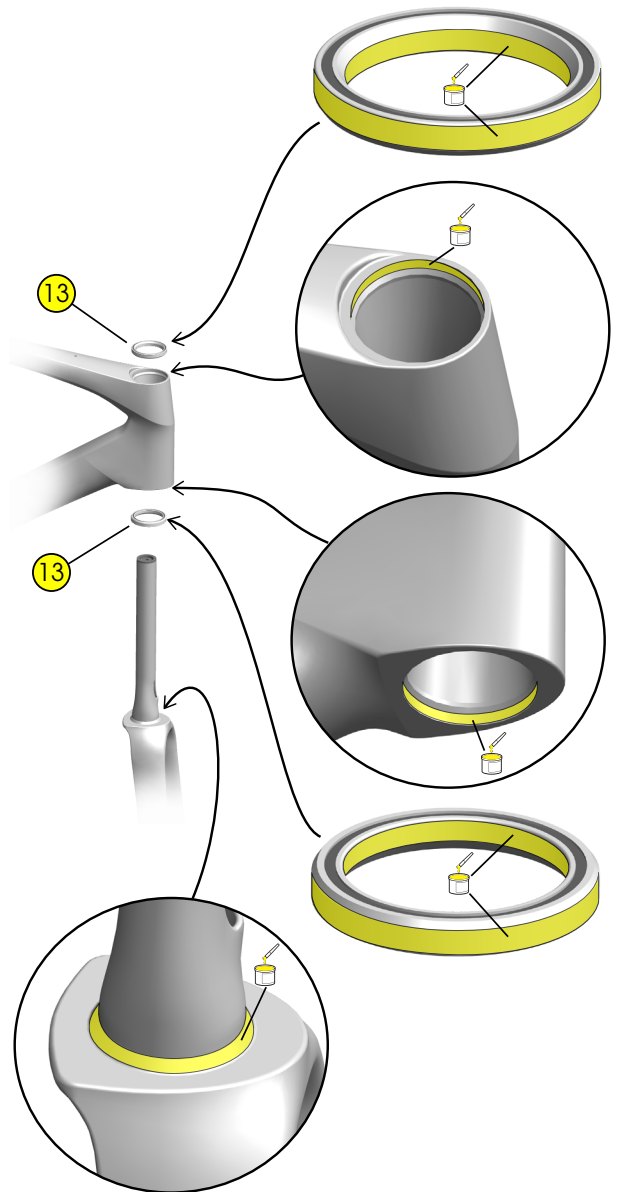

3. Insert the fork into the head tube.

TIP: Use a sprint stand to hold the fork in place.

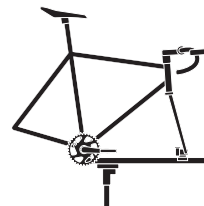

Install the headset

1. Route the headset parts down the housings.

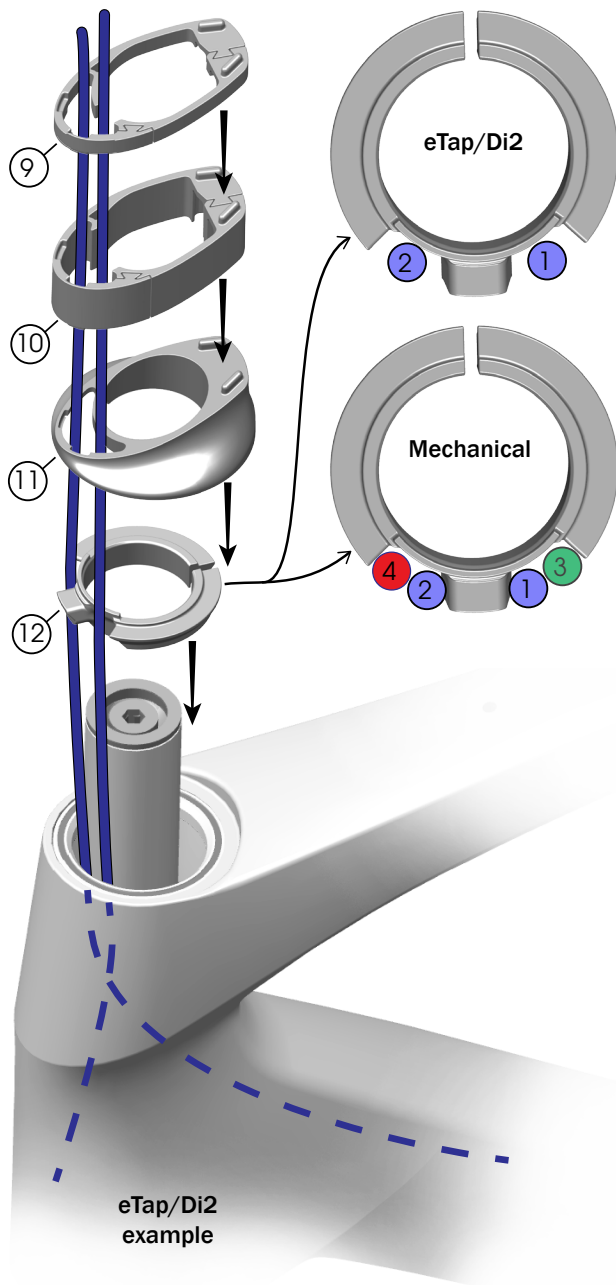

eTap/Di2
example

- ① Front brake hose
- ② Rear brake hose
- ③ Front derailleur cable housing
- ④ Rear derailleur cable housing

2. Loosely attach the stem (6).
3. Install the top cap (3) and tighten the top cap bolt (1).

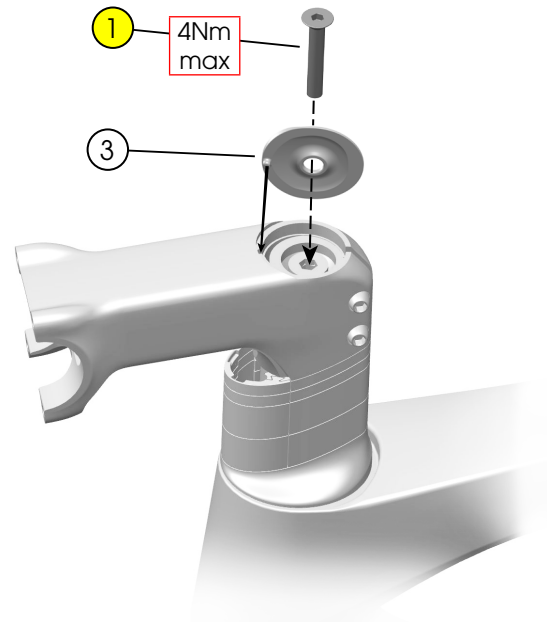

4. Tighten the stem bolts (4) — alternating between them — until both are torqued to 5.2Nm.
5. Install the routing cover (7).

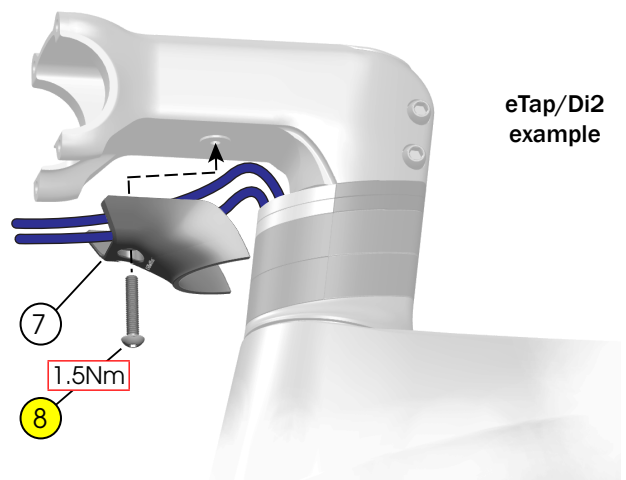

eTap/Di2
example

Fork and headset — standard stem

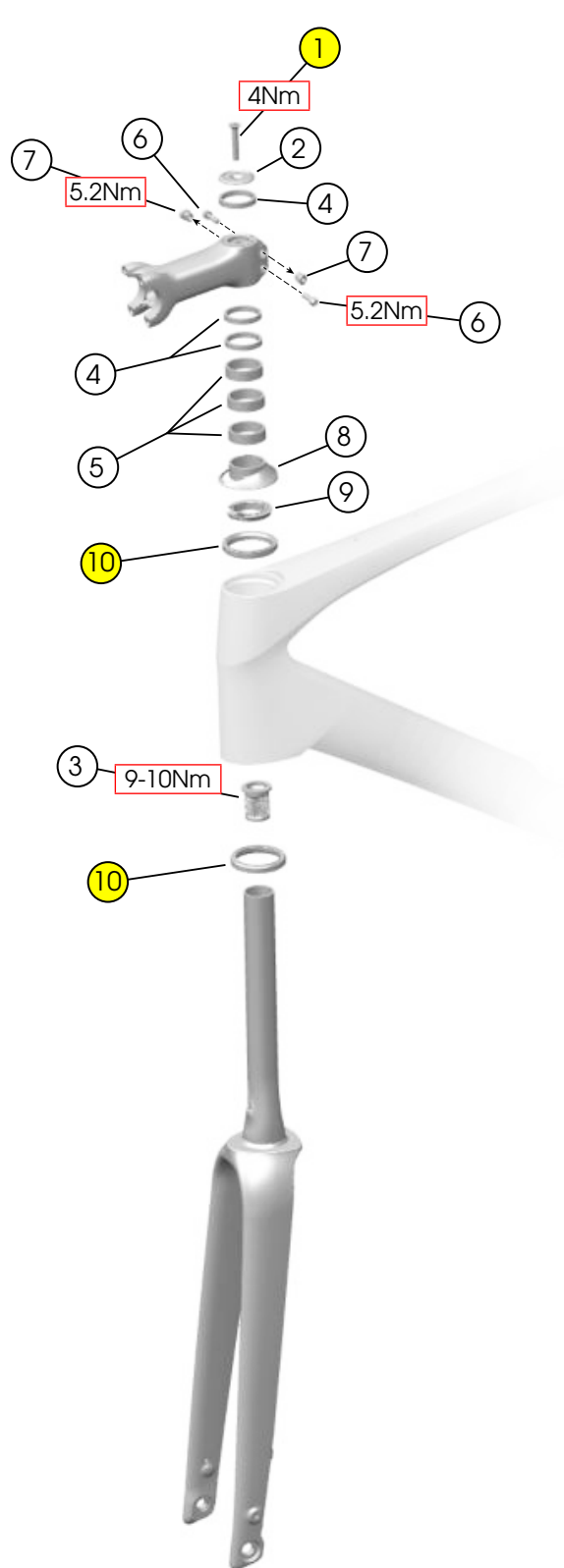

- ① Top cap bolt
- ② Top cap
- ③ Compression plug
- ④ Spacers (5mm) — [5253930](#)
- ⑤ Spacers (10mm) — [5253931](#)
- ⑥ Stem bolts (M5x18.5mm)
- ⑦ D-nuts (M5)
- ⑧ Bearing cover (standard stem) — [W5274615](#)
- ⑨ Split ring — [W5274269](#)
- ⑩ Headset bearings — [W540243](#)

Seatpost

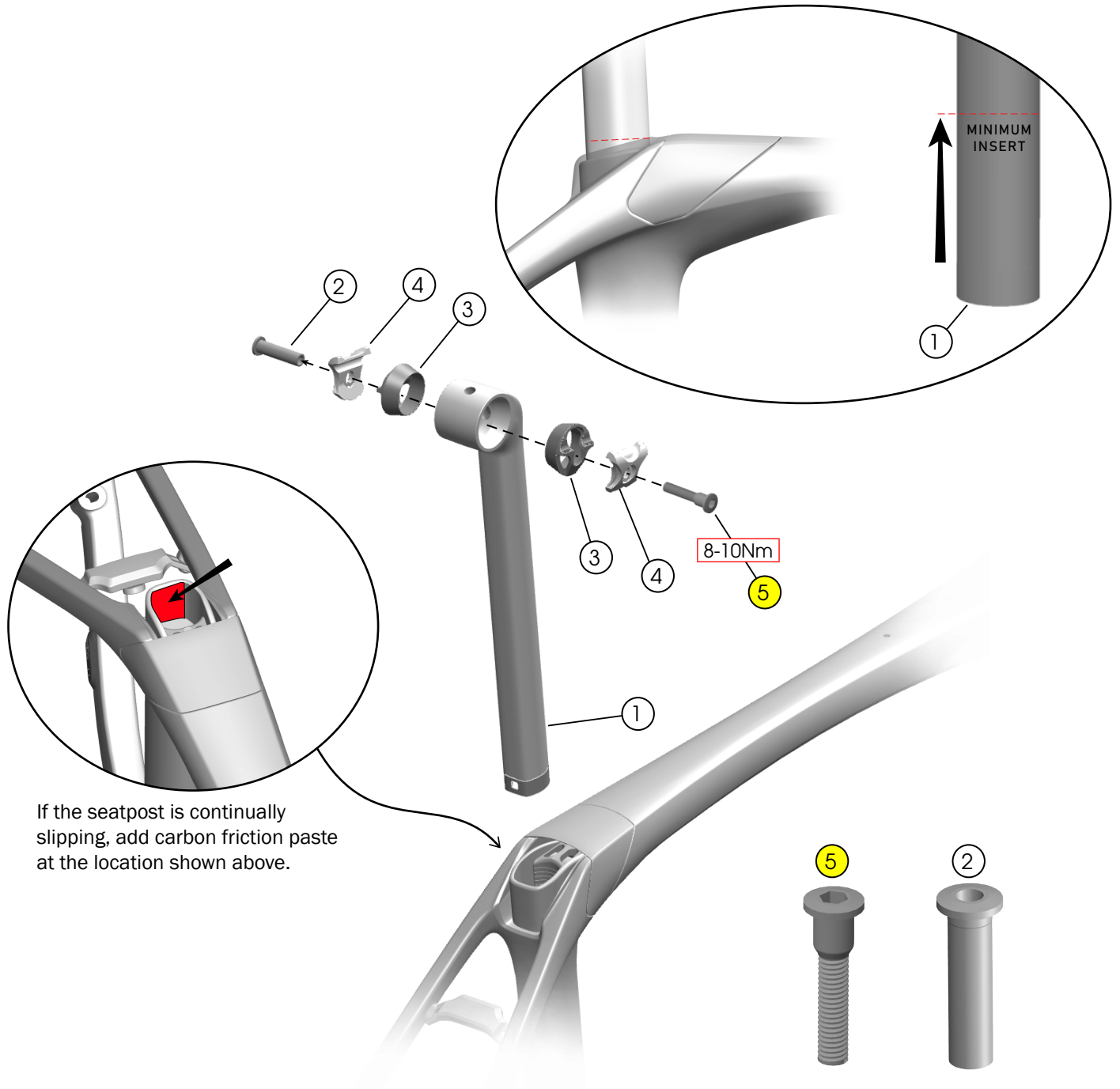

If the seatpost is continually slipping, add carbon friction paste at the location shown above.

- ① Seatpost (280mmx5mm) — [W5285077](#)
 - ② Bolt insert
 - ③ Barrels
 - ④ Saddle clamp ears (7mmx7mm) — [421564](#)
 - ⑤ Bolt (M6x16mm)
- [272628](#)

IsoSpeed

NOTICE: Do not perform routine maintenance on the IsoSpeed. Only service IsoSpeed hardware if you are replacing parts or torquing the pivot bolt (5).

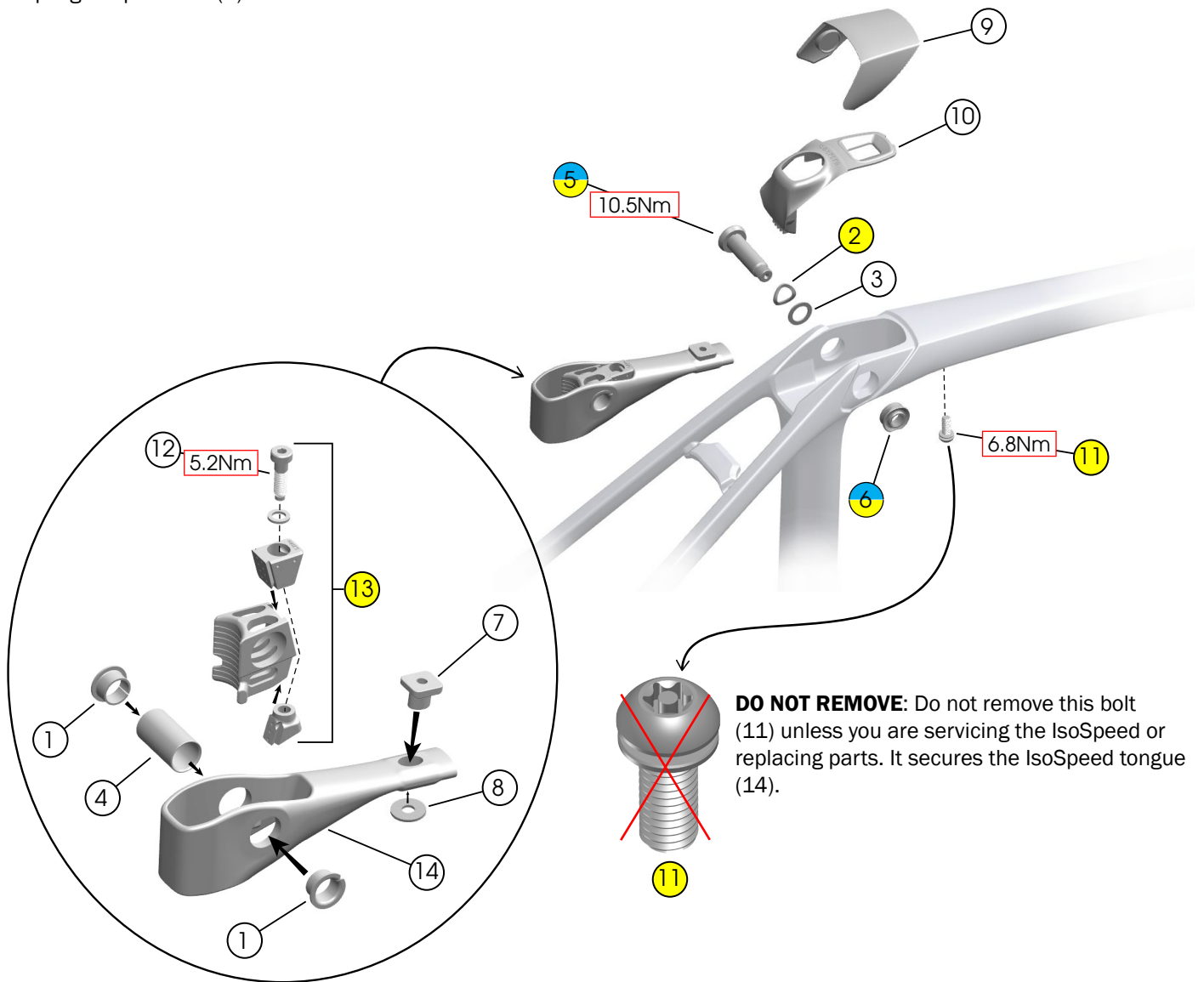

① Flanged bushings — [W5256074](#)

② Wave washer (M10)

③ Washer (M10)

④ Cylindrical bushing

⑤ Pivot bolt (M10)

⑥ Nut (M10)

⑦ T-nut — [W5260276](#)

⑧ Washer (M6) — [W5260277](#)

⑨ *IsoSpeed cover (black) — [W5297965](#)

⑩ Wedge cover — [W5269805](#)

⑪ Bolt, T25 tamper-resistant (M6x16mm) — [W5280089](#)

⑫ Bolt (M6x22mm)

⑬ Wedge assembly parts

⑭ IsoSpeed tongue (44-47cm) — [W5284403](#)

*This is a color-matched part — search trekbikes.com to find the right color for your bike.

IsoSpeed: remove parts

NOTICE: Do not perform routine maintenance on the IsoSpeed. Only service IsoSpeed hardware if you are replacing parts.

1. Remove the assembly cover (9).

NOTICE: Use your fingers to remove the cover. Do not use a tool or you could scratch the paint.

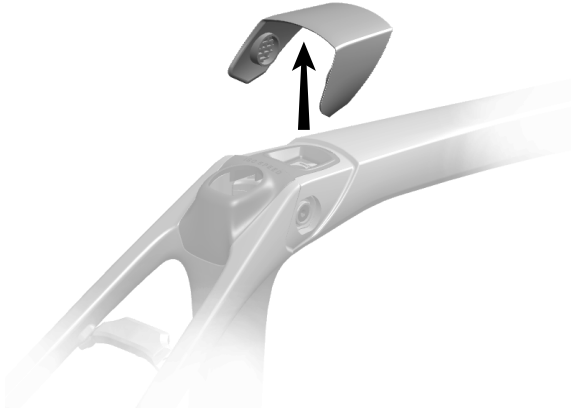

2. Remove the pivot bolt (5), washers (2, 3), and the nut (6).

NOTICE: Do not continue removing the pivot bolt (5) if the nut rotates (6) — this could damage the frame pockets. If necessary, use a shim to hold the nut (6) in place while removing the pivot bolt (5).

3. Remove the rest of the IsoSpeed parts as shown on page 14.

IsoSpeed: install parts

NOTICE: Do not perform routine maintenance on the IsoSpeed. Only service IsoSpeed hardware if you are replacing parts.

IMPORTANT: Clean all parts before reinstalling them using 50/50 isopropyl/water mix.

1. Grease the wedge assembly as shown below.

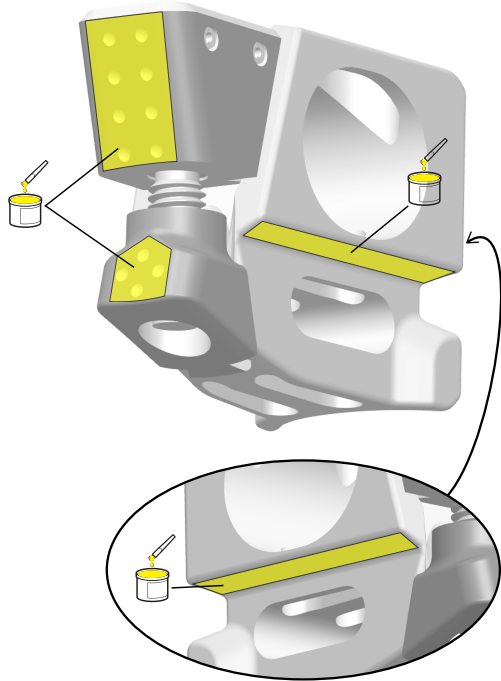

2. Assemble the tongue assembly (see page 14) and insert it into the frame. Insert and torque the bolt (11).

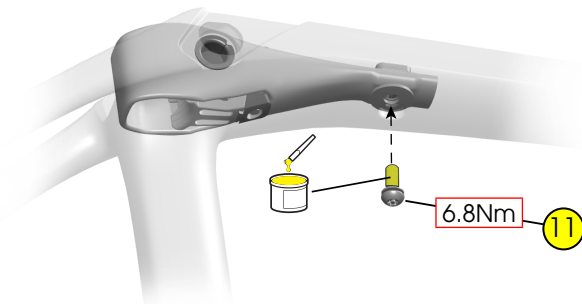

3. Apply threadlocker to the pivot bolt (5) and nut (6) threads.

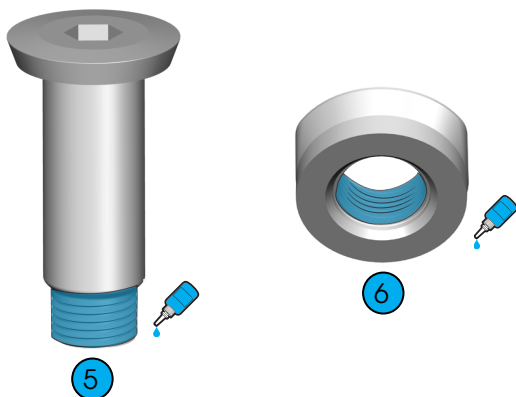

4. Place the wave washer (2) on the pivot bolt (5) and apply grease as shown below.

NOTE: Do not apply grease to the frame pockets or bushings. The grease could contact the pivot bolt threads.

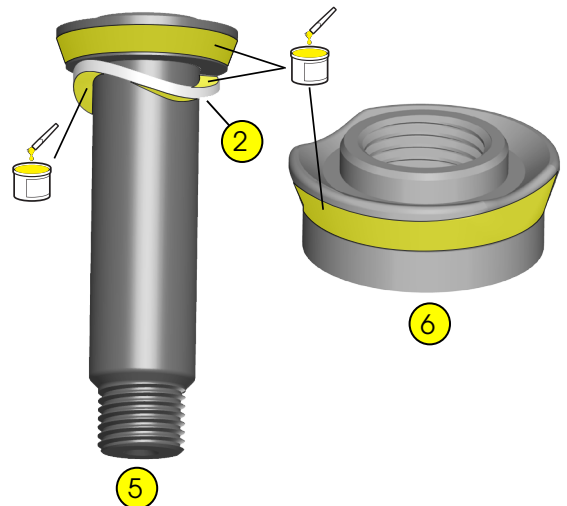

5. Install the nut (6) and pivot bolt (5). Torque the bolt to 10.5 Nm.

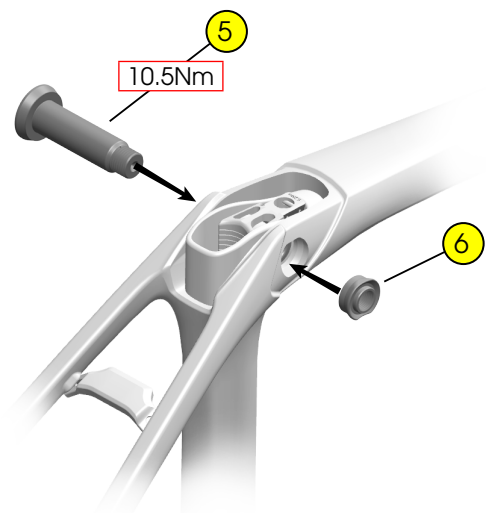

Chainkeeper

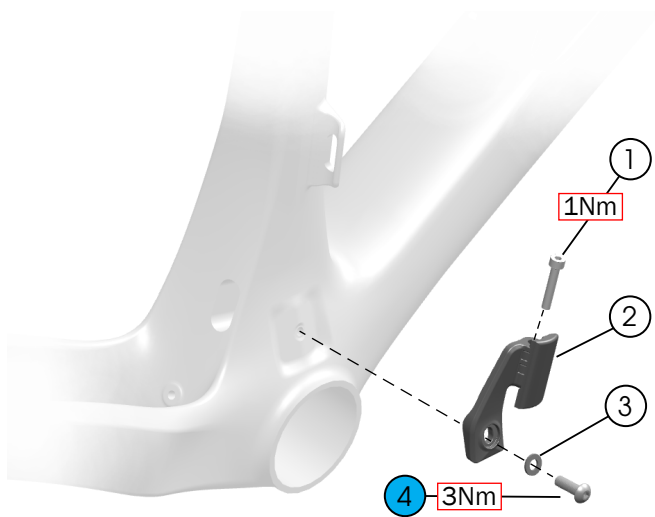

- ① Bolt (M4x22mm)
- ② Chainkeeper
- ③ Flat washer (M5x10mm)
- ④ Bolt (M5x16mm)

[5305773](#)

Adjust the chainkeeper

1. Shift to the lowest gear (largest rear cassette cog) and inner chainring.
2. Loosen the bolt (1) on the chainkeeper.
3. Rotate the loose piece (shown in red below) so there is 1mm of horizontal clearance to the chain.

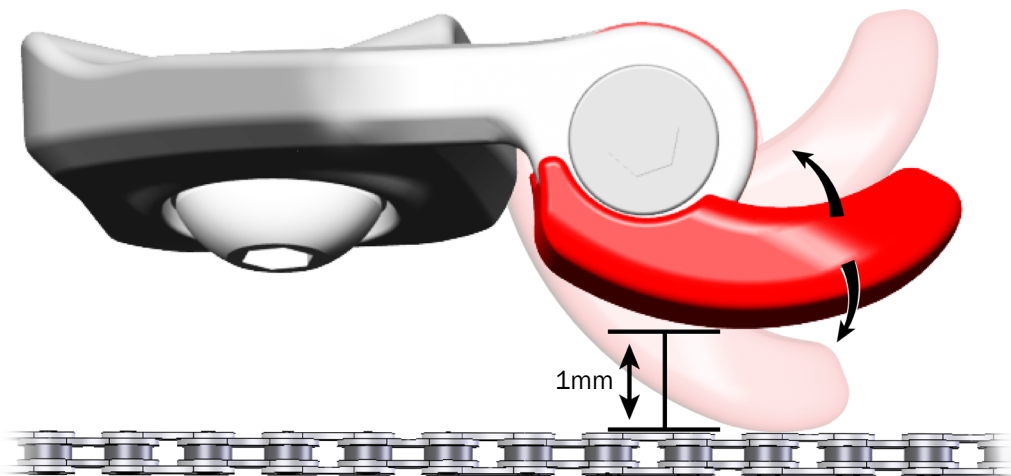

4. Tighten the bolt (1) to 1Nm.

Storage door

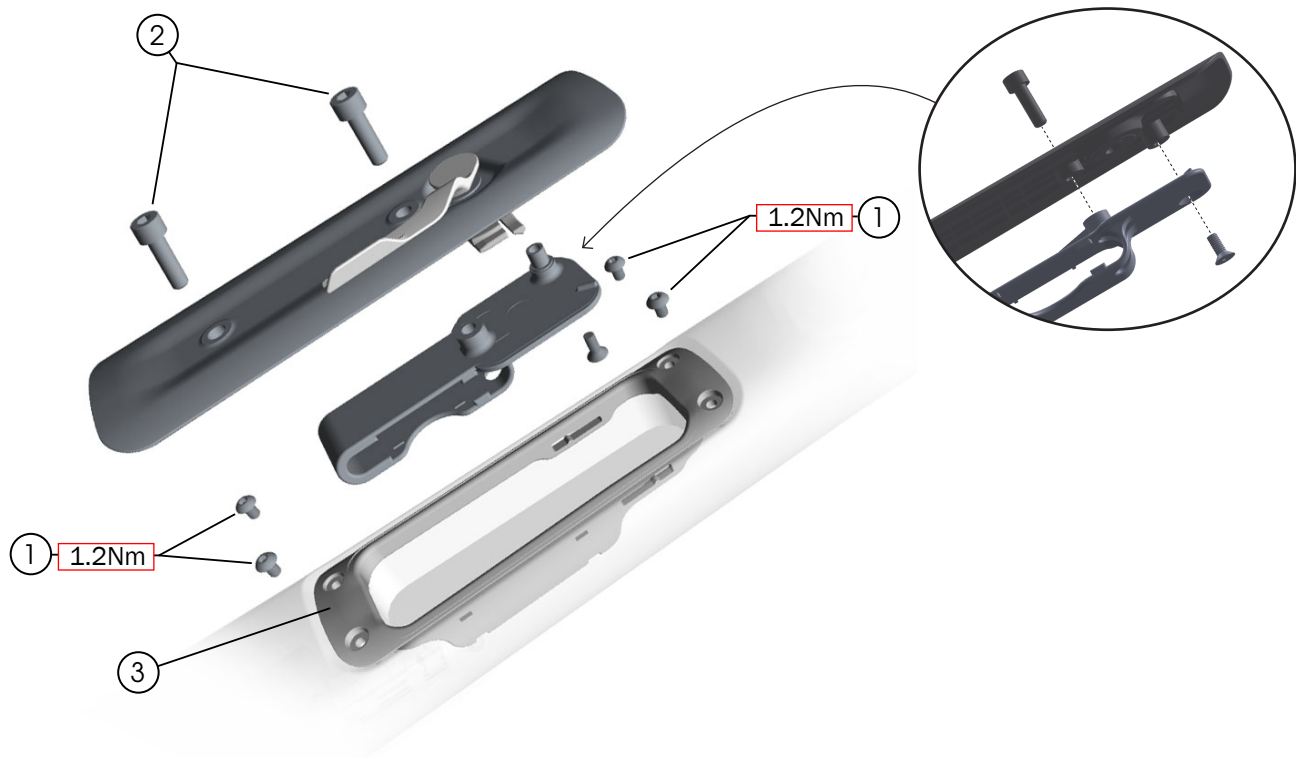

- ① Mount screws — [W547053](#)
 - ② Bolts (M5x16mm) — [W596821](#)
 - ③ Door frame — [W580769](#)
- } Storage door kit*

*This is a color-matched part — search trekbikes.com to find the right color for your bike.

Specifications

Frame

	SL/SLR
Rear hub OLD	142mm
Front hub OLD	100mm
Upper fork steerer tube OD	28.6mm
Lower fork steerer tube OD	38.1mm
Bottom bracket type/width	T47/85.5mm
Brake rotor diameter min/max	140/160mm
Tire width max 700c	38mm
Tire width max 700c (with fenders)	35mm
Fender compatible — rear	Yes
Fender compatible — front	Yes

Chainline/chainring

	Chainline	Max chainring teeth (T)		
		Small	Large	Single (1x)
Shimano	43.5mm	—	—	50t
	43.5mm	36T	52T	—
SRAM	43.5mm	—	—	50T
	43.5mm	33T	52T	—

Brake hose lengths (caliper to lever)

NOTE: The lengths below are based on a 100mm stem with 40mm of headset spacers below the stem.

Frame size	Rear brake	Front brake
50cm	1,440mm	815mm
52cm	1,460mm	830mm
54cm	1,480mm	845mm
56cm	1,500mm	860mm
58cm	1,526mm	880mm
60cm	1,557mm	905mm
62cm	1,588mm	930mm

Wire lengths — Di2 (derailleur to battery)

Frame size	Rear derailleur	Front derailleur
50cm	700mm	250mm
52cm	700mm	250mm
54cm	700mm	250mm
56cm	700mm	250mm
58cm	700mm	250mm
60cm	700mm	250mm
62cm	700mm	250mm

Housing lengths — mechanical (derailleur to lever)

Frame size	Rear derailleur	Front derailleur
50cm	1,590mm	1,240mm
52cm	1,610mm	1,260mm
54cm	1,630mm	1,280mm
56cm	1,650mm	1,300mm
58cm	1,675mm	1,325mm
60cm	1,710mm	1,360mm
62cm	1,740mm	1,390mm