

TREK



2023 FETCH+ 4

SERVICE MANUAL

Contents

Steering

pages 1-4

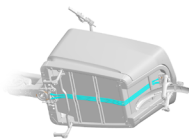

[Cable system](#)

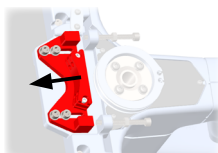

[Adjust cable tension](#)

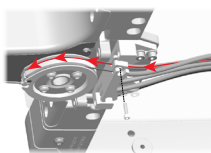

[Replace steering cables](#)

Drivetrain

pages 5-9

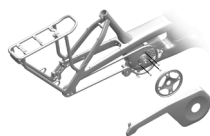

[Belt guard](#)

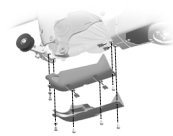

[Drive unit cover](#)

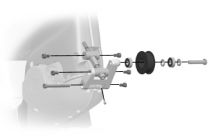

[Belt tensioner](#)

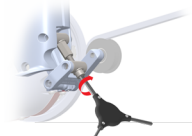

[Adjust belt tension](#)



[Align belt](#)

Routing

pages 10-14

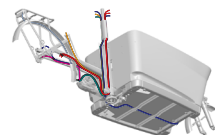

[Rear](#)

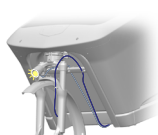

[Front](#)

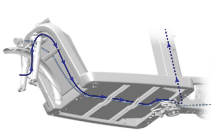

[Instructions](#)

Battery

pages 15-17



[Guide](#)



[Install battery guide](#)



[Lock, cover, and charge port](#)

Headsets

pages 18-20



[Rear assembly](#)



[Front assembly](#)

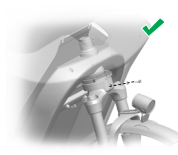

[Instructions](#)

Frame

pages 21-25

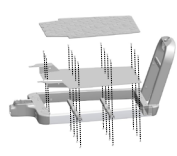

[Floor plate and mat](#)

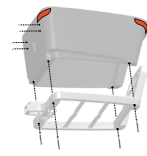

[Cargo box](#)

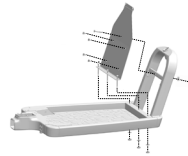

[Front cover](#)

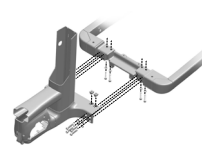

[Frame assembly](#)



[Frame tightening sequence](#)

Accessories

pages 26-32



[Front fender and light](#)

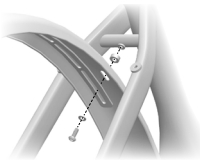

[Rear fender and light](#)



[Ring lock](#)

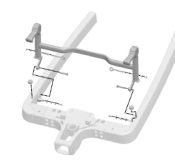

[Kickstand](#)



[Child seats](#)

About this manual

Scope

This manual contains parts diagrams, specifications (such as grease and torque values), instructions, and helpful tips (such as the easiest direction to route cables).

This manual does not contain instructions on all components (such as brake calipers). Refer to the original manufacturer for more information.

Working on a front cargo bike

The length, weight, and box size make working on this bicycle more difficult. Do not use a regular repair stand to lift the bicycle — use a ceiling-mounted hoist.

If you do not have a hoist, you can do many repairs by tipping the bicycle on it's side.

Interactive models

Additional info

There are additional manuals available at [Trekbikes.com/manuals](https://trekbikes.com/manuals).

- E-Cargo Owner's Manual — comprehensive instructions that come with your bicycle
- Bosch BES3 E-bike Manual — detailed instructions on the e-system found under Electric bikes > 2023

Legend

 Zip tie

 Torque value

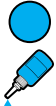
 Apply threadlocker

 Apply appropriate grease

Warnings

WARNING

Properly tighten hardware

Always tighten hardware to the specified torque. Over-tightening hardware could deform or break the hardware or components. Under-tightening hardware could cause hardware or components to become loose. Either situation could damage the bicycle and result in injury to the rider.

WARNING

Reapply threadlocker

All reused-fasteners with pre-applied threadlocker must be cleaned with isopropyl alcohol and have new threadlocker applied before re-assembly. If threadlocker is not applied, the fasteners may loosen which could damage the bicycle and result in injury to the rider.

Steering: cable system



or [Click here](#)

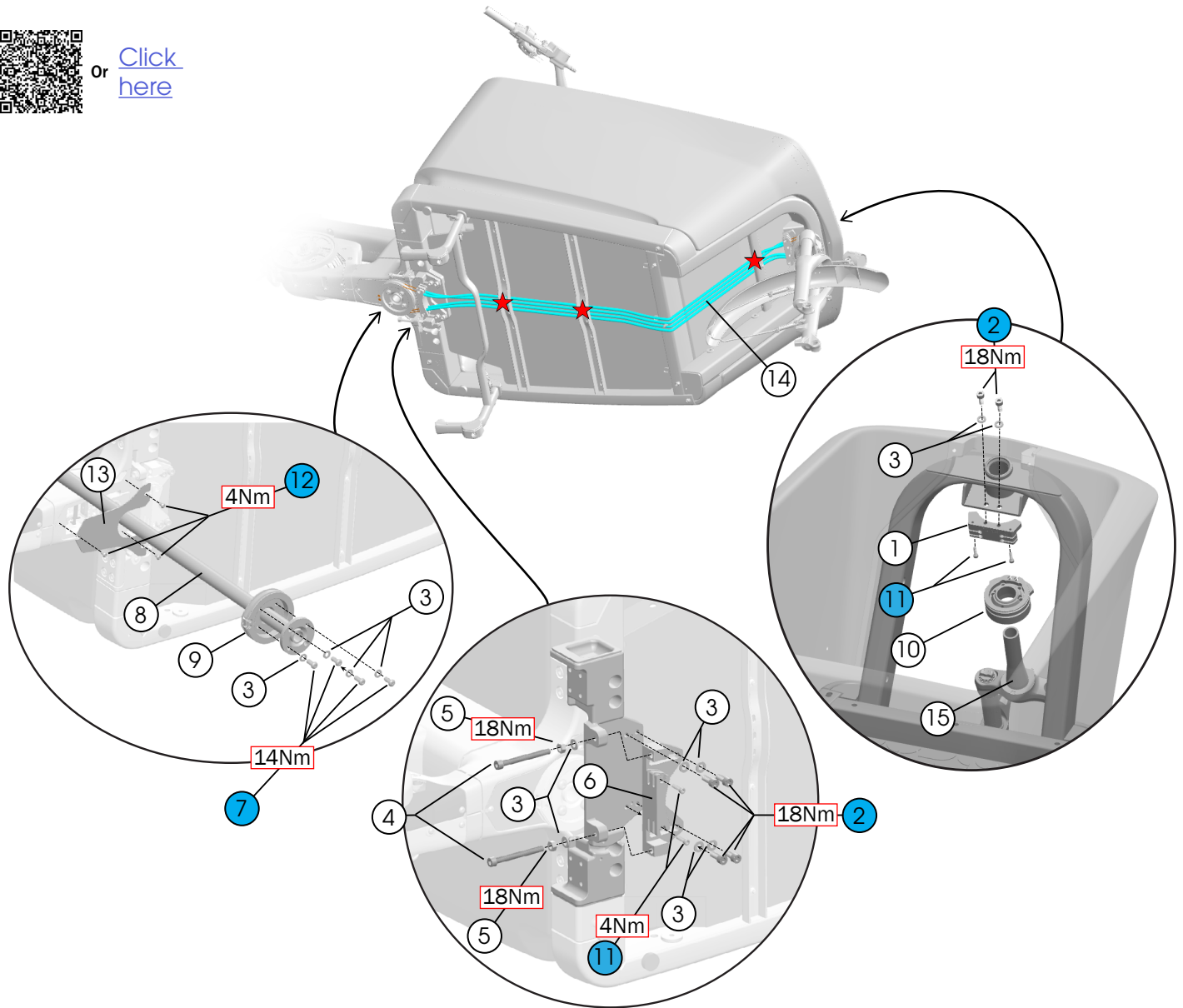

① Cable mount (front) — [W5257125](#)

② Bolts (M8x20mm)

③ Washers (M8)

④ Bolts (M8x80mm)

⑤ Nuts (M8)

⑥ Cable mount (rear) — [W5257126](#)

⑦ Bolts (M8x20mm) — [5284656](#)

⑧ Steerer tube (rear)

⑨ Steering disc (rear)

⑩ Steering disc (front) — [5284720](#)

⑪ Bolts (M5x20mm) — [5304417](#)

⑫ Bolts, T25 drive (M5x10mm) — [5284857](#)

⑬ Steering column cover — [W5268883](#)

⑭ Steering cables — [5284692](#)

⑮ Fork — [W5266799](#)

[5284549](#)

[5284657](#)

Steering

Drivetrain

Routing

Battery

Headsets

Frame

Accessories

Steering: adjust cable tension

1. Loosen the four rear cable mount bolts (2) — do not remove them.

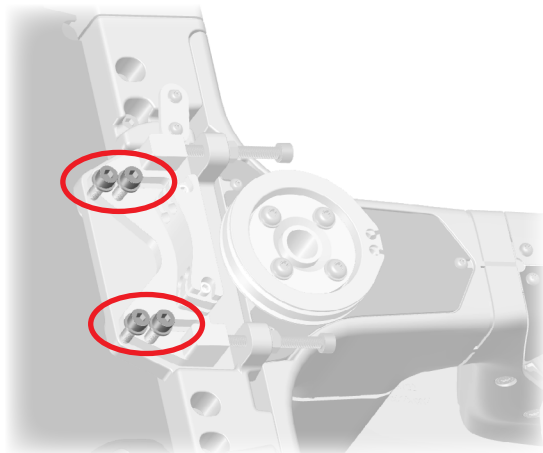

2. Hold the tensioning bolt (4) in place and use a 13mm wrench to loosen the tensioning nut (5). Then, loosen the tensioning bolt (4) to remove tension from the cables. Repeat for the other side.

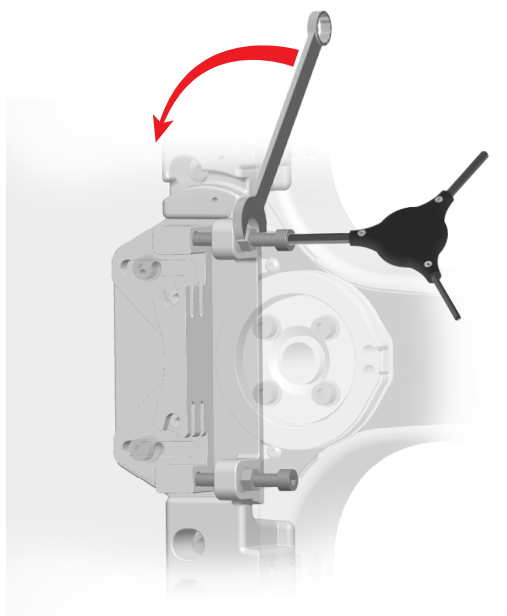

3. Move the cable mount (6) to increase tension in the cables.

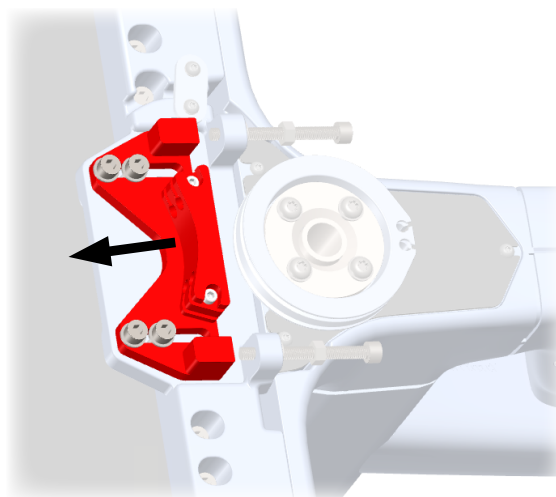

4. Tighten both tensioning bolts (4) — alternating between them to keep the cable mount parallel — until they are snug into the cable mount (6). Then, tighten both tensioning nuts (5) to 18Nm.

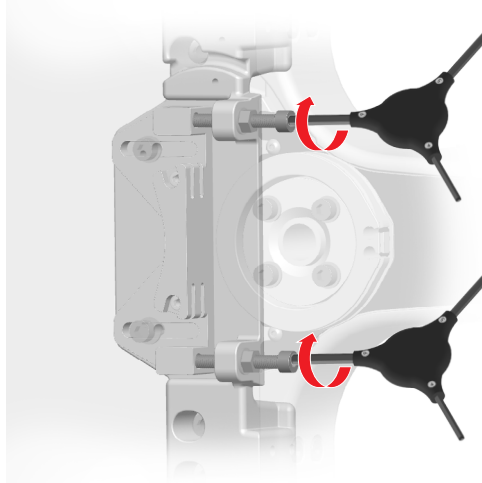

5. Test the front wheel steering and adjust the cable tension, if necessary. There should be no noticeable slack when steering quickly.
 - Too loose — the wheel will feel disconnected from the steering.
 - Too tight — the steering will feel heavy with a lot of friction.

Notice: If the cables are too tight, the bearings will wear out much faster than if the cables are tensioned properly.
6. Tighten all four rear cable mount bolts (2) to 18Nm (see Step 1).
7. Tighten both tensioning nuts (5) to 18Nm.

Steering: replace steering cables

Replace all four cables every two years or 10,000km/6,000mi.

NOTE: If a cable is damaged and needs repair, replace all four cables — not just the damaged one.

Remove the cables from the rear disc

1. Cut the three zip ties connecting the steering cables to the frame (see the zip tie locations on page 1).
2. Loosen the four rear cable mount bolts (2) — do not remove them.

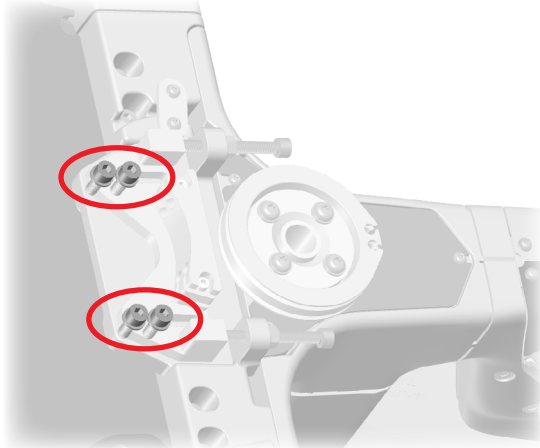

3. Hold the tensioning bolt (4) in place and use a 13mm wrench to loosen the tensioning nut (5). Then, loosen the tensioning bolt to remove tension from the cables. Repeat for the other side.

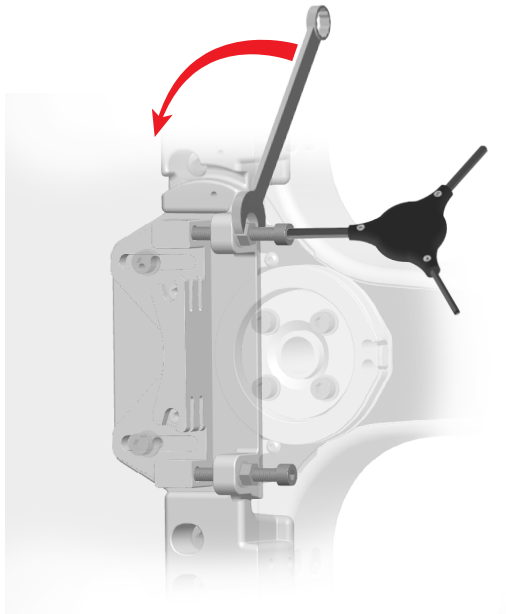

4. Remove the two bolts (11) securing the steering cables in the rear cable mount.

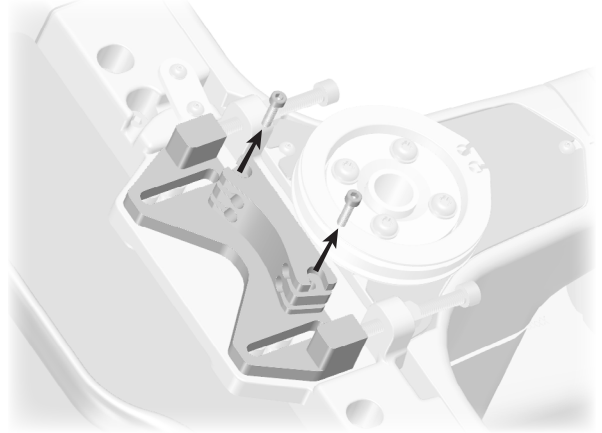

5. Slide the cable mount (6) towards the steering disc to relieve tension on the cables.
6. Remove the cables from the steering disc.

Remove the cables from the front disc

1. Loosen the two bolts (11) securing the steering cables in the front cable mount (1).

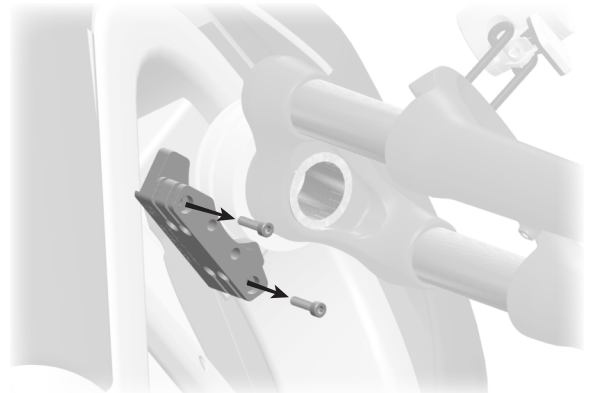

2. Remove the cables from the front steering disc.

Steering: replace the steering cables (continued)

Insert the cables into the front disc

NOTE: The cables may be slightly different lengths — there is no certain order you need to install them. They will stretch and even out after use.

1. Route the four cables through the frame brackets.

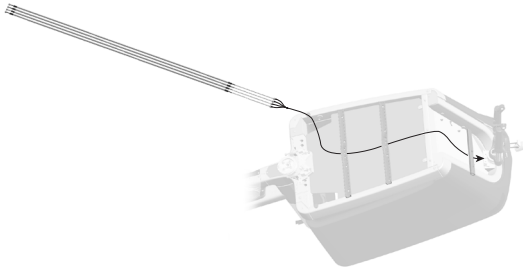

2. Route one cable into the lower section of the front steering disc. Then, route another cable in the upper section. Install one bolt (12) into the cable mount and torque to 4Nm to secure the two cables.

IMPORTANT: Make sure the cable end stop is fully inserted into the cable mount or you will not have enough slack when you install the cables in the rear disc.

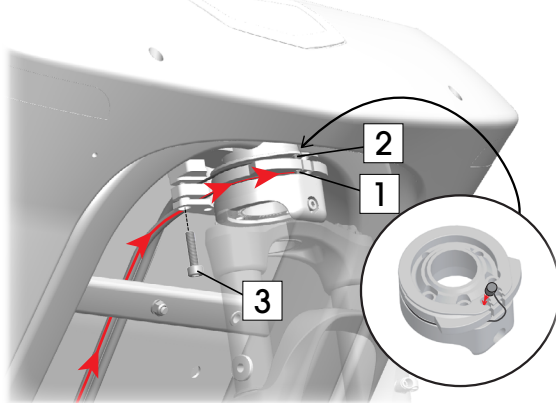

3. Repeat Step 2 for the other side.

Insert the cables into the rear disc

1. Route the rear cables as shown below.

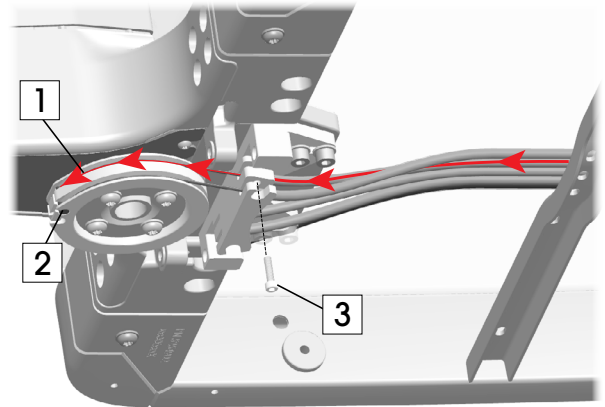

2. Tension the cables following Steps 3-7 on page 2.
3. Use six zip ties to attach the cables to the frame as shown below.

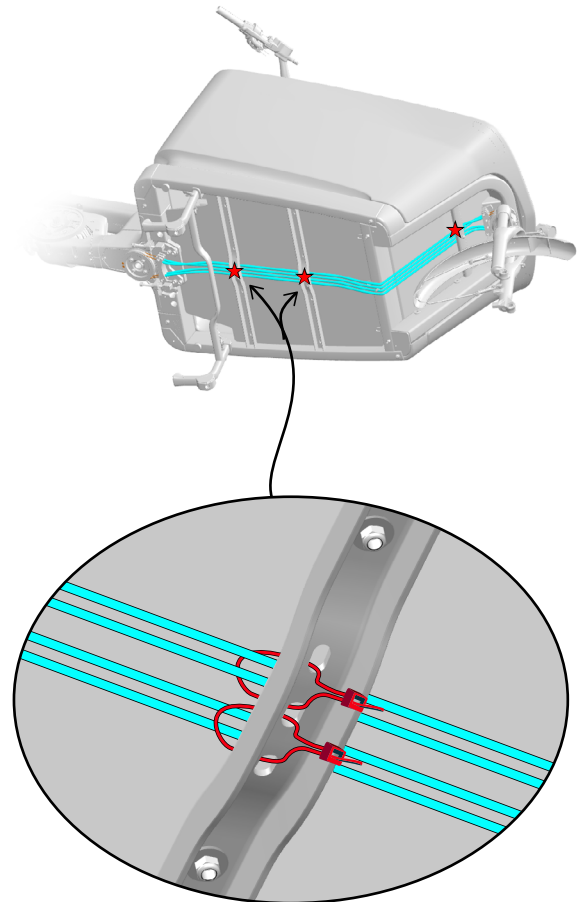

Drivetrain: belt guard



Or [Click here](#)

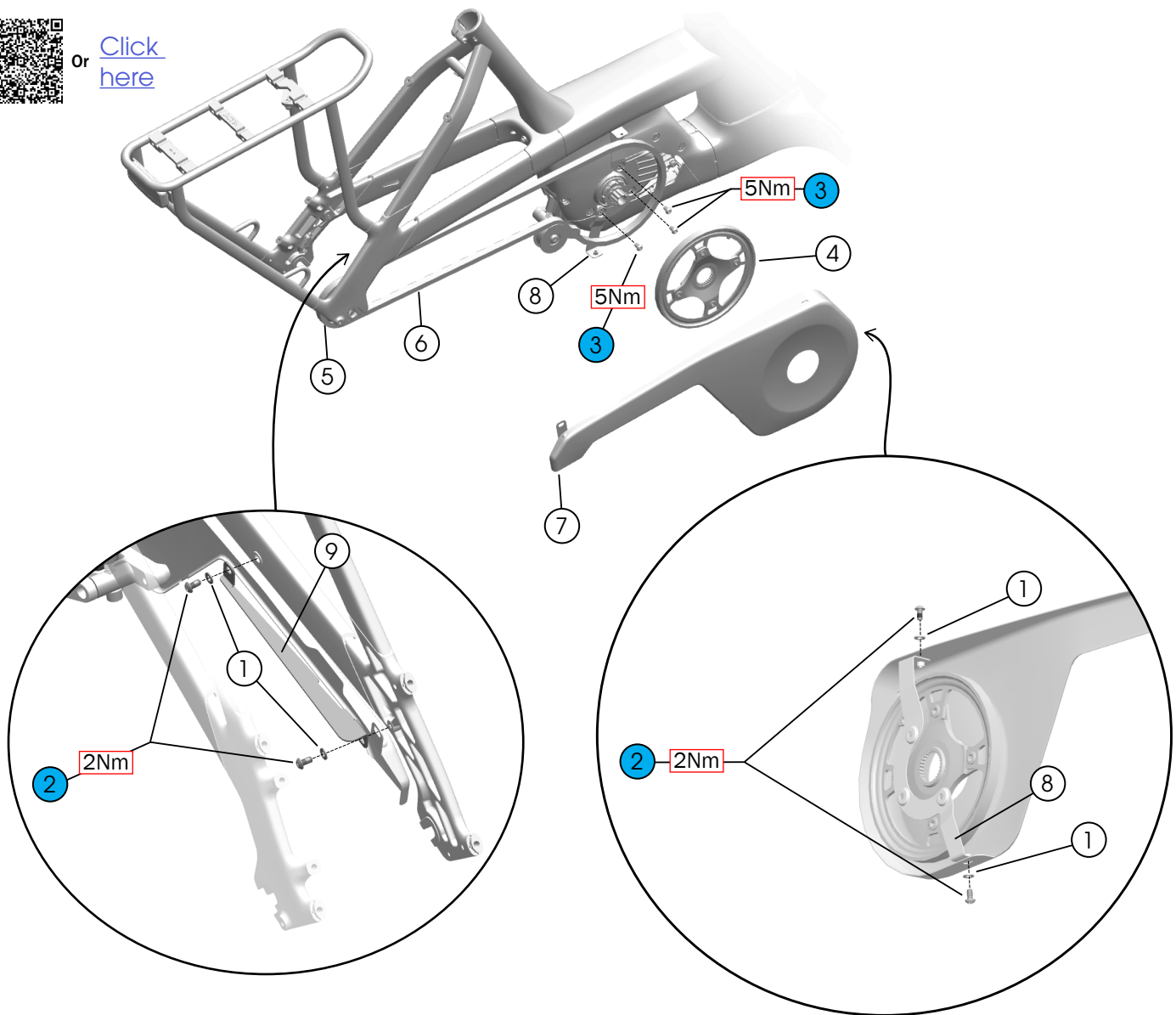

- ① Washers (M5)
- ② Bolts, T25 drive (M5x10mm)
- ③ Bolts (M6x10mm)
- ④ Beltring (50T) – [W5285189](#)
- ⑤ Sprocket (22T) – [W590978](#)
- ⑥ Belt (128T) – [W571473](#)

[5284857](#)

- ⑦ Belt guard
- ⑧ Belt guard bracket
- ⑨ Belt guard bracket addition
*North America only

[5280793](#)

Before removing the belt

- Remove the belt guard
- Remove the rear wheel
- Remove the driveside crank arm
- Release tension in the belt (see page 8)

See the manufacturer's specifications for more info:
[GatesCarbonDrive.com](https://www.gatescarbondrive.com).

Steering

Drivetrain

Routing

Battery

Headsets

Frame

Accessories

Drivetrain: drive unit cover



or [Click here](#)

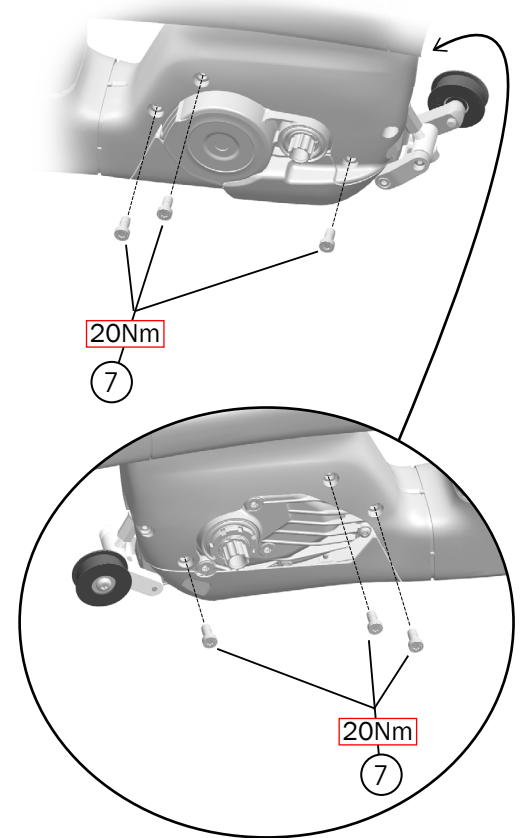
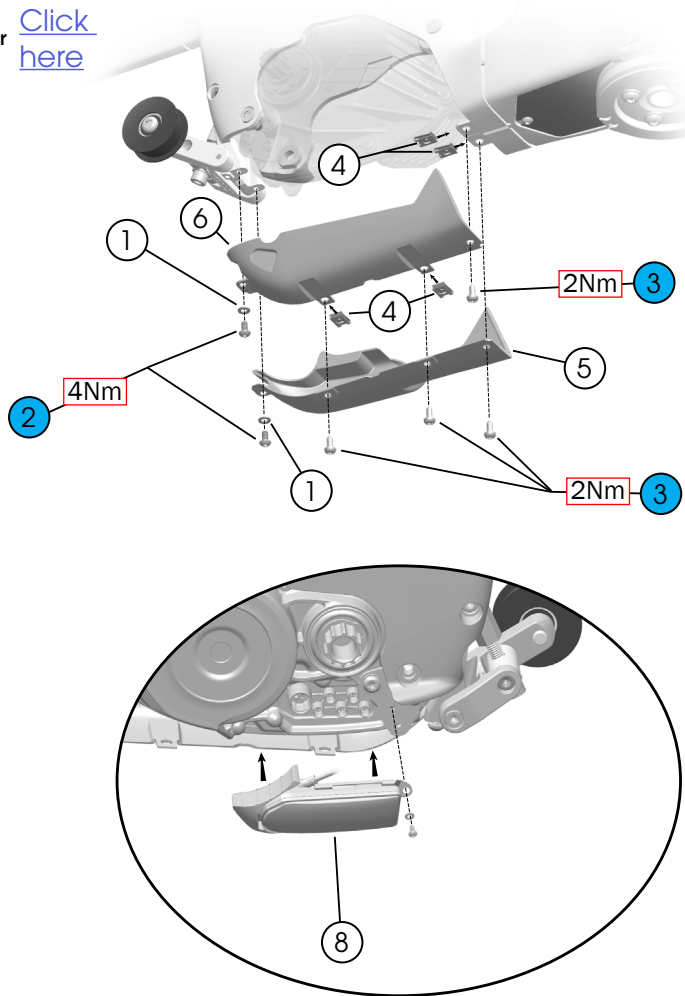

- | | |
|---|---------------------------|
| ① Washers (M5) | } 5284548 |
| ② Bolts, T25 drive (M5x10mm) | |
| ③ Bolts, T25 drive (M4.8x13mm) | |
| ④ Sheet nuts (M4.8) | |
| ⑤ Drive unit cover (non-drive side) | } 5280792 |
| ⑥ Drive unit cover (drive side) | |
| ⑦ Mounting bolts, T40 drive (M8x16mm) – *1270.016.470 | |
| ⑧ Bosch connect module BCM3100 – *EB13.200.02L | |

*Bosch part numbers are not available on [Trek bikes.com](#).

Steering

Drivetrain

Routing

Battery

Headsets

Frame

Accessories

Drivetrain: belt tensioner



Or [Click here](#)

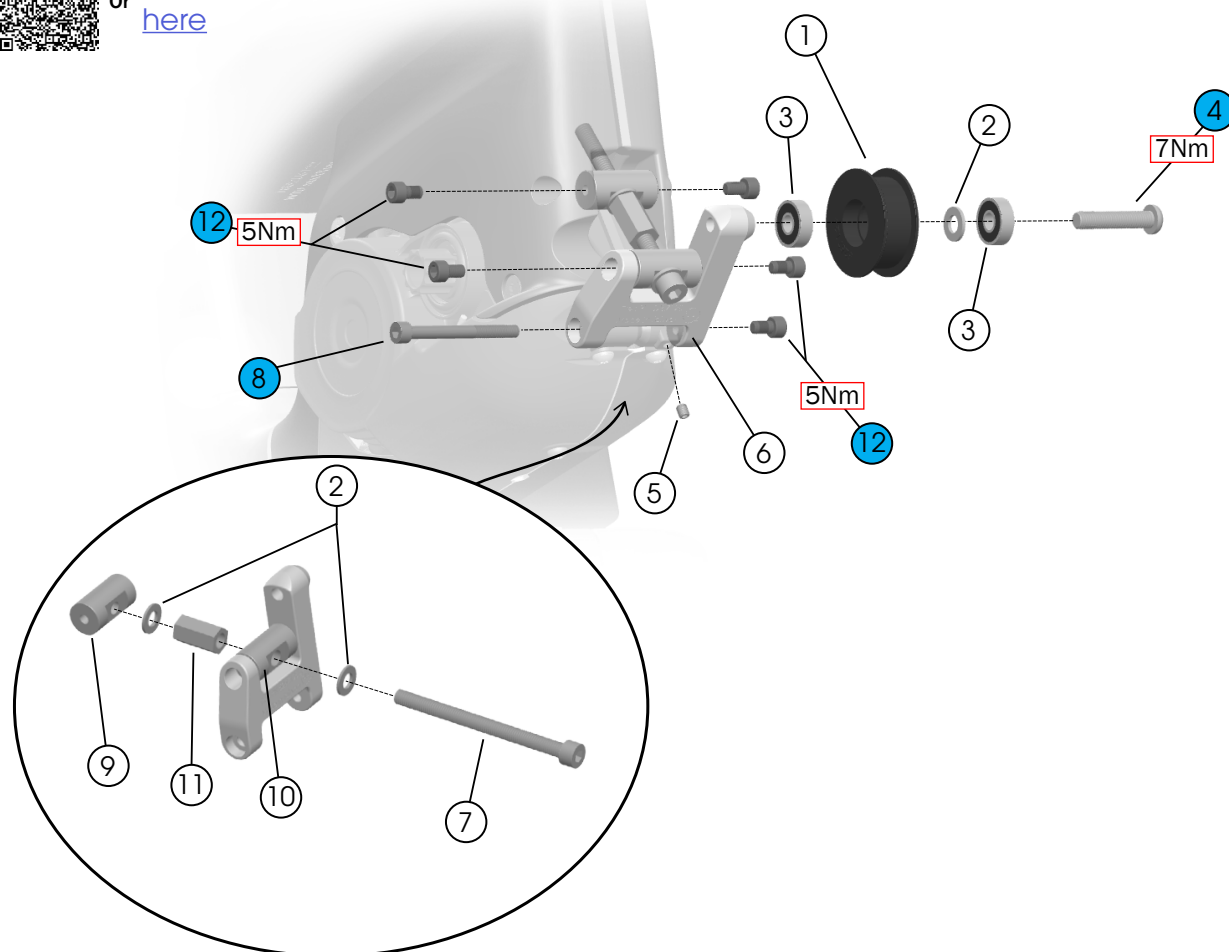

- ① Belt roller
- ② Washers (M8)
- ③ Bearings
- ④ Bolt (M8x40mm)
- ⑤ Bolt socket set screw – [W5282014](#)

[5291300](#)

- ⑥ Tensioner arm
- ⑦ Tensioning bolt (M8x100mm)
- ⑧ Bolt (M6x60mm)
- ⑨ Tensioning nut (upper)
- ⑩ Tensioning nut (lower)
- ⑪ Coupling nut
- ⑫ Bolts (M6x10mm)

[5280807](#)

Steering

Drivetrain

Routing

Battery

Headsets

Frame

Accessories

Drivetrain: adjust belt tension

Measure the belt tension

DESIRED TENSION: 45-60 Hz (35-45 lbs)

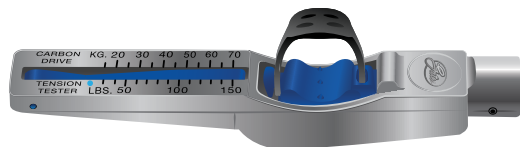

Gates Kriket Tension Gauge

1. Measure the belt tension using a tension gauge (such as the Gates Kriket Tension Gauge). See the technical manual at [GatesCarbonDrive.com](https://www.gates-carbon-drive.com).

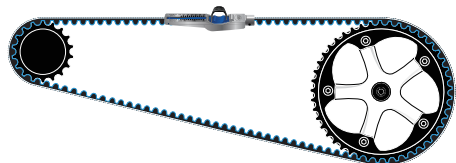

Source: Gates Corporation

TIP: You can also measure the tension using the methods listed below. Trek suggests using the Gates Kriket Tension Gauge for the most precise measurement.

- Your finger — push down in the middle of the belt. There should be 6-12mm of vertical movement.
 - Gates Carbon Drive app on your phone — this app measures belt tension through sound. Use the desired tension listed above.
2. Rotate the cranks 1/4 turn and measure the tension again. Repeat this at four different positions and average the measurements. If there is not enough tension, tighten the belt following the procedure to the right.

NOTE: If there is a large difference between measurements, the front beltring may be misaligned (see page 9).

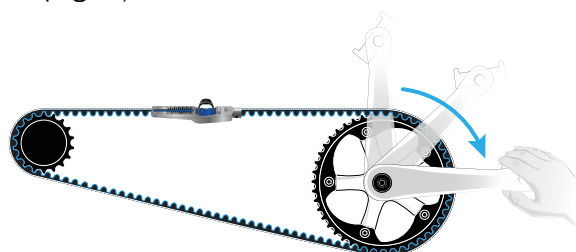

Source: Gates Corporation

Tension the belt

1. Hold the tensioning bolt (7) in place and use a 13mm wrench to loosen the coupling nut (11).

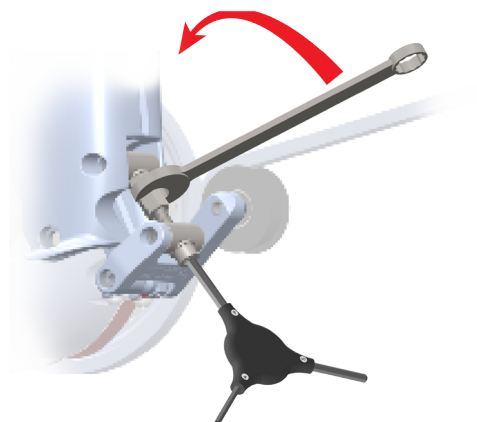

2. Tighten the tensioning bolt (7) until you reach proper belt tension.

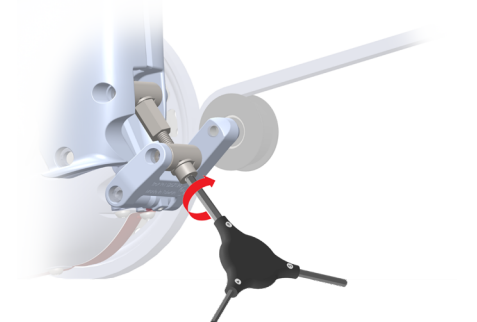

3. Verify the belt tension at different crank positions and average the results. Tighten or loosen the tensioning bolt (7), if necessary.
4. Hold the tensioning bolt (7) in place and use a 13mm wrench to tighten the coupling nut (11).

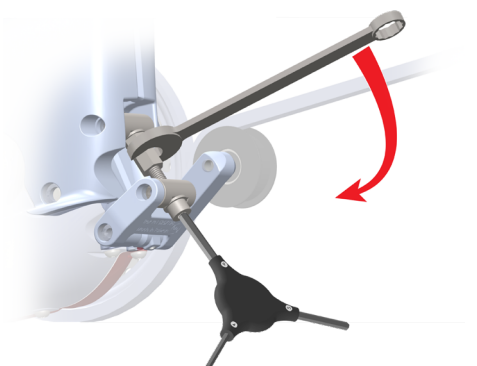

5. Rotate the cranks forward and backward to make sure the belt is centered on the belt roller (1).
6. Verify the tension and adjust, if necessary.

Drivetrain: align belt

Center the belt on the belt roller

The notch in the middle is slightly off-center.

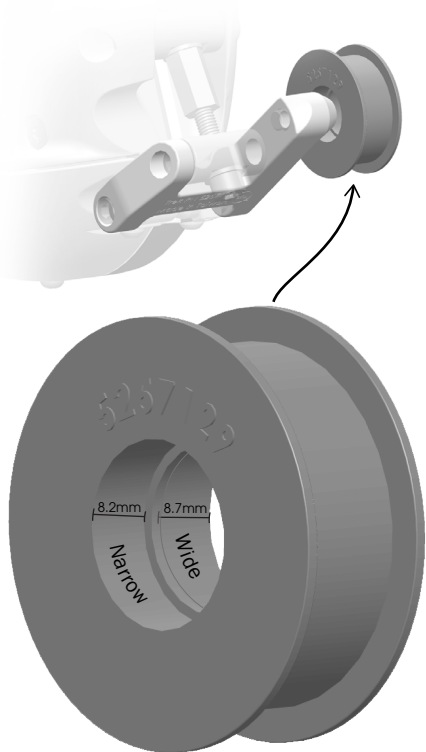

The belt may become off-center in the belt roller over time. If the belt continually touches the outer belt roller edge while pedaling, flip the belt roller around 180°. This moves the belt roller 0.7mm outward.

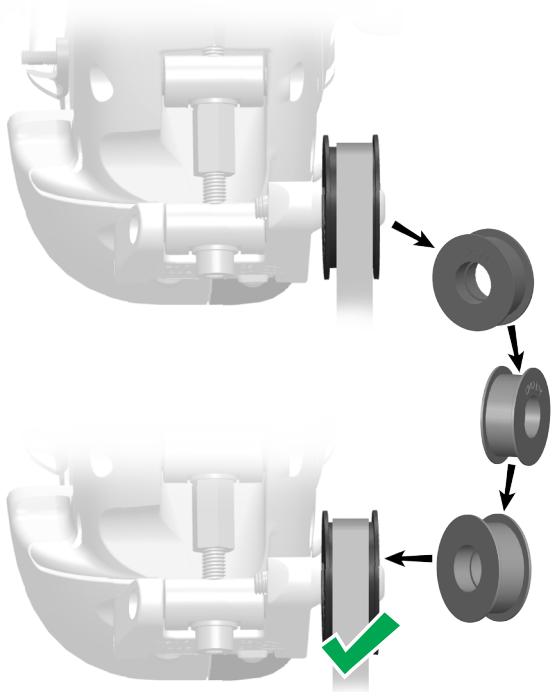

Adjust the belt angle

The belt roller should be parallel to the belt. If the belt roller gets out of alignment, tighten or loosen the set screw (5). This adjusts the angle of the tensioner arm.



1. Tighten or loosen the set screw until the belt is parallel to the belt roller.

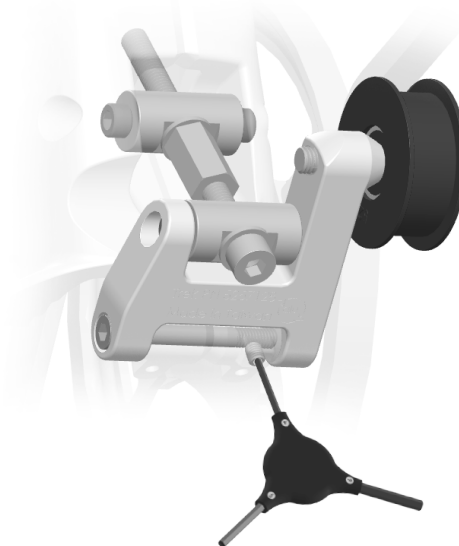

2. Verify the belt tension and adjust, if necessary (see page 8).

Routing: rear



or [Click here](#)

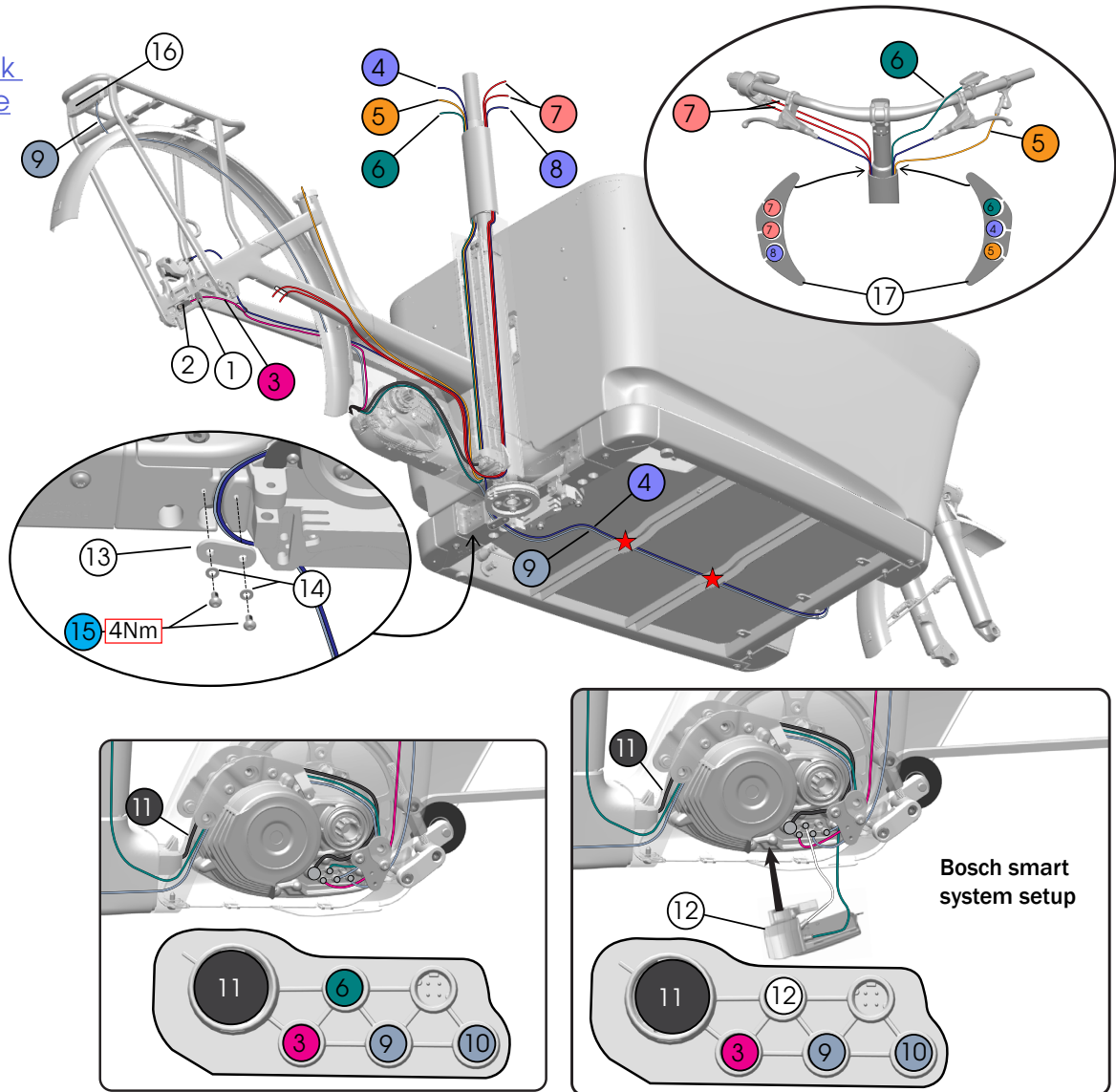

① Cable manager — [W316706](#)

② Bolt (M4x6mm)

③ Speed sensor and wire

④ Front brake hose

⑤ Dropper post cable

⑥ Remote wire

⑦ Shift cables

⑧ Rear brake hose

⑨ Front light wire

⑩ Rear light wire

⑪ Drive unit cable

⑫ Bosch Connect Module — [5282027](#)
Europe and North America only

⑬ Cable bracket — [W5290750](#)

⑭ Washers (M5)

⑮ Bolts (M5x10mm)

⑯ Rear light — [W504513](#)

⑰ Cable guides — [W5309355](#)

[5284750](#)

[5304416](#)

Steering

Drivetrain

Routing

Battery

Headsets

Frame

Accessories

Routing: front

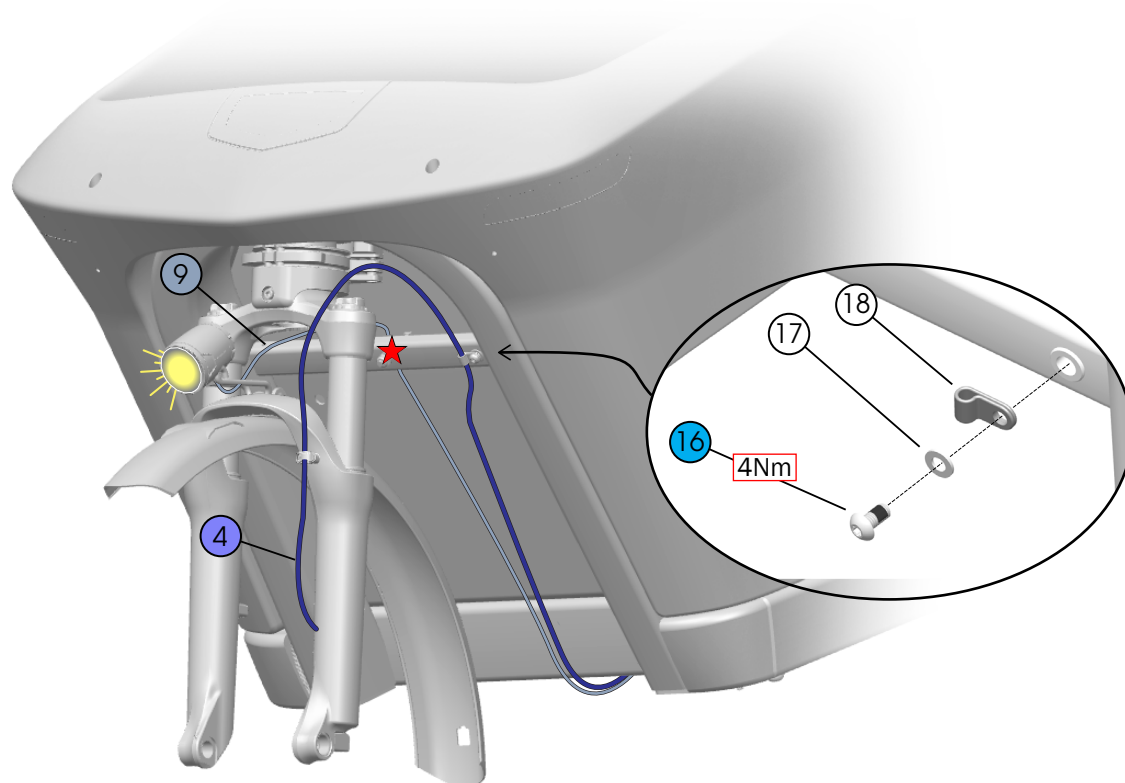

- ④ Front brake hose
- ⑨ Front light wire
- ⑩ Bolt (M5x10mm), T25 drive
- ⑪ Washer (M5)
- ⑫ Cable clamp — [W2016621](#)

[5304417](#)

Steering

Drivetrain

Routing

Battery

Headsets

Frame

Accessories

Routing: instructions

Rear headset

1. Route all handlebar cables/wires/hoses down through the frame — except the front brake. Use the current housing as a guide when pulling a new one through.

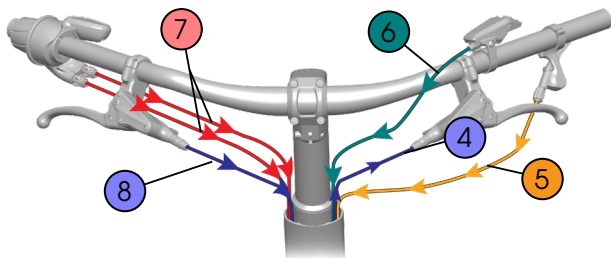

2. Route the cables through the frame. Remove the steering column cover (see page 1) and non-driveside motor cover (see page 6) to access the cables easier.

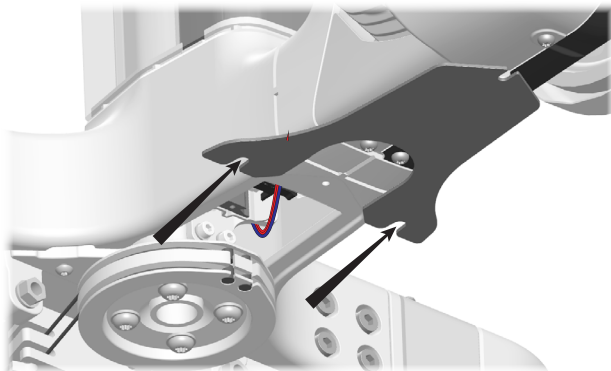

NOTE: Remove the motor to have additional access to the cables (see page 6).

3. Install the cable guides (17).

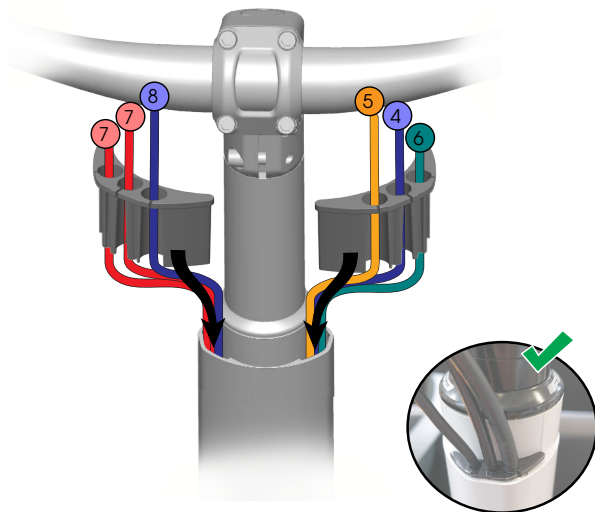

Speed sensor

Route the wire from the back — through the chainstay — to the drive unit.

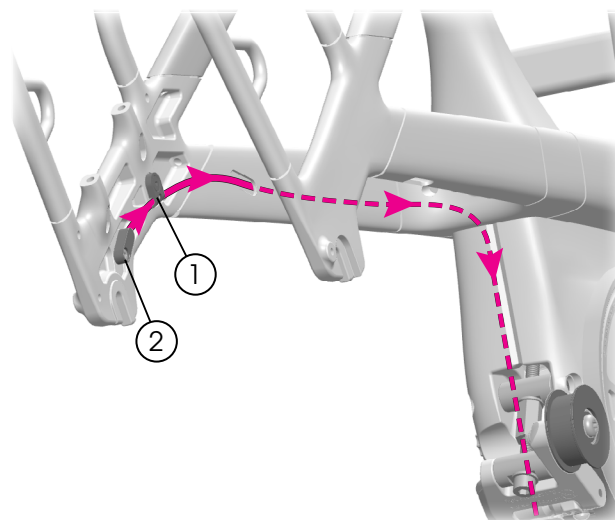

Steering

Drivetrain

Routing

Battery

Headsets

Frame

Accessories



Routing: instructions (continued)

Rear light

You must remove the rear wheel to route the wire. Make sure there is no slack in the wire between the fender and the tire.

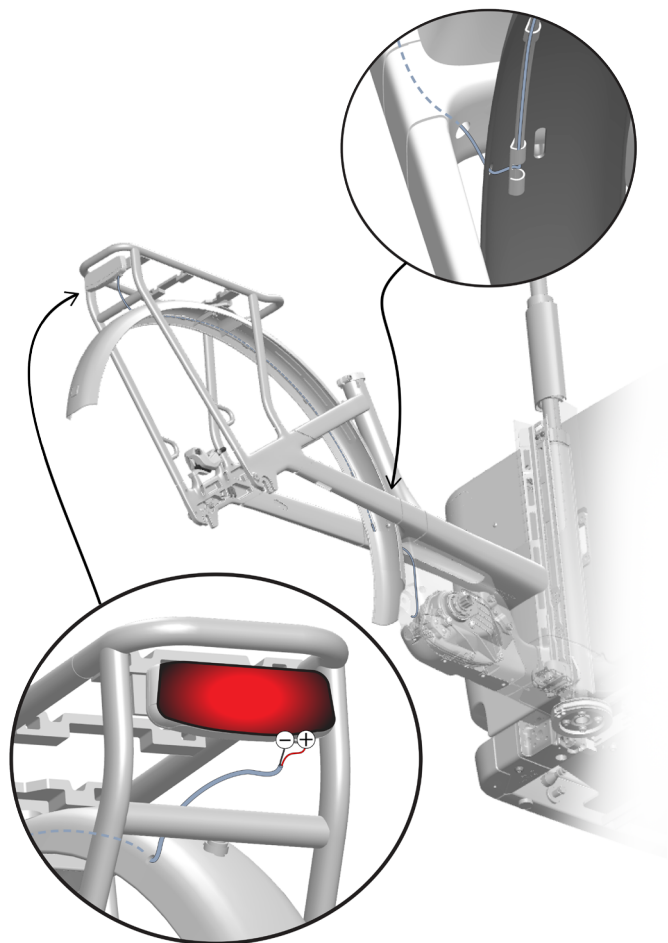

Drive unit cable

With the drive unit removed, connect the drive unit cable (11) at both ends before reinstalling the drive unit.

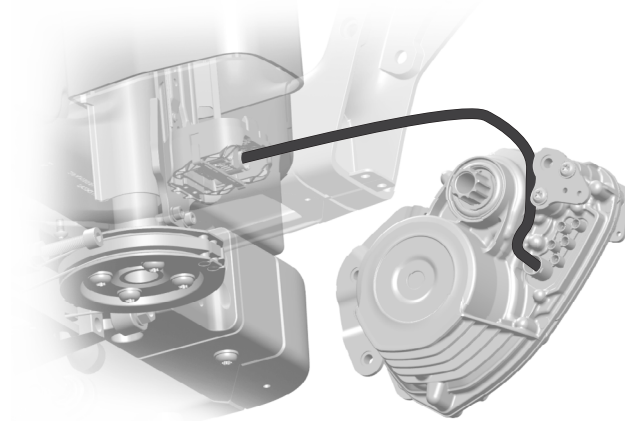

Steering

Drivetrain

Routing

Battery

Headsets

Frame

Accessories



Routing: instructions (continued)

Front brake and front light

Route the front brake hose and front light wire — starting from the front — under the frame as shown below.

Note: The front brake hose must have enough slack to turn the front wheel back and forth fully — without interference. The brake hose must have a 10mm (3/8" in) gap to the cargo frame as shown below.

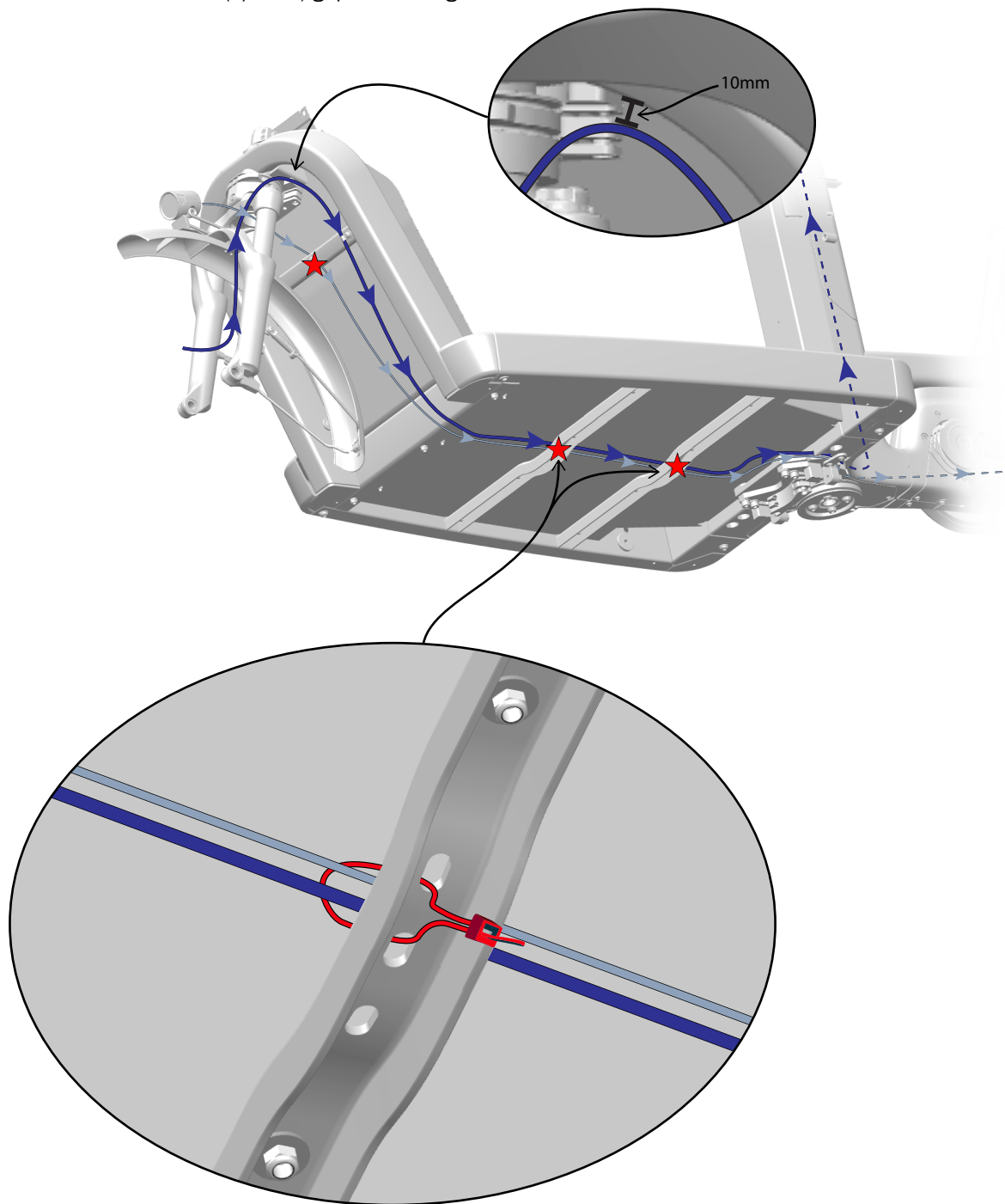

Steering

Drivetrain

Routing

Battery

Headsets

Frame

Accessories

Battery: guide



or [Click here](#)

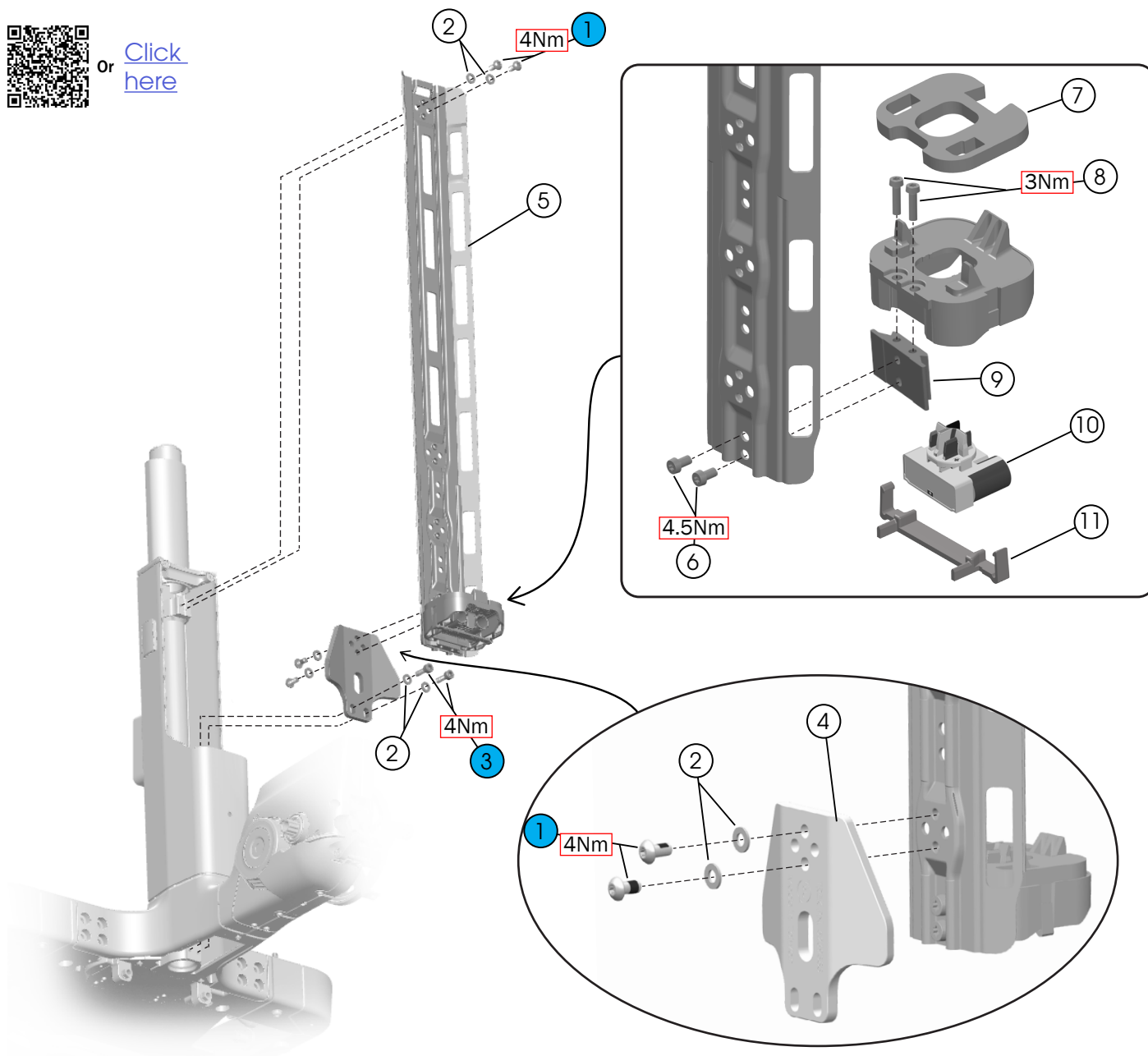

- ① Bolts, T25 (M5x10mm)
 - ② Washers (M5)
 - ③ Bolts (M5x14mm)
 - ④ Mounting extension — [W5269383](#)
 - ⑤ Guide rail — *EB12.100.01R
 - ⑥ Bolts, T20 (M5x9mm) — *EB12.100.01Y
- [5284856](#)

- ⑦ Damper foil plug — *EB12.100.01Z
- ⑧ Bolts, T25 (M4x16mm) — *EB12.100.01X
- ⑨ Cradle — *EB12.100.01B
- ⑩ Battery adapter — *EB12.100.015
- ⑪ Clamp ring — *EB12.100.02D

*Bosch part numbers are not available on [Trek bikes.com](#).

Steering

Drivetrain

Routing

Battery

Headsets

Frame

Accessories

Battery: install battery guide

Make sure all cables are routed in front of the battery guide before installing it.

1. Insert the battery guide assembly into the frame.

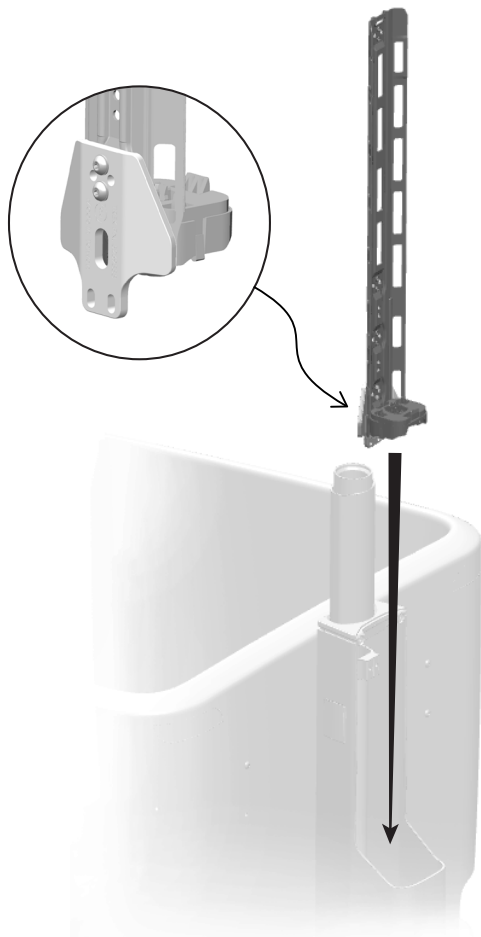

2. Install the two upper (1) battery guide bolts. Torque to 4Nm.

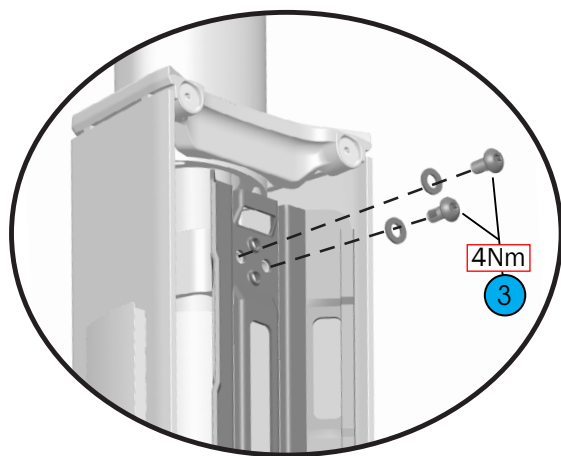

3. Install the two lower (3) battery guide bolts. Torque to 4Nm.

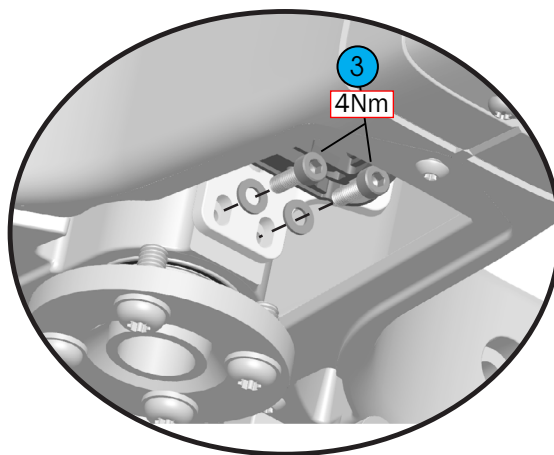

Steering

Drivetrain

Routing

Battery

Headsets

Frame

Accessories

Battery: lock, cover, and charge port



or [Click here](#)

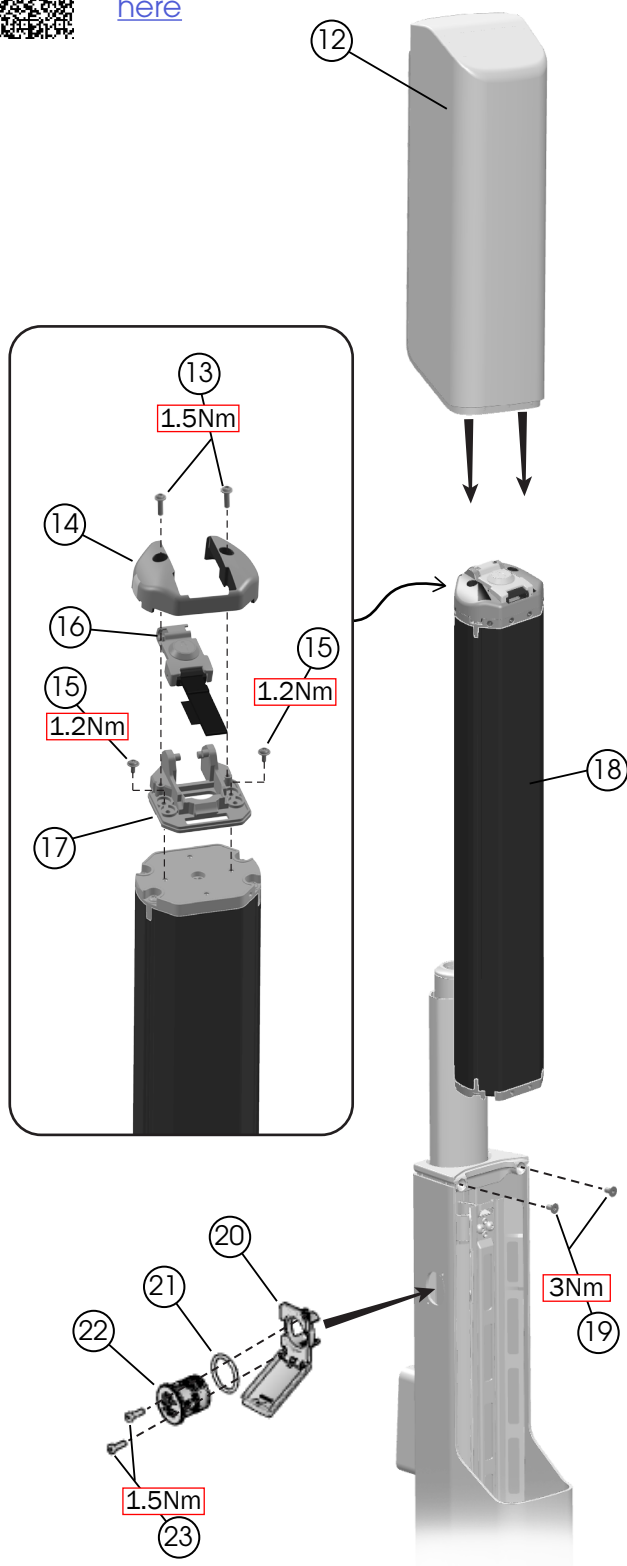

- ⑫ Battery cover — [W5257032](#)
- ⑬ Bolts, T15 (M3.5x12mm) — *EB12.100.01G
- ⑭ Cover — *EB12.100.01A
- ⑮ Bolts, T15 (M3x7mm) — *EB12.100.01G
- ⑯ Battery lock — [W5277876](#)
- ⑰ Locking assembly — *EB12.100.01D
- ⑱ PowerTube 750W battery — *EB12.100.00X
- ⑲ Bolts (M5x10mm) — [5272902](#)
- ⑳ Charge port cover — [W5251862](#)
- ㉑ O-ring — *EB12.120.019
- ㉒ Charge plug — *EB12.120.04B
- ㉓ Bolts (M3x10mm) — [5284849](#)

*Bosch part numbers are not available on [Trek bikes.com](#).

⚠ WARNINGS: BATTERY USE

- A short circuit in the electric system and/or damage to the battery might lead to over-heating. In an extremely rare case, a battery that has been severely impacted could potentially catch fire.
- Only charge the battery with a Bosch smart system charger. Using the wrong charger risks the life of the battery and presents a potential fire hazard.
- Only use the charger in dry, indoor areas.
- Do not leave a charging battery unattended.
- When the battery is fully charged, disconnect the charger from the battery and wall socket.

Steering

Drivetrain

Routing

Battery

Headsets

Frame

Accessories

Headsets: rear assembly



or [Click here](#)

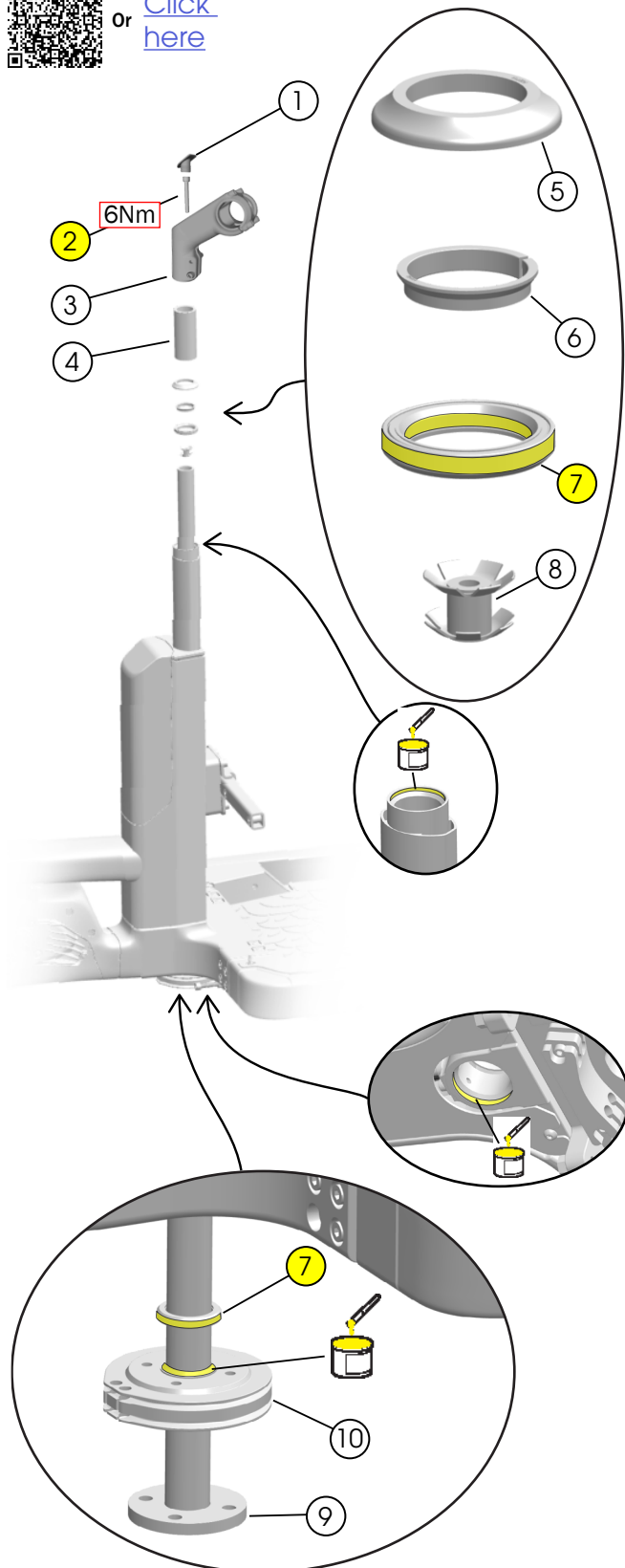

- ① Stem cover — [5307966](#)
 - ② Compression bolt
 - ③ Stem
 - ④ Stem spacer — [W5295111](#)
 - ⑤ Bearing cover — [W5283853](#)
 - ⑥ Compression ring — [W532842](#)
 - ⑦ Headset bearings — [W531676](#)
 - ⑧ Compression nut (1") — [63374](#)
 - ⑨ Steerer tube
 - ⑩ Steerer disc
- [W5297608](#)
- [5284549](#)

Steering

Drivetrain

Routing

Battery

Headsets

Frame

Accessories

Headsets: front assembly



or [Click here](#)

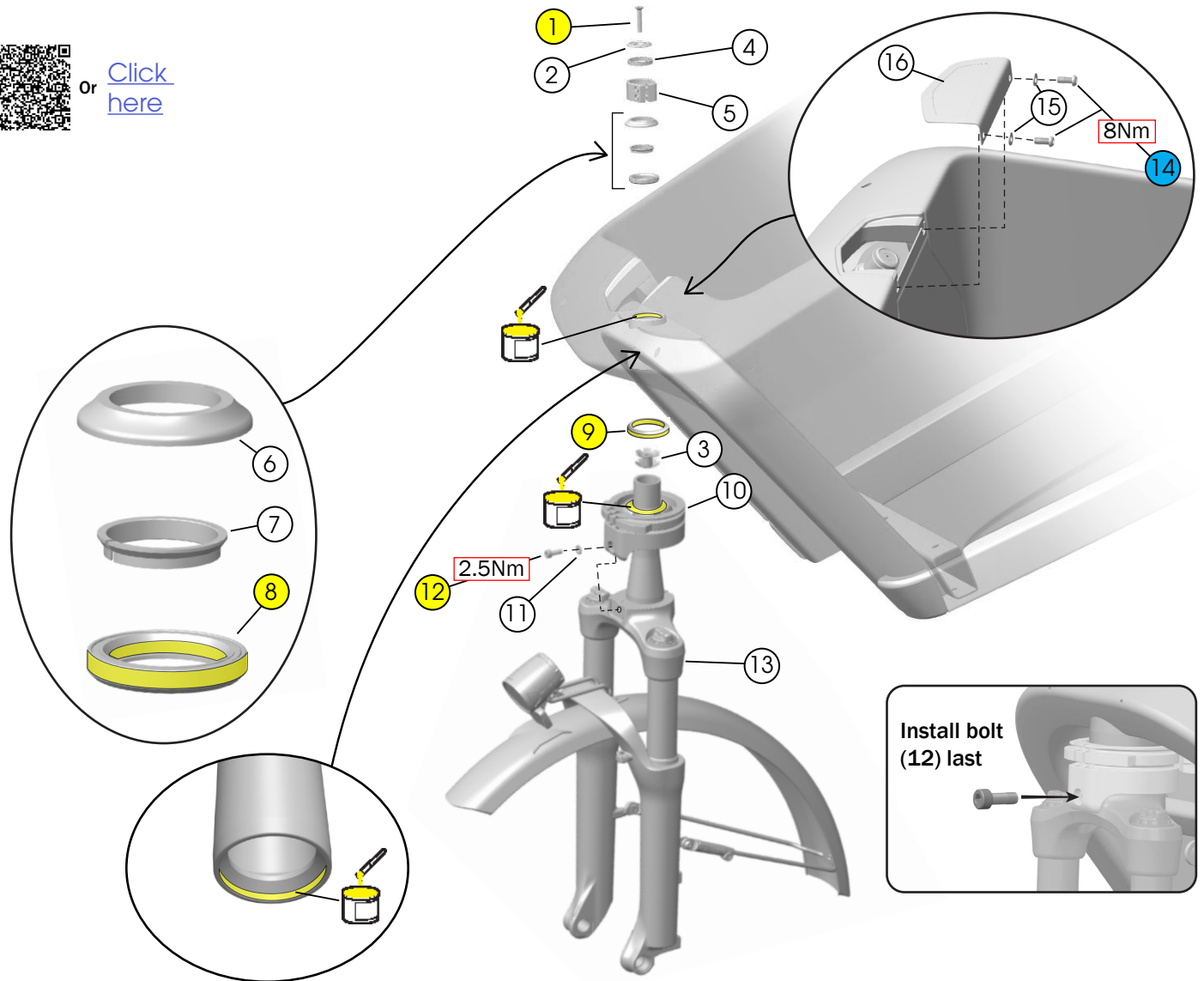

- ① Compression bolt (M6x35mm)
- ② Top cap
- ③ Compression nut (1 1/8")
- ④ Spacer (5mm) — [5253928](#)
- ⑤ Headset collar — [W5257186](#)
- ⑥ Bearing cover
- ⑦ Compression ring
- ⑧ Headset bearing (upper)
- ⑨ Headset bearing (lower)

[W545877](#)

[426180](#)

- ⑩ Front steering disc — [5284720](#)
- ⑪ Washer (M5)
- ⑫ Bolt (M5x14mm)
- ⑬ Suspension fork — [W5266799](#)
- ⑭ Bolts, T40 drive (M8x20mm)
- ⑮ Washers (M8)
- ⑯ Headset lid — [5280797](#)

[5305201](#)

[5284749](#)

Install bolt
(12) last

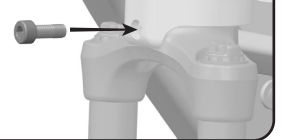

Steering

Drivetrain

Routing

Battery

Headsets

Frame

Accessories

Headsets: instructions

Install the front headset/fork

1. Assemble the headset/fork and tighten the compression bolt (1).
2. Install the bolt (12) and washer (11).

NOTE: If you do this in the reverse order, the assembly can be misaligned.

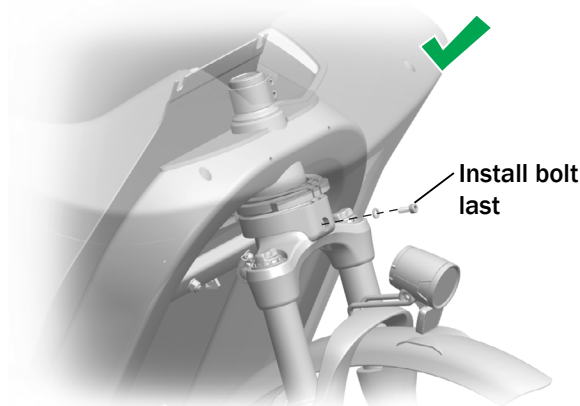

Remove the steering cables before uninstalling either headset assembly

See pages 3-4 for instructions on how to remove them.

NOTICE: If you do not remove the steering cables before uninstalling the headset, they can get damaged by the weight of the steerer tube.

Verify rear headset tightness

1. Hold the stem (3) and move it up/down and forward/backward to ensure the headset is assembled and tightened properly. The steering should be responsive, direct, and without play.
2. If there is play, reassemble and tighten the headset parts as necessary (see page 17).

Stem clamp bolts tightening order

1. Tighten the top two bolts to 10Nm.

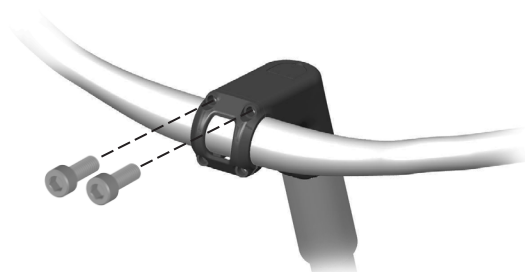

2. Tighten the lower two bolts to 10Nm.

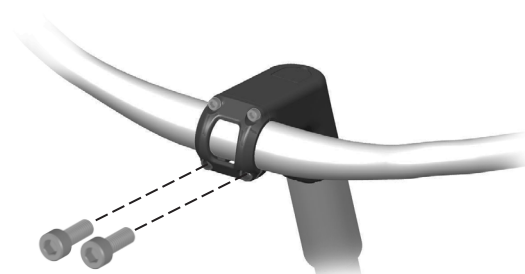

Frame: floor plate and mat



or [Click here](#)

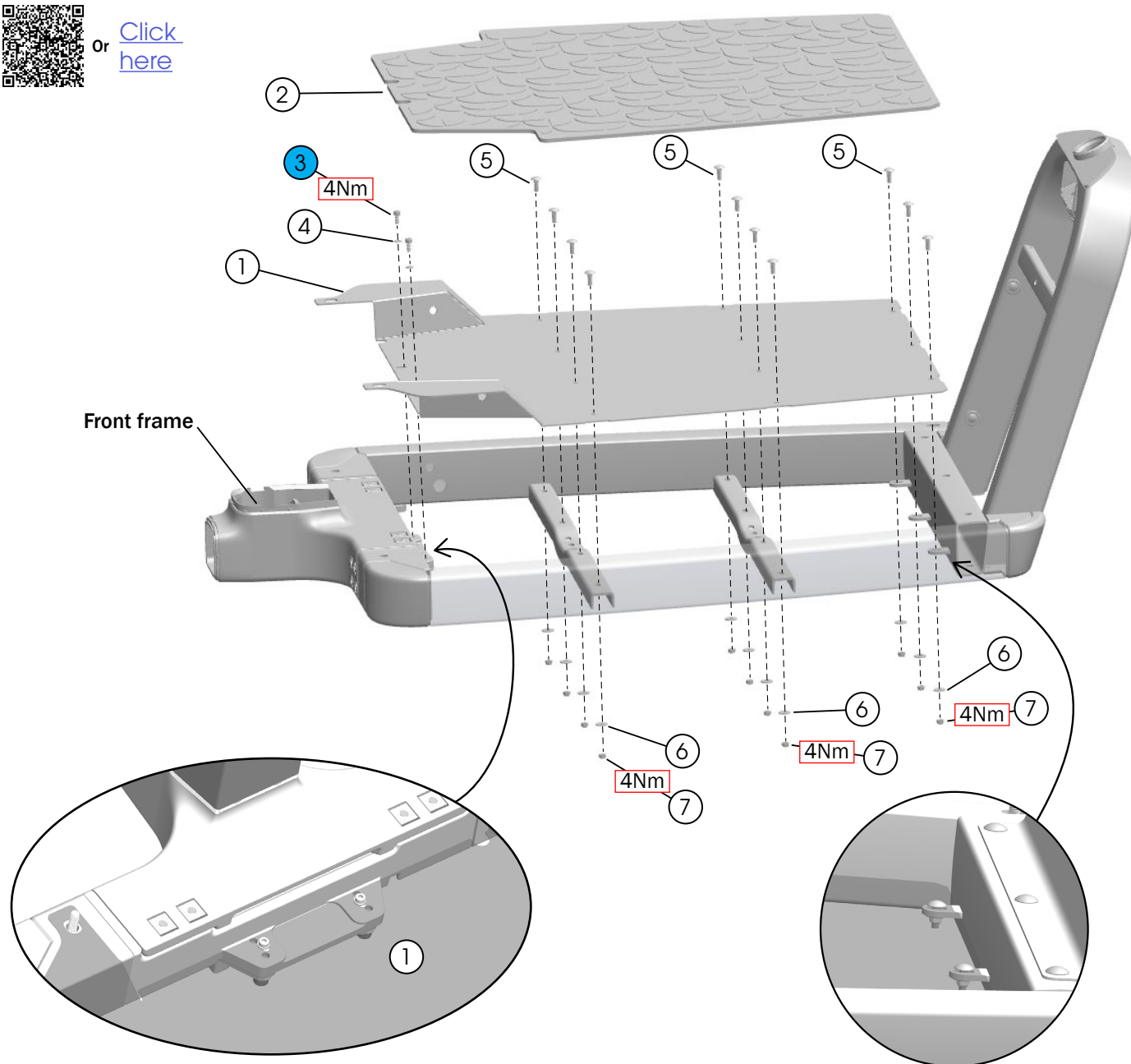

① Floor plate — [W5267707](#)

② Floor mat — [W5271011](#)

③ Bolts (M5x12mm)

④ Washers (M5)

⑤ Bolts (M5x16mm)

⑥ Washers, wide (M5)

⑦ Nuts (M5)

[5286562](#)

Steering

Drivetrain

Routing

Battery

Headsets

Frame

Accessories

Frame: cargo box

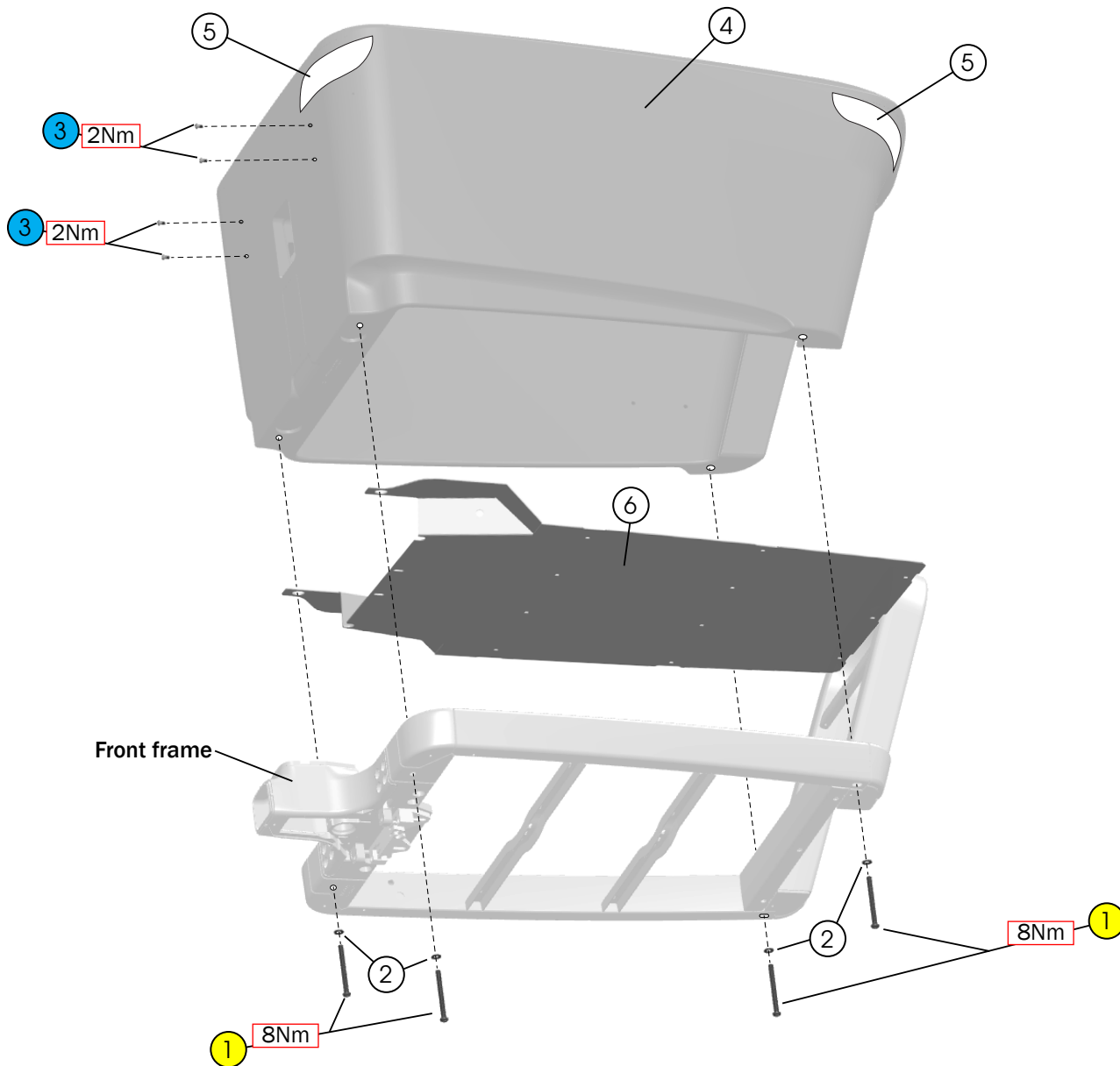

- 1 Bolts (M8x90mm)
 2 Washers (M8)
 }
[5284748](#)
- 3 Bolts (M5x10mm) — [5284749](#)
- 4 Cargo box — [5280798](#)
- 5 Decals — [5291298](#)
- 6 Floor plate — [W5267707](#)

Steering

Drivetrain

Routing

Battery

Headsets

Frame

Accessories

Frame: front cover

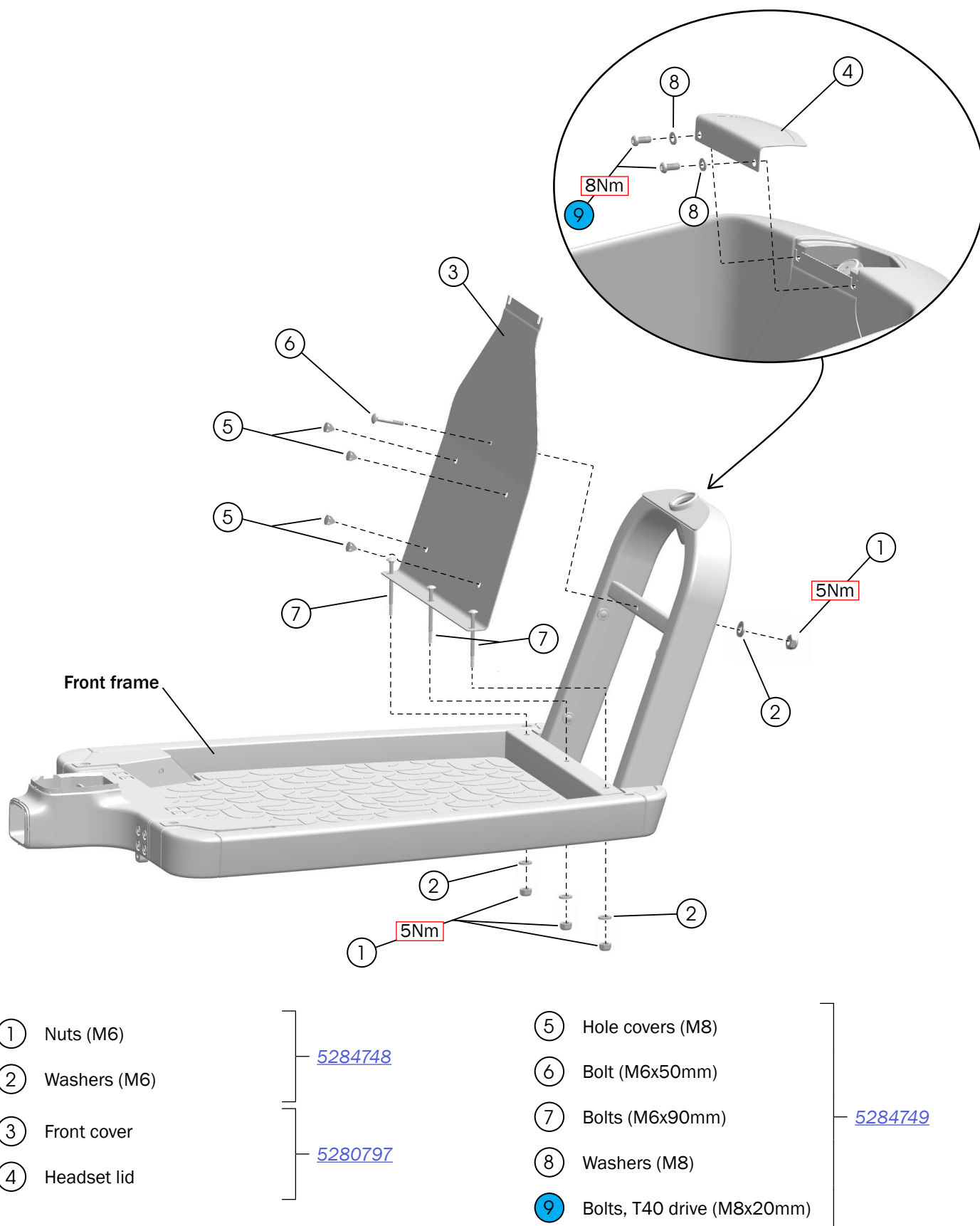

Steering

Drivetrain

Routing

Battery

Headsets

Frame

Accessories

Frame: frame assembly

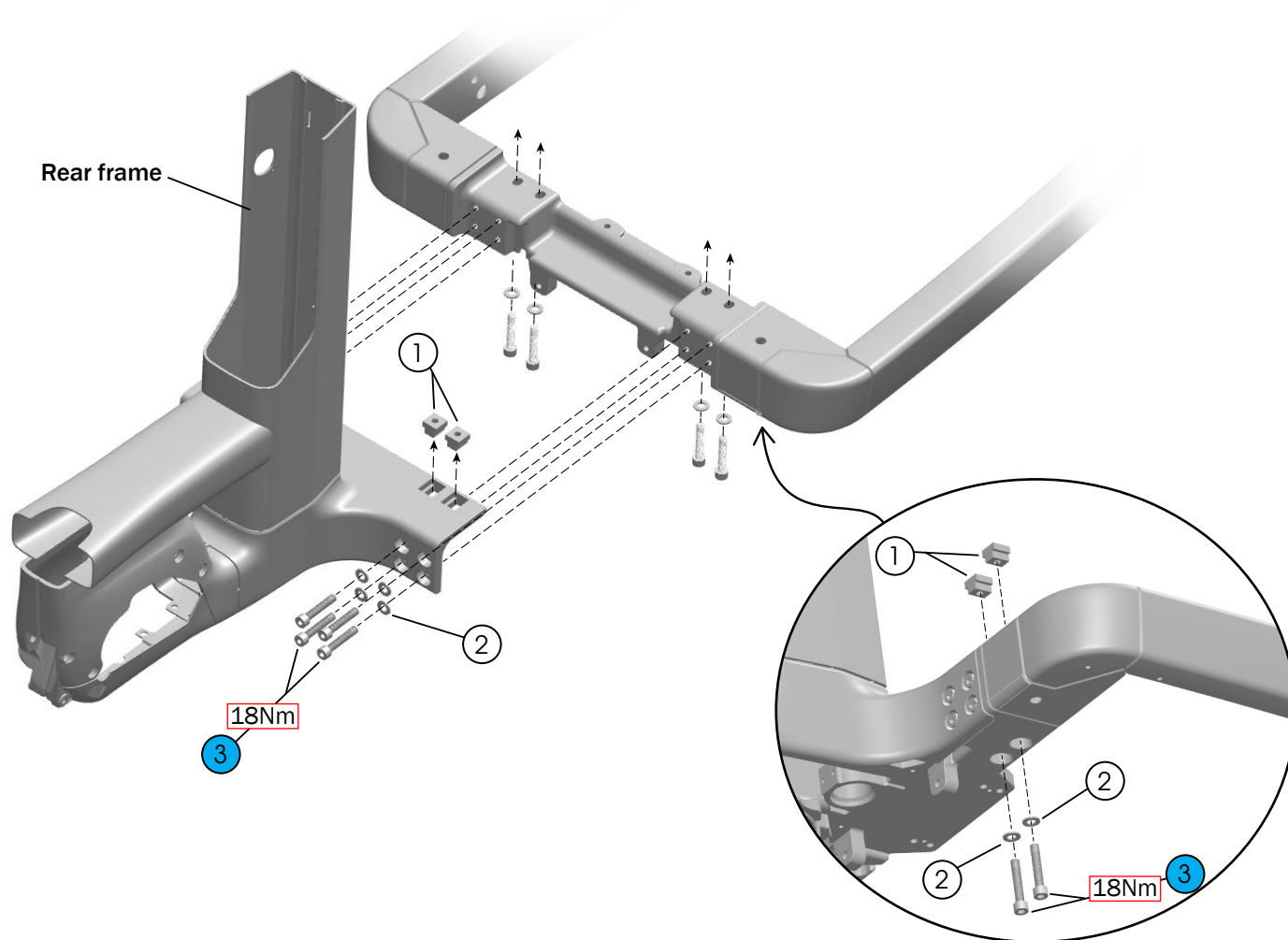

- ① T-nuts
- ② Washers (M8)
- ③ Bolts (M8x45mm)

[5286563](#)

IMPORTANT: If connecting the front and rear frame together, follow the frame tightening sequence on page 25.

Steering

Drivetrain

Routing

Battery

Headsets

Frame

Accessories

Frame: frame tightening sequence

1. Tighten the eight horizontal bolts to 5Nm.

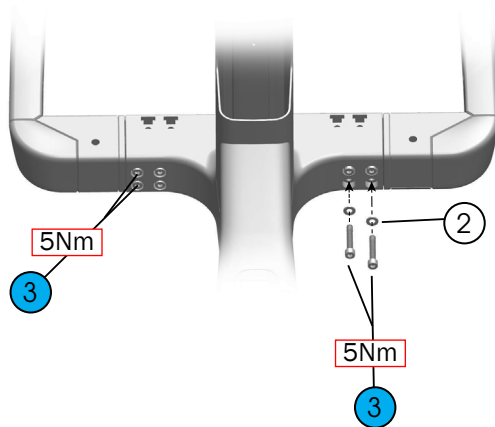

2. Tighten the four vertical bolts to 5Nm.

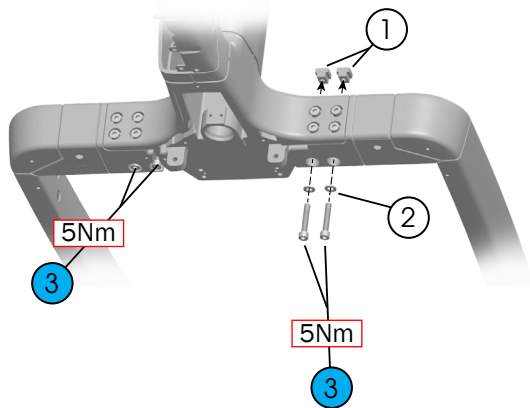

3. Fully tighten the eight horizontal bolts — in an X pattern — to 18Nm in the order shown below.

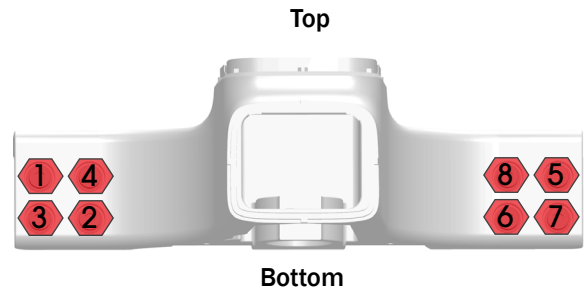

4. Fully tighten the four vertical bolts — outside first — to 18Nm in the order shown below.

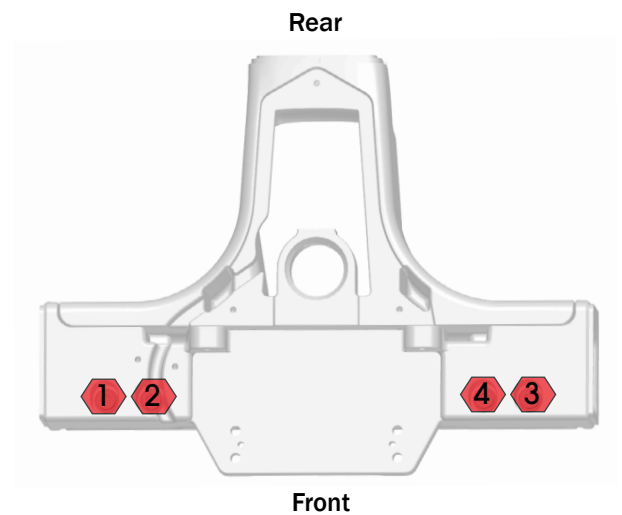

Steering

Drivetrain

Routing

Battery

Headsets

Frame

Accessories

Accessories: front fender and light



or [Click here](#)

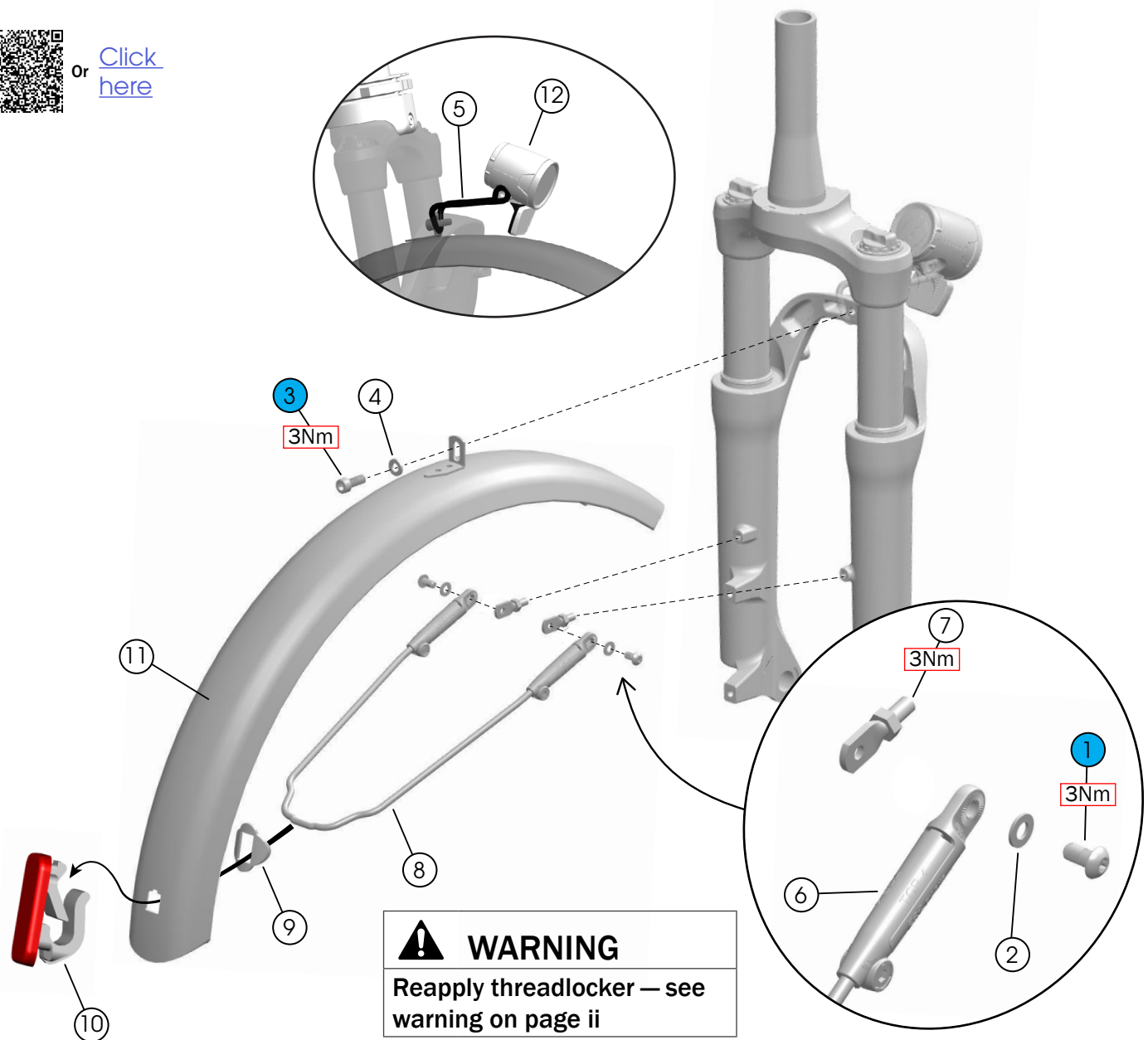

① Bolts, T25 drive (M5x10mm)

② Washers (M5)

③ Bolt (M6x16mm)

④ Washer (M6)

⑤ Light bracket

⑥ Stay mounts — [5258260](#)

⑦ Mount bolts — [W331954](#)

[5284747](#)

[5286558](#)

⑧ Fender stay (20"x65mm) — [W5269940](#)

⑨ Stay holder

⑩ Stay damping rubber

⑪ Front fender — [W5269617](#)

⑫ Front light — [598624](#)

[5258253](#)

Steering

Drivetrain

Routing

Battery

Headsets

Frame

Accessories

Accessories: rear fender and light



or [Click here](#)

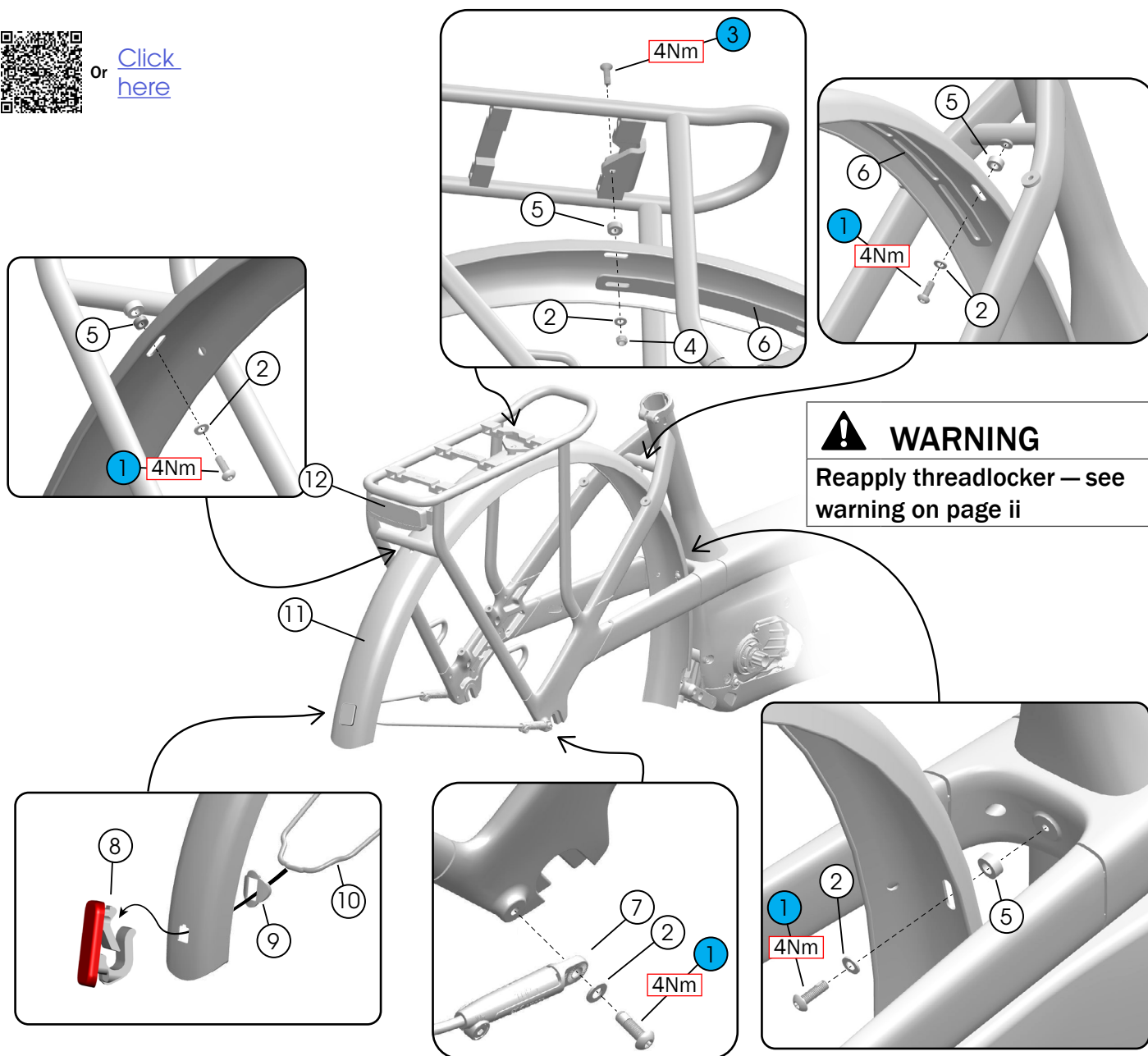

- ① Bolts, T25 drive (M5x16mm)
- ② Washers (M5)
- ③ Bolt (M5x18mm)
- ④ Nut (M5)
- ⑤ Spacers (5mm) — [5307541](#)
- ⑥ Strut (380mm) — [W600320](#)

[5284754](#)

- ⑦ Stay mounts — [5258260](#)
- ⑧ Stay holder
- ⑨ Stay damping rubber
- ⑩ Fender stay (27.5"x65mm) — [W5269996](#)
- ⑪ Rear fender — [W5269618](#)
- ⑫ Rear light — [*W504513](#)

[5258253](#)

**Replacement part is different than the original*

Steering

Drivetrain

Routing

Battery

Headsets

Frame

Accessories

Accessories: ring lock



Or [Click here](#)

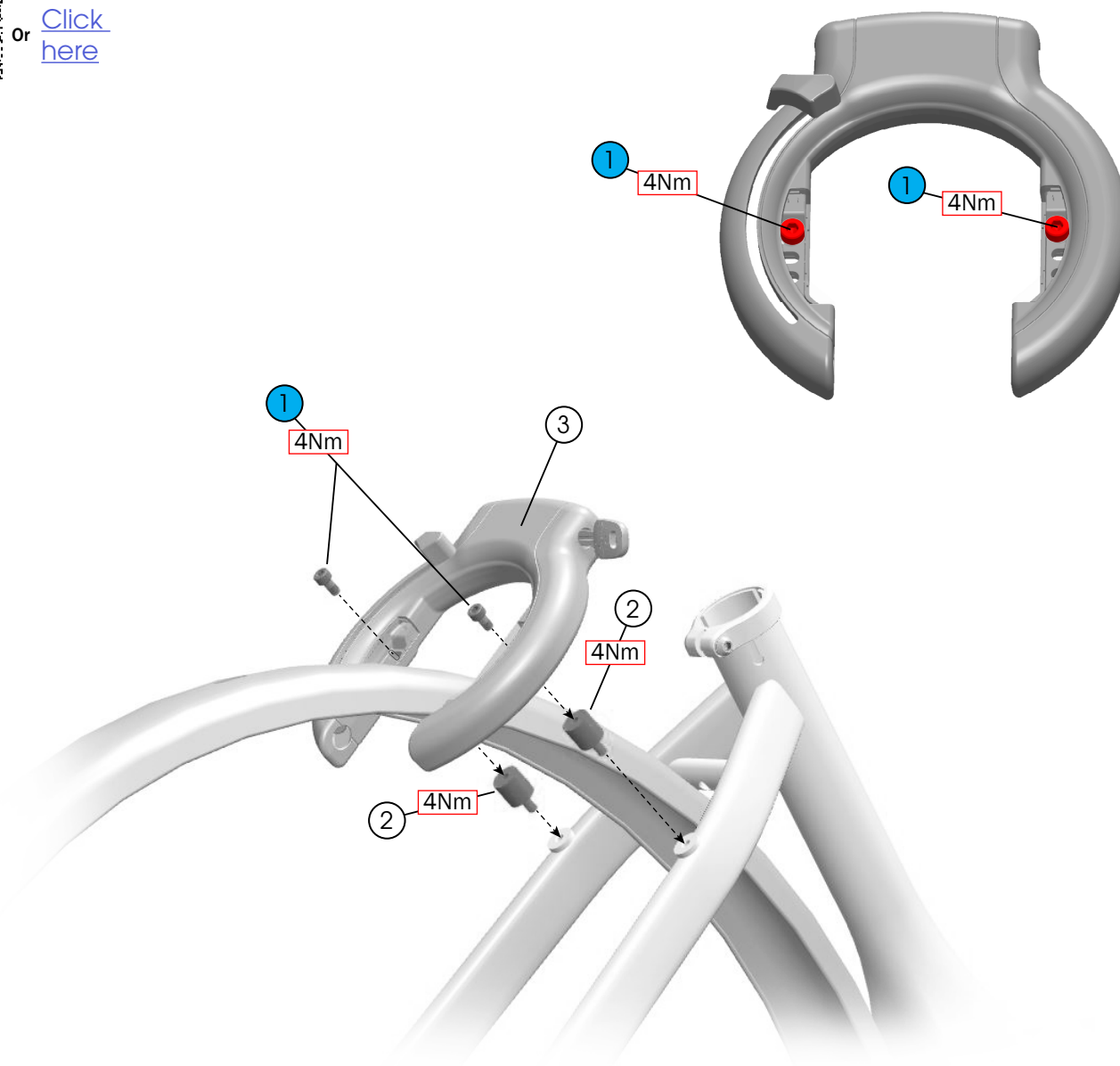

① Bolts (M5x10mm)

② Vibration dampers (M5x10mm)

③ Ring lock

[5284753](#)

Non-retainable — [5253038](#)

*Retainable — [592162](#)

*The key cannot be removed if the ring lock is unlocked.

Steering

Drivetrain

Routing

Battery

Headsets

Frame

Accessories

Accessories: kickstand



or [Click here](#)

NOTE: Replace the springs (8) every two years.

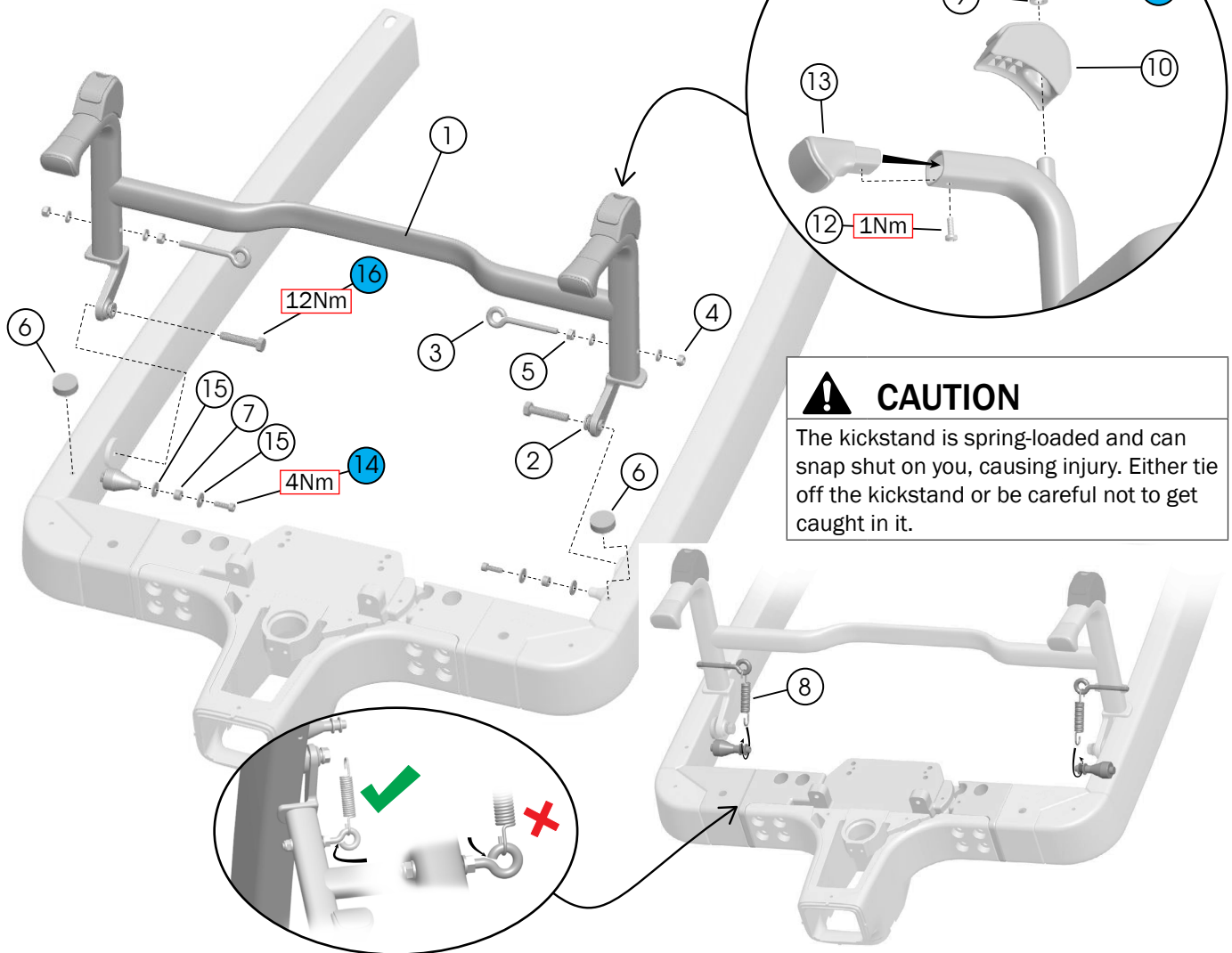

CAUTION

The kickstand is spring-loaded and can snap shut on you, causing injury. Either tie off the kickstand or be careful not to get caught in it.

- ① Kickstand
- ② Bearings
- ③ Eye bolts (M6x65mm)
- ④ Nuts, nylock (6mm)
- ⑤ Nuts (6mm)
- ⑥ Threaded bumper
- ⑦ Spacers (6mm)
- ⑧ Springs — 5291884

[5280791](#)

- ⑨ Washers (M6)
- ⑩ Knee
- ⑪ Bolts (M6x20mm)
- ⑫ Bolts (M3.5x15mm)
- ⑬ Foot
- ⑭ Bolts (M5x16)
- ⑮ Washers (M5), oversized
- ⑯ Bolts (M8x40)

[5288121](#)

[5291301](#)

[5280791](#)

Steering

Drivetrain

Routing

Battery

Headsets

Frame

Accessories

Accessories: child seats



or [Click here](#)

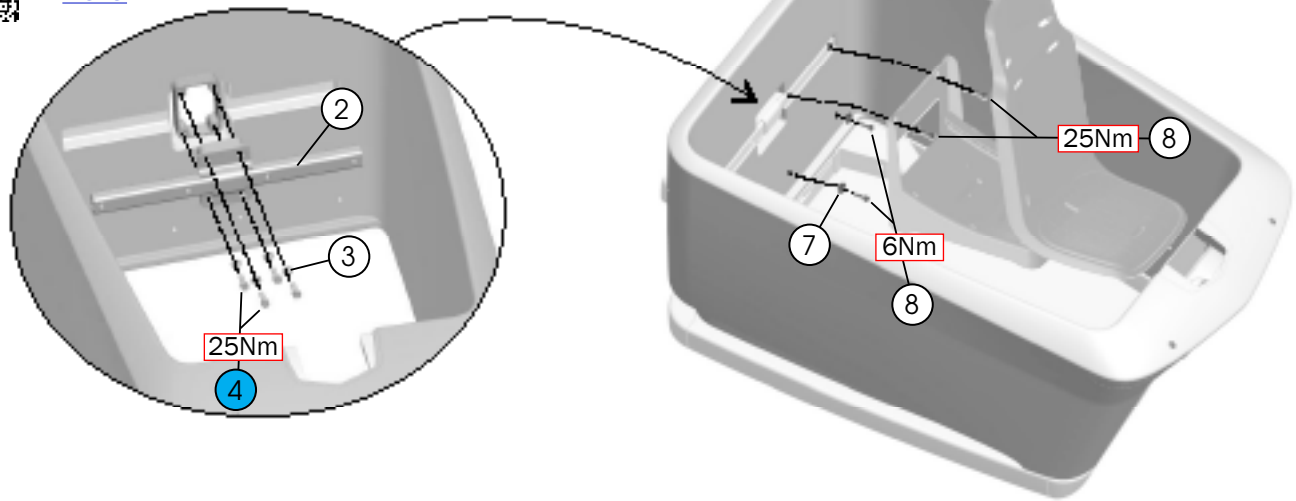

With headrest

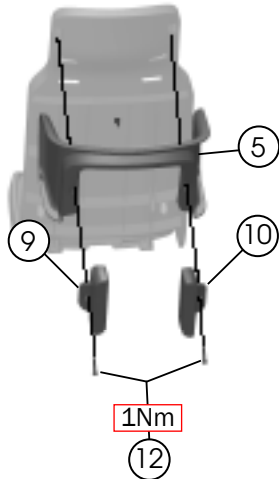

Without headrest

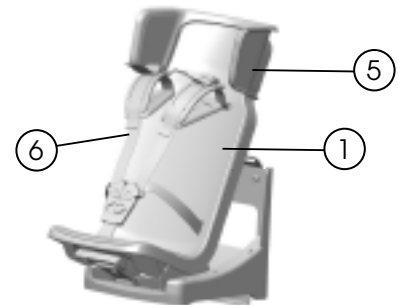
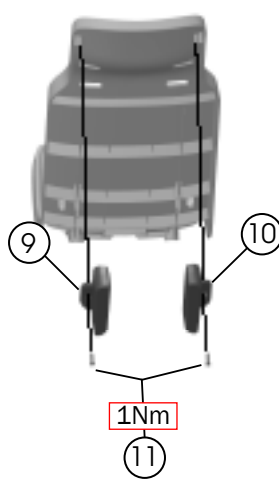

① Child seat — [5283900](#)

② Crossbar mount — [W5270763](#)

③ Washers (M8)

④ Bolts (M8x25mm)

⑤ Headrest — [5298521](#)

⑥ Harness — [5291779](#)

⑦ Mushroom fasteners

⑧ Bolts (M8x16mm)

[5286564](#)

[5291431](#)

⑨ Left bumper

⑩ Right bumper

⑪ Bolt (16mm), without headrest — [W5313645](#)

⑫ Bolt (25mm), with headrest — [W5313646](#)

[5310015](#)

Steering

Drivetrain

Routing

Battery

Headsets

Frame

Accessories

Accessories: install the child seats

1. Pull the inner latch and put the seat in the fully reclined position.

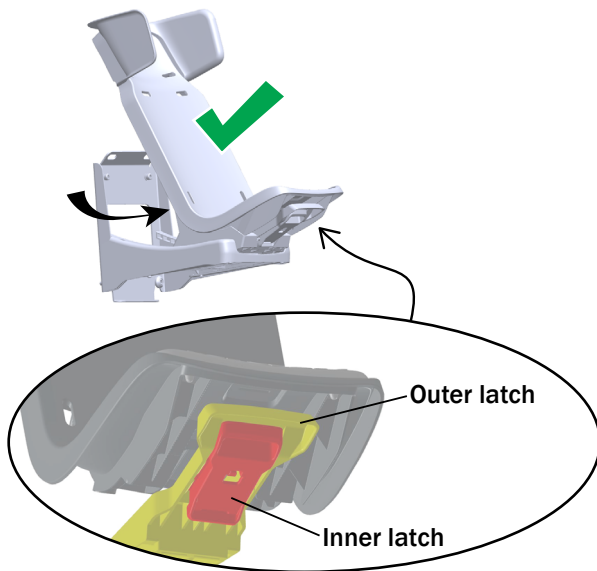

2. Slide the seat down onto the mushroom fasteners.

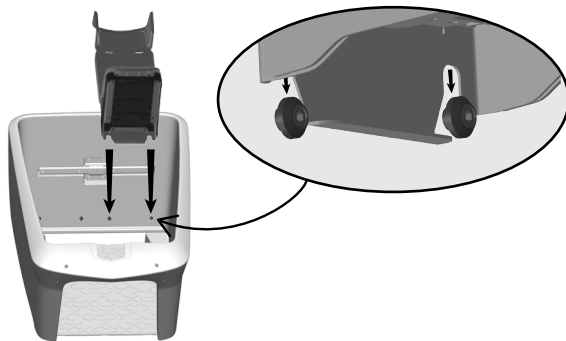

3. Install the upper bolts and torque to 25Nm.

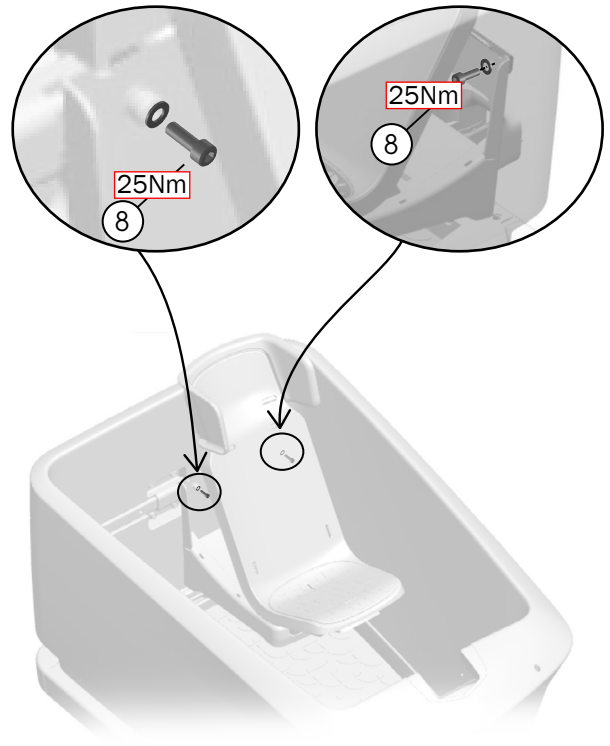

4. Put the seat in the fully upright position.
5. Install the other seat following Steps 1-4.

Steering

Drivetrain

Routing

Battery

Headsets

Frame

Accessories

Accessories: remove the child seats

1. Pull the inner latch and put one seat in the fully reclined position.

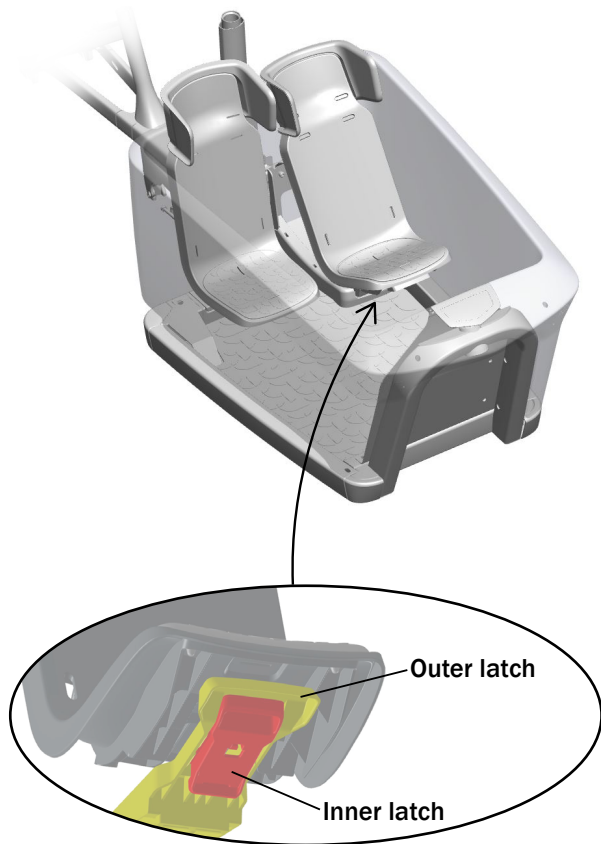

2. Remove the upper bolts.

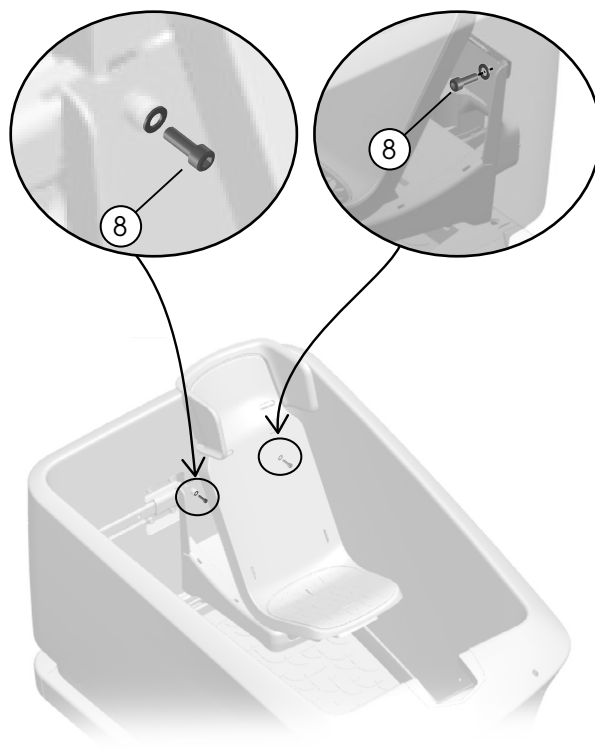

3. Pull the seat up and remove it.
4. Remove the other seat following Steps 1-3.

Steering

Drivetrain

Routing

Battery

Headsets

Frame

Accessories

Parts list

Wheels

	Part number
Front wheel	W5292177
Rear wheel	W5292180
Front rim	W5283286
Rear rim	W5283287
Hub axle	5304638
End caps	436181
Axle bearings	431759
Rim strip (20")	W5280094
Rim strip (27.5")	W332413
Tire pick-up twinskin (20")	W5273457
Tire pick-up twinskin (27.5")	W5273456

Cranks

	Part number
Crank prowheel ISIS 170mm	W571998
Crank bolts	W572003

Brakes (Tektro)

	Part number
Brakeset Dorado Cargo HD-T737	W5280220
Brakeset Dorado Cargo HD-E737R	W5280221
Rotor TR-17 180mm 2.3mm	5293931
Rotor TR-17 203mm 2.3mm	5293932
A-11 PM to PM Spacer 20mm	1048801
A-12 PM to PM Spacer 23mm	1048802
Hydraulic brake fluid 100mL	5295307
Q13RS 5.0mm	5293929
Olive & barb Dorado Auriga Comp Draco	5293930

Seatpost (TranzX)

	Part number
Seatpost 31.6 120mm with dropper post	W571998

Specifications

		Fetch+ 4
Rear hub OLD		142mm
Tire width max 700c	Front	25mm
	Rear	28mm

Dropper post stiffness

Weight of rider	Pressure
>50-70kg	200-230PSI
75-100kg	230-260PSI
100-125<	260-300PSI