



Bontrager Ion 100 R and Flare R City

The Bontrager Ion 100 R is a daylight-visible headlight that provides 100 lumens of broad, balanced light to see and be seen in the city, day or night.

The Bontrager Flare R City is a daylight-visible tail light that provides 35 lumens of broad, balanced light to be seen in the city, day or night.

Each light in its brightest mode may be visible from 900 meters (0.5 miles), with a broad light pattern ideal for riding in city and urban environments. Proper setup and selection of mode is critical to maximize visibility and riding safety.

Install the lights with the power button facing up and the lens perpendicular to the ground. This position will maximize visibility for cars and for illuminating your environment. The daytime flash modes are the brightest, so are best reserved for day use. Night steady and night flash modes are designed for use in the dark. These lights also feature an ambient light sensor that can automatically select the best flash mode for your environment.

About this manual

This manual is for Bontrager lights Ion 100 R (headlight) and Flare R City (tail light).

Please read this entire manual, especially the safety information. Check for updates at trekbikes.com

IMPORTANT: Check your local lighting laws. Flashing lights and full brightness may not be allowed in all locations. Ion 100 R and Flare R City do not conform to the German road traffic regulation StVZO.

For more information

If you need help not offered by this manual, talk to your Bontrager retailer or visit trekbikes.com.

Bontrager Ion 100 R and Flare R City

bontrager.com

BT17_ION_100_R_FLARE_R_CITY_V2

List of parts Ion 100 R

Headlight with sealed lithium-ion battery (USB rechargeable)



Quick-connect bracket for headlight (PN W527649)



Fits any size round handlebar, 22.2mm to 35mm.

Charger cable (PN W327765)

Micro USB cable can be plugged into a computer or wall adapter (adapter not included).



Use with a quality CE or UL approved USB charger rated for 500 mA or greater.

Flare R City

Tail light with sealed lithium-ion battery (USB rechargeable)

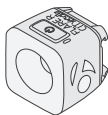

Quick-connect bracket for tail light (PN W533846)



Easily mounts to the seatpost of any Trek city, road, or mountain bike. Features a built-in 16 degree offset to place the lens perpendicular to the ground with a normal seatpost angle.

Accessories

The Ion 100 R and Flare R City lights are compatible with these optional mounting systems. Please see your Bontrager retailer for details.

Bontrager helmet mount (PN 428462)

- Strap mount easily attaches a Bontrager Ion or Flare light to most helmets.

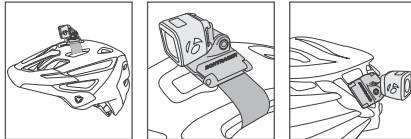

Bontrager Lithos helmet Blendr accessory mount (PN 516635)

- Blendr mount integrates into the Bontrager Lithos helmet.

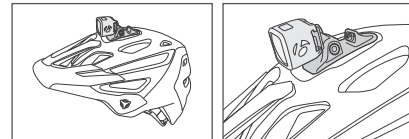

Bontrager seatstay bracket (PN 418932)

- Adjustable plastic mount fits low on the frame.

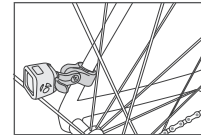

Bontrager seatpost clamp (PN 418932)

- Rigid clamp with adapters for seatposts from 22.2-31.8mm.

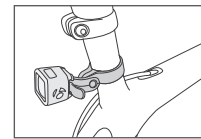

Bontrager seat pack clip (PN W528503-plastic, PN 424905-steel)

Clip-style light mount attaches to seat bags, backpacks, belts, and pockets.

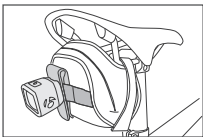

Bontrager Blendr accessories

Ion Bar Mount (PN W510438)

- Attachment system for Bontrager Blendr stems fits a variety of accessories. See your Bontrager retailer for details.

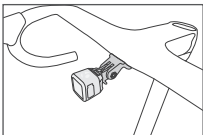

Installation

Before first use, charge the battery.

To install the Ion 100 R

1. Place the quick-connect on the handlebar with the hook in front.

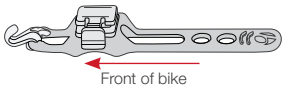

2. Stretch the strap under the bar and connect to the hook.

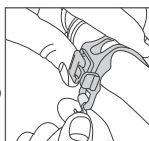

NOTE: Use the second hook to latch excess strap.

3. Slide the ION 100 R onto the bracket until it clicks.

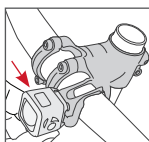

The power button should be facing up and the lens of the light should be perpendicular to the road.

To install the Flare R City

1. Install the quick-connect bracket on the seatpost with the lever to the drive side of the bike. When installed properly, the lens will be perpendicular to the ground and the saddle icon will point the same direction as the saddle on the bike.

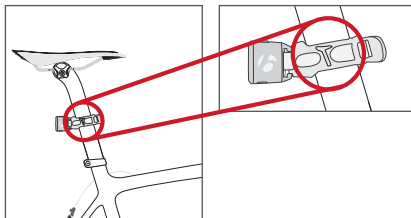

2. Stretch the strap around the seatpost and connect to the hook.

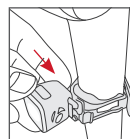

3. Slide the light onto the bracket.

Removal

To remove the Ion 100 R

Press down on the tab and slide the light away from the lever.

Alternatively, you can remove the entire quick-connect bracket, with the light attached.

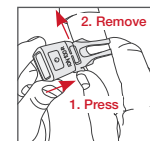

To remove the Flare R City

Press down on the tab and slide the light away from the lever.

Alternatively, you can remove the entire quick-connect bracket, with the light attached.

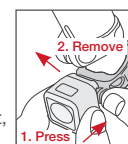

Operation

To power on, press the power button.

The light will be in the output mode last used.

To power off, press and hold the power button until the light turns off.

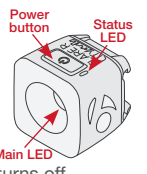

Auto brightness

The lights automatically adjust their brightness for maximum visibility and battery conservation.

The Ion 100 R and Flare R City get brighter as ambient light increases (day), and dimmer as ambient light decreases (night).

NOTE: When auto brightness is enabled, Ion 100 R modes are 100, 50, 5, and auto flash. Flare R City modes are auto flash, or auto steady.

To disable or enable auto brightness, press and hold the power button 8 seconds. The main LED will flash once.

Battery status feature

The status LED tells the percent of battery charge that remains.

Status LED color	Charge remaining
Red steady	5 to 25%
Red flashing	Less than 5%

Low battery feature

The light automatically changes to low battery flash mode when the battery supply goes below 5%. This extends the light output for an additional hour.

⚠ WARNING

A bicycle without correct lights and reflectors might be difficult for other people to see, and you might not be able to see. If you cannot see, or other people cannot see you, you could have an accident. Make sure your lights operate correctly and that batteries are charged.

To change mode

1. Quick-press the power button. Each press moves to the next mode (see table below).

Ion 100 R Modes*	Lumen Output (peak)	Runtime (hours)	Auto Brightness
High	100	1.5	No
Medium	50	3	No
Low	5	16	No
Auto flash			
Day	100	8	Yes
Night	100	7	Yes

Flare R City Modes*	Lumen Output (peak)	Runtime (hours)	Auto Brightness
Auto flash			
Day	35	8	Yes
Night	35	16	Yes
Auto steady			
Day	20	3	Yes
Night	2	20	Yes

*With auto brightness enabled.

⚠ CAUTION

The light may be hot to touch.

Charging the battery

Both the Ion 100 R and Flare R City are fully charged in the packaging, but we recommend that you charge them before first use. Complete charging takes approximately 1.5 hours from empty.

1. Open the USB port cover.
2. Plug the Micro charger cable into the USB port on the light.
3. Plug the cable into a computer or wall adapter.
4. When the charge is complete, unplug the Micro charger cable and close the USB port cover.

IMPORTANT: Ensure USB cover is latched before riding in the rain or in wet conditions. If USB cover is not closed, damage to the light may occur.



Status indicator while charging

While charging, the status LED indicates the battery charging status.

Status LED	Battery power status
Flashing red	Charging: The flash rate slows as charging nears completion
Off	Charge complete

For best results, charge at room temperature in a dry place. Use a quality CE or UL approved USB charger rated for 500 mA or greater. Avoid extreme conditions including wet, cold, or extremely hot.

Traveling with the light(s)

The light contains a lithium-ion battery. Certain restrictions may apply to this product when traveling, especially when traveling by air. Always check with your carrier for specific restrictions prior to traveling with this product.

Caring for the battery

Store the light at room temperature in a dry place. Avoid moisture, or extreme hot or cold.

Store the light in the charged condition. Avoid "deep discharge." Battery life will decrease if the light is stored in a fully discharged condition.

Over time, the run time of the battery will diminish. Expect about 500 full charges, depending on care. After a full life, the battery will continue to charge but with a lower run time. When the run time is unsatisfactory, please recycle. Do not open the case of the light or incinerate.

Specifications

- Ion 100 R: 3.7Vdc, 250mAh, 0.9Wh
- Flare R City: 3.7Vdc, 250mAh, 0.9Wh

Recycling

Please recycle the battery.

In the US, you can find out where to do this at call2recycle:

<http://www.call2recycle.org/>

This symbol on the product(s) and/or accompanying documents means that used electrical and electronic products should not be mixed with general household waste. For proper treatment, recovery, and recycling outside the US, please take this product(s) to designated collection points. Alternatively, in some countries you may be able to return your products to your local retailer upon purchase of an equivalent new product. Disposing of this product correctly will help save valuable resources and prevent any potential negative effects on human health and the environment, which could otherwise arise from inappropriate waste handling. Please contact your local authority for further details of your nearest designated collection point. Penalties may be applicable for incorrect disposal of this waste, in accordance with your national legislation.

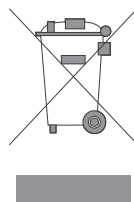

Trek contact information

North America

Trek Bicycle
801 West Madison Street
Waterloo, WI 53594 USA
Tel: +1 800-313-8735

Europe

Bikeurope BV
Ceintuurbaan 2-20C
3847 LG Harderwijk
The Netherlands
Tel: +31 (0)33 45 09 060

Australia

Trek Bicycle Corp. Au.
8 Townsville Street
(Level One)
Fyshwick (ACT)
2609 AU
Tel: +61 (02) 61 732 400

European Union Compliance

Ion 100 R and Flare R City do not comply with German StVZO regulations!

Trek Bicycle Corporation and Bontrager hereby declare that the lighting device(s) identified as 'Ion 100 R' and 'Flare R City' are in compliance with the following European Directives:

- EMC Directive 2014/30/EU
- RoHS Directive 2011/65/EU