

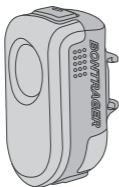

**Welcome.**

# Parts



**Flare R**



**Micro USB Cable**



**Quick Connect Bracket**

Bikeurope BV / Trek Benelux  
Ceintuurbaan 2-20C  
3847 LG Harderwijk  
The Netherlands  
Tel.: +31-(0)33-4500600 (BLX)

US Address: 801 West Madison Street, Waterloo, WI USA  
US Phone: 920 478 2191

## Description

Flare R is a daylight visible tail light with 65 lumens of balanced light that is visible up to 2 kilometers away.

Featuring a new ambient light sensor, Flare R automatically adjusts its brightness between day and night modes depending on the environment. It's designed to be brightest during the day to maximize visibility, and less bright in the dark to reduce the risk of dazzling approaching drivers. When combined with its unique Lock mode, a user selects their preferred mode and Flare R operation is simplified to a simple on and off with the power button.

Designed with the focus, flash, and range to be noticed on the road day or night, the Flare R is the ultimate daytime running light.

# Operation

## Powering On

Press and release the power button one time to turn on the light. The power button LED will show battery status.

## Changing the mode

Each quick-press of the power button will change to the next mode.

## Locking/Unlocking the mode

Turn on and select the desired mode, then press and hold the power button 8 seconds to select it. The light will turn off and the main LED will flash once. To unlock, repeat the process

## Enabling/Disabling the ambient sensor

The light is shipped with the ambient sensor enabled. To disable, with the light off, press and hold the power button 12 seconds. The light will flash twice.

## Powering off

Press and hold the power button until the light turns off.

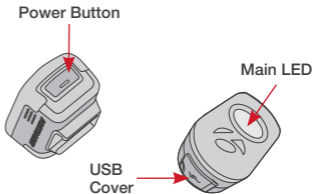

**IMPORTANT:** Ensure USB cover is latched before riding in the rain or in wet conditions. If USB cover is not closed, damage to the light may occur.

# Mode Descriptions

## **Day Flash 65\***

65-lumen random bursts for 5.75 hours

*Day Flash 65 offers daytime visibility up to 2Km with all super bright random pulses.*

## **All-Day Flash 35\***

35-lumen random bursts for 10 hours

*All-Day Flash 35 offers daytime visibility up to 1Km with all super bright random pulses and the side lights turned off for an exceptionally long run time.*

## **Night Flash 65\***

Always on with the side lights turned off, 65-lumen short duration bursts for 23 hours

*Night Flash 65 is constantly on with short bright pulses for optimized visibility in the night. It is designed to get attention without dazzling approaching vehicles or cyclists.*

## **Day Steady 25**

25 lumens for 4.25 hours

*This is a bright, non-flashing light for daytime "to be seen" visibility.*

## **Night Steady 5**

5 lumens for 21 hours

*This is a non-flashing light that is less bright for use at night when ambient light is low. It is also great for group rides.*

**\*IMPORTANT:** Check your local lighting laws. Flashing lights are not allowed in all locations. Flare R does not conform to the German road traffic regulation StVZO.

# Run Time Table

Ambient Sensor Enabled (default)		
Mode	Run time* (hours)	Low battery strobe** (hours)
Day Flash	5.75 – 23	+2
All-Day Flash	10 – 23	+2
Day Steady	4.25 – 21	+2

\***Run time** will vary as the ambient sensor switches between modes for the given amount of light.

Ambient Sensor Disabled		
Mode	Run time (hours)	Low battery strobe** (hours)
Day Flash	5.75	+2
All-Day Flash	10	+2
Night Flash	23	+2
Day Steady	4.25	+2
Night Steady	21	+2

**\*\*Low Battery Strobe:**

When the battery gets to 5% remaining charge, the light will automatically switch to a 5-lumen strobe mode and the status LED will begin blinking. This will provide up to 2 hours of runtime. If the light enters lower battery strobe, charge the light immediately for 2 hours for full charge.

 **WARNING**

A bicycle without correct lights and reflectors might be difficult for other people to see, and you might not be able to see. If you can not see, or other people can not see you, you could have an accident. Make sure your lights operate correctly and that batteries are charged.

# Charging and Charge Status

Although the Flare R is fully charged at the factory, it is recommended to charge it before first use. Complete charging takes approximately 2 hours from empty.

## Charging

While charging via the USB port, the light will remain off but the status LED will flash to show the charging status.

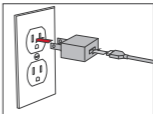
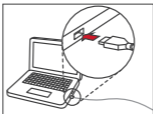
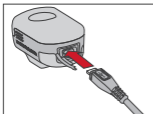

**IMPORTANT:** Use a quality CE or UL approved USB charger rated for 500 mA or greater.

**Flashing red:** Actively charging.

As the battery progresses from zero charge (red) to full charge (green), the flashes will get progressively longer in duration. Green: Charging has completed.

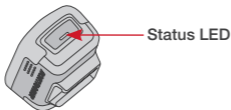

## Charging LED progression





# Battery Level Status

## Battery Level Indicator (Run time):

When the Flare R is switched on, the status LED in the power button indicates the battery power remaining.

Button light color	Power remaining
Green	More than 25%
Red	Between 5% and 25%
Blinking red**	Less than 5%

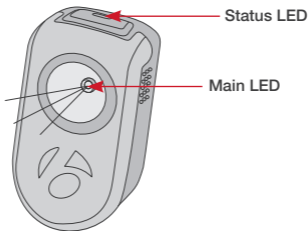

## \*\*Low Battery Strobe:

When the battery gets to 5% remaining charge, the light will automatically switch to a 5-lumen strobe mode and the status LED will begin blinking. This will provide up to 2 hours of runtime. If the light enters lower battery strobe, charge the light immediately for 2 hours for full charge.

## Mounting

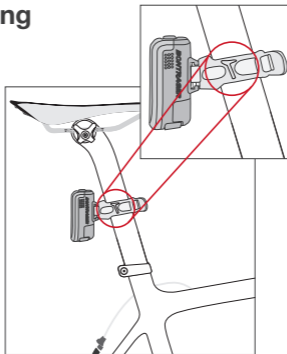

**IMPORTANT:** Ensure the light's lens is oriented perpendicular to the ground and free of any dirt and debris to optimize visibility.

**NOTE:** Use the second hook to latch excess strap.

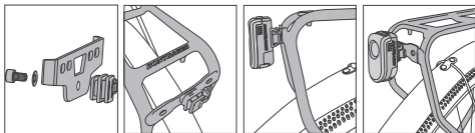

**Rack attachment:** Remove rubber strap from quick connect and affix to rack with M5 x 8mm screw and 10mm dia x 1mm thick cupped washer.

## Accessories

This light is compatible with these optional mounting systems. Please see your Bontrager retailer for details.

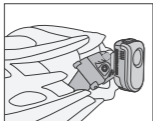

Bontrager helmet mount (PN 428462)

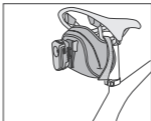

Bontrager seat pack clip (PN W528503 - plastic/PN 424905 - steel)

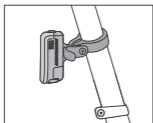

Bontrager seat post clamp (PN 418932)

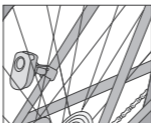

Bontrager seat-stay bracket (PN 418932)

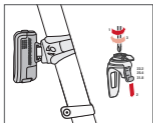

Bontrager Sync bracket (PN 418921)

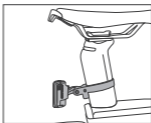

Speed Concept mounting  
Combine PN 418932 with PN W327560 (2014+ Speed Concept) or PN W306729 (2011-2013 Speed Concept)



## **About this Manual**

This is the manual for your Flare R.  
Check for updates at [bontrager.com](http://bontrager.com).